

REC'D. BY
M M R APR 17 1997

ORDINANCE NO. 3087

AN ORDINANCE ANNEXING TO THE CITY OF ROCHESTER APPROXIMATELY 55 ACRES OF LAND LOCATED IN THE SOUTHEAST QUARTER OF THE SOUTHEAST QUARTER OF SECTION 18, TOWNSHIP 106 NORTH, RANGE 13 WEST, OLMTSTED COUNTY, MINNESOTA.

THE COMMON COUNCIL OF THE CITY OF ROCHESTER DO ORDAIN:

Section 1. A petition has been filed with the Common Council of the City of Rochester, signed by the owners of land described herein, requesting the Common Council to annex said land to the City of Rochester. The land described in said petition for annexation is located in Marion Township, Olmsted County, Minnesota, and is described as follows:

The Southeast Quarter of the Southeast Quarter (SE 1/4 SE 1/4) of Section Eighteen (18), Township One Hundred Six (106) North of Range Thirteen (13) West; and That part of the Northeast Quarter of the Southeast Quarter (NE 1/4 SE 1/4) of Section Eighteen (18), Township One Hundred Six (106) North of Range Thirteen (13) West, described as follows: Commencing at the Northeast corner of the Southeast Quarter (SE 1/4) of Section Eighteen (18), Township One Hundred Six (106) North of Range Thirteen (13) West, thence South along the East line of said Southeast Quarter a distance of 780.13 feet for a place of beginning, thence North 82°02' West 558.02 feet, thence North 4°38'55" East 334.85 feet to the center of a township road running in an Easterly and Westerly direction through said Section, thence North 81°27' West along the center of said road a distance of 154.44 feet, thence South 1°10' West a distance of 871.2 feet, thence North 80° West a distance of 466.98 feet, thence North 1°10' East 871.2 feet to the center of said township road, thence North 80° West along the center of said road to the West line of said Northeast Quarter of the Southeast Quarter, thence South along the said West line to the Southwest corner of said Northeast Quarter of the Southeast Quarter, thence East along the South line of said Northeast Quarter of the Southeast Quarter, to the Southeast corner of said Northeast Quarter of the Southeast Quarter thence North along the East line of said Northeast Quarter of the Southeast Quarter to the place of beginning, containing 55.75 acres, more or less.

Section 2. The total quantity of land included in said petition is approximately 55.75 acres in size.

Section 3. On February 3, 1997, the Common Council held a public hearing to consider this annexation petition after providing written notice of the hearing, by registered mail, to the property owner, the Marion Township officers, and the adjacent property owners.

REC'D BY APR 17 1997
M M M

Section 4. Following the public hearing, the Common Council of the City of Rochester determined that the land abuts the municipal limits, is less than 60 acres in area, the annexation petition is signed by all property owners of the land described in Section 1, and the land is or will soon become urban or suburban in character.

Section 5. Therefore, pursuant to Minn. Stat. §414.033, subd. 2(3), the land described in Section 1 above is hereby annexed, added to and made a part of the City of Rochester, Minnesota, as effectually as if it had originally been a part thereof.

Section 6. Present and future owners of the lands annexed by this ordinance are hereby notified that in addition to the usual assessments, it is the intention of the Common Council to assess against benefitted property all or a portion of the cost of any storm sewer, water tower, pumping station, and trunk line sanitary sewer construction, heretofore or hereafter undertaken to serve the area annexed.

Section 7. This ordinance shall take effect and be in force from and after its official publication and from and after the filing of a certified copy hereof with the Minnesota Municipal Board, the Marion Town Clerk, the County Auditor, and the Secretary of State.

PASSED AND ADOPTED BY THE COMMON COUNCIL OF THE CITY OF ROCHESTER, MINNESOTA, THIS 7TH DAY OF APRIL, 1997.

John Hanzler
PRESIDENT OF SAID COMMON COUNCIL

ATTEST:

Cindy Kay Scher
CITY CLERK

APPROVED THIS 8TH DAY OF APRIL, 1997.

Ed C. C. C.
MAYOR OF SAID CITY

(Seal of the City of
Rochester, Minnesota)

ord\annex96.17

REC'D. BY
MMR APR 17 1997

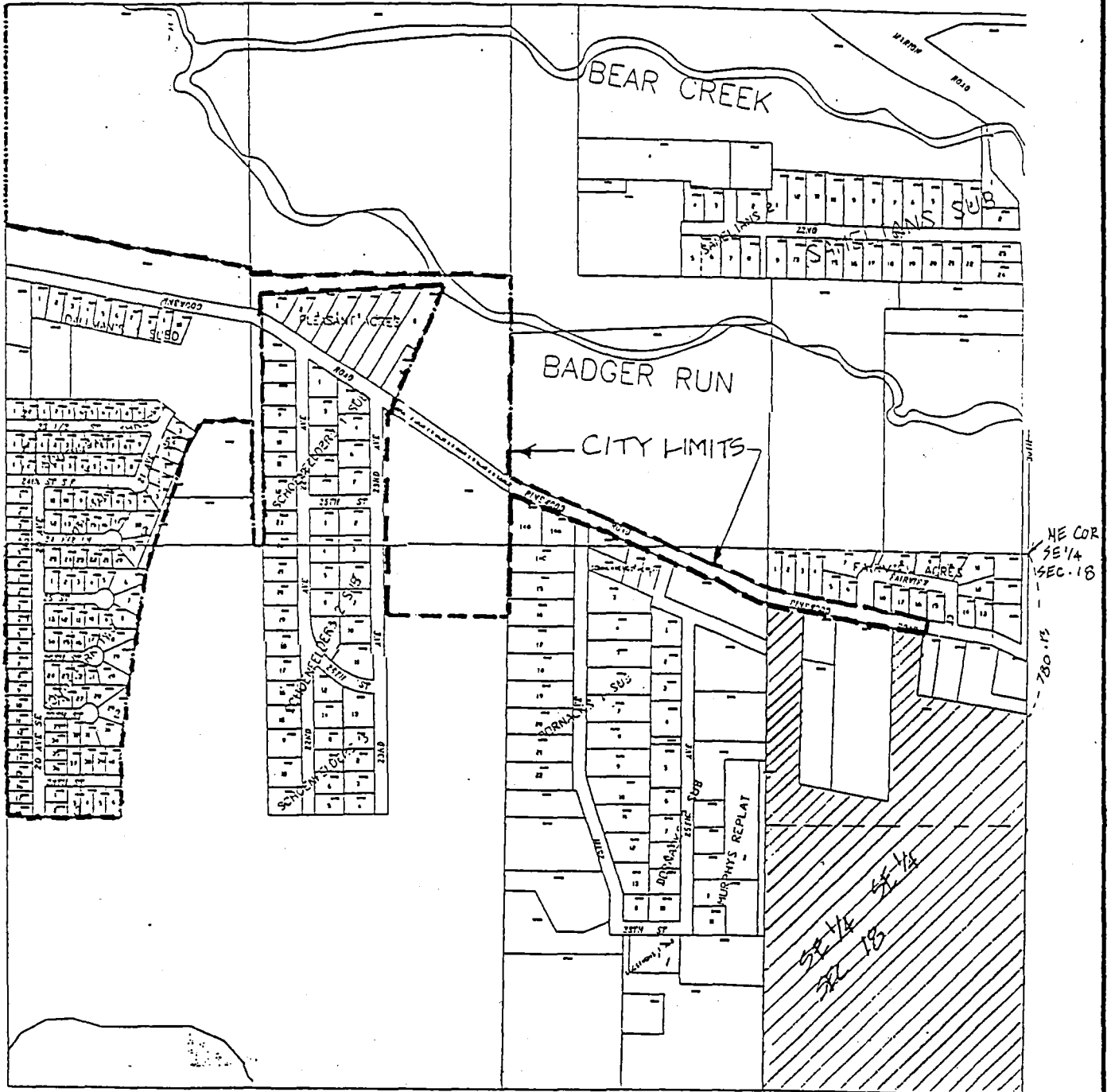

AREA TO BE ANNEXED = 55.75 AC.
POPULATION = 0

↑ NORTH
SCALE 1" = 600'

PART OF SECTION 18
MARRION TOWNSHIP

McGhie
Consulting Engineers

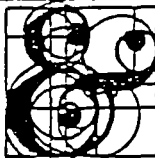

Betts, Inc.
Land Surveyors

ANNEXATION EXHIBIT

1645 3rd AVE. S.E.

Rochester, MN 55904

507-299-3912