

ORDINANCE NO. 11, SECOND SERIES
AN ORDINANCE AMENDING CITY CODE CHAPTER II
EXTENDING THE CORPORATE LIMITS OF THE
CITY OF NISSWA TO INCLUDE CERTAIN UNINCORPORATED
PLATTED LAND ABUTTING UPON THE CITY LIMITS

CITY OF NISSWA,
COUNTY OF CROW WING, STATE OF MINNESOTA

The City Council of the City of Nisswa ordains:

Section 1. Purpose and Intent. The purpose and intent of this ordinance is to extend the corporate limits of the City of Nisswa and to amend the City Code Chapter II, Part 6.

Section 2. Scope of Ordinance.

Chapter II, Part 6, Section 2.91 of the City Code shall be amended as follows:

WHEREAS, a certain petition dated February 20, 1997, requesting annexation of the territory hereinafter described was filed with the City on the 20th day of February, 1997, and duly presented to the Council and Planning Commission thereafter; and

WHEREAS, the petition was signed by all owners of property legally described as: The North 84 Feet of Lot 1, The Best Place, County of Crow Wing, State of Minnesota.

WHEREAS, no objections to the annexation have been received from the town board, or the government body of any municipality whose boundaries abut upon the boundaries of the land to be annexed; and

WHEREAS, an objection was received from adjoining property owners as well as a response from the Crow Wing County Auditor; and

WHEREAS, public hearings were duly held by the governing body of the City of Nisswa, Minnesota, as well as the City of Nisswa Planning Commission on the proposed annexation after published notice and mailed notice to requesting parties; and

WHEREAS, the land described in the petition abuts upon the City limits at the Southern boundary thereof;

The Council of the City of Nisswa, Minnesota, ordains:

1. The City Council hereby determines (1) that the territory described herein abuts upon the City limits and is urban or suburban in character; and (2) that none of the territory is now included

within the limits of any City.

2. The population of the territory is _____.

3. Territory annexed. The corporate limits of the City are hereby extended to include the platted land described as follows: and the same is hereby annexed to and included within the City as effectually as if it had originally been a part thereof: The North 84 feet of Lot 1, The Best Place, County of Crow Wing, State of Minnesota.

4. The City Clerk is hereby directed to file certified copies of this ordinance with the Minnesota Municipal Board, the Secretary of State, the Town Clerk, and the County Auditor.

5. Effective Date. This ordinance takes effect upon its passage and publication and the filing of the certified copies as directed in paragraph 4, and approval of the ordinance by the Minnesota Municipal Board.

Passed by the Council this 16th day of July, 1997, by a 4/5ths vote.

CITY OF NISSWA

By: Harold M. Kraus
Harold Kraus, Mayor

By: Janice Buss
Janice Buss, City Clerk

IN THE MATTER OF THE PETITION FOR
DANIEL F. PADRNOS AND YVONNE M. PADRNOS
FOR ANNEXATION PURSUANT TO MINNESOTA
STATUTES 414.033, SUBD. 5

TO: Council of the City of Nisswa, Minnesota and

Minnesota Municipal Board
Suite 225, Bandana Square
1021 Bandana Blvd. East
St. Paul, MN 55108

PETITIONERS STATE: The property owner or a majority of the property owners in number are required to commence a proceeding under M.S. 414.033, Subd. 5.

It is hereby requested by all of the property owners.

The area proposed for annexation is described as follows:

The North 84 feet of Lot 1, The Best Place according to the plat thereof on file and of record in the office of the Crow Wing County Recorder

1. There are 2 property owners in the area proposed for annexation.
2. 2 property owners have signed this petition.
3. Said property is unincorporated, abuts on the city's South boundary, and is not included within any other municipality.
4. The area of land to be annexed, in acres is approximately .8678 acres, is platted.
5. The reason for the requested annexation is to include all property of petitioners under a single governmental jurisdiction.
6. All of the annexation area is or is about to become urban or suburban in character.
7. The area proposed for annexation is not included in any area that has already been designated for orderly annexation pursuant to M.S. 414.0325.

PETITIONERS' REQUEST: That pursuant to M.S. 414.033, the property described herein be annexed to and included within the City of Nisswa.

REC'D. BY MAR 13 1997
MAR 13

Dated: February 20, 1997

Daniel F. Padrnos
Daniel F. Padrnos

Yvonne M. Padrnos
Yvonne M. Padrnos

c:\wp51\rac\gull4\pet.ann

UNORGANIZED TERRITORY T. 134 N.-R. 29 W.



2029 South 6th - Brainerd, Minnesota 56401
(Just North of Holiday Inn)

Phone: 828-0444

Lakeshore - Residential - Commercial
Appraising
Commercial & Residential Leasing



Highway 371 South of Nisswa

A FULL SERVICE GROCERY STORE WITH
A 70 YEAR TRADITION

963-2265

CENTRAL LAKES OIL, INC.

JOBBER FOR

•HOME •FARM •INDUSTRY

Automatic Keep Fill - Budget Plan Available
Metered Delivery

CENTRAL LAKES FUEL CLUB

24 Hour Availability of Gasoline & Diesel Fuel
Through Our New KardGard System

829-7175

9th & LAUREL — BRAINERD

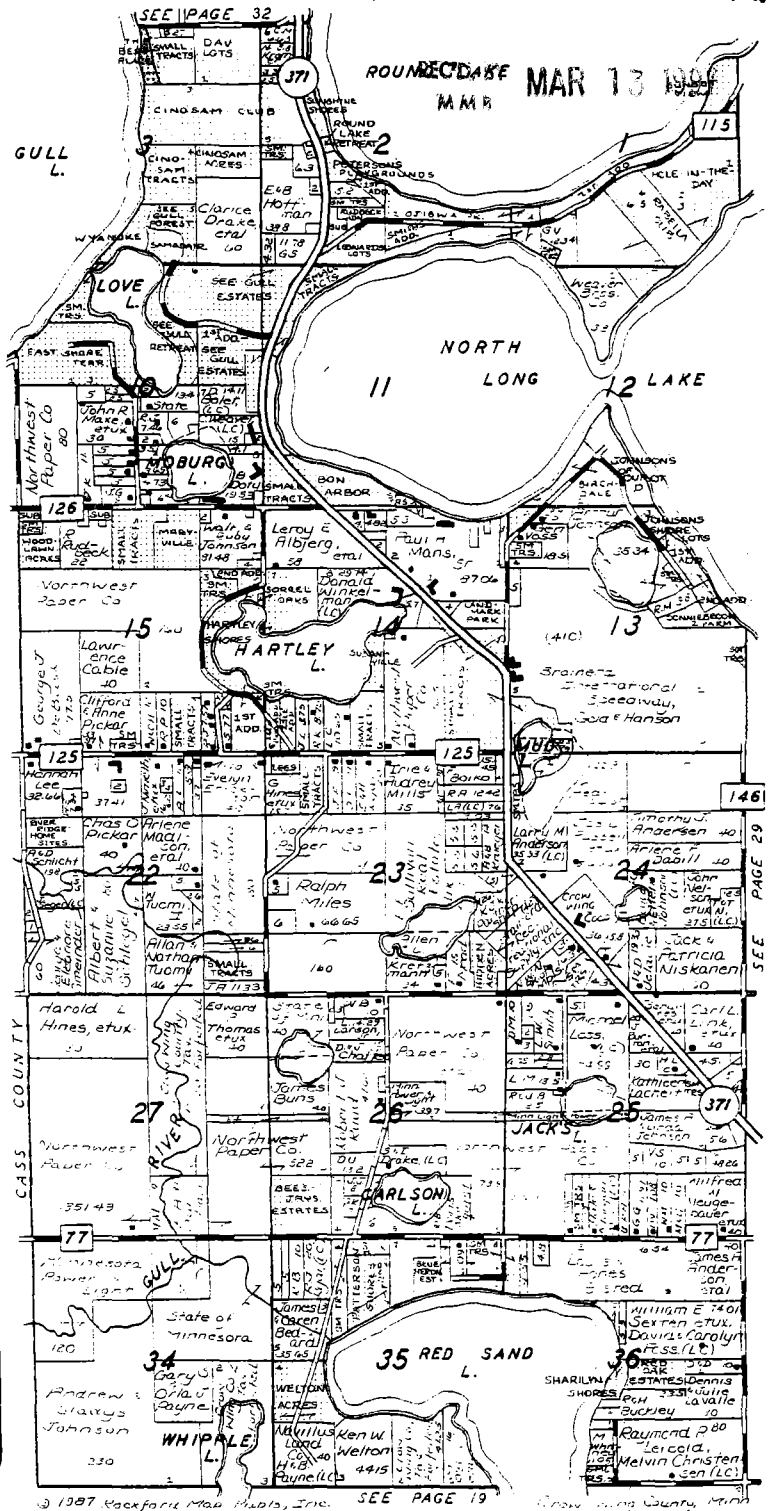

Ceramic — Quarry — Asbestos Floor Tile

Tile Installation

KENT JOHANSEN

(218) 829-3804

3663 Highway 210 West - Baxter, Minnesota 56401

SALES — SERVICE — PARTS

John's Camper Sales, Inc.

4146 Highway 371 North
Brainerd, Minnesota 56401
(Across from Bir.)

Phone: (218) 828-1045