

Proposed Ordinance No. 21/96

ORDINANCE NO. 1150

AN ORDINANCE EXTENDING THE CORPORATE LIMITS OF THE CITY OF OWATONNA TO INCLUDE CERTAIN UNINCORPORATED LAND ABUTTING THE CITY OF OWATONNA

**WHEREAS**, the City of Owatonna is the owner of the property described herein; and

**WHEREAS**, the property described lies in Sections 29, 30, 31, 32, and 33 of Township 108 North, Range 20 West and comprises approximately 729.12 acres including road right-of-way; and

**WHEREAS**, said property is suitably conditioned for and needs urban government; and

**WHEREAS**, no part of the property described herein is included within the limits of an incorporated city; and

**WHEREAS**, the City has authority pursuant to Minnesota Statutes 414.033, Subdivision 2 (1), to declare the property described herein annexed to the City; and

**WHEREAS**, the City of Owatonna is a city of the third class operating under a Home Rule Charter adopted pursuant to the provisions of the Constitution and Laws of the State of Minnesota.

**NOW THEREFORE, THE CITY COUNCIL OF THE CITY OF OWATONNA DO ORDAIN:**

**SECTION 1.** The City Council hereby determines:

1. That the annexation will be to the best interest of the City of Owatonna and of the property affected.
2. Said property is suitably conditioned for and needs urban government.
3. That none of said properties are now included within the limits of any incorporated city.

SECTION 2. That the following described property, referred to in the preamble of this ordinance, situated in the County of Steele, State of Minnesota, to-wit:

All that part of the SW1/4 and all that part of the South Half of the NW1/4 of Section 33, T 108 N, R 20 W, Steele County, Minnesota, described by:

Commencing at the southwest corner of said SW1/4; thence N 89°39' 34" E, assumed bearing, 1218.07 feet along the south line of said SW1/4 to a point on the centerline of County State Aid Highway 45, last said point being the True Point of Beginning; thence northwesterly along said highway centerline and along a nontangential curve concave to the southwest, central angle 19°09' 14", radius 2291.83 feet, arc length 766.15 feet, chord N 27°49' 15" W 762.59 feet; thence N 37°23'52" W 591.90 feet along said highway centerline; thence northwesterly along said highway centerline and along a tangential curve concave to the northeast, central angle 15°47'07", radius 1432.39 feet, arc length 394.63 feet to the easterly right of way line of Trunk Highway 35; thence N 2°59'54" W 408.87 feet; thence S 87°00'06" W 74.11 feet to said County State Aid Highway 45 centerline; thence northerly along said County State Aid Highway centerline and along a nontangential curve concave to the east, central angle 1°55'44", radius 1432.39 feet, arc length 48.22 feet, chord N 3°58'05" W 48.22 feet; thence N 3°00'13" W 686.22 feet to the north line of said SW1/4; thence N 89°37'57" W 33.07 feet along the north line of said SW1/4 to the easterly right of way line of said Trunk Highway 35; thence N 2° 59'54" W 476.4 feet along the easterly right of way line of said Trunk Highway 35; thence S 89° 30'10 E 1297.07 feet to the west right of way line of Midwestern Railroad Properties, Inc., formerly known as Chicago, Rock Island and Pacific Railroad; thence S 1°46'04" W 1179.86 feet along said Railroad right of way line; thence southerly along said Railroad right of way line and along a tangential curve concave to the east, central angle 11°39'33", radius 5779.65 feet, arc length 1176.12 feet; thence S 80°06'31" W 30.00 feet along said Railroad right of way line; thence southerly along said Railroad right of way line and along a nontangential curve concave to the east, central angle 0°47'23", radius 5809.65 feet, arc length 80.08 feet, chord S 10°17'11" E 80.08 feet to the south line of said N1/2 of SE1/4 of SW1/4; thence S 89°50'10" W 124.67 feet to the southwest corner of said N1/2 of SE1/4 of SW1/4; thence S 0°11' 30" W 654.22 feet to the southeast corner of the SW1/4 of said SW1/4; thence S 89°39'34" W 99.84 feet to said True Point of Beginning.

Containing 63.78 acres, more or less: AND

All that part of the SW1/4 of Section 32, T 108 N, R 20 W, Steele County, Minnesota, described by:

Beginning at the northwest corner of said SW1/4; thence S 89°37' 18" E, assumed bearing, 1547.72 feet along the north line of said SW1/4; thence S 49°53'31" W 1046.98 feet; thence S 41°21'40" W 337.06 feet; thence N 89°44'29" W 529.39 feet to the west line of said SW1/4; thence N 0°19'04" E 935.32 feet to beginning.

Containing 21.68 acres, more or less: AND

All that part of the NW1/4 of Section 32, T 108 N, R 20 W, Steele County, Minnesota, described by:

Beginning at the northwest corner of said NW1/4; thence S 89°41' 26" E, assumed bearing, 2624.09 feet to the northeast corner of said NW1/4; thence S 0°05'10" W 2657.18 feet to the southeast corner of said NW1/4; the N 89°37'18" W 2634.79 feet to the southwest corner of said NW1/4; thence N 0°19'00" E 17.05 feet along the west line of said NW1/4; thence N 58°25'21" E 120.44 feet; thence N 49°53'31" E 1812.20 feet; thence N 55°46'28" W 1785.46 feet to the west line of said NW1/4; thence N 0°19'00" E 402.14 feet to beginning.

Containing 121.92 acres, more or less: AND

All that part of the NE1/4 of Section 32, T 108 N, R 20 W, Steele County, Minnesota, described by:

Beginning at the northwest corner of said NE1/4; thence S 89°41' 47" E, assumed bearing, 2356.63 feet along the north line of said NE1/4 to the west right of way line of County State Aid Highway 23; thence S 2°59'54" E 2664.84 feet along the west right of way line of said highway to the south line of said NE1/4; thence N 89°37'18" W 2500.04 feet to the southwest corner of said NE1/4; thence N 0°05'10" E 2657.18 feet to beginning.

Containing 148.22 acres, more or less: AND

All that part of the SW1/4 and all that part of the SW1/4 of the SE1/4 of Section 29, T 108 N, R 20 W, Steele County, Minnesota, described by:

Beginning at the southwest corner of said SW1/4; thence N 0°20' 55" E, assumed bearing, 2006.97 feet along the west line of said SW1/4; thence S 55°46'28" E 1210.69 feet to the south line of the North Half of said SW1/4; thence S 89°47'08" E 390.08 feet along the south line of said N1/2 of SW1/4; thence S 13°03'46" E 321.67; thence S 55°46'28" E 1390.18 feet to the east line of said S1/2 of SW1/4; thence S 55°46'28" E 436.22 feet to the south line of said SE1/4; thence N 89°41'47" W 362.10 feet to the southwest corner of said SE1/4; thence N 89°41'26" W 2624.09 feet to beginning.

Containing 70.20 acres, more or less: AND

All that part of the SE1/4 of Section 29, T 108 N, R 20 W, Steele County, Minnesota, described by:

Commencing at the southeast corner of said SE1/4; thence N 89°41' 47" W, assumed bearing, 311.27 feet along the south line of said SE1/4 to a point on the west right of way line of County State Aid Highway 23, last said point being the True Point of Beginning; thence N 89°41'47" W 1856.98 feet along the south line of said SE1/4; thence N 49°53'31" E 1135.27; thence N 88° 33' 10" E 277.33; thence N 1° 26' 50" W 161.10 feet; thence N 49° 53' 31" E 834.25 feet to the west right of way line of said highway; thence S 2°59'54" E 1509.54 feet to said True Point of beginning.

Containing 31.41 acres, more or less: AND

The SE1/4 of Section 30, T 108 N, R 20 W, Steele County, Minnesota.

Containing 162.90 acres, more or less: AND

All that part of the North Half of the NE1/4 of Section 31, T 108 N, R 20 W, Steele County, Minnesota, described by:

Beginning at the northeast corner of said NE1/4; thence S 0°19' 00" W, assumed bearing, 225.00 feet along the east line of said NE1/4; thence N 89°41'00" W 412.00 feet; thence N 0°19'00" E 220.59 feet to the north line of said NE1/4; thence N 89°42'14" E 412.02 feet to beginning.

Containing 2.11 acres, more or less: AND

All that part of the North Half of the NE1/4 of Section 31, T 108 N, R 20 W, Steele County, Minnesota, described by:

Beginning at the northwest corner of said NE1/4; thence N 89°42' 14" E, assumed bearing, 482.00 feet along the north line of said NE1/4 to the centerline of Crane Creek; thence S 56°06'14" W 582.67 feet along said Creek centerline to the west line of said NE1/4; thence N 0°17'34" E 322.46 feet to beginning.

Containing 1.78 acres, more or less: AND

All that part of Lot 1 in the NW1/4 of Section 31, T 108 N, R 20 W, Steele County, Minnesota, described by:

Beginning at the northeast corner of said Lot 1; thence S 0°17' 34" W, assumed bearing, 322.46 feet along the east line of said Lot 1 to the centerline of Crane Creek; thence S 56°06'14" W 1077.13 feet along said Creek centerline to the west line of said lot 1; thence N 0°17'34" E 924.00 feet to the northwest corner of said Lot 1; thence S 89°56'49" E 891.00 feet to beginning.

Containing 12.75 acres, more or less: AND

All that part of the NW1/4 and all that part of the West Half of the SW1/4 of the NE1/4 of Section 30, T 108 N, R 20 W, Steele County, Minnesota, described by:

Beginning at the southeast corner of said NW1/4; thence N 89°34' 17" W, assumed bearing, 931.00 feet along the south line of said NW1/4; thence N 0°24' E 485.00 feet; thence N 89°48' E 952.00 feet; thence N 42°12' E 480.34 feet; thence N 63°36' E 312 feet, more or less, to the centerline of Crane Creek; thence southerly 246 feet, more or less, along said Crane Creek centerline to the east line of said W1/2 of SW1/4 of NE1/4; thence S 0°18'50" W 755 feet, more or less, to the south-east corner of said W1/2 of SW1/4 of NE1/4; thence N 89°34'17" W 663.24 feet to beginning.

Containing 22.4 acres, more or less: AND

All that part of the East Half of the SW1/4 of the NE1/4 of Section 30, T 108 N, R 20 W, Steele County, Minnesota, described by:

Commencing at the southwest corner of said E1/2 of SW1/4 of NE1/4; thence S 89°34'17" E, assumed bearing, 41.08 feet, along the south line of said NE1/4 to the True Point of Beginning; thence N 34°13' 32" E 297.16 feet; thence S 47°14'37" E 366.73 feet to the south line of said NE1/4; thence N 89°34'17" W 436.42 feet to said True Point of Beginning.

Containing 1.24 acres, more or less: AND

All that part of the East Half of the SW1/4 of the NE1/4 and all that part of the East Half of the NE1/4 of Section 30, T 108 N, R 20 W, Steele County, Minnesota, described by:

Commencing at the southwest corner of said E1/2 of SW1/4 of NE1/4; thence S 89°34'17" E, assumed bearing, 639.76 feet along the south line of said NE1/4 to the True Point of Beginning; thence N 38°34' 17" W 685 feet, more or less, to the centerline of Crane Creek; thence southeasterly 1540 feet, more or less, along said creek centerline to the south line of said NE1/4; thence N 89°34'17" W 959 feet, more or less, to beginning.

Containing 7.7 acres, more or less: AND

All that part of the SW1/4 of Section 30, T 108 N, R 20 W, Steele County, Minnesota, described by:

Beginning at the northeast corner of said SW1/4; thence S 0°16' 52" W, assumed bearing, 995.10 feet along the east line of said SW1/4; thence N 64°18'19" W 1958.69 feet; thence N 34°13'32" E 191.43 feet to the north line of said SW1/4; thence S 89°34'17" E 1662.26 feet to beginning.

Containing 23.24 acres, more or less: AND

All those portions of abutting rights-of-way of Interstate 35 and County Road 45 North not included in the previously described parcels and lying within the following described boundary:

Commencing at the southeast corner of the SE 1/4 of Section 29, Township 108 North, Range 20 West, Steele County, Minnesota, thence N 89° 41' 47" W, assumed bearing, 311.27 feet along the south line of said SE 1/4 to a point on the west right-of-way line of CSAH 23; last said point being the True Point of Beginning; thence N 0° 59' 54" W 1,509.54 feet along the westerly right-of-way line of CSAH 23; thence east to the east right-of-way line of County Road 45 North; thence southerly along the east right-of-way of said CR 45N to its intersection with the south line of the North 1/2 of Section 32; thence west along said South line of the N 1/2 of Section 32 to its intersection with the west right-of-way line of CSAH 23; thence northerly along the westerly right-of-way line of CSAH 23 to the True Point of Beginning.

Containing 37.79 acres, more or less.

Total acreage of annexation is 729.12

be and the same hereby is annexed to the City of Owatonna and shall, upon the effective date of this ordinance, become a part of the City of Owatonna as effectively as if it had been originally a part thereof, and the corporate limits of said City of Owatonna are hereby extended to include said land.

SECTION 3. This ordinance is enacted pursuant to the provisions of Minnesota Statutes, Chapter 414, Section 414.033, Subd. 2 (1).

SECTION 4. Upon its adoption, a certified copy of this ordinance shall be filed with each of the following:

Clinton Falls Town Clerk  
Minnesota Municipal Board  
Steele County Auditor  
Minnesota Secretary of State

as provided by law.

SECTION 5. This Ordinance shall take effect upon its passage, publication and approval by the Minnesota Municipal Board.

Passed and adopted this 15th day of October, 1996, with the following vote: Aye 6; No 0; Absent 1.

Approved and signed this 15th day of October, 1996.

  
\_\_\_\_\_  
Mayor

ATTEST:

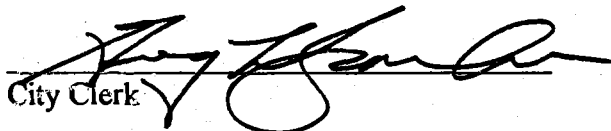
  
\_\_\_\_\_  
City Clerk

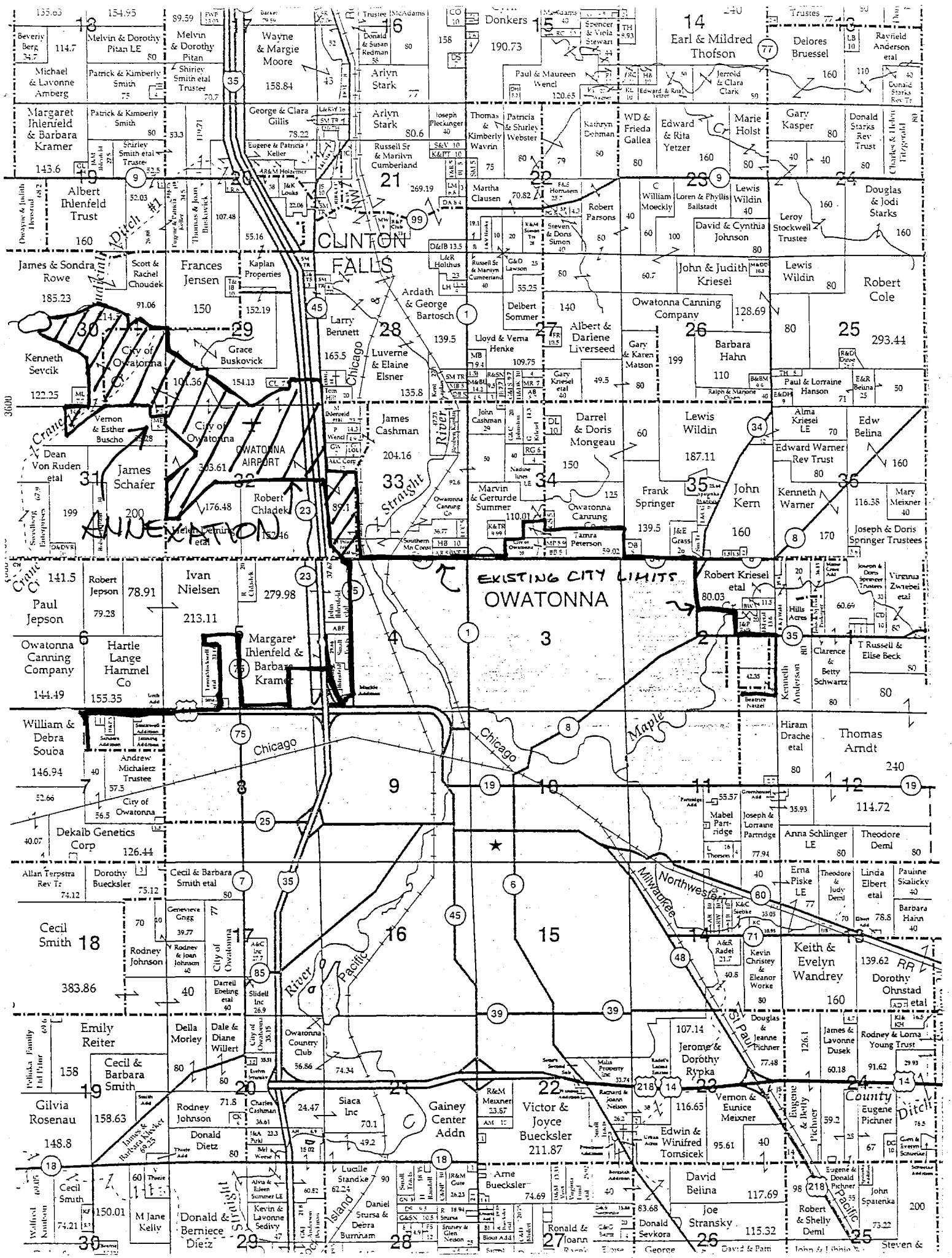

135.63

154.95

59.59

Wayne & Margie Moore

158.84

16

158

190.73

15

14

Earl & Mildred Thofson

140

14

Deiores Bruessel

110

Rayfield Anderson et al

110

Beverly Berg 24.7

Melvin & Dorothy Pitan LE 80

Melvin & Dorothy Pitan

Shirley Smith et al Trustee 70.7

158.84

Arlyn Stark 77

158

190.73

15

Spencer & Viola Stewart 39.3

14

Earl & Mildred Thofson

140

Deiores Bruessel

110

Rayfield Anderson et al

110

Michael & Lavonne Amberg

Patrick & Kimberly Smith 75

Shirley Smith et al Trustee 70.7

158.84

Arlyn Stark 77

158

190.73

15

Paul & Maureen Wend 120.65

14

Earl & Mildred Thofson

140

Deiores Bruessel

110

Rayfield Anderson et al

110

Donald Starks Rev Trust

Margaret Ihlenfeld & Barbara Kramer

Patrick & Kimberly Smith 80

Shirley Smith et al Trustee 70.7

158.84

Arlyn Stark 77

158

190.73

15

Paul & Maureen Wend 120.65

14

Earl & Mildred Thofson

140

Deiores Bruessel

110

Rayfield Anderson et al

110

Donald Starks Rev Trust

143.6

Shirley Smith et al Trustee 52.5

George & Clara Gillis 78.22

Arlyn Stark 80.6

158

190.73

15

120.65

14

Earl & Mildred Thofson

140

Deiores Bruessel

110

Rayfield Anderson et al

110

Donald Starks Rev Trust

110

Albert Ihlenfeld Trust 32.03

Shirley Smith et al Trustee 52.5

George & Clara Gillis 78.22

Arlyn Stark 80.6

158

190.73

15

120.65

14

Earl & Mildred Thofson

140

Deiores Bruessel

110

Rayfield Anderson et al

110

Donald Starks Rev Trust

110

160

Scott & Rachel Choudek 91.06

Francis Jensen 150

Kaplan Properties 152.19

Arlyn Stark 269.19

158

190.73

15

120.65

14

Earl & Mildred Thofson

140

Deiores Bruessel

110

Rayfield Anderson et al

110

Donald Starks Rev Trust

160

Scott & Rachel Choudek 91.06

Francis Jensen 150

Kaplan Properties 152.19

Arlyn Stark 269.19

158

190.73

15

120.65

14

Earl & Mildred Thofson

140

Deiores Bruessel

110

Rayfield Anderson et al

110

Donald Starks Rev Trust

160

Scott & Rachel Choudek 91.06

Francis Jensen 150

Kaplan Properties 152.19

Arlyn Stark 269.19

158

190.73

15

120.65

14

Earl & Mildred Thofson

140

Deiores Bruessel

110

Rayfield Anderson et al

110

Donald Starks Rev Trust

160

Scott & Rachel Choudek 91.06

Francis Jensen 150

Kaplan Properties 152.19

Arlyn Stark 269.19

158

190.73

15

120.65

14

Earl & Mildred Thofson

140

Deiores Bruessel

110

Rayfield Anderson et al

110

Donald Starks Rev Trust

185.23

Scott & Rachel Choudek 91.06

Francis Jensen 150

Kaplan Properties 152.19

Arlyn Stark 269.19

158

190.73

15

120.65

14

Earl & Mildred Thofson

140

Deiores Bruessel

110

Rayfield Anderson et al

110

Donald Starks Rev Trust

147

Scott & Rachel Choudek 91.06

Francis Jensen 150

Kaplan Properties 152.19

Arlyn Stark 269.19

158

190.73

15

120.65

14

Earl & Mildred Thofson

140

Deiores Bruessel

110

Rayfield Anderson et al

110

Donald Starks Rev Trust

147

Scott & Rachel Choudek 91.06

Francis Jensen 150

Kaplan Properties 152.19

Arlyn Stark 269.19

158

190.73

15

120.65

14

Earl & Mildred Thofson

140

Deiores Bruessel

110

Rayfield Anderson et al

110

Donald Starks Rev Trust

147

Scott & Rachel Choudek 91.06

Francis Jensen 150

Kaplan Properties 152.19

Arlyn Stark 269.19

158

190.73

15

120.65

14

Earl & Mildred Thofson

140

Deiores Bruessel

110

Rayfield Anderson et al

110

Donald Starks Rev Trust

147

Scott & Rachel Choudek 91.06

Francis Jensen 150

Kaplan Properties 152.19

Arlyn Stark 269.19

158

190.73

15

120.65

14

Earl & Mildred Thofson

140

Deiores Bruessel

110

Rayfield Anderson et al

110

Donald Starks Rev Trust

147

Scott & Rachel Choudek 91.06

Francis Jensen 150

Kaplan Properties 152.19

Arlyn Stark 269.19

158

190.73

15

120.65

14

Earl & Mildred Thofson

140

Deiores Bruessel

110

Rayfield Anderson et al

110

Donald Starks Rev Trust

147

Scott & Rachel Choudek 91.06

Francis Jensen 150

Kaplan Properties 152.19

Arlyn Stark 269.19

158

190.73

15

120.65

14

Earl & Mildred Thofson

140

Deiores Bruessel

110

Rayfield Anderson et al

110

Donald Starks Rev Trust

147

Scott & Rachel Choudek 91.06

Francis Jensen 150

Kaplan Properties 152.19

Arlyn Stark 269.19

158

190.73

15

120.65

14

Earl & Mildred Thofson

140

Deiores Bruessel

110

Rayfield Anderson et al

110

Donald Starks Rev Trust

147

Scott & Rachel Choudek 91.06

Francis Jensen 150

Kaplan Properties 152.19

Arlyn Stark 269.19

158

&lt;

# CLINTON FALLS & MEDFORD



RECD. BY  
M M R

OCT 23 1996

T.108N. - R.20W.

Rice County

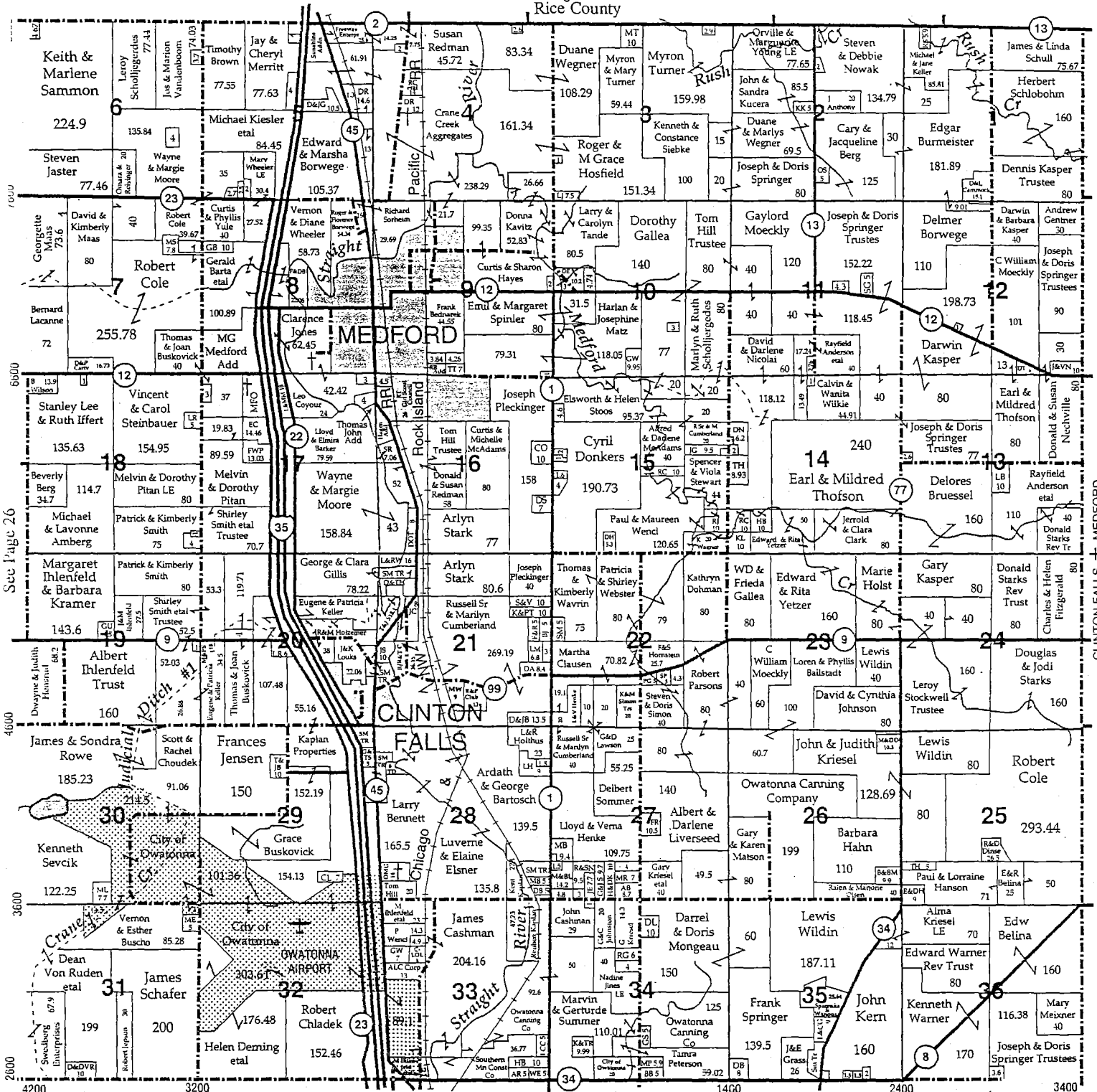

See Page 26

See Page 30

CLINTON FALLS + MEDFORD

See Page 30

See Page 22

