

Councilmember Olson introduced the following ordinance and moved for its adoption:

ORDINANCE NO. 1996-1

AN ORDINANCE EXTENDING THE CORPORATE LIMITS OF THE CITY OF MCKINLEY TO INCLUDE CERTAIN LAND OWNED BY THE CITY OF MCKINLEY AND ABUTTING THE CITY OF MCKINLEY

WHEREAS, the City of McKinley owns the following described property which abuts the corporate limits of the City of McKinley:

Southwest Quarter [SW $\frac{1}{4}$] of the Northeast Quarter [NE $\frac{1}{4}$];
Southeast Quarter [SE $\frac{1}{4}$] of the Northeast Quarter [NE $\frac{1}{4}$];
Northwest Quarter [NW $\frac{1}{4}$] of the Southeast Quarter [SE $\frac{1}{4}$];
Northeast Quarter [NE $\frac{1}{4}$] of the Southeast Quarter [SE $\frac{1}{4}$]

all in Section 17, Township 58 North, Range 16 West of the 4th P.M.

WHEREAS, it is the desire of the City of McKinley to annex said abutting land to the corporate limits of the City.

NOW, THEREFORE, the City Council of McKinley, Minnesota does hereby ordain:

Section 1. The City Council hereby determines and finds that the property is unincorporated, it abuts the municipality and is owned by the City of McKinley. The City may annex said land by ordinance under the terms of Minn. Stat. §414.033 subd. 2(1). The property is not included in any area that has already been designated for orderly annexation pursuant to Minn. Stat. §414.0325.

Section 2. The land is urban in nature or about to become so.

Section 3. The corporate limits of the City of McKinley are hereby extended to include said property and the same is hereby annexed to and included within the City of McKinley as if the property had originally been part thereof.

Section 4. The City Clerk is directed to file certified copies of this ordinance with the Minnesota Municipal Board, Biwabik Township, the St. Louis County Auditor and the Minnesota Secretary of State.

Section 5. This ordinance takes effect upon its passage and publication and the filing of the certified copies as directed in Section 4 and approval of the Ordinance by the Minnesota Municipal Board.

I hereby certify that this document is a true and exact copy of the original.

By: Trina Olson
Trina Olson, Clerk

STATE OF MINNESOTA)
)ss
COUNTY OF ST. LOUIS)

Eileen Rioux, being duly sworn, on oath says that he/she is the publisher or authorized agent and employee of the publisher of the newspaper known as Mesabi Daily News, and has full knowledge of the facts which are stated below:

(A) The newspaper has complied with all of the requirements constituting qualification as a qualified newspaper, as provided by Minnesota Statute 331A.02, 331A.07, and other applicable laws, as amended.

(B) The printed Trenti Law Firm, RE: City of McKinley

which is attached was cut from the columns of said newspaper, and was printed and published one time; it was published on Fri, the 7th day of June, 19 96 and printed below is a copy of the lower case alphabet from A to Z, both inclusive, which is hereby acknowledged as being the size and kind of type used in the composition and publication of the notice.

* abcdefghijklmnopqrstuvwxyz

BY: Eileen Rioux

Victoria L. Juntunen
Subscribed and sworn to before me on
this 7th day of June, 19 96
Notary Public

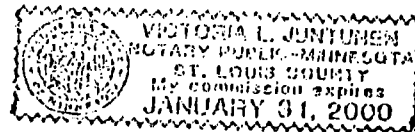

* ALPHABET SHOULD BE IN THE

FRIDAY, JUNE 7, 1996/MESABI DAILY NEWS/ **B9**

THE CITY OF MCKINLEY AND ABUTTING
THE CITY OF MCKINLEY

Pursuant to the terms of Minn. Stat. §414.033, subd. 2(a), the City of McKinley has passed this ordinance to extend the corporate limits of the City of McKinley to include by annexation the following described properties:

- a. Southwest Quarter of Northeast Quarter (SW 1/4 of NE 1/4);
- b. Southeast Quarter of Northeast Quarter (SE 1/4 of NE 1/4);
- c. Northwest Quarter of Southeast Quarter (NW 1/4 of SE 1/4);
- d. Northeast Quarter of Southeast Quarter (NE 1/4 of SE 1/4);

NOTICE: A printed copy of the Ordinance in its entirety is available for inspection during regular office hours at the office of the City Clerk and is also posted in the City Library. (MDN 6-7, 1996)

(1) Lowest classified rate paid by
SUMMARY OF ORDINANCE NO. 1996-1
AN ORDINANCE EXTENDING THE
CORPORATE LIMITS OF THE CITY OF MCKINLEY TO INCLUDE CERTAIN LAND OWNED BY

(2) Maximum rate allowed by law for the above matter

(3) Rate actually charged for the above matter

\$ 9.93/inch
(Line, word, or inch rate)

\$ 9.31/inch
(Line, word, or inch rate)

BIWABIK

T. 58 N.-R.16 W.

REC'D. BY MAIL NOV 19 1996

SEE PAGE 70

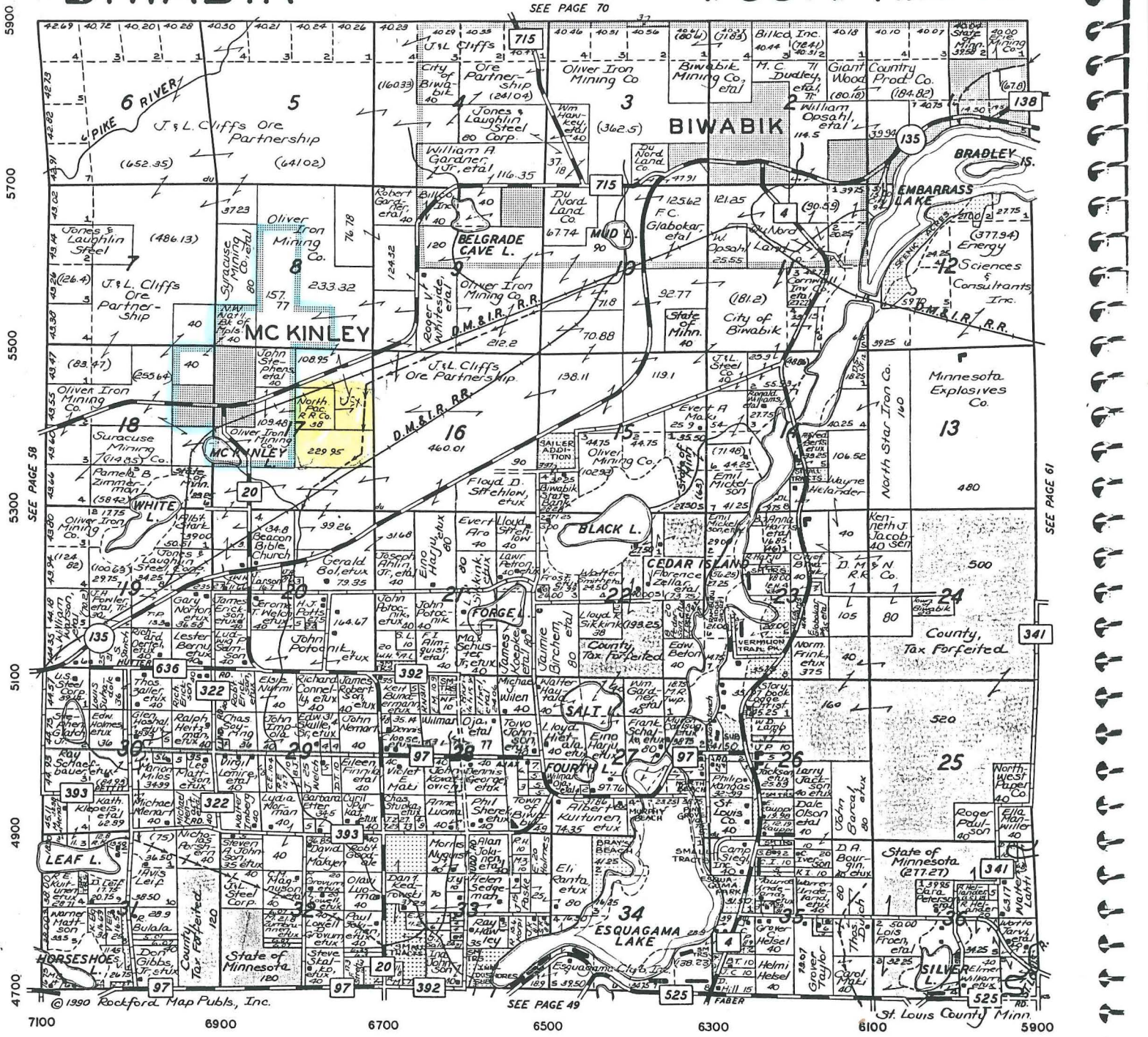

5900
5700
5500
5300
5100
4900
4700

7100 6900 6700 6500 6300 6100 5900

© 1990 Rockford Map Publs, Inc.

SEE PAGE 49

SEE PAGE 61