

RECD BY OCT 02 1996  
JMP

IN THE MATTER OF THE PETITION OF MARILYN BURDA  
AND DARWIN BURDA FOR ANNEXATION OF CERTAIN  
UNINCORPORATED TERRITORY TO THE CITY OF SLEEPY EYE

We, the undersigned, being all of the owners of the territory described below, hereby request the City to annex this territory to the City and to extend the City boundary to include the same, and for that purpose, respectfully state:

1. The territory to be annexed consists entirely of unplatted lands being less than 200 acres and being situated in Home Township, Brown County, Minnesota, more particularly described as follows, viz:

NE $\frac{1}{4}$  of SE $\frac{1}{4}$ , Section 29, Township 110N, Range 32W  
excepting therefrom Lots A and B.

NW $\frac{1}{4}$  of SE $\frac{1}{4}$ , and that part of the balance of Lot M-4 of M-2 of the SW $\frac{1}{4}$  of SE $\frac{1}{4}$ , Section 29, which lies North of the Chicago and Northwestern railway tracks and excepting Outlot A, Kroschel's Subdivision in the NW $\frac{1}{4}$  of SE $\frac{1}{4}$ , Section 29, and excepting that part of the W $\frac{1}{2}$  of SE $\frac{1}{4}$  described as follows: Beginning at the Southwest corner of Outlot A of Kroschel's Subdivision in the Northwest Quarter of said Southeast Quarter of Section 29; then South 89 degrees 58 minutes 48 seconds East, an assumed bearing, along the south line of said Outlot A and the easterly prolongation of said south line 470.00 feet; then South 00 degrees 08 minutes 36 seconds East parallel with the west line of said Southeast Quarter 1385.43 feet to the northerly right-of-way line of the Dakota Minnesota and Eastern Railroad; then South 78 degrees 03 minutes 46 seconds West 480.13 feet to the said west line of the Southeast Quarter of Section 29; then North 00 degrees 08 minutes 36 seconds West along said west line 1484.90 feet to the point of beginning containing 15.5 acres, more or less and being subject to easements of record in said county and state, ALL being in Township 110N, Range 32W.

SE $\frac{1}{4}$  of SE $\frac{1}{4}$ , Section 29, Township 110N, Range 32W, excepting therefrom Lots A & B and excepting .80 acres sold to the Village of Sleepy Eye Lake and 3.35 acres sold to the State of Minnesota, and excepting Seven Gables Addition in the SE $\frac{1}{4}$  of SE $\frac{1}{4}$ , Section 29, Township 110N, Range 32W.

2. The territory described above abuts upon the City limits and none of it is presently included within the corporate limits of

REC'D. BY  
MMB OCT 02 1996

any incorporated city.

3. All of this territory is or is about to become urban or suburban in character.

Dated: 9-25, 1996

Marilyn Burda  
Marilyn Burda

Darwin Burda  
Darwin Burda

STATE OF ALASKA )  
                                  ) ss:  
COUNTY OF \_\_\_\_\_ )

The foregoing was acknowledged before me this 25 day of September, 1996, before me, a notary public, within and for said County and State, personally appeared MARILYN BURDA AND DARWIN BURDA, wife and husband, to me known to be the same persons described in and who executed the foregoing instrument, and acknowledged that they executed the same as their free act and deed.

Teresa Wesley  
Notary Public

State of Alaska  
NOTARY PUBLIC  
Teresa J. Wesley  
My Commission Expires 1-30-97.

REC'D. BY OCT 11 1996  
MMR

● DENOTES MON FOUND

○ DENOTES MON SET  
WITH REG. No. 19791



SCALE 1" = 100'

BALANCE  
LOT M-4 or M-2  
SW 1/4 or SE 1/4

BALANCE

EYE

N 89° 54' 45" E - 340.00'

CEDAR STREET NE

300.00

SE 1/4

0.72 ACRES

LOT 1

BLOCK 1

3.10 ACRES

*Seven Gables Addition*

DEDICATED STREET

S 00° 26' 39" E - 490.00'

R.O.W. LINE

300.00

S 89° 54' 45" W - 340.00

N 00° 26' 39" W - 490.00'

450.00

450.00

40.00

S 89° 54' 45" W - 1332.32'

U.S. No. 14

LOT M-6  
LOT M-1

M-5  
OF  
M-1



- EXISTING MANHOLE
- | — EXISTING WATERMAIN
- ← — EXISTING SANITARY SEWER
- PROPOSED MANHOLE
- ⊗ PROPOSED CATCH BASIN
- | — PROPOSED WATERMAIN
- ← — PROPOSED SANITARY SEWER
- PROPOSED STORM SEWER

REC'D. BY  
MMR OCT 11 1996

1" = 200'  
MARCH 1994

D M & E RAILROAD

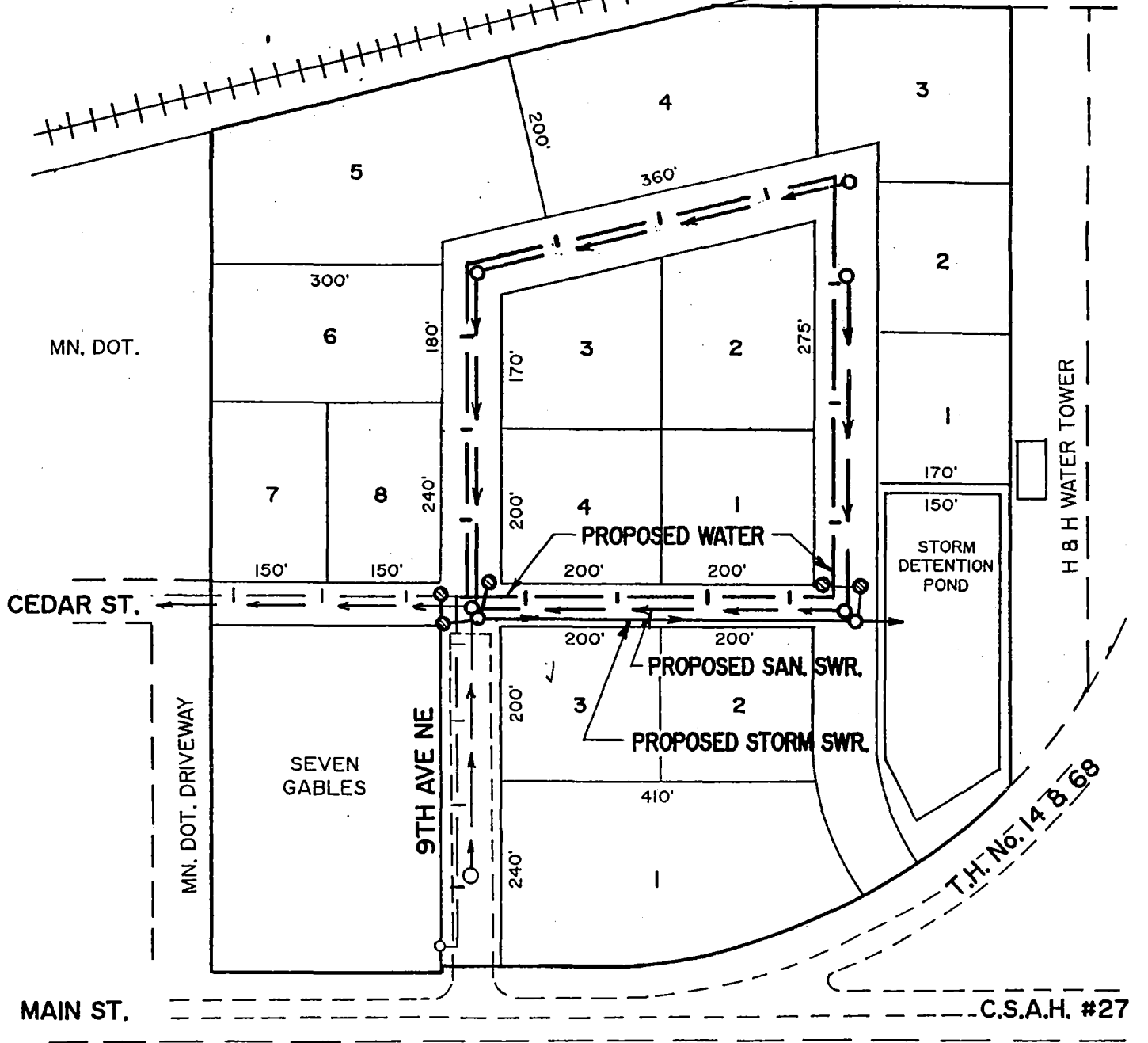

**PROPOSED DEVELOPMENT PLAN  
BURDA COMMERCIAL PROPERTY**



**BOLTON & MENK, INC.**  
ENGINEERS  
SLEEPY EYE, MINNESOTA

RECORDED BY  
M.M.D. OCT 11 1996

HOME CEMETERY

ST. MARYS ST. NE

O.L. A  
KROSCHER'S SUBDIVISION  
NW 1/4 - SE 1/4  
29 - 110 - 32

S 89° 58' 48" E  
470.00

PT. OF BEG.

KIEFERS  
THIRD ADD.

SLEEPY EYE CITY LIMITS &  
WEST LINE SE 1/4 29 - 110 - 32

PART  
W 1/2 - SE 1/4  
29 - 110 - 32  
15.5 ACRES

N 00° 08' 36" W  
1484.90

S 00° 08' 36" E - 1385.43

EMMERICH ST. NE

KIEFERS FIRST  
ADDITION

6TH AVE. NE

ELM ST. NE

KIEFERS  
FOURTH ADD.



SCALE 1" = 200'

● DENOTES IRON  
PIPE MONUMENT  
R.O.W. DENOTES  
RIGHT - OF - WAY

480.13

S 78° 03' 46" W

DM & E R.R.

R.R. R.O.W. LINE

50  
50

R.R. R.O.W. LINE



# MAP OF HOME

REC'D. BY  
MMR OCT 02 1996

TOWNSHIP: 110 N.

RANGE: 32 W

CODE: HO

NORTH PART OF HOME

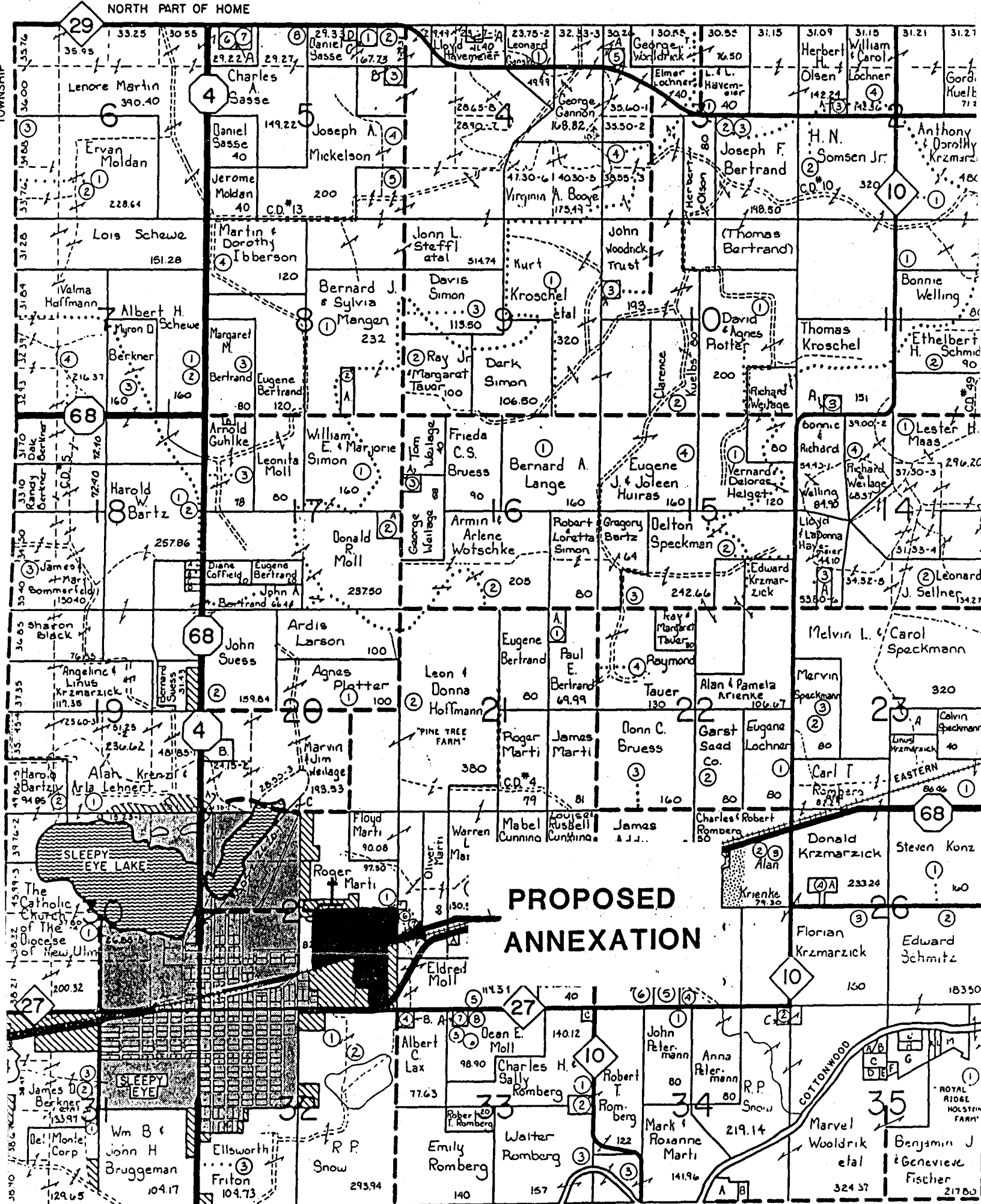

STARK

SEE SMALL TRACT OWNERS FOLLOWING TOWNSHIP MAPS