

CITY OF BARNUM

Gateway to the Northwoods

ORDINANCE NO. 95

AN ORDINANCE ANNEXING PROPERTY

The City Council of the City of Barnum, Minnesota, ordains that the property described as:

All that part of the South Half of the Southwest Quarter (S ½ of SW 1/4) lying north and west of Interstate Highway No. 35, all in Section Thirty-one (31), Township Forty-seven (47), North of Range Eighteen (18), West of the Fourth Principal Meridian, EXCEPT that part thereof lying Southerly (S'ly) from County State Aid Highway No. 6;

shall be annexed to the City of Barnum. The above-described property is located adjacent to the City of Barnum in the Township of Barnum, is owned by the City of Barnum and consists of 22.7 acres. That this annexation is allowed pursuant to Minn. Stat. Sec. 414.033, Subd. 2(1).

Passed by the Barnum City Council this 23rd day of October, 1995.

This Ordinance shall be in effect from and after its passage and publication according to law.

[City Seal]



Mayor David M. Johnson

ATTEST:



Clerk Pamela Porter



See Skelton Page 46

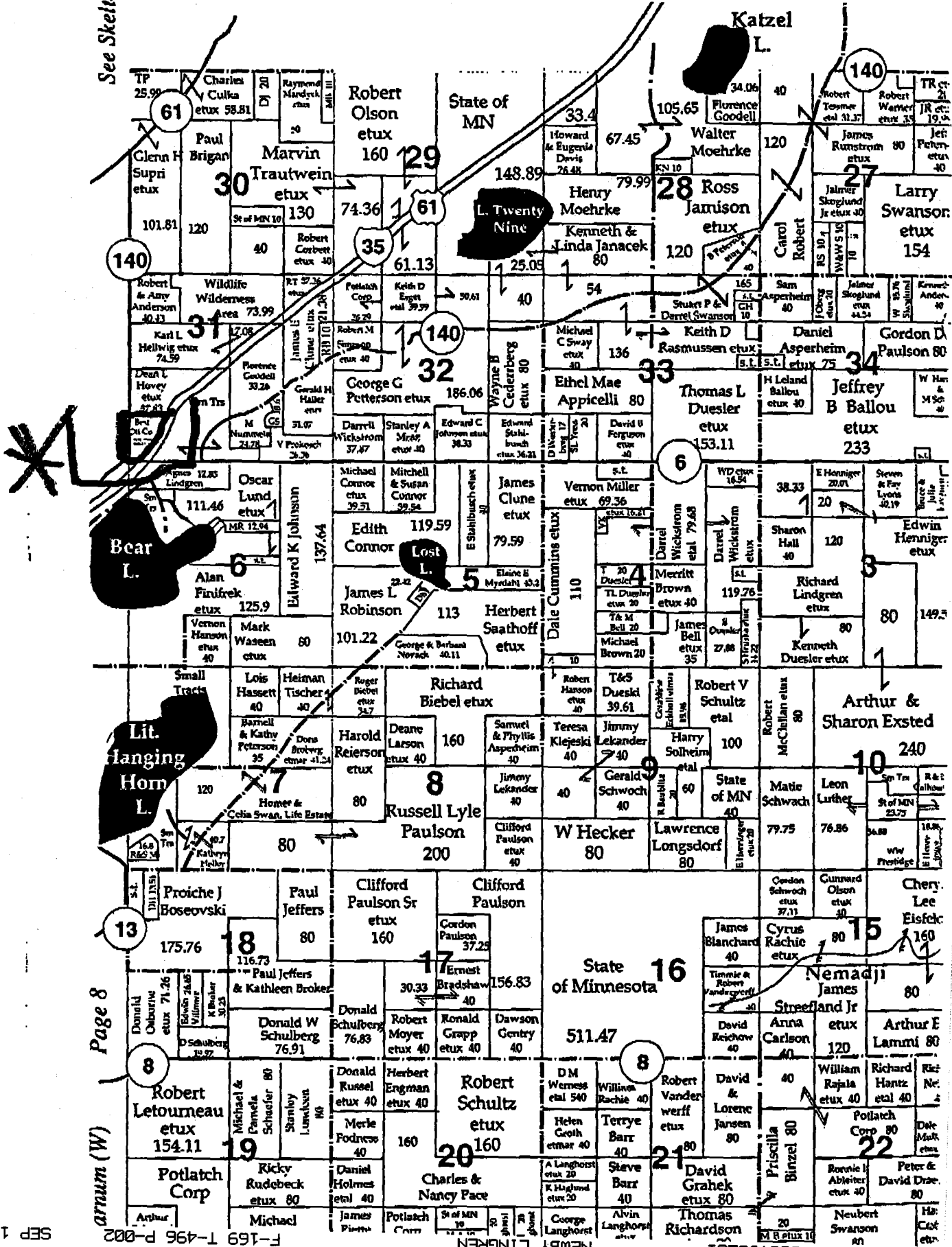

Page 8

annum (W)