

ORDINANCE NO. 3049

REC'D. BY
M.M.R. JUL 17 1996

AN ORDINANCE ANNEXING TO THE CITY OF ROCHESTER APPROXIMATELY 19.89 ACRES OF LAND LOCATED IN THE WEST HALF OF THE NORTHWEST QUARTER OF THE NORTHWEST QUARTER OF SECTION 17, TOWNSHIP 107 NORTH, RANGE 14 WEST, OLMSTED COUNTY, MINNESOTA.

THE COMMON COUNCIL OF THE CITY OF ROCHESTER DO ORDAIN:

Section 1. A petition has been filed with the Common Council of the City of Rochester, signed by the owners of land described herein, requesting the Common Council to annex said land to the City of Rochester. The land described in said petition for annexation is located in Cascade Township, Olmsted County, Minnesota, and is described as follows:

The West One-Half of the Northwest Quarter of the Northwest Quarter of Section 17, Township 107 North, Range 14 West, Olmsted County, Minnesota.

Containing 19.89 acres, more or less.

Section 2. The total quantity of land included in said petition is approximately 19.89 acres in size.

Section 3. On June 17, 1996, the Common Council held a public hearing to consider this annexation petition after providing written notice of the hearing, by registered mail, to the property owner, the Cascade Township officers, and the adjacent property owners.

Section 4. Following the public hearing, the Common Council of the City of Rochester determined that the land abuts the municipal limits, is less than 60 acres in area, the annexation petition is signed by all property owners of the land described in Section 1, and the land is or will soon become urban or suburban in character.

Section 5. Therefore, pursuant to Minn. Stat. §414.033, subd. 2(3), the land described in Section 1 above is hereby annexed, added to and made a part of the City of Rochester, Minnesota, as effectually as if it had originally been a part thereof.

Section 6. Present and future owners of the lands annexed by this ordinance are hereby notified that in addition to the usual assessments, it is the intention of the Common Council to assess against benefitted property all or a portion of the cost of any storm sewer, water tower, pumping station, and trunk line sanitary sewer construction, heretofore or hereafter undertaken to serve the area annexed.

Section 7. This ordinance shall take effect and be in force from and after its official publication and from and after the filing of a certified copy hereof with the Minnesota Municipal Board, the Cascade Town Clerk, the County Auditor, and the Secretary of State.

PASSED AND ADOPTED BY THE COMMON COUNCIL OF THE CITY OF
ROCHESTER, MINNESOTA, THIS 15th DAY OF JULY, 1996.

John H. Hanger
PRESIDENT OF SAID COMMON COUNCIL

ATTEST: Dicky Kay Stewart
CITY CLERK

APPROVED THIS 16th DAY OF JULY, 1996.

Tom Confield
MAYOR OF SAID CITY

(Seal of the City of
Rochester, Minnesota)

Location Map

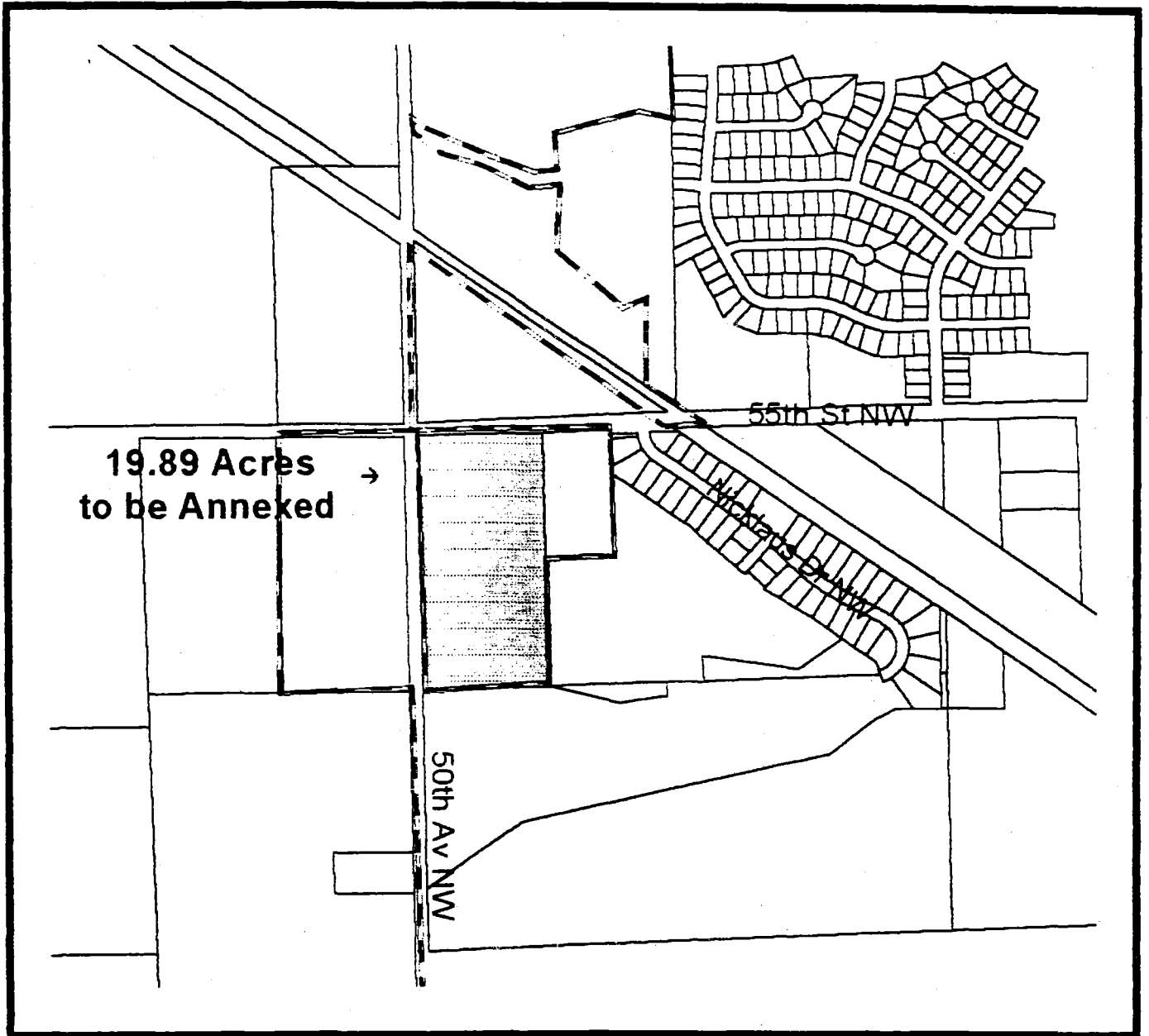

19.89 Acres →
to be Annexed

55th St NW

Nichols Dr NW

50th Av NW

 City Limits
 Property



1:800