

REC'D. BY
M M R JUL 15 1996

IN THE MATTER OF THE PETITION

of

NORTHSHORE MINING COMPANY

For ANNEXATION

PURSUANT TO MINNESOTA STATUTES 414.033, SUBD. 5

TO: Council of the City of Silver Bay, Minnesota

and

Minnesota Municipal Board

475 McColl Building

366 Jackson Street

St. Paul, MN 55101-1925

PETITIONERS STATE: The property owner or a majority of the property owners in number are required to commence a proceeding under M.S.A. § 414.033, Subd. 5.

It is hereby requested by: **Northshore Mining Company**, the sole property owner of the area proposed for annexation to annex certain property described herein lying in the **Town of Beaver Bay** to the **City of Silver Bay**, County of Lake, Minnesota.

The area proposed for annexation is described as follows:

Government Lot One (1), Section Seven (7), Township Fifty-five (55) North, Range Seven (7) West of the Fourth Principal Meridian.

AND

Part of Government Lot Two (2), Section Seven (7), Township Fifty-five (55) North, Range Seven (7) West of the Fourth Principal Meridian, described as follows: Commencing at the Northwest corner of Section (7), Township Fifty-five (55) North, Range Seven (7) West of the Fourth Principal Meridian, Lake County Minnesota, thence southerly along the range line between Ranges Seven and Eight West a distance of 855.55 feet more or less to the intersection of the center line of Highway 61 as located November 25, 1947, and the Range line between Ranges Seven and Eight, thence turn to the left $128^{\circ} 43'$ and go for a distance of 276.22', thence turn to the right $90^{\circ} 00'$ along a line (hereinafter called line "A") and go for a distance of 250', which point is the point of beginning, thence along a projection of line "A" for a distance of 884.49', thence turn to the right $39^{\circ} 38'$ and go to the shore of Lake Superior, thence go along the shore of Lake Superior, thence go along the shore of Lake Superior in an easterly direction to the intersection of the east line of Lot 2 and the shore of Lake Superior, thence Northerly along the east line of Lot 2 to the northeast corner thereof, thence westerly along the north line of Lot 2 to a point where the north line of Lot 2 intersects the center line of Highway 61 as located November 25, 1947, thence along the center line of Highway 61 to a point, which when measured along the center line of Highway 61, as located November 25, 1947 is 426.22' from the range line between Ranges 7 West and 8 West, thence southeasterly along a line parallel to line "A" previously described a distance of 150' to a point, thence southwesterly to point of beginning.

All that part of Government Lot Two (2) of Section Seven (7) in Township Fifty-five (55) North, Range Seven (7) West of the Fourth Principal Meridian, lying North of the center line of Highway No. 61 described as follows:

Commencing at the Northwest corner of Section 7, Township 55 North, Range 7 West of the Fourth Principal Meridian, Lake County, Minnesota, the point of beginning, thence Southerly along the range line between Range 7 and 8 West a distance of 855.55 feet more or less to the intersection of the center line of Highway No. 61 as located November 25, 1947, and the range line between Ranges 7 and 8, thence Northeasterly along the center line of said Highway to the intersection of said center line with the North line of Section 7, thence Westerly along said North line to the point of beginning. Including that portion of Highway No. 61 lying within said Government Lots One (1) and Two (2).

1. There is one property owner, the Petitioner, **North Shore Mining Company**, in the area proposed for annexation.
2. All property owners have signed this petition.
3. The population of the annexation area is zero.
4. Said property is unincorporated, abuts on the City's West boundary, and is not included within any other municipality.
5. The area of land to be annexed, in acres, is:

Unplatted 55.86 Total 55.86

Commercial area

6. The reason for the requested annexation is: The City of Silver Bay, through lease with the property owner, intends to improve and develop the area for a planned Harbor of Refuge and Small Boat Landing.
7. All of the annexation area is or is about to become urban or suburban in character.
8. The area proposed for annexation is not included in any area that has already been designated for orderly annexation pursuant to M.S.A. § 414.0325.

PETITIONERS REQUEST: That pursuant to M.S.A. § 414.033, the property described herein be annexed to and included within the **City of Silver Bay, Minnesota**.

Dated: 7/11/96

NORTHSHORE MINING COMPANY

[Signature]
President

REC'D. BY JUL 15 1996
M M R

SILVER BAY CITY LIMITS

8.09 AC.

GOV

US HWY 67

LOT

GOV

7360

.48 AC.

7350

.23 AC.

7310

3.00 AC.

24.67 AC.

23.10 AC.

LOT

7330

.67 AC.

2

7320

9.94 AC.

60'

7340

.17 AC.

1 21.10'

WIELAND ISLAND

250'

7370

.56 AC.

850'

540'

ANNEXATION AREA SHOWING ACREAGE

EXHIBIT "C"

ANNEXATION AREA

SW 1/4 - SW 1/4

GOV. LOT 4

1 6
12 7

HWY. 61 R/W LINE 7

WEST BREAKWATER

SILVER BAY VILLAGE LIMITS

LAKE SUPERIOR

GOV. LOT 2

GOV. LOT 1

Point of Beginning

NORTH

Scale: 1" = 300'

R 8 W
R 7 W

855.55'

426.22'

276.22'

128.43'

150.55'

641.88'

185.00'

RECORDED BY JUL 15 1996
M M R

EXHIBIT "B"

CITY OF SILVER BAY

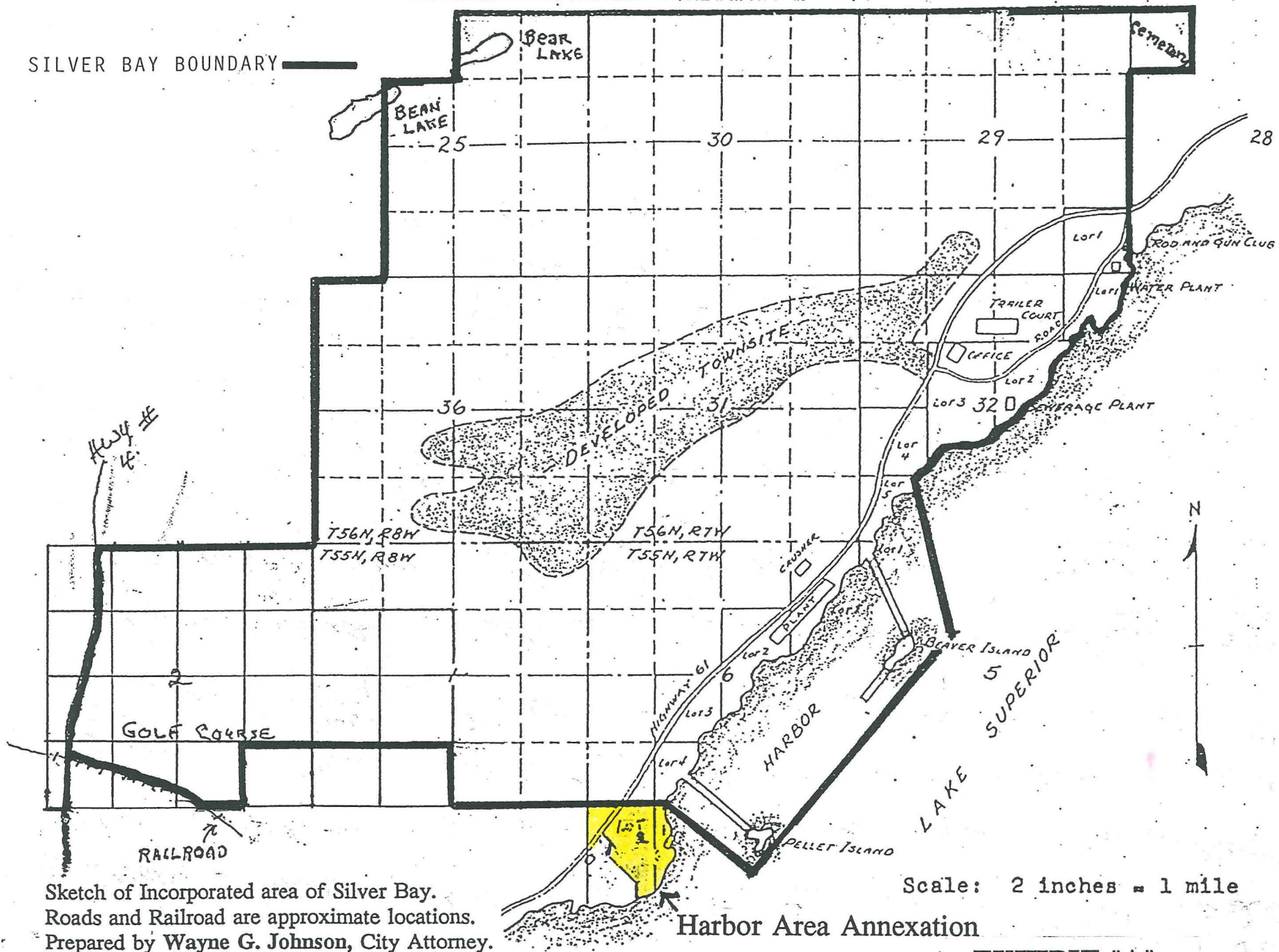

Sketch of Incorporated area of Silver Bay.
 Roads and Railroad are approximate locations.
 Prepared by Wayne G. Johnson, City Attorney.

Scale: 2 inches = 1 mile

Harbor Area Annexation

EXHIBIT "A"

RECD. BY
 MAIL
 JUL 15 1996