

**ORDINANCE NO. 97, 2ND SERIES**

(Uncodified)

AN ORDINANCE EXTENDING THE CORPORATE LIMITS OF THE CITY OF ROSEAU, MINNESOTA, TO INCLUDE CERTAIN UNINCORPORATED PLATTED LAND (UNPLATTED LAND NOT EXCEEDING 200 ACRES IN AREA) ABUTTING UPON THE CITY LIMITS.

WHEREAS, a certain petition dated June 26, 1996, requesting annexation of the territory hereinafter described was duly presented to the council on the 1st day of July, 1996; and

WHEREAS, the petition was signed by 8 owners, constituting a majority, but not all, of a total number of 9 owners; and

WHEREAS, no objections to the annexation have been received from the town board, or the government body of any municipality whose boundaries abut upon the boundaries of the land to be annexed; and

WHEREAS, on July 9, 1996, a Resolution of Waiver of Objection to said Annexation was signed by the Town Clerk and the Town Chairperson of Jadis Township, and

WHEREAS, a hearing was duly held on the 5th day of August, 1996, at 6:00 PM, by the governing body of the City of Roseau, Minnesota, on the proposed annexation after at least 30 days mailed notice; and

WHEREAS, the land described in the petition abuts upon the city limits at the easterly and northerly boundaries thereof.

The council of the City of Roseau, Minnesota, ordains:

**SECTION 1. COUNCIL FINDINGS.** The City Council hereby determines that the territory described herein abuts upon the city limits and is or is about to become urban or suburban in character; and that none of the territory is now included within the limits of any city.

**SECTION 2. POPULATION.** The population of the territory is (four) 4.

**SECTION 3. TERRITORY ANNEXED.** The corporate limits of the city are hereby extended to include the platted land, or if unplatted, does not exceed 200 acres in area, described herein and the same is hereby annexed to and included within the city as effectually as if it had originally been a part thereof:

Part of the Northwest Quarter of the Southeast Quarter (NW $\frac{1}{4}$  SE $\frac{1}{4}$ ) of Section Thirteen (13), in Township One Hundred Sixty-two (162) North, Range Forty (40) West, described as follows, to-wit:

Commencing at the Northwest corner of Lot Three (3) of Block One (1) in Row's Addition to the City of Roseau, according to the recorded Plat thereof; thence North, parallel with the West line of the NW $\frac{1}{4}$  SE $\frac{1}{4}$  of Section 13, Township 162 North, Range 40 West, a distance of 165 feet; thence East, parallel with the South line of said NW $\frac{1}{4}$  SE $\frac{1}{4}$ , a distance of 150 feet; thence South, parallel with the West line of said NW $\frac{1}{4}$  SE $\frac{1}{4}$ , a distance of 165 feet to the North line of Lot Four (4) of Block One (1) in said

Row's Addition to the City of Roseau; thence West, on and along the North line of said Row's Addition to the City of Roseau, a distance of 150 feet, to the point of beginning.

(Terrance H. Taylor and Terry E. Taylor -.56 acres, more or less)

**AND**

Beginning at the Southeast corner of the Northwest Quarter of the Southeast Quarter (NW $\frac{1}{4}$  SE $\frac{1}{4}$ ) of Section Thirteen (13), Township One Hundred Sixty-two (162) North, Range Forty (40) West; thence West on and along the South line of said NW $\frac{1}{4}$  SE $\frac{1}{4}$  a distance of 791.44 feet; thence North, parallel with the East line of said NW $\frac{1}{4}$  SE $\frac{1}{4}$ , a distance of 330.00 feet to the point of beginning of the tract of land intended to be described; thence West, parallel with the South line of said NW $\frac{1}{4}$  SE $\frac{1}{4}$ , a distance of 271.61 feet; thence North, parallel with the East line of said NW $\frac{1}{4}$  SE $\frac{1}{4}$ , a distance of 165.00 feet; thence East, parallel with the South line of said NW $\frac{1}{4}$  SE $\frac{1}{4}$ , a distance of 88.61 feet; thence South, parallel with the East line of said NW $\frac{1}{4}$  SE $\frac{1}{4}$ , a distance of 15.00 feet; thence East parallel with the South line of said NW $\frac{1}{4}$  SE $\frac{1}{4}$ , a distance of 183.00 feet; thence South, parallel with the East line of said NW $\frac{1}{4}$  SE $\frac{1}{4}$ , a distance of 150.00 feet to the point of beginning.

(Shirley Staples, f/k/a Shirley Grahn - .94 acres, more or less)

**AND**

Lot Four (4) of Block One (1), in Halverson's First Subdivision, part of the NW $\frac{1}{4}$  SE $\frac{1}{4}$  of Sec. 13, in Twp. 162 N., Range 40 W., according to the Plat thereof on file and of record in the Office of the County Recorder of Roseau County, Minnesota.

(Steven R. Fredrickson - .67 acres, more or less)

**AND**

Lot Two (2) of Block Two (2) in Halverson's First Subdivision, part of the NW $\frac{1}{4}$  SE $\frac{1}{4}$  of Section 13 in Township 162 North, Range 40 West, according to the Plat thereof on file and of

record in the office of the County Recorder of Roseau County, Minnesota.

(Clayton G. Erickson and Ruth V. Erickson - .66 acres, more or less)

**AND**

Lot One (1) of Block Two (2), in Halverson's First Subdivision, part of the NW $\frac{1}{4}$  SE $\frac{1}{4}$  of Sec. 13, in Twp. 162 N., Range 40 W., according to the Plat thereof on file and of record in the Office of the County Recorder of Roseau County, Minnesota.

(Walter Hellquist and Marjorie Hellquist - 1.01 acres, more or less)

**AND**

Outlot "A" of Halverson's First Subdivision, part of the Northwest Quarter of the Southeast Quarter (NW $\frac{1}{4}$  SE $\frac{1}{4}$ ), of Section Thirteen (13); and a tract of land described as follows: Commencing at the Southeast corner of the NW $\frac{1}{4}$  SE $\frac{1}{4}$  of Section 13; thence West, on and along the South line of said NW $\frac{1}{4}$  SE $\frac{1}{4}$ , a distance of 791.44 feet; thence North, parallel with the East line of said NW $\frac{1}{4}$  SE $\frac{1}{4}$ , a distance of 280 feet to a point which is designated as the point of beginning of the tract of land hereby intended to be described; from this point of beginning East parallel with the South line of said NW $\frac{1}{4}$  SE $\frac{1}{4}$  a distance of 183 feet; thence North, parallel with the East line of said NW $\frac{1}{4}$  SE $\frac{1}{4}$ , a distance of 200 feet; thence West, parallel with the South line of said NW $\frac{1}{4}$  SE $\frac{1}{4}$ , a distance of 183 feet; thence South, a distance of 200 feet to the point of beginning, being a part of the NW $\frac{1}{4}$  SE $\frac{1}{4}$  of said Section 13, ALL in Township One Hundred Sixty-two (162) North, of Range Forty (40) West of the Fifth Principal Meridian in Minnesota, according to the United States Government Survey thereof; subject to easements of record concerning the West 33 feet of the above described premises.

(Rebecca L. Warne - 1.26 acres, more or less)

**SECTION 4. FILING.** The City Clerk is hereby directed to file certified copies of this Ordinance with the Minnesota Municipal Board, the Secretary of State, the Jadis Town Clerk and the Roseau County Auditor.

**SECTION 5. EFFECTIVE DATE.** This Ordinance takes effect upon its passage and publication and the filing of the certified copies as directed in Section 4, and approval of the Ordinance by the Minnesota Municipal Board.

Adopted by the City Council of the City of Roseau, Minnesota, this 5th day of August, 1996.

\_\_\_\_\_  
Mayor

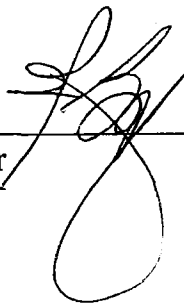

ATTEST:

\_\_\_\_\_  
City Clerk

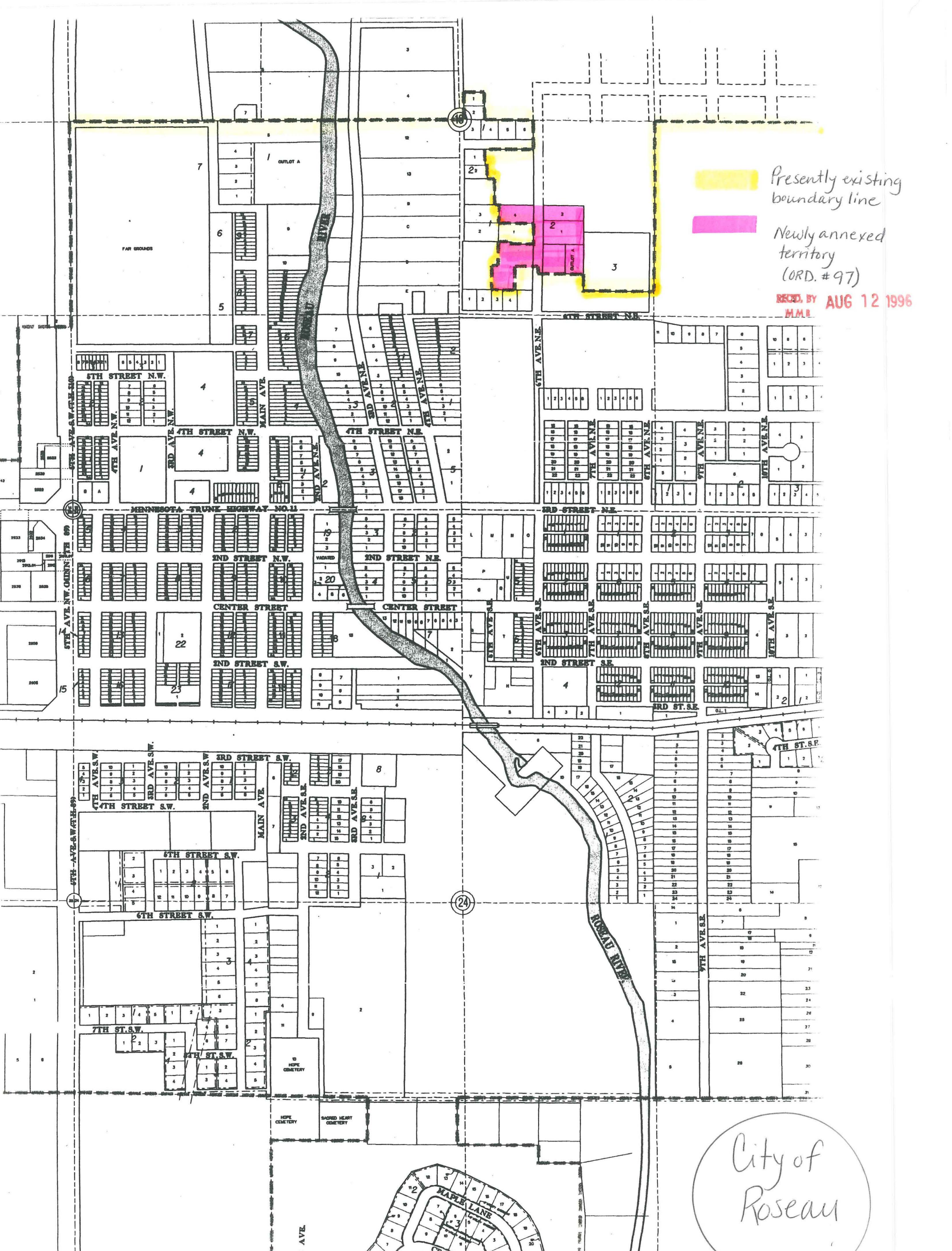

Presently existing boundary line

Newly annexed territory (ORD. #97)

RECD. BY AUG 12 1996  
M.M.E.

City of  
Roseau