

ORDINANCE NO. LC121096

An Ordinance extending the Corporate Limits of the City of Le Center to include certain unincorporated land abutting upon the City Limits.

WHEREAS, a certain petition dated April 15, 1996, requested annexation of the territory hereinafter described was duly presented to the Council on the 24th day of April, 1996; and

WHEREAS, the petition was signed by all owners of said territory; and

WHEREAS, no objections to the annexation have been received by the Town Board, or the government body of any municipality whose boundaries abut upon the boundaries of the land to be annexed; and

WHEREAS, the land described in the Petition abuts the City Limits of the Northerly and Westerly boundaries thereof.

NOW, THEREFORE, the Council of the City of Le Center, ordains:

1. The City Council hereby determines that the territory described herein abuts upon the City Limits and is, or is about to become, urban or suburban in character and that none of the territory is now included within the limits of any city.
2. The population of the territory is zero (0).
3. The corporate limits of the City are hereby extended to include the lands described on attached "Exhibit A" and the same is hereby annexed to and included within the City as effectually as if it had originally been a part thereof.
4. The City Clerk is hereby directed to file certified copies of this Ordinance with the Municipal Board, the Secretary of

State, the Town Clerk, the County Auditor, and the County Recorder.

5. This Ordinance takes effect upon its passage and publication and the filing of the certified copies as directed in paragraph 4, and approval of the Ordinance by the Minnesota Municipal Board.

Adopted by the council this 10th day of December,
1996.

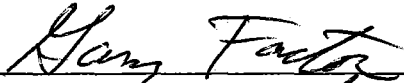

Gary Factor, Mayor

ATTEST:

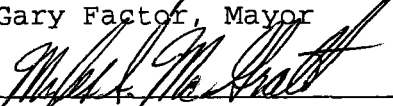

Myles McGrath, City Clerk

REC'D. BY
MMR DEC 30 1996

EXHIBIT A

Part of the Northeast One Quarter of the Northwest One Quarter of Section 33-111-24, Le Sueur County, Minnesota, described as follows:

Beginning at the North Quarter corner of said Section 33; thence on an assumed bearing of North 89 degrees 59 minutes 43 seconds West along the North line of said Northwest One Quarter of Section 33 a distance of 632.00 feet; thence South 00 degrees 52 minutes 04 seconds East 435.65 feet; thence South 89 degrees 59 minutes 43 seconds East 632.00 feet to the East line of said Northwest Quarter; thence North 00 degrees 52 minutes 04 seconds West along the East line of said Northwest Quarter 435.65 feet to the point of beginning. This tract contains 6.32 acres more or less.

REC'D. BY APR 25 1996
M A D

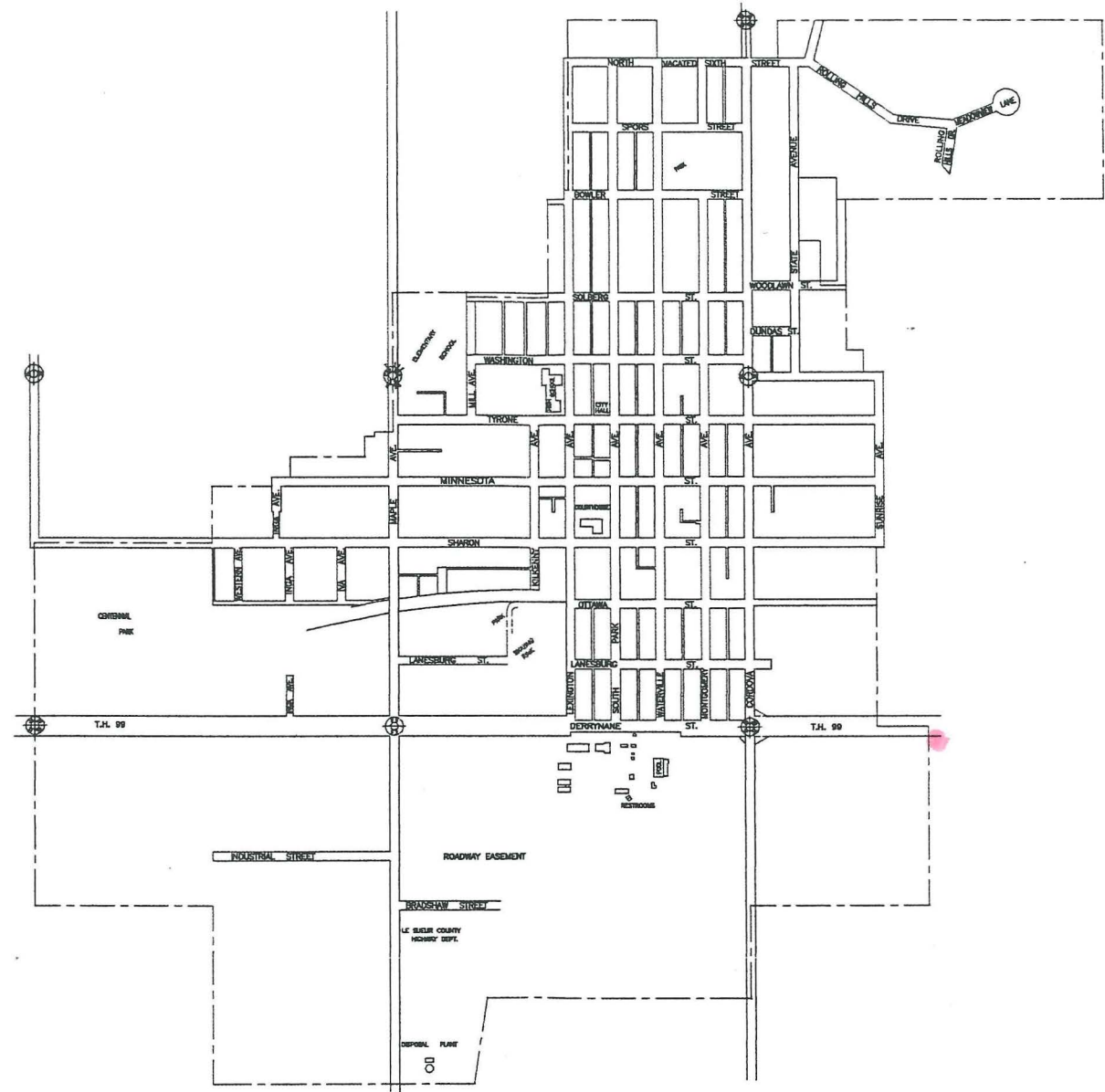

O:\LEGE\MAPS\LEGE117.DWG 03-05-96

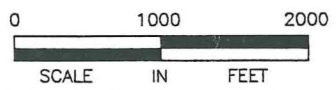

BOLTON & MENK, INC
CONSULTING ENGINEERS & SURVEYORS
BURNSVILLE, MN AMES, IA
FAIRMONT, MN MANKATO, MN SLEEPY EYE, MN

CITY OF LE CENTER, MINNESOTA
CITY BLOCK MAP
1996