

REC'D. BY
M M R APR 25 1996

PETITION FOR ANNEXATION BY ORDINANCE

IN THE MATTER OF THE PETITION FOR ANNEXATION
PURSUANT TO MINNESOTA STATUTE 414.033, SUBD. 5

TO: COUNCIL OF THE CITY OF LE CENTER, MINNESOTA

AND

MINNESOTA MUNICIPAL BOARD
475 McCOLL BUILDING
366 JACKSON STREET
ST. PAUL, MN 55101-1925

PETITIONERS STATE: This is a Petition for annexation pursuant to M.S. 414.033, Subd. 5.

It is hereby requested by all (100%) of the property owners of the area proposed for annexation to annex certain real property described herein lying in the Township of Lexington, County of Le Sueur, to the City of Le Center, State of Minnesota.

The area proposed for annexation is legally described on Exhibit A. attached hereto and incorporated herein by reference and is located in Le Sueur County, Minnesota.

- a) The Petitioner, Ruth Munn, is the sole owner of the described property, and she has signed this Petition.
- b) The described property is unincorporated, abuts the City of Le Center on its Westerly and Southerly boundary and is not included with any other Municipality.
- c) The area of Land to be annexed consists of 6.32 acres and is unplatted.
- d) The reason for the requested annexation is industrial development.
- e) All of the described property is or is about to become urban or suburban in character.
- f) The area proposed for annexation is not included in any area that has already been designated for orderly annexation pursuant to M.S. 414.0325

PETITIONERS' REQUEST: That pursuant to M.S. 414.033 Subd. 5, the property described herein be annexed to and included within the City of Le Center.

Dated: April 15, 1996.

Ruth S. Munn
Ruth S. Munn

Dale C. Munn
Dale C. Munn

Part of the Northeast One Quarter of the Northwest One Quarter of Section 33-111-24, Le Sueur County, Minnesota, described as follows:

Beginning at the North Quarter corner of said Section 33; thence on an assumed bearing of North 89 degrees 59 minutes 43 seconds West along the North line of said Northwest One Quarter of Section 33 a distance of 632.00 feet; thence South 00 degrees 52 minutes 04 seconds East 435.65 feet; thence South 89 degrees 59 minutes 43 seconds East 632.00 feet to the East line of said Northwest Quarter; thence North 00 degrees 52 minutes 04 seconds West along the East line of said Northwest Quarter 435.65 feet to the point of beginning. This tract contains 6.32 acres more or less.

RECD. BY APR 25 1996
M A D

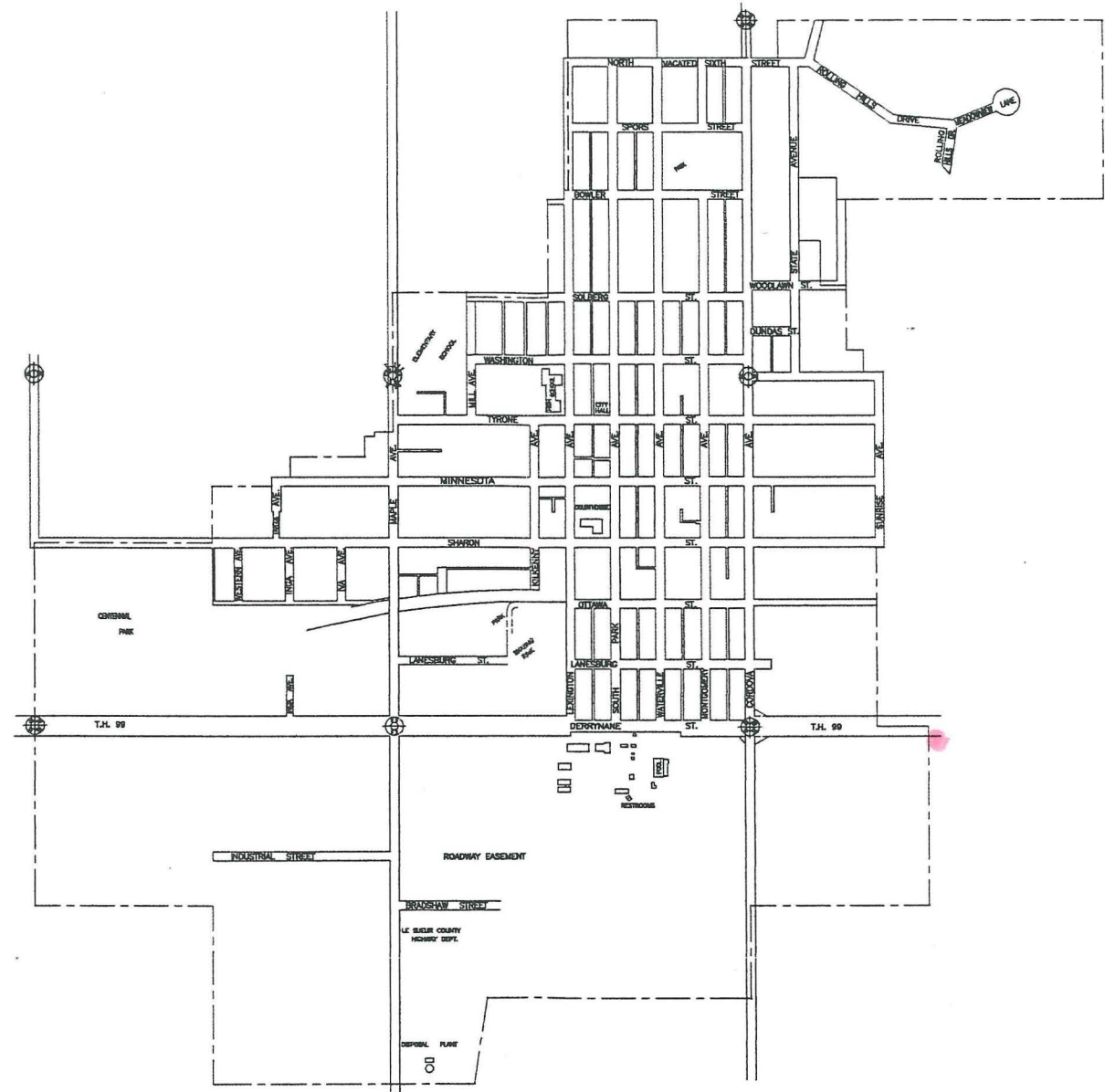

O:\LEGE\MAPS\LEGE117.DWG 03-05-96



BOLTON & MENK, INC
CONSULTING ENGINEERS & SURVEYORS
BURNSVILLE, MN AMES, IA
FAIRMONT, MN MANKATO, MN SLEEPY EYE, MN

CITY OF LE CENTER, MINNESOTA
CITY BLOCK MAP
1996