

project/gusanx

Councilmember Joe Jarvis introduced the following ordinance for its adoption:

ORDINANCE NO. 577

AN ORDINANCE EXTENDING THE CORPORATE LIMITS OF THE CITY OF HINCKLEY TO INCLUDE CERTAIN LAND OWNED BY MICKEY NILSEN & KEN SMITH ABUTTING THE CITY OF HINCKLEY

WHEREAS, Mickey Nilsen and Ken Smith have filed a petition dated 7/28/95 requesting that certain land, as legally described below:

All of the South 1/2 of the East 1/2 of Southwest 1/4 of Section 19 Township 41 Range 20, Pine County, Minnesota, less the following be annexed to the City of Hinckley:

That part of the East Half of the Southwest Quarter of Section 19, Township 41, Range 20, Pine County, Minnesota, which lies southerly of the Grindstone River.

Except the following described parcels:

- 1.) That part of the Southeast Quarter of the Southwest Quarter of Section 19, Township 41, Range 20, Pine County, Minnesota, described as follows:

Beginning at the southwest corner of said Southeast Quarter of the Southwest Quarter; thence east, along the south line of said Southeast Quarter of the Southwest Quarter, a distance of 297 feet; thence north, at right angles, 387 feet; thence west, at right angles, 298.46 feet, more or less, to the west line of said Southeast Quarter of the Southwest Quarter; thence south, along said west line, 387 feet to the point of beginning.

- 2.) That part of the East Half of the Southwest Quarter of Section 19, Township 41, Range 20, described as follows:

Beginning at the intersection of the east line of said East Half of the Southwest Quarter and the north boundary line of Minnesota Highway No. 48; thence west, along the said north line of Highway No. 48, a distance of 100 feet; thence at right angles north a distance of 150 feet; thence at right angles east a distance of 100 feet to the east line of said East Half of the Southwest Quarter; thence south, along said east line of the East Half of the Southwest Quarter, to the point of beginning, Book 127 of Deeds, page 572.

- 3.) That part of the East Half of the Southwest Quarter of Section 19, Township 41, Range 20, Pine County, Minnesota, described as follows:

Commencing at the southwest corner of said East Half of the Southwest Quarter; thence on an assumed bearing of North 00 degrees 27 minutes 37 seconds" West, along the west line of said East Half of the Southwest Quarter, a distance of 703.95 feet to the point of beginning of the property to be described; thence North 89 degrees 32 minutes 23 seconds" East 270.35 feet; thence North 21 degrees 03 minutes 05 seconds" East 255.66 feet; thence North 4 degrees 14 minutes 55 seconds" West 453.25 feet to the center line of

REC'D BY APR 15 1996
M M R

the River Road; thence South 50 degrees 50 minutes 44 seconds West, along said center line, 250.99 feet; thence southwesterly 159.97 feet, along said center line, which is a tangent curve concave to the southeast, having a radius of 694.93 feet and a central angle of 13 degrees 11 minutes 21 second"; thence South 37 degrees 39 minutes 23 seconds" West, along said center line, 42.06 feet to the west line of said East Half of the Southwest Quarter; thence South 0 degrees 27 minutes 37 seconds East, along said west line, 386.68 feet to the point of beginning.

Subject to the River Road over and across the northwest 33 feet thereof, as measured at right angles to and parallel with said center line.

Subject to easements of record.

AND WHEREAS, Mickey Nilson & Ken Smith represents that they are the owners of the respective property, abuts the limits of the City of Hinckley, is not included within any other municipality, is not included in any area that has already been designated for orderly annexation pursuant to Minnesota Statutes 414.0325, and is approximately 33 acres in size.

AND WHEREAS, A public hearing was held on April 2, 1996 with the required 30 day public notice sent to the Town of Barry and all contiguous property owners.

NOW THEREFORE, the City Council of Hinckley, Minnesota, does hereby ordain:

Section 1. The City Council hereby determines and finds that the property abuts the municipality, that the area to be annexed is sixty (60) acres or less, that the property is not included in any area that has already been designated for orderly annexation pursuant to Minnesota Statutes 414.0325, that the municipality has received a properly prepared Petition for Annexation from all of the owners of the property, and that the Petition complies with all of the provisions of Minnesota Statutes 414.033.

Section 2. The property is urban in nature or about to become so.

Section 3. The corporate limits of the City of Hinckley are hereby extended to include the property and the same is hereby annexed to and included within the City of Hinckley as if the property had originally been part thereof.

Section 4. The City Clerk is directed to file certified copies of this Ordinance with the Minnesota Municipal Board, Barry Township, the Pine County Auditor, and the Minnesota Secretary of State.

Section 5. This Ordinance takes effect upon its passage and publication and the filing of the certified copies as directed in Section 4 and approval of the Ordinance by the Minnesota Municipal Board.

Councilmember Tom Buetel seconded the foregoing Ordinance and all voted in favor.

REC'D. BY APR 08 1996
MMR

And the following voted opposed of the adoption of the above ordinance:

WHEREBY the Ordinance was declared duly passed and ordained.

Adopted this 2nd day of April, 1996.



Tom R. Cieluch, Mayor

ATTEST:

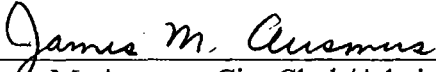

James M. Ausmus, City Clerk/Administrator

MAR 05 1996

KREGER-HANSON, INC.



PLANNING
ARCHITECTURE

PROJECT:
FOR:
**HINKLEY R.V. &
MOBILE HOME
SALES & SERVICE**
HINKLEY, MN

SHEET TITLE:
Preliminary
SCHEMATIC SITE PLAN
SHEET NUMBER:
C-1 FEB. 11, 1996

SITE LIGHTING:
AS LAY OUT HERE
MADE TO PROTECT THE PROPERTY OF THE PROJECT
FENCING:
EMERGENCY SHELTER -- LAUNDRY

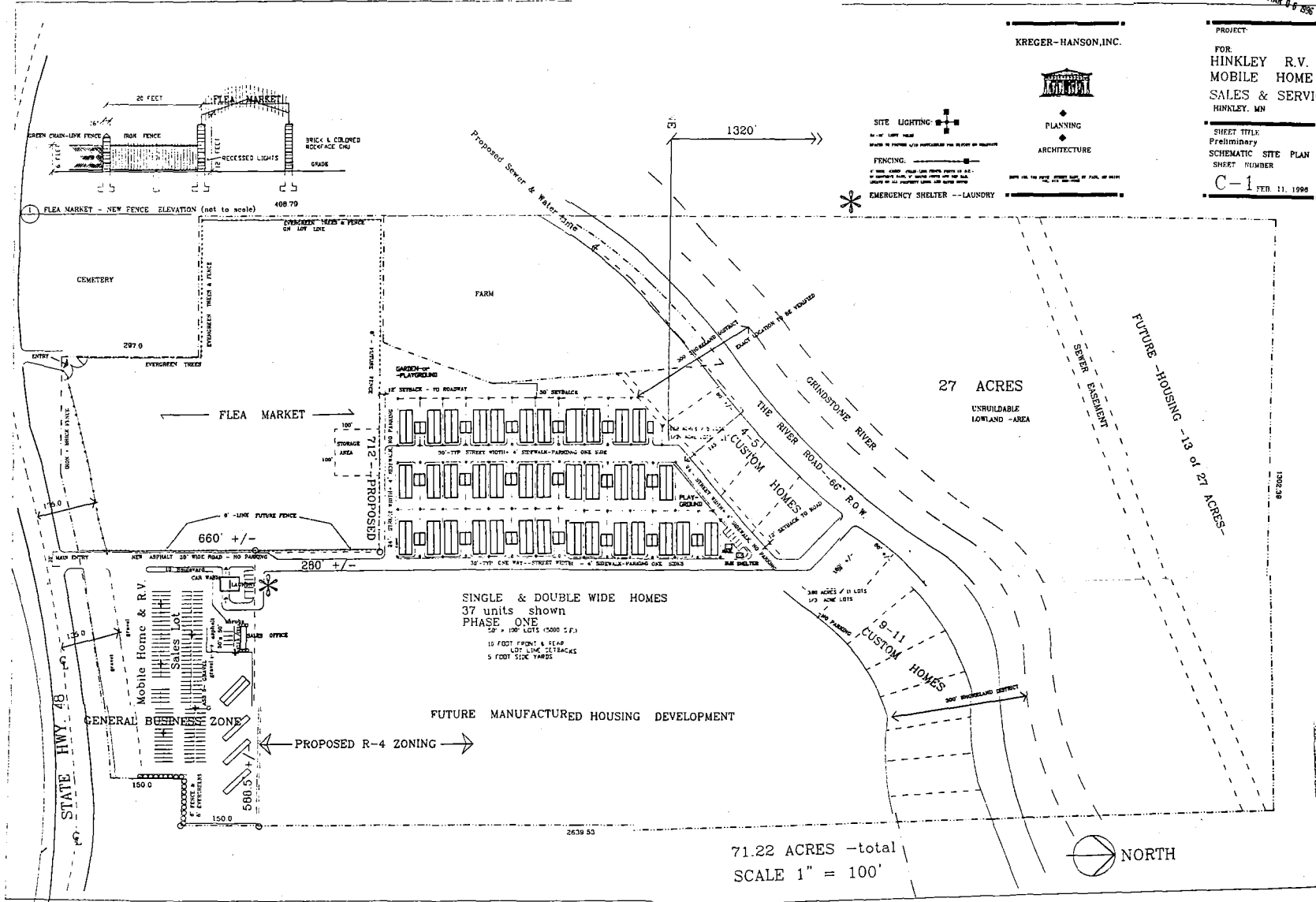

SINGLE & DOUBLE WIDE HOMES
37 units shown
PHASE ONE
50' x 100' LOTS (5000 S.F.)
10 FOOT FRONT & REAR
LOT LINE SETBACKS
5 FOOT SIDE YARDS

71.22 ACRES - total
SCALE 1" = 100'



RECEIVED BY
MAIL APR 08 1996

CITY OF
HINCKLEY
PINE COUNTY
MINNESOTA

DECEMBER 1988

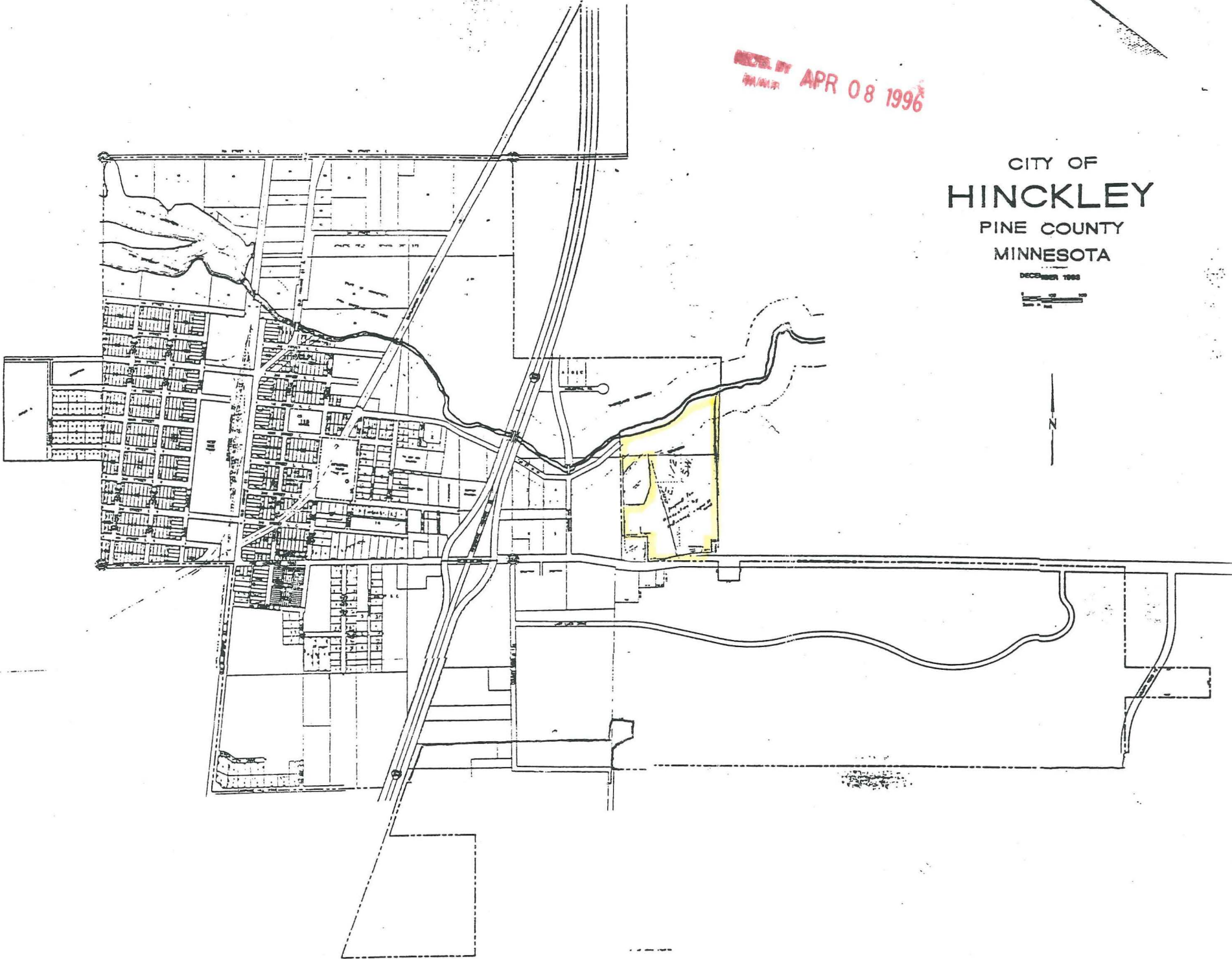

REC'D. BY APR 08 1936
M M R

- ⊙ DENOTES FOUND IRON MONUMENT
- ⊙ DENOTES PINE COUNTY LAND CORNER MONUMENT
- ⊙ DENOTES SET 1/2 INCH IRON PIPE WITH PLASTIC CAP MARKED A. L. S. NO. 8155



THE EAST LINE OF THE E 1/2 OF THE SW 1/4 OF SEC. 19 T. 41 R. 20 IS ASSUMED A BEARING OF N 0° 10' 42" W



Existing River
 City Limits
 Limits

SW 1/4
 E 1/2

DESCRIPTION OF FARMSTEAD

That part of the East Half of the Southwest Quarter of Section 19, Township 41, Range 20, Pine County, Minnesota, described as follows:

Commencing at the southwest corner of said East Half of the Southwest Quarter; thence on an assumed bearing of North 0°27'37" West along the west line of said East Half of the Southwest Quarter a distance of 703.93 feet to the point of beginning of the property to be described; thence North 89°32'21" East 270.35 feet; thence North 21°03'05" East 253.46 feet; thence North 4°10'59" West 453.25 feet to the center line of the River Road; thence South 50°50'44" West along said center line 250.99 feet; thence southwesterly 159.97 feet along said center line, which is a tangent curve concave to the southeast, having a radius of 594.93 feet and a central angle of 13°11'21"; thence South 37°39'23" along said center line 42.06 feet to the west line of said East Half of the Southwest Quarter; thence South 0°27'37" East along said west line 386.68 feet to the point of beginning.

Subject to the River Road over and across the north-west 33 feet thereof, as measured at right angles to and parallel with said center line.

I hereby certify that this is a true and correct representation of a survey of the boundaries of the East Half of the Southwest Quarter (E of SW), Section Nineteen, (19), Township Forty-one (41), Range Twenty (20), except the following:

- a) Two acres deeded to the Trustees of the Swedish Lutheran Church Society of Winckley, Minnesota, Book R of Deeds, page 327.
- b) Beginning at the southwest corner of the SE1 of the SW1 of said Section 19, Township 41, Range 20, running thence east on the section line 141 rods; thence north at right angles to said section line 18 rods; thence east 31 rods; thence south 18 rods to said section line; thence on said section line 31 rods to place of beginning. Also an easement for highway over said strip of land 16 feet wide, adjoining and along the north boundary line of the cemetery situated on the SE1 of the SW1 of said Section 19, Township 41, Range 20, now enclosed and fenced, Book 49 of Deeds, page 253.
- c) That part of the E1 of the SW1 of Section 19, Township 41, Range 20, described as follows: Beginning at the intersection of the east line of the said E1 of the SW1 and the north boundary line of Minnesota Highway No. 48; thence west along the said north line of Highway No. 48 a distance of 100 feet; thence at right angles north a distance of 150 feet; thence at right angles east a distance of 100 feet to the east line of said E1 of the SW1; thence south along said east line of the E1 of the SW1 to the point of beginning, Book 127 of Deeds, page 372.
- d) Subject to a permanent easement and right of way given to the City of Winckley, Minnesota, Book 22 of Miscellaneous, page 283.
- e) Subject to a right of way easement granted to Northwestern Bell Telephone Company recorded in Book 12 of Miscellaneous, page 304.
- f) Subject to State Highway No. 48 right of way, Book 75 of Mortgages, page 584.
- g) Subject to the township road, Microfilm No. 295672.

And of the location of all visible encroachments, if any, from or on said land. As surveyed by me this Fifteenth day of January, 1931.

W. B. Rude
 W. B. Rude
 Land Surveyor
 Minnesota License No. 8155

APPROXIMATE RIGHT OF WAY LINE
 0.110' 09" 20"
 4.208' 63"
 3.321' 64"

RECORDED BY APR 08 1996
M.M.R.

- DENOTES FOUND IRON MOVEMENT
- ⊙ DENOTES PINE COUNTY LAND CORNER MOVEMENT
- DENOTES SET 1/2 INCH FROM PIPE WITH PLASTIC CAP MARKED A.L.S. NO. 9195

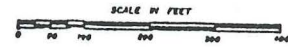

THE EAST LINE OF THE E 1/2 OF THE SW 1/4 OF SEC. 10 T. 41 N. R. 20
IS LOCATED A BEARING OF N 89° 10' 42" W.



DESCRIPTION OF FARMSTEAD

That part of the East Half of the Southwest Quarter of Section 19, Township 41, Range 20, Pine County, Minnesota, described as follows:

Commencing at the southwest corner of said East Half of the Southwest Quarter; thence on an assumed bearing of North 8°21'31" West along the west line of said East Half of the Southwest Quarter a distance of 703.95 feet to the point of beginning of the property to be described; thence North 81°31'21" East 270.33 feet; thence North 31°03'05" East 235.86 feet; thence North 4°16'35" West 151.35 feet to the center line of the River Road; thence South 30°56'48" West along said center line 250.99 feet; thence southwest only 137.97 feet along said center line, which is a tangent curve concave to the southeast, having a radius of 694.93 feet and a central angle of 11°11'21"; thence South 31°39'23" East 42.86 feet to the East line of said East Half of the Southwest Quarter; thence South 6°27'37" East along said east line 306.66 feet to the point of beginning.

Subject to the River Road over and across the northwest 1/2 of the East Half of the Southwest Quarter of Section 19, Township 41, Range 20, Pine County, Minnesota, as shown on the plat hereof, and parallel with said center line.

I hereby certify that this is a true and correct representation of a survey of the boundaries of the East Half of the Southwest Quarter (E1) of SW1/4, Section Nineteen, (19), Township Forty-one (41), Range Twenty (20), except the following:

- Two acres devoted to the Trustees of the Swedish Lutheran Church Society of Hinckley, Minnesota, Book 8 of Deeds, page 221.
- Beginning at the southwest corner of the E1 of the SW1 of said Section 19, Township 41, Range 20, running thence east on the section line 14 rods; thence north at right angles to said section line 13 rods; thence east 31 rods; thence north 13 rods to said section line; thence on said section line 31 rods to place of beginning. Also an easement for highway over said strip of land 16 feet wide, adjoining and along the north boundary line of the cemetery situated on the E1 of the SW1 of said Section 19, Township 41, Range 20, now enclosed and fenced, Book 49 of Deeds, page 293.
- That part of the E1 of the SW1 of Section 19, Township 41, Range 20, described as follows: beginning at the intersection of the east line of the said E1 section of the SW1 and the north boundary line of Minnesota Highway No. 49; thence west along the said north line of Highway No. 49 a distance of 100 feet; thence at right angles north a distance of 150 feet; thence at right angles east a distance of 100 feet to the east line of said E1 of the SW1; thence south along said east line of the E1 of the SW1 to the point of beginning, Book 127 of Deeds, page 372.
- Subject to a permanent easement and right of way given to the City of Hinckley, Minnesota, Book 22 of Miscellaneous, page 283.
- Subject to a right of way easement granted to Northwestern Bell Telephone Company recorded in Book 12 of Miscellaneous, page 366.
- Subject to State Highway No. 49 right of way, Book 79 of Mortgages, page 334.
- Subject to the township road, Microfilla No. 285672.

And of the location of all visible encroachments, if any, from or on said land, as surveyed by me this Fifteenth day of January, 1991.

W. M. Rude
 W. M. Rude
 Land Surveyor
 Minnesota License No. 9195

General Business

R-4

R-4

River

1/2 OF SW 1/4 E. 1/2

E. 1/2