

ORDINANCE NO.

3022

REC'D BY
MAR 27 1996

AN ORDINANCE ANNEXING TO THE CITY OF ROCHESTER APPROXIMATELY 14.51 ACRES OF LAND LOCATED IN THE WEST HALF OF THE SOUTHWEST QUARTER OF SECTION 8, TOWNSHIP 107 NORTH, RANGE 14 WEST, OLMSTED COUNTY, MINNESOTA.

THE COMMON COUNCIL OF THE CITY OF ROCHESTER DO ORDAIN:

Section 1. A petition has been filed with the Common Council of the City of Rochester, signed by the owners of land described herein, requesting the Common Council to annex said land to the City of Rochester. The land described in said petition for annexation is located in Cascade Township, Olmsted County, Minnesota, and is described as follows:

That part of the West Half of the Southwest Quarter of Section 8, Township 107 North, Range 14 West, Olmsted County, Minnesota, described as follows:

Commencing at the northeast corner of said West Half; thence South 00 degrees 59 minutes 54 seconds West, assumed bearing, along the east line thereof, 1002.79 feet for the point of beginning; thence North 89 degrees 00 minutes 06 seconds West, 178.93 feet; thence South 71 degrees 59 minutes 05 seconds West, 273.43 feet; thence South 83 degrees 48 minutes 59 seconds West, 116.18 feet; thence southerly 5.64 feet along a nontangential curve, concave easterly, radius of 2528.01 feet, central angle of 00 degrees 07 minutes 40 seconds and the chord of said curve bears South 06 degrees 14 minutes 52 seconds East, 5.64 feet; thence South 83 degrees 41 minutes 18 seconds West, not tangent to said curve, 110.30 feet; thence South 06 degrees 51 minutes 45 seconds East, 333.27 feet; thence South 00 degrees 13 minutes 53 seconds East, 59.73 feet; thence South 89 degrees 46 minutes 07 seconds West, 91.82 feet; thence westerly 76.45 feet along a tangential curve, concave northerly, radius of 120.00 feet central angle of 36 degrees 30 minutes 04 seconds and the chord of said curve bears North 71 degrees 58 minutes 50 seconds West, 75.16 feet; thence North 53 degrees 43 minutes 48 seconds West, tangent to said curve, 256.59 feet; thence westerly 203.30 feet along a tangential curve concave southerly, radius of 330.00 feet, central angle of 35 degrees 17 minutes 53 seconds and the chord of said curve bears North 71 degrees 22 minutes 44 seconds West, 200.10 feet; thence North 89 degrees 01 minute 41 seconds West, tangent to said curve, 135.91 feet to the west line of the Southwest Quarter of said Section 8; thence South 00 degrees 58 minutes 19 seconds West, along said west line, 60.00 feet; thence South 89 degrees 01 minute 41 seconds East, 135.91 feet; thence easterly 166.34 feet along a tangential curve, concave southerly, radius of 270.00 feet, central angle of 35 degrees 17 minutes 53 seconds and the chord of said curve bears South 71 degrees 22 minutes 44

seconds East, 163.72 feet; thence South 53 degrees 43 minutes 48 seconds East, tangent to said curve, 256.59 feet; thence easterly 114.67 feet along a tangential curve, concave northerly, radius 180.00 feet, central angle of 36 degrees 30 minutes 04 seconds and the chord of said curve bears South 71 degrees 58 minutes 50 seconds East, 112.74 feet; thence North 89 degrees 46 minutes 07 seconds East, tangent to said curve, 134.35 feet; thence South 00 degrees 13 minutes 53 seconds East, 155.00 feet; thence South 52 degrees 08 minutes 13 seconds East, 442.92 feet; thence North 60 degrees 33 minutes 12 seconds East, 100.32 feet; thence South 00 degrees 59 minutes 54 seconds West, 532.35 feet; thence South 53 degrees 43 minutes 48 seconds East, 155.01 feet to the east line of the West Half of the Southwest Quarter of said Section 8; thence North 00 degrees 59 minutes 54 seconds East, along said east line, 1563.87 feet to the point of beginning.

Containing 14.51 acres, more or less.

Section 2. The total quantity of land included in said petition is approximately 14.51 acres in size.

Section 3. On February 21, 1996, the Common Council held a public hearing to consider this annexation petition after providing written notice of the hearing, by registered mail, to the property owner, the Cascade Township officers, and the adjacent property owners.

Section 4. Following the public hearing, the Common Council of the City of Rochester determined that the land abuts the municipal limits, is less than 60 acres in area, the annexation petition is signed by all property owners of the land described in Section 1, and the land is or will soon become urban or suburban in character.

Section 5. Therefore, pursuant to Minn. Stat. §414.033, subd. 2(3), the land described in Section 1 above is hereby annexed, added to and made a part of the City of Rochester, Minnesota, as effectually as if it had originally been a part thereof.

Section 6. Present and future owners of the lands annexed by this ordinance are hereby notified that in addition to the usual assessments, it is the intention of the Common Council to assess against benefitted property all or a portion of the cost of any storm sewer, water tower, pumping station, and trunk line sanitary sewer construction, heretofore or hereafter undertaken to serve the area annexed.

Section 7. This ordinance shall take effect and be in force from and after its official publication and from and after the filing of a certified copy hereof with the Minnesota Municipal Board, the Cascade Town Clerk, the County Auditor, and the Secretary of State.

REC'D. BY MAR 27 1996
M M R

PASSED AND ADOPTED BY THE COMMON COUNCIL OF THE CITY OF
ROCHESTER, MINNESOTA, THIS 18TH DAY OF MARCH, 1996.

John Thunzicher
PRESIDENT OF SAID COMMON COUNCIL

ATTEST: Nicky Kari Green
ACTING CITY CLERK

APPROVED THIS 19TH DAY OF MARCH, 1996.

Charles G. Confield
MAYOR OF SAID CITY

(Seal of the City of
Rochester, Minnesota)

ord\annex96.3

ANNEXATION EXHIBIT

REC'D. BY MAR 27 1996
M A A P

1" = 600'

Center
Section
8-107-14

UNPLATTED

UNPLATTED
ANNEXATION
14.51 ACRES

EXISTING
CITY LIMITS

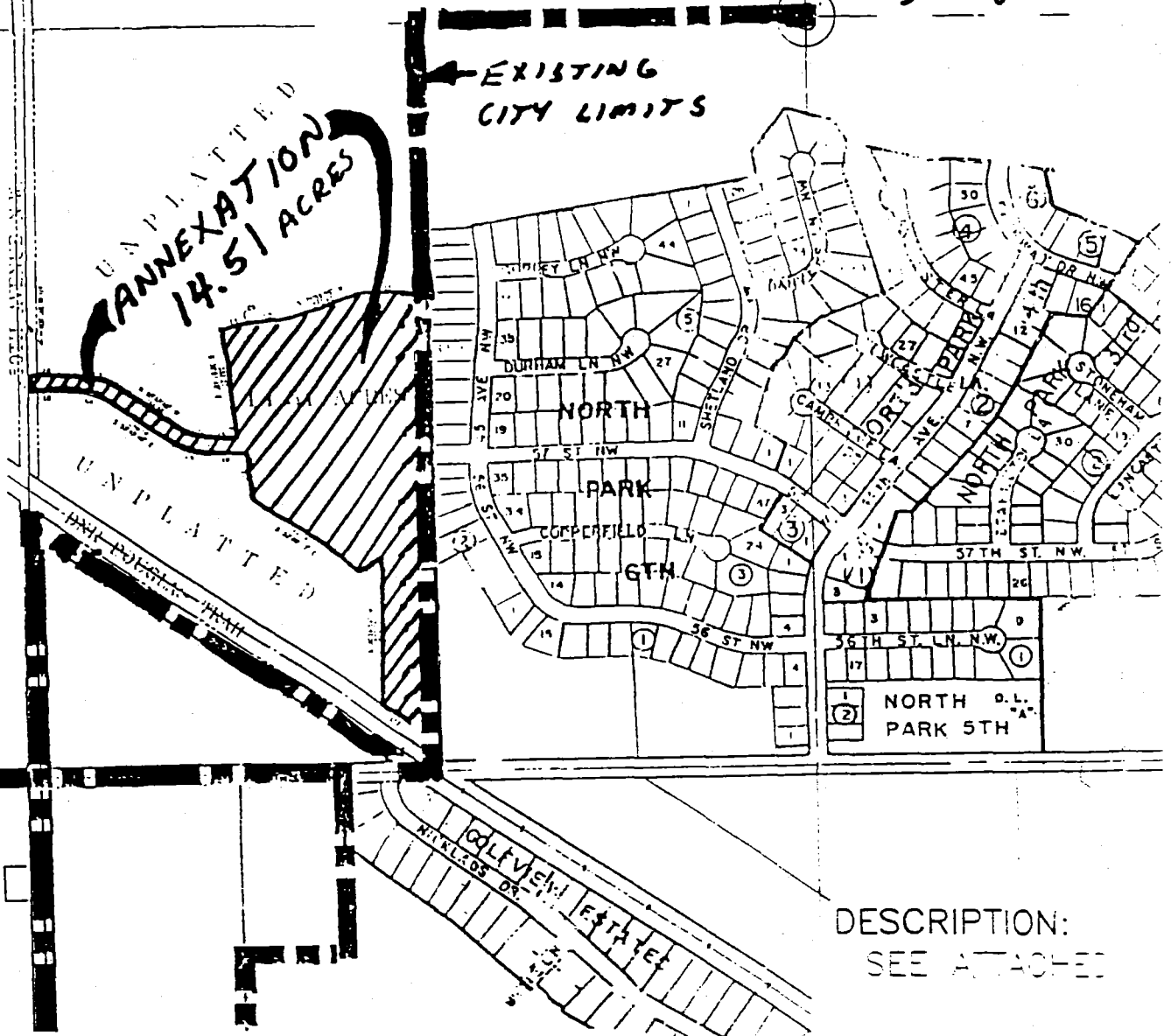

DESCRIPTION:
SEE ATTACHED

FOR :

DAKOTA OF ROCHESTER, INC.
ROCHESTER, MINNESOTA
55901

McGhie
Consulting Engineers

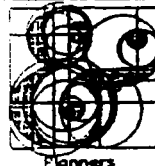

Betts, Inc.
Land Surveyors

SCALE: 1" = 600'

DRAWN BY: BWC

DATE: 01-09-96

ACCT. NO.: 1112/4487

CADD NO.: 4487ANNX

1644 5/11/97

ROCHESTER, MN. 55904

507-289-1919