

RECEIVED BY MAR 19 1996
M M B 7:45 am

BEFORE THE MUNICIPAL BOARD
OF THE STATE OF MINNESOTA

Robert J. Ferderer	Chair
Paul B. Double	Vice Chair
Lea De Souza Speeter	Vice Chair
_____	Ex-officio Member
_____	Ex-officio Member

IN THE MATTER OF THE PETITION)
 OF THE CITY OF ALBERTVILLE) Docket No. _____
 FOR ANNEXATION OF UNINCORPORATED)
 PROPERTY IN THE TOWNSHIP OF FRANKFORT) PETITION FOR ANNEXATION
 TO THE CITY OF ALBERTVILLE PURSUANT)
 TO MINNESOTA STATUTES §414.031)

TO: THE MINNESOTA MUNICIPAL BOARD
Suite 475, McColl Building
366 Jackson Street
Saint Paul, Minnesota 55101

Petitioner City of Albertville, Wright County Minnesota ("Albertville") hereby petitions the Minnesota Municipal Board pursuant to Minn. Stat. §414.031 for a public hearing and an order annexing to Albertville certain property in the Township of Frankfort, Wright County Minnesota ("Frankfort"). Pursuant to Minn. Stat. Ch. 414 and in support of this Petition, Albertville states as follows:

1. The area proposed for annexation ("Annexation Area") is described as follows:

FROM TOWNSHIP 120 NORTH, RANGE 23 WEST, THE FOLLOWING DESCRIBED PROPERTY:

- That part of Sections 1 and 2 lying north of the Crow River;
- All of Sections 3, 4, 5;
- That part of Section 6 not already included in the Albertville City Limits;
- That part of Section 8, lying north and east of I-94;
- That part of Section 9, lying north and east of I-94;
- That part of Section 10, lying north and west of the Crow River;
- That part of Section 12, lying north of the Crow River.

All of the above-described property is located within Frankfort Township, Wright County, Minnesota.

REC'D BY MAR 19 1996
M M R 7:45 am

FROM TOWNSHIP 120 NORTH, RANGE 24 WEST, THE FOLLOWING
DESCRIBED PROPERTY:

That part of Sections 1 and 2 which is not already included in the Albertville City Limits;
All of Section 3;
The North One-Half of Section 10;
The Northwest One-Quarter of Section 11, not already included in the Albertville City
Limits.

All of the above-described property is located within Frankfort Township, Wright
County, Minnesota..

Maps showing existing Albertville boundaries and the Annexation Area are set forth in
Exhibit A.

2. The Frankfort Township property abuts Albertville on its western and eastern boundaries
and is not part of any incorporated city or in an area designated for orderly annexation.
3. The total acreage of the Annexation Area constitutes approximately 5100 acres.
4. The Annexation Area is or is about to become urban or suburban in character.
5. Annexation of the Annexation Area into Albertville is required to protect the public,
health, safety and welfare.
6. Annexation of the Annexation Area will be in the best interests of the residents of the
Annexation Area.
7. After annexation of the Annexation Area, Frankfort will be able to continue to carry out
the functions of township government without hardship and the remaining residents of
Frankfort Township will not be harmed by the annexation.
8. The increase in revenues to Albertville as a result of the annexation will be commensurate
with the benefits provided to the Annexation Area.
9. Annexation to another municipality would not be in the best interests of the residents of
the Annexation Area.
10. Albertville's City Council Resolution 1996 - 26, dated March 18, 1996 which authorized
the submission of this Petition, is attached as Exhibit B and made a part of this Petition.

RECORDED BY MAR 19 1996
M.M.G. 7:45 am

11. The entities entitled to notice under Minn. Stat. §414.09 are: The Township of Frankfort as the township presently governing the Annexation Area; Wright County as the county in which the Annexation Area is situated; the Townships of Hassan and Monticello and the Cities of Otsego, Dayton and St. Michael as municipalities with abutting territory to the Annexation Area.

WHEREFORE, the City of Albertville request that the Minnesota Municipal Board Order that the Annexation Area be annexed to Albertville and provide such other relief as is just and equitable.

Dated: March 18, 1996

THE CITY OF ALBERTVILLE

BY: Dean Boring
Acting Mayor

Attested to this 18th day of March, 1996

Sandra Houghton
Clerk

FILED BY MAR 19 1996
7:45am

**CITY OF ALBERTVILLE
RESOLUTION #1996- 26**

**A RESOLUTION AUTHORIZING A PETITION TO THE MINNESOTA
MUNICIPAL BOARD FOR ANNEXATION OF PORTIONS OF
FRANKFORT TOWNSHIP**

Pursuant to due call and notice thereof, a regular meeting of the City Council of the City of Albertville, Minnesota was held in the City Hall of said City on the 18th day of March, 1996 at 6:00 P.M.

The following members were present:

The following members were absent:

NOW, THEREFORE, BE IT RESOLVED by the City Council of Albertville, Wright County, Minnesota, as follows:

That the attached Petition For Annexation of the following described property in Frankfort Township be filed with the Minnesota Municipal Board:

FROM TOWNSHIP 120 NORTH, RANGE 23 WEST, THE FOLLOWING DESCRIBED PROPERTY:

That part of Sections 1 and 2 lying north of the Crow River;
All of Sections 3, 4, 5;
That part of Section 6 not already included in the Albertville City Limits;
That part of Section 8, lying north and east of I-94;
That part of Section 9, lying north and east of I-94;
That part of Section 10, lying north and west of the Crow River;
That part of Section 12, lying north of the Crow River.

All of the above-described property is located within Frankfort Township, Wright County, Minnesota.

FROM TOWNSHIP 120 NORTH, RANGE 24 WEST, THE FOLLOWING DESCRIBED PROPERTY:

That part of Sections 1 and 2 which is not already included in the Albertville City Limits;
All of Section 3;
The North One-Half of Section 10;
The Northwest One-Quarter of Section 11, not already included in the Albertville City Limits.

All of the above-described property is located within Frankfort Township, Wright County, Minnesota..

**THIS RESOLUTION ADOPTED BY RECORDED VOTE OF THE CITY COUNCIL OF
THE CITY OF ALBERTVILLE IN OPEN SESSION ON THIS 18th DAY OF
MARCH, 1996.**

RECEIVED BY MAR 19 1996
M.M.R.

7:45am



Acting Mayor

ATTEST:

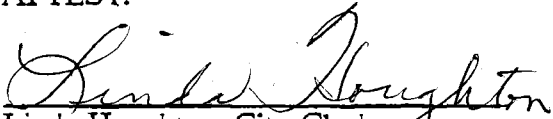

Linda Houghton, City Clerk

(SEAL)

EAST PART MONTICELLO WEST PART CITY OF OTSEGO

T.121 N.-R.24 W. EAST PART CITY OF OTSEGO WEST PART CITY OF FRANKFORT

RECEIVED BY MAR 19 1996 7:45 am

T.120-121 N.-R.23 W. 29

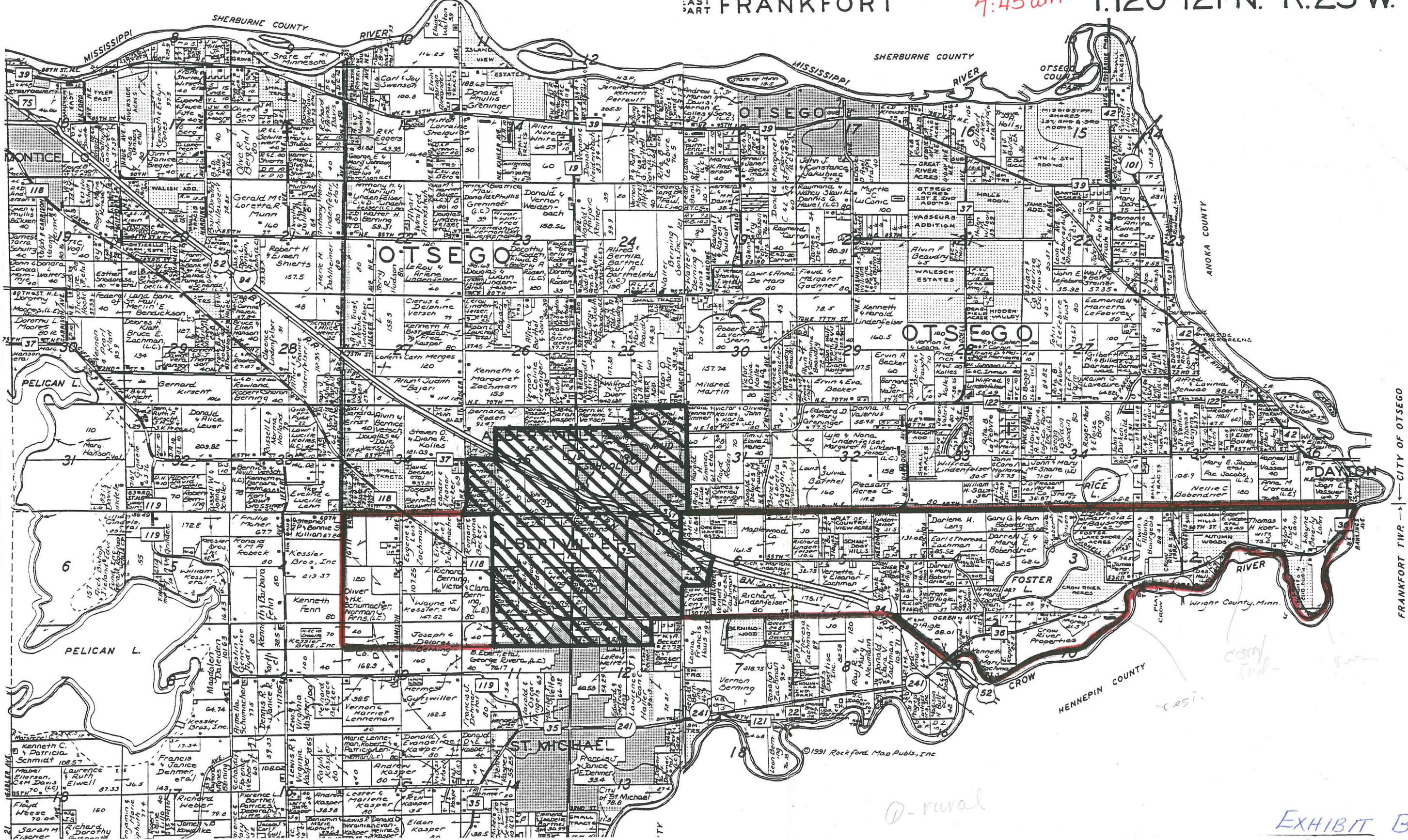

D-rural

EXHIBIT B

©1991 Rockford Map Pubs, Inc