

REC'D BY MAR 11 1996
M M R

ORDINANCE NO. 3016

AN ORDINANCE ANNEXING TO THE CITY OF ROCHESTER APPROXIMATELY 1.78 ACRES OF LAND LOCATED IN THE SOUTHWEST QUARTER OF THE SOUTHWEST QUARTER OF SECTION 13 AND THE NORTHWEST QUARTER OF THE NORTHWEST QUARTER OF SECTION 24, TOWNSHIP 106 NORTH, RANGE 14 WEST, OLMSTED COUNTY, MINNESOTA.

THE COMMON COUNCIL OF THE CITY OF ROCHESTER DO ORDAIN:

Section 1. A petition has been filed with the Common Council of the City of Rochester, signed by the owners of land described herein, requesting the Common Council to annex said land to the City of Rochester. The land described in said petition for annexation is located in Rochester Township, Olmsted County, Minnesota, and is described as follows:

That part of the Southwest Quarter of the Southwest Quarter of Section 13, and of the Northwest Quarter of the Northwest Quarter of Section 24, Township 106 North, Range 14 West, Olmsted County, Minnesota, described as follows:

Beginning at the northwest corner of said Northwest Quarter; thence southerly on an assumed azimuth from north of 178 degrees 52 minutes 49 seconds along the west line of said Northwest Quarter 382.39 feet to the northerly right of way line of Trunk Highway No. 52; thence easterly 89 degrees 33 minutes 29 seconds azimuth along said northerly right of way line 100.01 feet; thence northerly 358 degrees 52 minutes 49 seconds azimuth 772.22 feet to the intersection with the easterly extension of the southerly line of The 12 Seas Subdivision, according to the plat thereof on file in the County Recorder's office, Olmsted County, Minnesota; thence westerly 268 degrees 55 minutes 12 seconds azimuth along said easterly extension 102.21 feet to the southeast corner of said The 12 Seas Subdivision; thence southerly 178 degrees 33 minutes 30 seconds azimuth along the west line of said Southwest Quarter 388.07 feet to the point of beginning.

Containing 1.78 acres, more or less.

Section 2. The total quantity of land included in said petition is approximately 1.78 acres in size.

Section 3. On March 4, 1996, the Common Council held a public hearing to consider this annexation petition after providing written notice of the hearing, by registered mail, to the property owner, the Rochester Township officers, and the adjacent property owners.

Section 4. Following the public hearing, the Common Council of the City of Rochester determined that the land abuts the municipal limits,

is less than 60 acres in area, the annexation petition is signed by all property owners of the land described in Section 1, and the land is or will soon become urban or suburban in character.

Section 5. Therefore, pursuant to Minn. Stat. §414.033, subd. 2(3), the land described in Section 1 above is hereby annexed, added to and made a part of the City of Rochester, Minnesota, as effectually as if it had originally been a part thereof.

Section 6. Present and future owners of the lands annexed by this ordinance are hereby notified that in addition to the usual assessments, it is the intention of the Common Council to assess against benefitted property all or a portion of the cost of any storm sewer, water tower, pumping station, and trunk line sanitary sewer construction, heretofore or hereafter undertaken to serve the area annexed.

Section 7. This ordinance shall take effect and be in force from and after its official publication and from and after the filing of a certified copy hereof with the Minnesota Municipal Board, the Rochester Town Clerk, the County Auditor, and the Secretary of State.

PASSED AND ADOPTED BY THE COMMON COUNCIL OF THE CITY OF ROCHESTER, MINNESOTA, THIS 4TH DAY OF MARCH, 1996.

John H. Hunsicker
PRESIDENT OF SAID COMMON COUNCIL

ATTEST:

Julie Kay Sorenson
ACTING CITY CLERK

APPROVED THIS 5TH DAY OF MARCH, 1996.

Thomas J. Campbell
MAYOR OF SAID CITY

(Seal of the City of
Rochester, Minnesota)

REC'D BY JAN 29 1996
M A R

REC'D BY MAR 11 1996
M A R

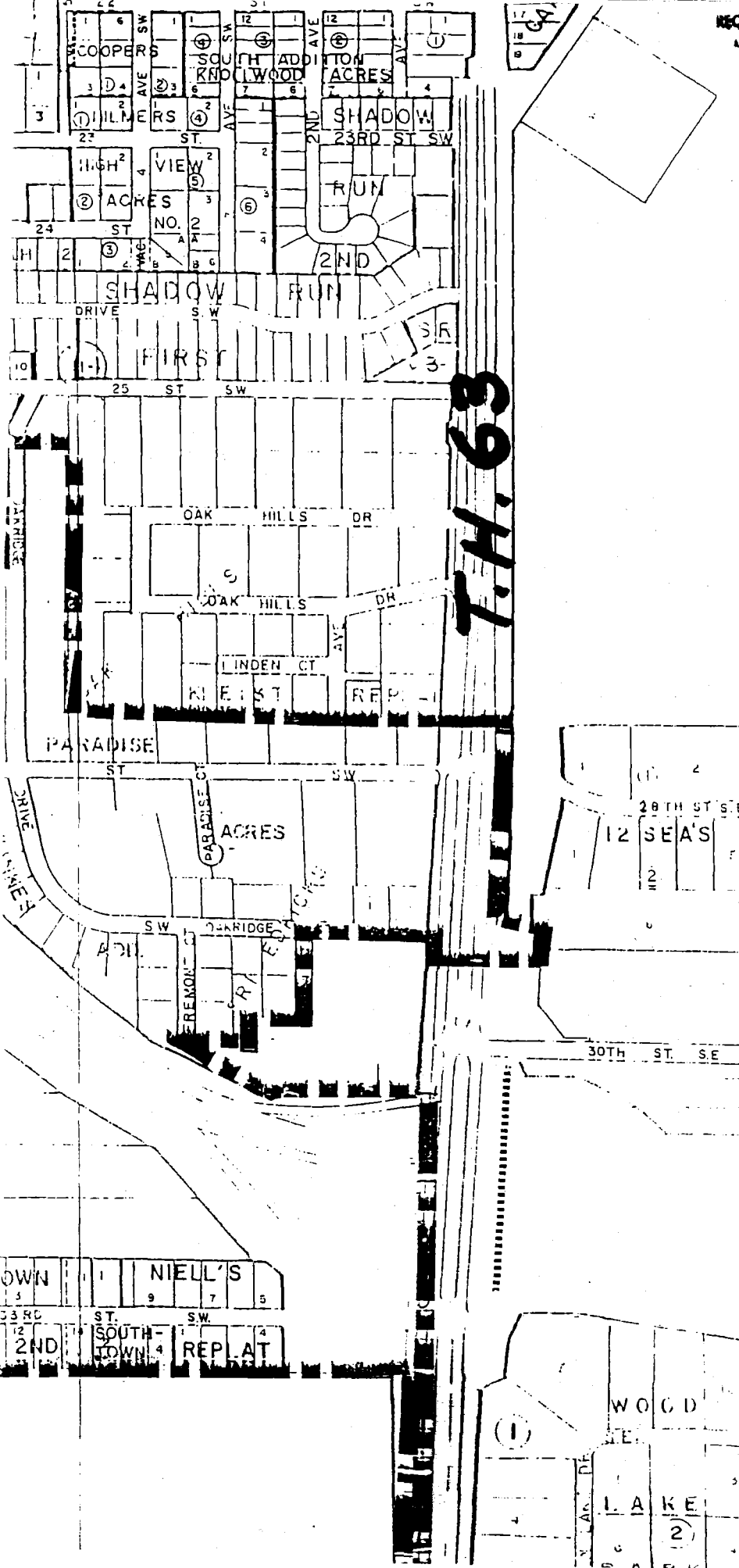

**PROPOSED
ANNEX &
ZONE
CHANGE**

T.H. 52

(1)

(1)

(2)

(2)

(2)