

## Ordinance No.: Chapter 27, 96-03

AN ORDINANCE EXTENDING THE CORPORATE LIMITS OF THE CITY OF DASSEL  
TO INCLUDE CERTAIN LAND OWNED BY:  
John and Lois Dahl  
AND ABUTTING THE CITY OF DASSEL

WHEREAS, John and Lois Dahl having filed a petition dated 01-03-96, 1996, requesting that certain land, as legally described below and hereinafter referred to as the "Subject Property", be annexed to the City of Dassel:

That part of Lot Eight (8) lying South of Railroad limits (Railroad right of way) and East of the lake, Section 33, Township 119 North, Range 29 West, EXCEPT THEREFROM: That part of government Lot 8, Section 33, Township 119, Range 29, described as follows: Commencing at the Northeast corner of said Government Lot 8; thence South 03 degrees 51'04" West, assumed bearing, along the East line of said Government Lot 8 a distance of 674.41 feet to the Southerly right-of-way line of the line a distance 441.14 feet to the actual point of the beginning; thence south a distance of 192.82 feet, thence West a distance of 151.59 feet, thence North a distance of 209.17 feet, to the Southerly right-of-way line of said Burlington Northern Railroad; thence South 83 degrees 50'38" East, along said right-of-way line a distance of 152.47 feet to the actual point of beginning; ALSO EXCEPT THEREFROM: That part of Government Lot 8, Section 33, Township 119, Range 29, lying southerly of the Southerly right-of-way line of Burlington Northern Railroad and Westerly of the following described line: Commencing at the Southeast corner of said Government Lot 8; thence along the South line of said Government lot 8 on an assumed bearing of West, a distance of 2075.53 feet to the actual point of beginning of the line to be described; thence North 14 degrees 30'00" East, a distance of 290.00 feet, more or less, to the waters edge of Sellards Lake and there terminating; ALSO EXCEPT THEREFROM: Any portion of the above-described lands lying in Sellards Addition according to the plat thereof on file and of record in the Office of the Meeker County Recorder; ALSO EXCEPT THEREFROM: That part of Government Lot 8, Section 33, Township 119 North, Range 29 West, shown as parcel 240 on Minnesota Department of Transportation Right of Way Plat No. 47-4 as the same was filed for record on January 16, 1992 in Book 229B of the County Recorder in and for Meeker County, Minnesota, with said parcel having been conveyed to the State of Minnesota for trunk highway purposes by Warranty Deed dated April 16, 1992, recorded May 28, 1992 in Book 615 of Deeds, pages 791-792 in the Office of the County Recorder in and for Meeker County, Minnesota.

WHEREAS, John and Lois Dahl represent that they are the sole owners of the Subject Property, that the property is unincorporated, abuts the limits of the City of Dassel, is not included within any other municipality, is not included in any area that has already been designated for orderly annexation

pursuant to Minnesota Statutes 414.0325, and is approximately 9 acres in size.

NOW, THEREFORE, The City Council of Dassel, Minnesota does hereby ordain as follows:

Section 1. The City Council hereby determines and finds the following:

1. That the Subject Property abuts the City of Dassel.
2. That the area to be annexed is sixty (60) acres or less.
3. That the property is urban or suburban in nature or about to become so.
4. That the Subject Property is not included in any area that has already be designated for orderly annexation pursuant Minnesota Statutes 414.0325.
5. That the City has received a properly prepared petition for annexation from all of the owners of the Subject Property.
6. That the petition complies with all of the provisions of Minnesota Statute 414.033.

Section 2. The corporate limits of the City of Dassel are hereby extended to include the property an the same is hereby annexed to and included within the City of Dassel as if the property had originally been part thereof.

Section 3. The City Clerk is authorized and directed to file certified copies of this ordinance with the Minnesota Municipal Board, Dassel Township, the Meeker County Auditor, and the Minnesota Secretary of State.

Section 4. This ordinance takes effect upon its passage and publication by the City Council, the filing of the certified copies as directed by Section 3, and final approval by the Minnesota Municipal Board.

Enacted by the Dassel City Council the 5th day of February, 1996.

REC'D. BY MAR 08 1996  
M A M R

Ordinance Chap 27, 97-2 (Continued)

City of Dassel, Minnesota

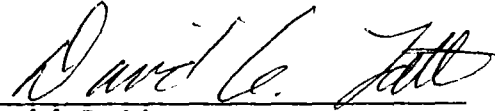

David Latt  
Mayor

Attest:

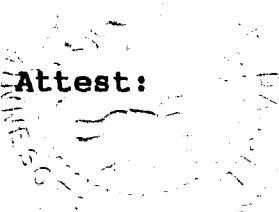
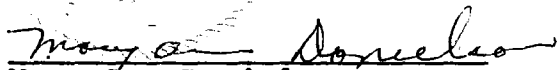

Mary Ann Danielson  
City Clerk

Published in the Dassel-Cokato Enterprise-Dispatch the \_\_\_\_\_ day  
of \_\_\_\_\_, 199\_\_.

That part of Lot Eight (8) lying South of Railroad limits (Railroad right of way) and East of the lake, Section 33, Township 119 North, Range 29 West, EXCEPT THEREFROM: That part of Government Lot 8, Section 33, Township 119, Range 29, described as follows: Commencing at the Northeast corner of said Government Lot 8; thence South  $03^{\circ}51'04''$  West, assumed bearing, along the East line of said Government Lot 8 a distance of 674.41 feet to the Southerly right-of-way line of the Burlington Northern Railroad; thence North  $83^{\circ}50'38''$  West, along said right-of-way line a distance 441.14 feet to the actual point of beginning; thence South a distance of 192.82 feet, thence West a distance of 151.59 feet, thence North a distance of 209.17 feet, to the Southerly right-of-way line of said Burlington Northern Railroad; thence South  $83^{\circ}50'38''$  East, along said right-of-way line a distance of 152.47 feet to the actual point of beginning; ALSO EXCEPT THEREFROM: That part of Government Lot 8, Section 33, Township 119, Range 29, lying southerly of the Southerly right-of-way line of Burlington Northern Railroad and Westerly of the following described line: Commencing at the Southeast corner of said Government Lot 8; thence along the South line of said Government Lot 8 on an assumed bearing of West, a distance of 2075.53 feet to the actual point of beginning of the line to be described; thence North  $14^{\circ}30'00''$  East, a distance of 290.00 feet, more or less, to the water's edge of Sellards Lake and there terminating; ALSO EXCEPT THEREFROM: Any portion of the above-described lands lying in Sellards Addition according to the plat thereof on file and of record in the Office of the Meeker County Recorder; ALSO EXCEPT THEREFROM: That part of Government Lot 8, Section 33, Township 119 North, Range 29 West, shown as Parcel 240 on Minnesota Department of Transportation Right of Way Plat No. 47-4 as the same was filed for record on January 16, 1992 in Book 229B of the County Recorder in and for Meeker County, Minnesota, with said parcel having been conveyed to the State of Minnesota for trunk highway purposes by Warranty Deed dated April 16, 1992, recorded May 28, 1992 in Book 615 of Deeds, pages 791-792 in the Office of the County Recorder in and for Meeker County, Minnesota.

REC'D. BY MAR 08 1996  
K M R

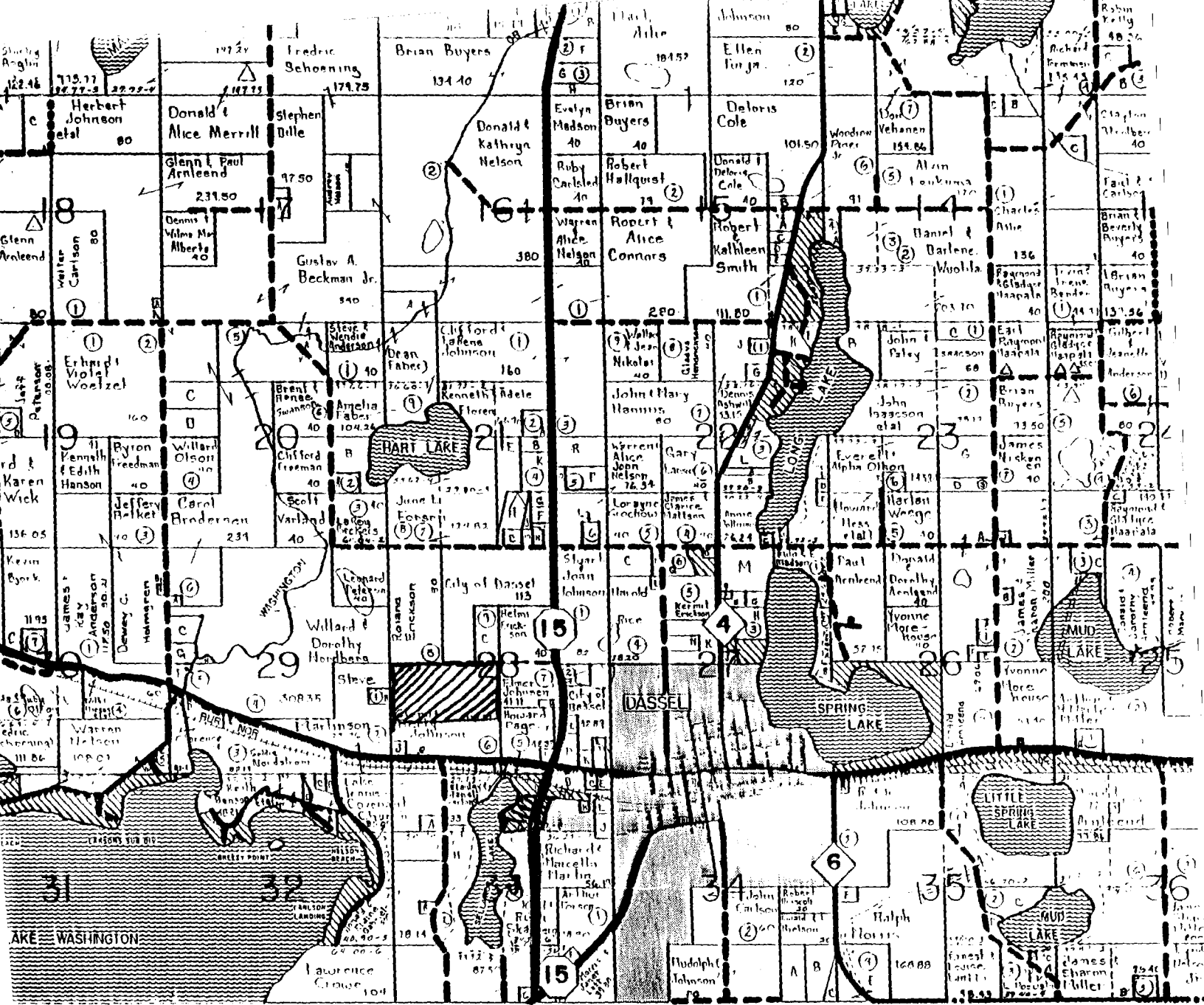

SEE SMALL TRACT OWNERS FOLLOWING TOWNSHIP MAPS

HOMES • COMMERCIAL • LAKE SHORE

**Earl Raske**  
**Lois Raske**

state 96228      Office: 612-877-7221  
Home: 612-877-7391

MAR 08 1996