

**ORDINANCE NO. 561**

FILED BY MAY 22 1996  
MMR

**AN ORDINANCE AMENDING AN ORDINANCE NO. 555 OF THE CITY OF SAUK CENTRE ANNEXING LAND OWNED BY INDEPENDENT SCHOOL DISTRICT NO. 743 OF SAUK CENTRE, MINNESOTA.**

THE CITY OF SAUK CENTRE DOES ORDAIN:

**Section 1.** The City of Sauk Centre has received a petition from Independent School District No. 743 of Sauk Centre, Minnesota, requesting the annexation of lands into the corporate limits of the City of Sauk Centre, which land is located in Sauk Centre Township, Stearns County, Minnesota, and is described in Exhibit A attached hereto and made a part hereof.

**Section 2.** The City having reviewed the petition and lands involved, has made the following findings and determinations:

- A. The land is urban or suburban in character;
- B. The land abuts the corporate limits of the City of Sauk Centre;
- C. The land is 60 acres or less in size;
- D. The land was not served by city sewer and said facilities were not available on the date petition was received.

**Section 3.** The City of Sauk Centre has notified the supervisors of Sauk Centre Township, the superintendent of Independent School District No. 743, and all land owners within and contiguous to the area to be annexed, of the annexation petition and a hearing thereon was held at the regularly scheduled meeting of the Sauk Centre City Council on February 7, 1996, at which time the City of Sauk Centre took testimony for and against said annexation.

**Section 4.** The City of Sauk Centre is empowered pursuant to Minnesota Statute 414.033 to annex the subject property by ordinance and by the execution of this ordinance directs that said property be annexed into the City of Sauk Centre.

**Section 5.** As a result of this annexation, the population of the City of Sauk Centre will not increase.

**Section 6.** The City of Sauk Centre hereby requests that the Minnesota Municipal Board immediately order and approve said annexation upon receipt of this ordinance. The City further requests that no further consideration by the said board is necessary and that no alteration of the stated boundaries of the annexation be made by said board.

**Section 7.** The City hereby directs that the zoning map described in Section 1001.04, Subdivision 2, of the Sauk Centre City Code be amended to include property described in Exhibit A, and further that the City amend its land use controls to conform to Chapter 103F as a result of this annexation.

**Section 8.** That Sauk Centre City Clerk is directed to file a certified copy of this ordinance with the following boards and agencies: Minnesota Municipal Board, Sauk Centre Township, Stearns County Auditor and the Minnesota Secretary of State.

**Section 9.** That this ordinance shall be in full force and effect after its publication in the Sauk Centre Herald.

The foregoing ordinance was duly passed and adopted by the City Council of the City of Sauk Centre, Minnesota, at its regular Meeting on the 15<sup>th</sup> day of May, 1996.

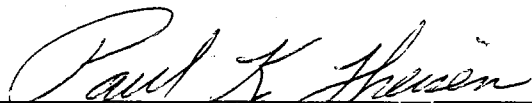
  
\_\_\_\_\_  
Paul K. Theisen - Its Mayor

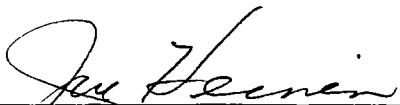
  
\_\_\_\_\_  
Joe Heinen - Its City Clerk

THIS INSTRUMENT WAS DRAFTED BY:

Thomas J. Mayer  
Attorney at Law  
421 Sinclair Lewis Avenue  
Sauk Centre, MN 56378  
#69139

**EXHIBIT A****Independent School District Property**

That part of the East Half of the Northwest Quarter of the Southeast Quarter (E1/2 NW1/4 SE1/4) of Section 10, Township 126, Range 34 West, lying South of the centerline of County Road 17 and West of the tread of Sauk River; and that part of the East Half of the Southwest Quarter of the Southeast Quarter (E1/2 SW1/4 SE1/4), Section 10, Township 126, Range 34, Stearns County, Minnesota, lying West of the centerline or tread of the Sauk River; and that part of the West Half of the Southeast Quarter of the Southeast Quarter (W1/2 SE1/4 SE1/4) of Section 10, Township 126, Range 34, Stearns County, Minnesota, lying West of the centerline or tread of Sauk River and the North Half of the Northwest Quarter of the Northeast Quarter (N1/2 NW1/4 NE1/4) of Section 15, Township 126, Range 34, excepting the West 800 feet thereof, Stearns County, Minnesota, lying West of the centerline or tread of Sauk River; and that part of the North Half of the Northeast Quarter of the Northeast Quarter (N1/2 NE1/4 NE1/4) of Section 15, Township 126, Range 34, Stearns County, Minnesota, lying West of the centerline or tread of the Sauk River, all in Stearns County, Minnesota, containing 36.91 acres more or less.

**ORDINANCE NO. 555**

**AN ORDINANCE OF THE CITY OF SAUK CENTRE ANNEXING LAND OWNED BY INDEPENDENT SCHOOL DISTRICT NO. 743 OF SAUK CENTRE, MINNESOTA.**

THE CITY OF SAUK CENTRE DOES ORDAIN:

**Section 1.** The City of Sauk Centre has received a petition from Independent School District No. 743 of Sauk Centre, Minnesota, requesting the annexation of lands into the corporate limits of the City of Sauk Centre, which land is located in Sauk Centre Township, Stearns County, Minnesota, and is described in Exhibit A attached hereto and made a part hereof.

**Section 2.** The City having reviewed the petition and lands involved, has made the following findings and determinations:

- A. The land is urban or suburban in character;
- B. The land abuts the corporate limits of the City of Sauk Centre;
- C. The land is 60 acres or less in size;
- D. The land was not served by city sewer and said facilities were not available on the date petition was received.

**Section 3.** The City of Sauk Centre has notified the supervisors of Sauk Centre Township, the superintendent of Independent School District No. 743, and all land owners within and contiguous to the area to be annexed, of the annexation petition and a hearing thereon was held at the regularly scheduled meeting of the Sauk Centre City Council on February 7, 1996, at which time the City of Sauk Centre took testimony for and against said annexation.

**Section 4.** The City of Sauk Centre is empowered pursuant to Minnesota Statute 414.033 to annex the subject property by ordinance and by the execution of this ordinance directs that said property be annexed into the City of Sauk Centre.

**Section 5.** As a result of this annexation, the population of the City of Sauk Centre will not increase.

**Section 6.** The City of Sauk Centre hereby requests that the Minnesota Municipal Board immediately order and approve said annexation upon receipt of this ordinance. The City further requests that no further consideration by the said board is necessary and that no alteration of the stated boundaries of the annexation be made by said board.

**Section 7.** The City hereby directs that the zoning map described in Section 1001.04, Subdivision 2, of the Sauk Centre City Code be amended to include property described in Exhibit A, and further that the City amend its land use controls to conform to Chapter 103F as a result of this annexation.

**Section 8.** That Sauk Centre City Clerk is directed to file a certified copy of this ordinance with the following boards and agencies: Minnesota Municipal Board, Sauk Centre Township, Stearns County Auditor and the Minnesota Secretary of State.

**Section 9.** That this ordinance shall be in full force and effect after its publication in the Sauk Centre Herald.

The foregoing ordinance was duly passed and adopted by the City Council of the City of Sauk Centre, Minnesota, at its regular Meeting on the 21st day of February, 1996.

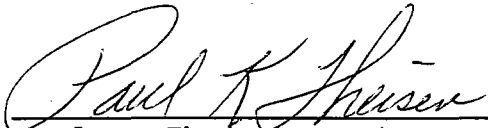
  
\_\_\_\_\_  
Paul K. Theisen - Its Mayor

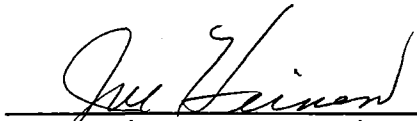
  
\_\_\_\_\_  
Joe Heinen - Its City Clerk

THIS INSTRUMENT WAS DRAFTED BY:

Thomas J. Mayer  
Attorney at Law  
421 Sinclair Lewis Avenue  
Sauk Centre, MN 56378  
#69139

RECEIVED BY  
MMS FEB 29 1996

## EXHIBIT A

That part of the E1/2 of the NW1/4 of the SE1/4 of Section 10, Township 126, Range 34 W., lying South of the centerline of County Road 17; and that part of the E1/2 of the SW1/4 of the SE1/4, Section 10, Township 126, Range 34, Stearns County, Minnesota, lying West of the centerline or tread of the Sauk River Channel; and that part of the W1/2 of the SE1/4 of the SE1/4 of Section 10, Township 126, Range 34, Stearns County, Minnesota, lying West of the centerline or tread of the N1/2 of the NW1/4 of the NW1/4 of Section 15, Township 126, Range 34, excepting the West 800 feet thereof, Stearns County, Minnesota lying West of the centerline or tread of the Sauk River Channel; and that part of the N1/2 of the NE1/4 of the NE1/4 of Section 15, Township 126, Range 34, Stearns County, Minnesota, lying West of the centerline or tread of the Sauk River Channel, all in Stearns County, Minnesota, containing 36.91 acres more or less.

**ANNEXED  
9/95  
79+ ACRES**

APPROVED BY FEB 29 1996  
CITY OF

RIVER

**EXISTING CITY  
BOUNDARY**

**AREA TO  
BE  
ANNEXED**

← 36.91 A

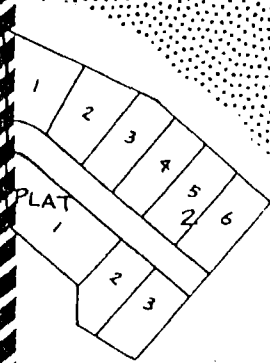

R2

**R1**

SENIOR  
H SCHOOL

11