

REC'D BY MAR 28 1996  
MAR

ORDINANCE NO. 3018

AN ORDINANCE ANNEXING TO THE CITY OF ROCHESTER  
APPROXIMATELY 54.72 ACRES OF LAND LOCATED IN THE  
NORTHEAST QUARTER OF SECTION 30, TOWNSHIP 107  
NORTH, RANGE 13 WEST, OLMSTED COUNTY, MINNESOTA.

THE COMMON COUNCIL OF THE CITY OF ROCHESTER DO ORDAIN:

Section 1. A petition has been filed with the Common Council of the City of Rochester, signed by the owners of land described herein, requesting the Common Council to annex said land to the City of Rochester. The land described in said petition for annexation is located in Haverhill Township, Olmsted County, Minnesota, and is described as follows:

That part of the North Half of the Northeast Quarter of Section 30, Township 107 North, Range 13 West, Olmsted County, Minnesota, described as follows:

Beginning at the northwest corner of said Northeast Quarter; thence southerly on a Minnesota State Plane Grid Azimuth from north of 178 degrees 35 minutes 52 seconds along the west line of said Northeast Quarter 964.16 feet to the center line of old County State Aid Highway No. 2; thence northeasterly 364.05 feet along said center line on a nontangential curve concave southerly, having a radius of 954.93 feet, a central angle of 21 degrees 50 minutes 34 seconds, and a chord azimuth of 78 degrees 24 minutes 17 seconds; thence easterly 89 degrees 19 minutes 34 seconds along said center line 1962.68 feet; thence easterly 345.14 feet along said center line on a tangential curve concave northerly, having a radius of 2938.25 feet and a central angle of 06 degrees, 43 minutes 49 seconds to the east line of said Northeast Quarter; thence northerly 359 degrees 03 minutes 15 seconds azimuth along said east line 867.37 feet to the northeast corner of said Northeast Quarter; thence westerly 269 degrees 29 minutes 46 seconds azimuth along said north line 2670.47 feet to the point of beginning.

Containing 54.72

Section 2. The total quantity of land included in said petition is approximately 54.72 acres in size.

Section 3. On March 18, 1996, the Common Council considered this annexation petition and determined that the land abuts the municipal limits, is less than 200 acres in area, the annexation petition is signed by a majority of property owners of the land described in Section 1, and the land is or will soon become urban or suburban in character.

Section 4. Therefore, pursuant to Minn. Stat. §414.033, subd. 5, the land described in Section 1 above is hereby annexed, added to and made a part of the City of Rochester, Minnesota, as effectually as if it had originally been a part thereof.

Section 5. Present and future owners of the lands annexed by this ordinance are hereby notified that in addition to the usual assessments,

RECEIVED BY  
MMR MAR 28 1996

it is the intention of the Common Council to assess against benefitted property all or a portion of the cost of any storm sewer, water tower, pumping station, and trunk line sanitary sewer construction, heretofore or hereafter undertaken to serve the area annexed.

Section 6. This ordinance shall take effect and be in force from and after its official publication and from and after the filing of a certified copy hereof with the Minnesota Municipal Board, the Haverhill Town Clerk, the County Auditor, and the Secretary of State.

PASSED AND ADOPTED BY THE COMMON COUNCIL OF THE CITY OF ROCHESTER, MINNESOTA, THIS 18TH DAY OF MARCH, 1996.

John Hunkeler  
PRESIDENT OF SAID COMMON COUNCIL

ATTEST: Nicky Kay (Drew)  
ACTING CITY CLERK

APPROVED THIS 19TH DAY OF MARCH, 1996.

Charles J. Confield  
MAYOR OF SAID CITY

(Seal of the City of  
Rochester, Minnesota)

ord\annex96.5

# ANNEXATION MAP

REC'D. BY MAR 28 1996  
M M R

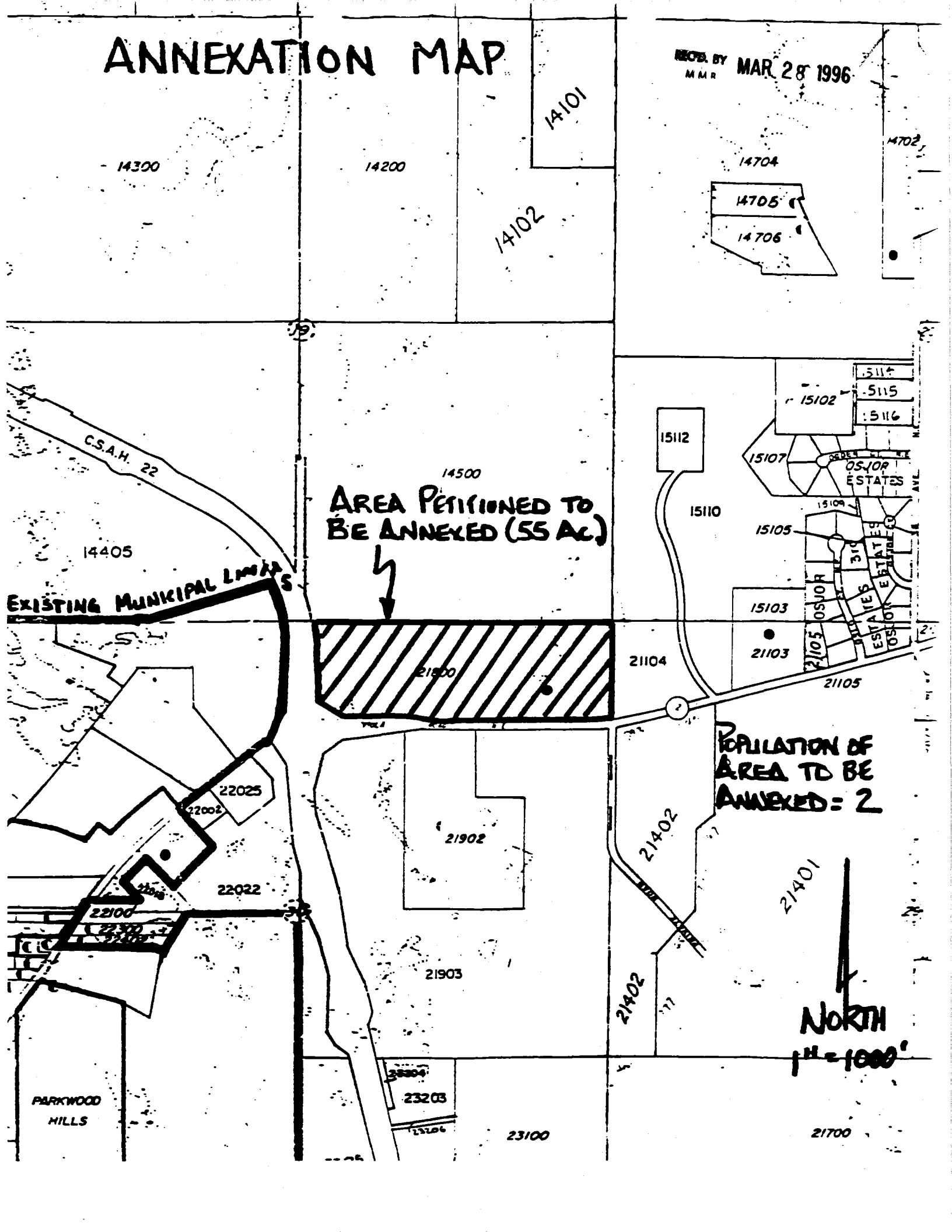

AREA PETITIONED TO  
BE ANNEXED (55 AC.)

POPULATION OF  
AREA TO BE  
ANNEXED: 2

NORTH

1" = 1000'

PARKWOOD  
HILLS