

ORDINANCE NO. 314

**AN ORDINANCE EXTENDING THE CORPORATE
LIMITS OF THE CITY OF CAMBRIDGE
AND AMENDING ORDINANCE NO. 310**

AN ORDINANCE extending the Corporate limits of the City of Cambridge to include certain unincorporated territory abutting upon the limits of the City and consisting of 60 acres or less for which a Petition for Annexation has been received from all property owners of the land.

WHEREAS, the territory described below is not presently within the corporate limits of any incorporated City;

WHEREAS, this territory abuts upon the corporate limits of the City along the West line of the property and is deemed to be urban or suburban in character or about to become so;

WHEREAS, this territory consists entirely of an area totaling 60 acres or less;

WHEREAS, the municipality has received a valid Petition for Annexation from all the property owners of said land;

WHEREAS, the population of said area to be annexed is zero (0);

WHEREAS, the area to be annexed is not presently sewed by public sewer facilities or public sewer facilities are not otherwise available; and

WHEREAS, the City of Cambridge has conducted a public hearing and given 30 days written notice by certified mail to Isanti Township and all landowners within and contiguous to the area to be annexed.

The City Council of Cambridge ordains:

SECTION 1. TERRITORY ANNEXED

REC'D BY
M M R
DEC 26 1995

The corporate limits of the City of Cambridge are hereby extended to include the unplatted territory described as follows, which territory abuts the municipality, consists of 60 acres or less, and for which the municipality has received a valid Petition for Annexation from all the owners of said land:

The North 660 feet of that part of Government Lot 6 lying East of the West One-half of the Southwest Quarter of the Northeast Quarter (W 1/2 of SW 1/4 of NE 1/4) of Section 7, except the North 3 rods thereof, and a strip of land for road purposes, described as the South 1 rod of the North 3 rods of that part of the SE 1/4 of the NW 1/4 lying East of the Township Road and also the South 1 rod of the North 3 rods of Lot 6, all in Section 7, Township 35, Range 23.

ALSO:

The NW 1/4 of the SW 1/4 of the NE 1/4 of Section 7, Township 35, Range 23, excepting the North 3 rods therefrom lying east of the Township road of said Section

The above-described parcel consists of approximately 23.94 acres.

SECTION 2. FILING

The City Clerk-Administrator is directed to file certified copies of this Ordinance with the Secretary of State, the County Auditor of Isanti County, the Town Clerk of Isanti Township and the Minnesota Municipal Board.

SECTION 3. EFFECTIVE DATE OF ANNEXATION

This Ordinance takes effect upon its passage and publication and the filing of certified copies as directed in Section 2 and final approval by the Minnesota Municipal Board.

ADOPTED BY THE CITY OF CAMBRIDGE, MINNESOTA, NOVEMBER 20, 1995.

CITY OF CAMBRIDGE

By: [Signature]
Its: Mayor

ATTEST:

By: Scott G. Larson
Its: Clerk-Admin.

PUBLISHED IN _____ ON _____, 1995.

THIS INSTRUMENT WAS DRAFTED BY:

Jimmy A. Lindberg
PARKER, SATROM, O'NEIL,
LINDBERG & MCKINNIS, P.A.
123 South Ashland
Cambridge, MN 55008
(612) 689-3000
ID NO.: 63290

I, Scott G. Larson, Clerk-Administrator for the City of Cambridge, do hereby certify that I have compared the copy of this Ordinance with the original on file and of record in my office and that it is a true and correct copy thereof.

CITY OF CAMBRIDGE
By: Scott G. Larson
Scott G. Larson
Its: Clerk-Administrator

REC'D. BY
MMR
DEC 26 1995

A-90-58
ORD. 241
O.D. 40244
5-3-90

GOV'T. LOT 6

River

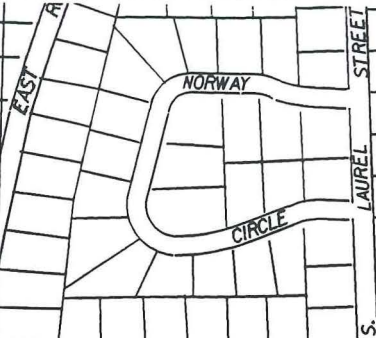

A
ORD. 300
A-5487
3-16-95

C

D

E

F

G

A-90-58
ORD. 241
O.D. 40244
5-8-90

GOV'T. LOT 5

Existing City Limits

Rum

A-80-158
ORD. 236
O.D. 13984
12-20-89
A-4666

A-90-27
ORD. 238
O.D. 40141
3-15-90
A-4686

ORD. 314

NEW

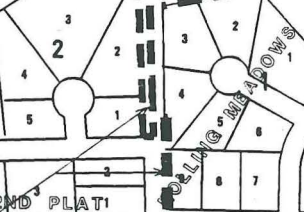

RUM VIEW TERRACE 2ND PLAT

A-83-148
A-5136
ORD. 275
O.D. 8302807
7-29-93

DRIVE

312TH AVE. N.E.

WILD RIVER ADD.

POLK ST. N.E.

40TH AVE. S.W.

City of
Cambridge

7

