

**AN ORDINANCE PROVIDING FOR
THE ANNEXATION OF CERTAIN
PROPERTIES TO THE CITY OF BRAINERD**

Ordinance No. 1003

THE COUNCIL OF THE CITY OF BRAINERD DOES ORDAIN:

SECTION ONE. That Roger and Harriet Piehl, the fee owners of certain property in the County of Crow Wing, State of Minnesota, described as follows:

The southwest quarter of the southeast quarter of Section 33, Township 134 N., Range 28 W., except the north thirty (30) feet thereof, Crow Wing County, Minnesota

filed a petition with the Council of the City of Brainerd on September 11, 1995 requesting that said realty be annexed to the City of Brainerd pursuant to Section 414.033, Subdivision 2 (3) of the Minnesota Statutes.

SECTION TWO. That said realty abuts the City of Brainerd and is less than 60 acres in size.

SECTION THREE. That Council of the City of Brainerd deems the annexation of said realty to the City of Brainerd to be in the best interests of the City of Brainerd and the territory affected and, accordingly, said realty is hereby annexed to the City of Brainerd so as to become and be apart of the City of Brainerd and included within its corporate limits and boundaries thereof.

SECTION FOUR. This ordinance shall take effect and be in force one week from and after its publication.

Adopted this 16th day of October, 1995.

REC'D. BY OCT 23 1995
M A C



JAMES E. WALLIN
President of the Council

Approved this 17th day of October, 1995.

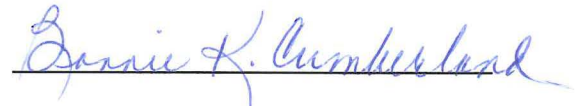

BONNIE K. CUMBERLAND
Mayor

ATTEST:



DANIEL J. VOGT
City Administrator

Published One Time: October 23, 1995

Existing

Land To
Be Annexed
(Piehl)

City of
Brainerd

Unorganized
Territory

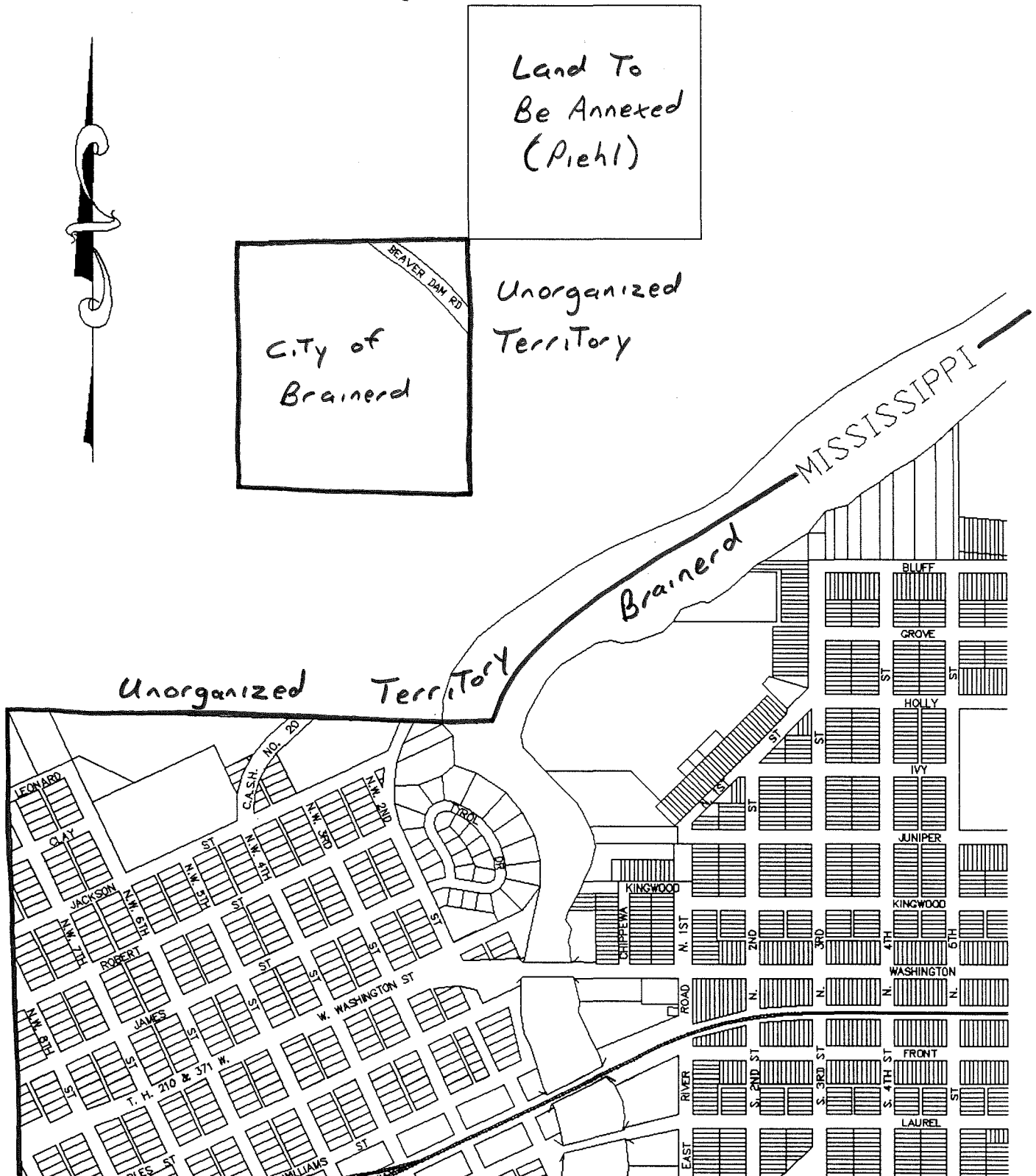

Proposed

