

REC'D. BY AUG 17 1995  
M M R

**PUBLICATION NO. 4855**  
**ORDINANCE NO. 95-157**

**AN ORDINANCE EXTENDING THE CORPORATE LIMITS OF THE CITY OF HUTCHINSON  
TO INCLUDE CERTAIN UNINCORPORATED LAND COMPLETELY SURROUNDED BY LAND  
WITHIN THE CITY LIMITS AND ABUTTING THEREON PURSUANT TO MINNESOTA STATUTES  
414.033, SUBDIVISION 2(2)**

WHEREAS, certain territory described below is not presently included within the corporate limits of any incorporated city; and

WHEREAS, this territory is completely surrounded on all sides by lands already included within the corporate limits of the city and is deemed to be urban or suburban in character;

NOW, THEREFORE, the City Council of Hutchinson, Minnesota does hereby ordain:

SECTION 1. Territory annexed. The corporate limits of the City of Hutchinson, Minnesota, are hereby extended to include the territory described as follows, which territory now is and has heretofore been completely surrounded by territory already included within the city limits:

- A. All unincorporated areas located within the Northwest Quarter of the Northwest Quarter; the Northeast Quarter of the Northwest Quarter; the Southwest Quarter of the Northwest Quarter; and the Southeast Quarter of the Northwest Quarter, Section 36, Township 117 North, Range 30 West. (0.40± acres)
- B. The Westerly 20 feet of the South three fourths of the Northwest Quarter of the Southeast Quarter, Section 36, Township 117 North, Range 30 West. (0.45 acres)
- C. All unincorporated areas located within the Southwest Quarter of the Southwest Quarter, Section 32, Township 117 North, Range 29 West. (0.25± acres)
- D. All unincorporated areas located within the following described property located in Section 7, Township 116 North, Range 29 West: The West one-half of County Road 25 lying south of Lot 9, Auditors Plat of Lot 15 of the Auditors Plat of Section 7, Township 116 North, Range 29 West, and lying north of the north line of and its easterly prolongation of Tract "S" in Registered Land Survey Number 1. (0.40± acres)

SECTION 2. The total area is 1.50± acres.

SECTION 3. The property is urban in nature.

SECTION 4. The corporate limits of the City of Hutchinson are hereby extended to include the Property and the same is hereby annexed to and included within the City of Hutchinson as if the property had originally been part thereof.

SECTION 5. The City Administrator is directed to file certified copies of this ordinance with the Minnesota Municipal Board, Acoma Township, Hutchinson Township, Hassan Valley Township, the McLeod County Auditor, and the Minnesota Secretary of State.

SECTION 6. This ordinance takes effect upon its passage and publication and the filing of the certified copies as directed in Section 4 and approval of the Ordinance by the Minnesota Municipal Board.

Adopted this 8th day of August, 1995.

ATTEST:

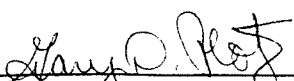
  
\_\_\_\_\_  
Gary D. Plotz  
City Administrator

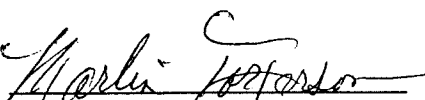
  
\_\_\_\_\_  
Marlin Torgerson  
Mayor

REC'D. BY AUG 17 1995  
M M R

- 1. SPRUCE CT.
- 2. PINEHURST LA.
- 3. E. PINEHURST LA.
- 4. E. PINEHURST LA.

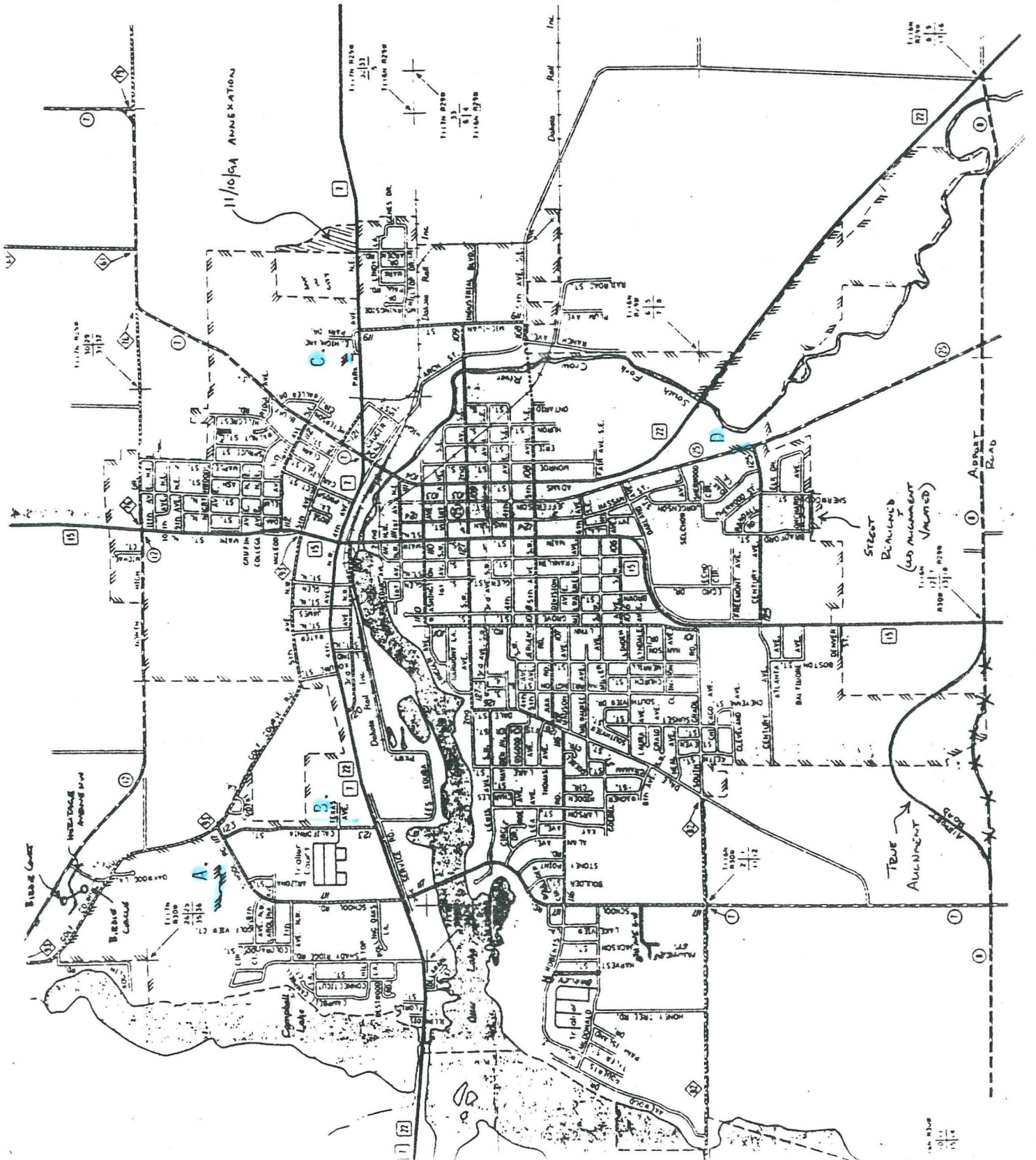

Street Relined  
(as shown)

True Alignment

11/10 GA ANNEXATION



Parcel D - Sect. 7,  
Twp. 116N, Range 29W

I-1

REC'D BY AUG 17 1995  
E M R

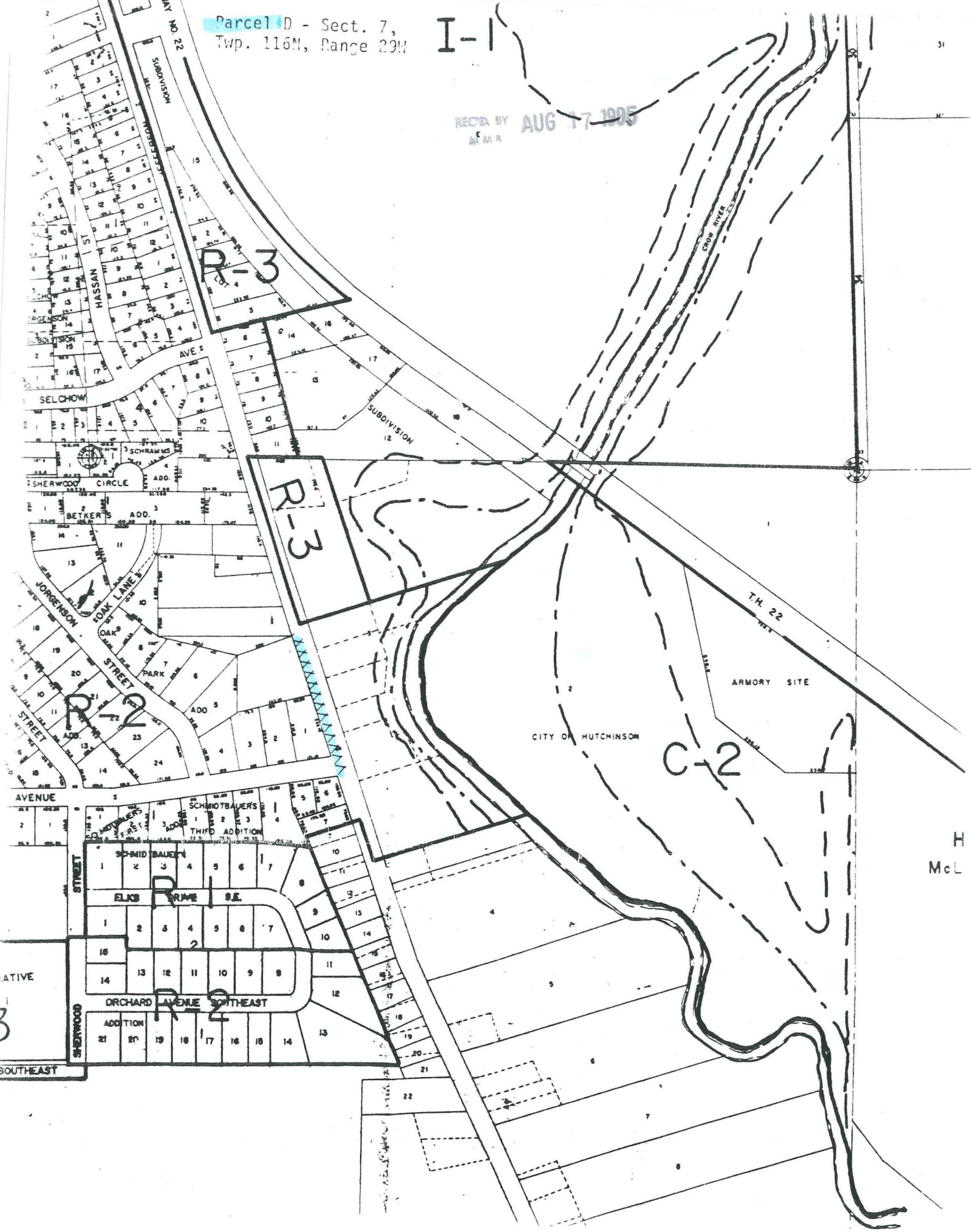

H  
McL

Parcel B - Sect. 36, Twp. 117N, Range 30W

REC'D BY AUG 17 1995  
M M R

