

AN ORDINANCE ANNEXING TO THE CITY OF WINSTED, MINNESOTA CERTAIN LANDS IN WINSTED TOWNSHIP ABUTTING THE CITY, BEING A PART OF LOT 1, SECTION 3, TOWNSHIP 117 NORTH, RANGE 27 WEST, McLEOD COUNTY, MINNESOTA.

THE CITY COUNCIL OF WINSTED DOES ORDAIN:

Section 1. The City of Winsted having received the Petition of JAMES R. FIECKE and SANDRA K. FIECKE, husband and wife, MARK A. OLLIG, a single person, and LARRY J. VEALETZEK and TAMMRA VEALETZEK, husband and wife, who are the owners of certain lands as per attached Exhibit "A", which is incorporated herein by reference as though fully set forth in full, which abut upon the present territorial limits of the City of Winsted, and the City Council of the City of Winsted desires to annex such lands so as to include said lands within the City of Winsted, County of McLeod and State of Minnesota and to further adopt an Ordinance annexing said land to the City of Winsted. Such parcel of land is located in Winsted Township, McLeod County, Minnesota and is described as per attached Exhibit "A" which is incorporated herein by reference as though fully set forth in full.

Section 2. The Mayor and the Council of the City of Winsted do hereby determine that the land described in Section 1 above abuts upon the present territorial limits of the City of Winsted, and is urban in character, and the annexation of said land will be to the best interest of the City of Winsted and the territory affected.

Section 3. Therefore, the lands referred to in Section 1 above and legally described in Section 1 above, are hereby annexed, added to and made a part of the City of Winsted, as effectually as if it had originally been a part thereof.

Section 4. Both the City of Winsted, Minnesota and the Township of Winsted, Minnesota have executed Waivers of the statutory 90-day period before a City Ordinance of Annexation can be adopted.

Section 5. This Ordinance shall take effect and be in force from and after its official publication and from and after the filing of a certified copy hereof with the Minnesota Municipal Board, the Clerk of Winsted Township, the McLeod County Auditor and the Secretary of State of Minnesota.

Passed by the City Council this 2nd day of January, 1996.

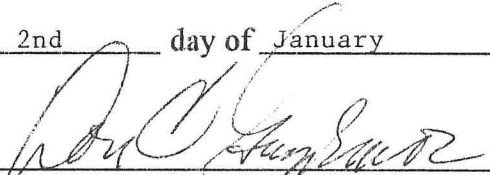
Don C. Guggemos, Mayor

Attest:

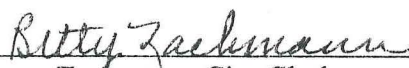
Betty Zachmann, City Clerk

REC'D. BY FEB 20 1996
M A D

EXHIBIT "A"

James R. Fiecke and Sandra K. Fiecke, husband and wife, are the fee owners to the following described parcels:

That part of Government Lot 1, Section 3, Township 117 North, Range 27 West, McLeod County, Minnesota described as follows:

Commencing at the Southeast corner of said Government Lot 1; thence Westerly, along the South line of said Government Lot 1 a distance of 1284.59 feet; thence Northerly, parallel with the East line of said Government Lot 1 a distance of 535.54 feet to the point of beginning of the land to be described; thence continuing Northerly along said parallel line 266.81 feet; thence Westerly, parallel with the South line of said Government Lot 1 a distance of 429 feet, more or less, to the shoreline of Grass Lake; thence Southerly, Southwesterly, Westerly and Southwesterly along said shoreline to the South line of said Government Lot 1; thence Easterly along said South line 1628.41 feet, more or less, to a point 1588.81 feet West of the Southeast corner of said Government Lot 1; thence Northerly, along the centerline of Grass Lake Road 535.96 feet to a line drawn from the point of beginning, parallel with the South line of said Government Lot 1; thence Easterly, parallel with said South line 299.78 feet to the point of beginning;

Excepting therefrom all that part of said parcel lying Westerly of the centerline of Grass Lake Road.

AND

That part of Government Lot 1, Section 3, Township 117 North, Range 27 West, McLeod County, Minnesota described as follows:

Commencing at the Southeast Corner of said Government Lot 1; thence Westerly along the South line of said Government Lot 1 a distance of 1284.59 feet; thence Northerly, parallel with the East line of said Government Lot 1 a distance of 149.46 feet to the point of beginning of the land to be described; thence continuing Northerly along said parallel line 386.08 feet; thence Westerly, parallel with the South line of said Government Lot 1 a distance of 299.78 feet to the centerline of Grass Lake Road; thence Southerly, along said centerline 386.48 feet to a line drawn from the point of beginning, parallel with the South line of said Government Lot 1; thence Easterly, parallel with said South line 300.16 feet to the point of beginning.

James R. Fiecke and Sandra K. Fiecke, husband and wife, are the fee owners subject to a Contract for Deed running in favor of Mark A. Ollig, a single person, to the following described parcel:

RECORDED BY
M M R FEB 20 1996

That part of Government Lot 1, Section 3, Township 117 North, Range 27 West, McLeod County, Minnesota described as follows:

Commencing at the Southeast corner of said Government Lot 1; thence Westerly along the South line of said Government Lot 1 a distance of 1284.58 feet to the point of beginning of the land to be described; thence Northerly, parallel with the East line of said Government Lot 1 a distance of 149.46 feet; thence Westerly, parallel with the South line of said Government Lot 1 distance of 300.16 feet to the centerline of Grass Lake Road; thence Southerly, along said centerline 149.48 feet to the South line of said Government Lot 1; thence Easterly along said South line 304.22 feet to the point of beginning.

James R. Fiecke and Sandra K. Fiecke, husband and wife, are the fee owners subject to a Contract for Deed running in favor of Larry J. Vealetzek and Tammra Vealetzek, husband and wife, as joint tenants, to the following described parcel:

That part of Government Lot 1, Section 3, Township 117 North, Range 27 West, McLeod County, Minnesota, described as follows:

Commencing at the Southeast corner of said Government Lot 1; thence Westerly along the South line of said Government Lot 1 a distance of 1284.59 feet; thence Northerly, parallel with the East line of said Government Lot 1 a distance of 802.35 feet to the point of beginning of the land to be described; thence continuing Northerly along said parallel line to a point 370.00 feet South of the North line of said Government Lot 1; thence Westerly, parallel with the North line of said Government Lot 1 a distance of 432 feet, more or less, to the shoreline of Grass Lake; thence Southerly along said shoreline to a line drawn from the point of beginning, parallel with the South line of said Government Lot 1; thence Easterly, parallel with said South line a of distance of 429 feet, more or less, to the point of beginning.

REC'D BY
MMR NOV 27 1995

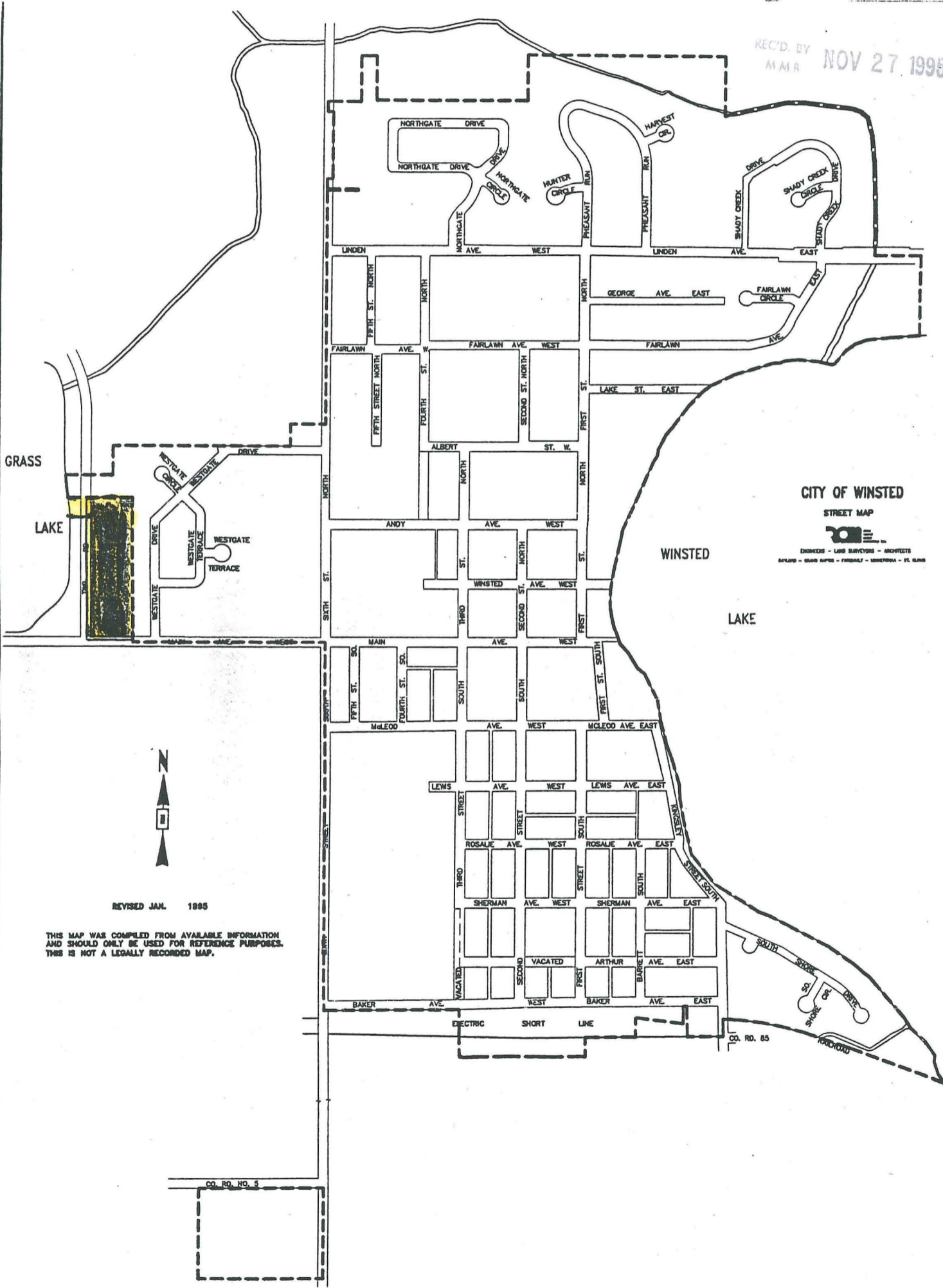

CITY OF WINSTED
STREET MAP
 ENGINEERS - LAND SURVEYORS - ARCHITECTS
 ASPHALT - GRASS - FURNACE - CONCRETE - ST. CLAY

REVISED JAN. 1985

THIS MAP WAS COMPILED FROM AVAILABLE INFORMATION AND SHOULD ONLY BE USED FOR REFERENCE PURPOSES. THIS IS NOT A LEGALLY RECORDED MAP.

REC'D. BY AUG 11 1995
M M R

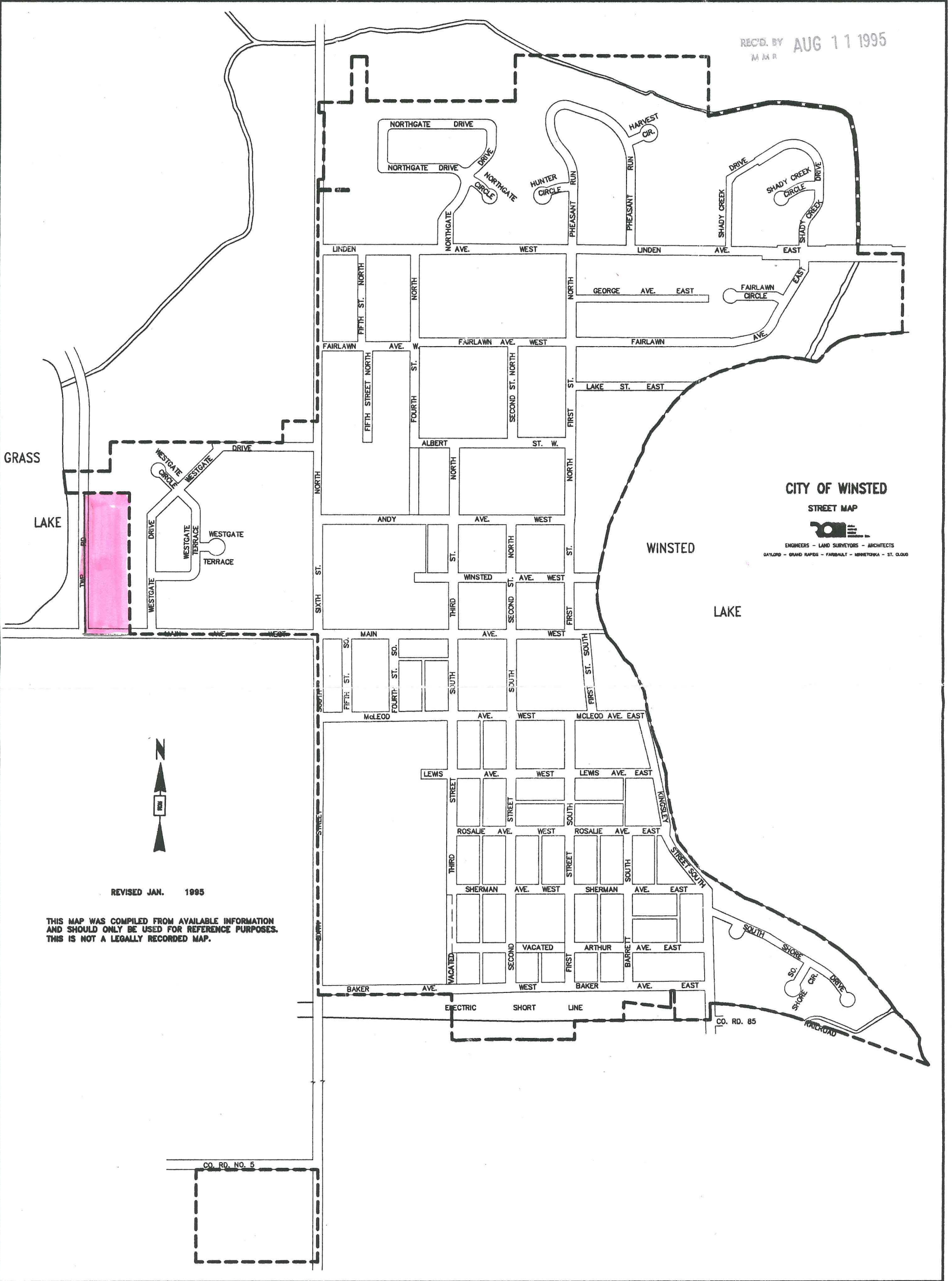

CITY OF WINSTED
STREET MAP

ENGINEERS - LAND SURVEYORS - ARCHITECTS
GAYLORD - GRAND RAPIDS - FAIRBANK - MINNETONKA - ST. CLOUD

REVISED JAN. 1995

THIS MAP WAS COMPILED FROM AVAILABLE INFORMATION
AND SHOULD ONLY BE USED FOR REFERENCE PURPOSES.
THIS IS NOT A LEGALLY RECORDED MAP.

CO. RD. NO. 5

CO. RD. 85

ELECTRIC SHORT LINE

SOUTH SHORE DRIVE
SHORE CR.
RAILROAD

GRASS LAKE

WINSTED

LAKE