

STATE OF MINNESOTA
COUNTY OF McLEOD

PETITION FOR ANNEXATION

I.

The Petitioners, James R. Fiecke and Sandra K. Fiecke, husband and wife, as joint tenants, are the owners of the premises described hereinbelow:

As per attached Exhibit "A" which is incorporated herein by reference as though fully set forth in full.

II.

That said lands described in the preceding paragraph abut the present corporate limits of the City of Winsted. The said lands are unplatted and are approximately 4.50 (more or less) acres in size. No petition for annexation of any part of said lands is presently before the commission. The undersigned Petitioners constitute all of the landowners and parties having an interest in said lands.

III.

The undersigned Petitioners believe that said lands are now or about to become urban or suburban in character and that the annexation of said lands to the City of Winsted would be in the best interest of the City of Winsted.

IV.

This Petition is brought pursuant to Minnesota Statutes Section 414.033, Subd. 5.

WHEREFORE, PETITIONERS PRAY:

I.

That said annexation is approved by the authorities prescribed by law.

REC'D BY
MMR NOV 27 1995

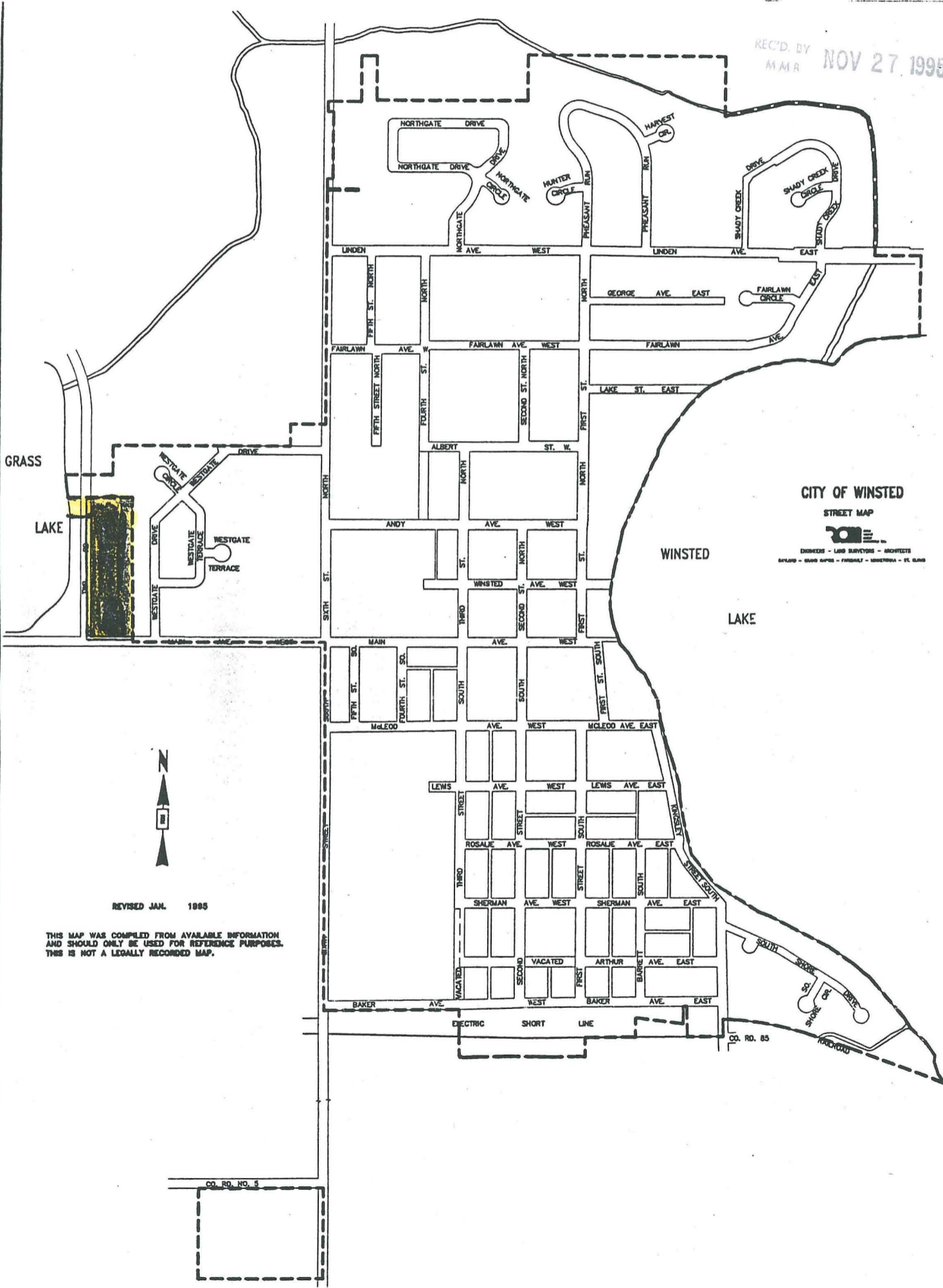

CITY OF WINSTED

STREET MAP



ENGINEERS - LAND SURVEYORS - ARCHITECTS

SURVEYORS - ROAD MAPS - FIDELITY - INSTRUMENTS - ET. PLANS



REVISED JAN. 1985

THIS MAP WAS COMPILED FROM AVAILABLE INFORMATION AND SHOULD ONLY BE USED FOR REFERENCE PURPOSES. THIS IS NOT A LEGALLY RECORDED MAP.

CO. RD. NO. 5

CO. RD. 85

REC'D. BY AUG 11 1995
M M R

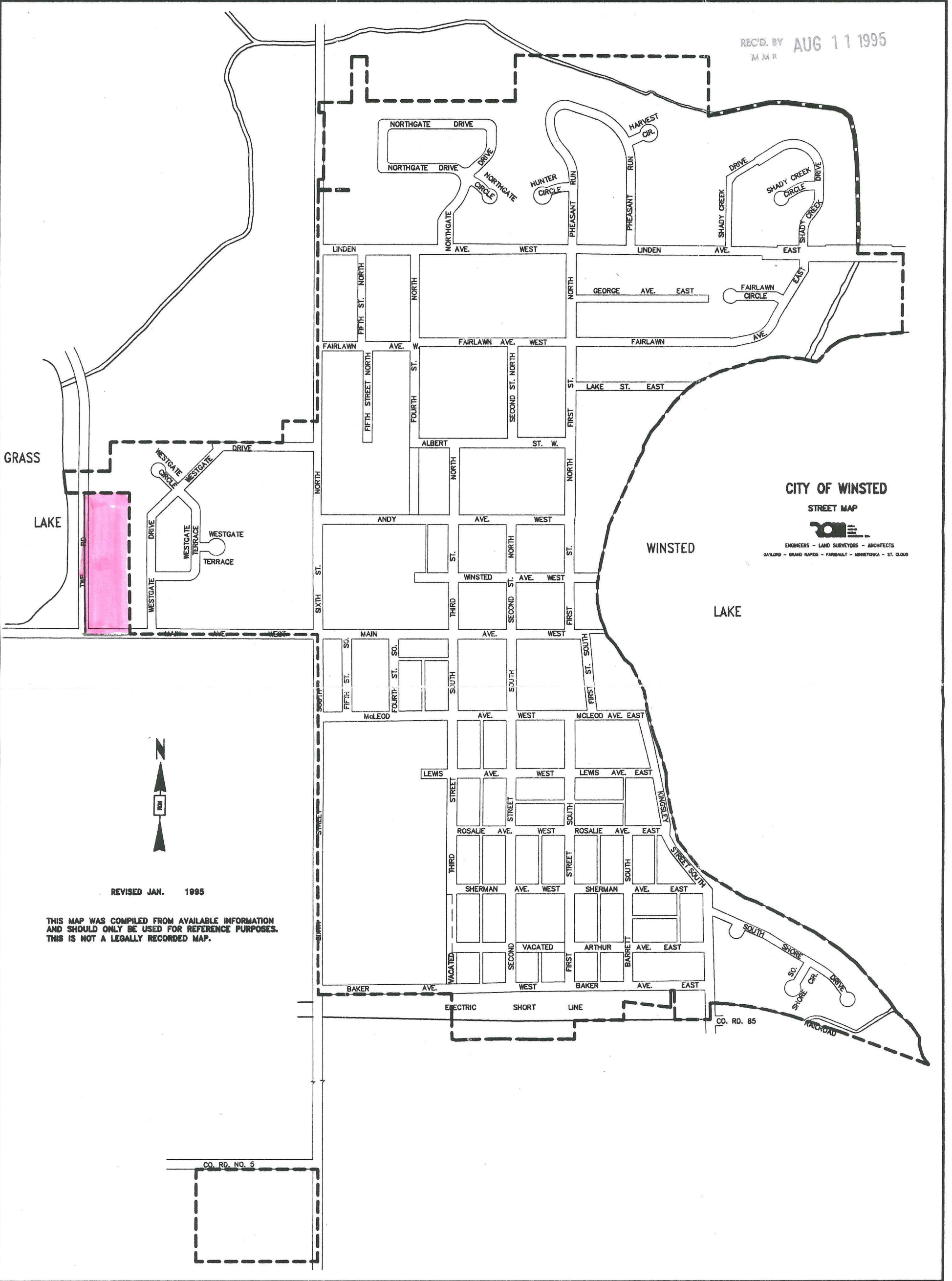

CITY OF WINSTED
STREET MAP

ENGINEERS - LAND SURVEYORS - ARCHITECTS
GAYLORD - GRAND RAPIDS - FAIRBANK - MINNETONKA - ST. CLOUD

REVISED JAN. 1995

THIS MAP WAS COMPILED FROM AVAILABLE INFORMATION
AND SHOULD ONLY BE USED FOR REFERENCE PURPOSES.
THIS IS NOT A LEGALLY RECORDED MAP.

CO. RD. NO. 5

CO. RD. 85