

RECD. BY JUL 13 1995
M M R

CITY OF FOREST LAKE

ORDINANCE NO. 465

AN ORDINANCE EXTENDING THE CORPORATE LIMITS OF THE CITY OF FOREST LAKE TO INCLUDE CERTAIN LAND OWNED BY M & M FINANCIAL COMPANY.

WHEREAS, M & M Financial Company has filed a Petition dated November 14, 1994 requesting that certain land situated in the County of Washington, State of Minnesota, described as follows:

Those parts of Governments Lots 2 and 3, Section 18, Township 32 North, Range 21 West, Washington County, Minnesota, described jointly as follows:

Commencing at the north quarter corner of said Section 18; thence South 0 degrees 37 minutes 05 seconds East, assumed bearing along the west line of said Government Lot 3, a distance of 795.74 feet to the point of beginning at an iron monument found on the easterly right-of-way line of Interstate Highway No. 35; thence continue South 0 degrees 37 minutes 05 seconds East, along said west line, a distance of 735.98 feet to an iron monument found; thence South 88 degrees 54 minutes 11 seconds East, 27.02 feet to an iron monument set; thence North 1 degree 30 minutes 19 seconds West, 209.95 feet to an iron monument set; thence North 56 degrees 38 minutes 50 seconds East, 440.90 feet to an iron monument set; thence North 71 degrees 14 minutes 40 seconds East, 403.23 feet to an iron monument set; thence North 80 degrees 37 minutes 38 seconds East, 502.64 feet to an iron monument set; thence South 89 degrees 57 minutes 53 seconds East, 351.25 feet to an iron monument set; thence North 1 degree 47 minutes 04 seconds West, 19.96 feet to an iron monument set; thence South 89 degrees 57 minutes 53 seconds East, 100.00 feet to an iron monument set; thence South 1 degree 47 minutes 04 seconds East, 19.96 feet to an iron monument set; thence South 89 degrees 57 minutes 52 seconds East, 201.92 feet to an iron monument set; thence South 1 degree 20 minutes 56 seconds East, 2.70 feet to an iron monument set; thence North 85 degrees 35 minutes 57 seconds East, 185.46 feet to an iron monument found; thence North 83 degrees 03 minutes 11 seconds East, 53.00 feet to an iron monument set; thence North 81 degrees 13 minutes 46 seconds East, 136.75 feet to an iron monument set; thence North 75 degrees 53 minutes 49 seconds East, 110.59 feet to an iron monument set; thence North 66 degrees 53 minutes 03 seconds East, 257.65 feet to an iron monument set at the point of intersection with the east line of said Government Lot 2; thence North 0 degrees 49 minutes 50 seconds West along said east line, a distance of 765.53 feet to the northeast corner of said Section 18; thence South 88 degrees 37 minutes 29 seconds West, along the north line of said Government Lot 2, a distance of 1321.43 feet to the northwest corner of Government Lot 2; thence South 0 degrees 43 minutes 28 seconds East along the west line of Government Lot 2, a

distance of 50.03 feet to an iron monument set; thence continuing South 0 degrees 43 minutes 28 seconds East, along said west line, a distance of 618.26 feet to an iron monument set at the southeast corner of the North 668.25 feet of said Government Lot 3; thence south 88 degrees 37 minutes 29 seconds West, along the south line of said North 668.25 feet, a distance of 1275.68 feet to an iron monument set at the point of intersection with the easterly right-of-way line of Interstate Highway No. 35; thence South 19 degrees 31 minutes 46 seconds West, along said right-of-way line, a distance of 136.40 feet to the point of beginning.

be annexed to the City of Forest Lake, and

WHEREAS, M & M Financial Company represents that it is the sole owner of the property, that the property is unincorporated, abuts the City limits of the City of Forest Lake, is not included within any other municipality, is not included in any area that has already been designated for orderly annexation pursuant to M.S. 414.0325 and is approximately 34 acres in size.

NOW THEREFORE, the City of Forest Lake, Minnesota does hereby ordain:

1. The City Council hereby determines and finds that the property abuts the City, that the area to be annexed is less than 60 acres, that the property is not included in any area that has already been designated for orderly annexation pursuant to M.S. 414.0325, that the City has received a properly prepared Petition for Annexation from all of the owners of the property and that the Petition complies with all of the provisions of M.S. 414.033.
2. The property is urban or suburban in nature or about to become so and is in need of city water and other city services.
3. Pursuant to M.S. 414.033, Subd. 2(3) the corporate limits of the City of Forest Lake are hereby extended to include the property and the same is hereby annexed to and included within the City of Forest Lake as if the property had originally been a part thereof.
4. The City Coordinator is directed to file certified copies of this ordinance with the Minnesota Municipal Board, Forest Lake Township, the Washington County Auditor and the Minnesota Secretary of State.
5. This ordinance takes effect upon its passage and publication and the filing of the certified copies as directed in Section 4 and approval of the ordinance by the Minnesota Municipal Board.

REC'D BY JUL 13 1995
CITY CLERK

Passed and adopted by the City Council, City of Forest Lake,
Minnesota this 26th day of June, 1995.

City of Forest Lake

By *Gary H Moen*
Gary Moen
Acting Mayor

ATTEST:

Charles P. Robinson
Charles P. Robinson
City Clerk

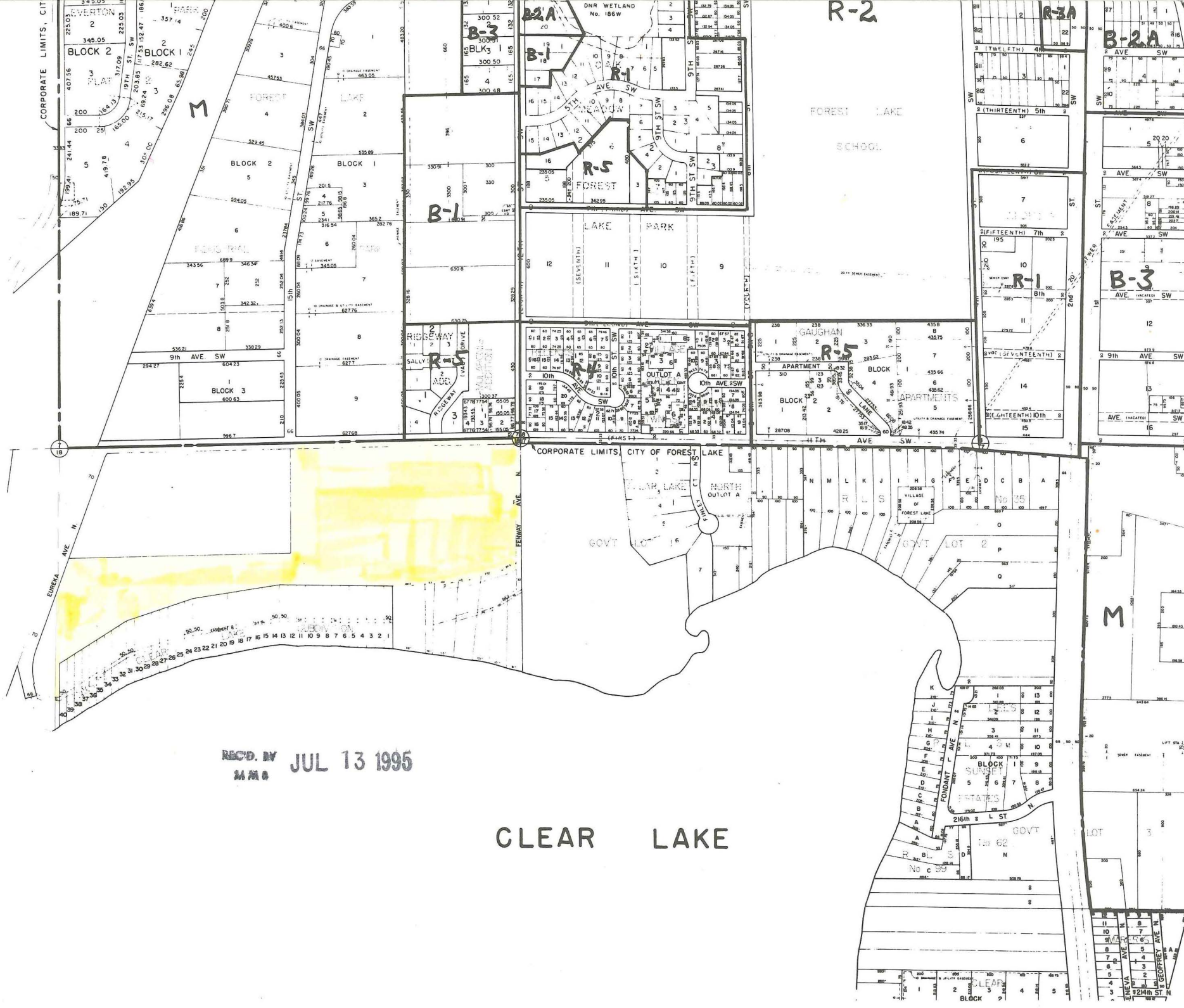

REC'D. BY JUL 13 1995
M M B

CLEAR LAKE