

PETITION FOR ANNEXATION IN ACCORDANCE
WITH MINNESOTA STATUTES, CHAPTER 414.033

TO THE CITY COUNCIL OF THE CITY OF WATKINS, MINNESOTA:

We, the undersigned, all of the owners of the territory described below, hereby request the council to annex this territory to the city and to extend the city boundaries to include the same, and for that purpose respectfully state:

1. The territory to be annexed consisting entirely of lands which are unplatted and do not exceed 200 acres in area and the description of such lands are as follows:

That part of the South 408.00 feet of the Southeast Quarter of the Northeast Quarter (SE1/4 of the NE1/4) of Section 2, Township 121, Range 30, Meeker County, Minnesota, which lies east of the West 555.00 feet of said SE1/4 of NE1/4 and which lies west of the following described line: Said line commencing at the southeast corner of said SE1/4 of NE1/4; thence on an assumed bearing of West along the south line thereof, a distance of 486.44 feet and this being the point of beginning of the line to be described, thence North 04 degrees 04' West, a distance of 409.03 feet, to the north line of said South 408.00 feet and said line terminating thereat, AND

That part of said SE1/4 of NE1/4 which lies within 16.50 feet easterly of the following described line: Said line commencing at the southeast corner of said SE1/4 of NE1/4; thence on an assumed bearing of West along the south line thereof, a distance of 486.44 feet to the point of beginning of the line to be described; thence North 04 degrees 04' West, a distance of 276.40 feet and said line terminating thereat; all of the above containing 2.3 acres, more or less, and being subject to the right of way of an existing public road along the south line thereof, and being subject to easements of record, if any; AND

subject to an ingress and egress easement over the following part of the above described tract:

That part of said SE1/4 of NE1/4 which lies within 16.50 feet easterly of the following described line: Said line commencing at the southeast corner of said SE1/4 of NE1/4; thence on an assumed bearing of West along the south line thereof, a distance of 486.44 feet to the point of beginning of the line to be described; thence North 04 degrees 04' West, a distance of 276.40 feet and said line terminating thereat.

2. The territory described above abuts upon the city limits on the easterly boundary thereof and none of it is presently included within the corporate limits of any incorporated city.
3. All of this territory is or is about to become urban or suburban in character.

4. The present population of the area to be annexed is zero.

Dated this 20 day of April, 1995.

Richard F. Schmitt
Richard Schmitt

Helen Schmitt
Helen Schmitt

JOINT RESOLUTION OF WAIVER

The Forest Prairie Township and the City of Watkins which are the only municipalities within or abutting the above described property with the right to object to the above Petition Annexation hereby jointly resolve:

1. That they acknowledge having received a copy of the foregoing Petition for Annexation herein, filed pursuant to Minnesota Statutes, Chapter 414.033.
2. Hereby, upon proper governing body resolution having no objections to the proposed Annexation waive their rights to object to the proposed Annexation and further waive the ninety (90) day period before which an Annexation Ordinance may be adopted, said Waiver being in accordance with Minnesota Statutes, Chapter 414.033, Subd. 6.
3. Hereby, upon proper governing body resolution, agree and authorize the City Council of the City of Watkins to forthwith annex the property referred to in the foregoing Petition for Annexation, to be within its corporate limits, by Ordinance without further notice.

Approved upon proper Resolution by the Board of Supervisors of Forest Prairie Township, Meeker County, Minnesota, this 24th day of April, 1995.

Don J. Kuuba
Forest Prairie Board Chairman

Robert G. Grogan
Forest Prairie Town Clerk

REC'D. BY JUN 16 1995
AM AM

Approved upon proper Resolution by the City Council of the City of Watkins this
8th day of June, 1995.

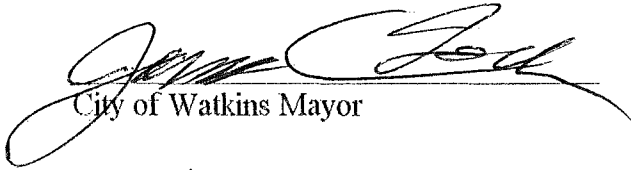

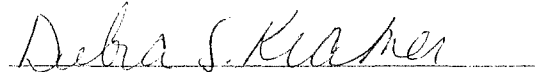
City of Watkins Mayor

City of Watkins Clerk

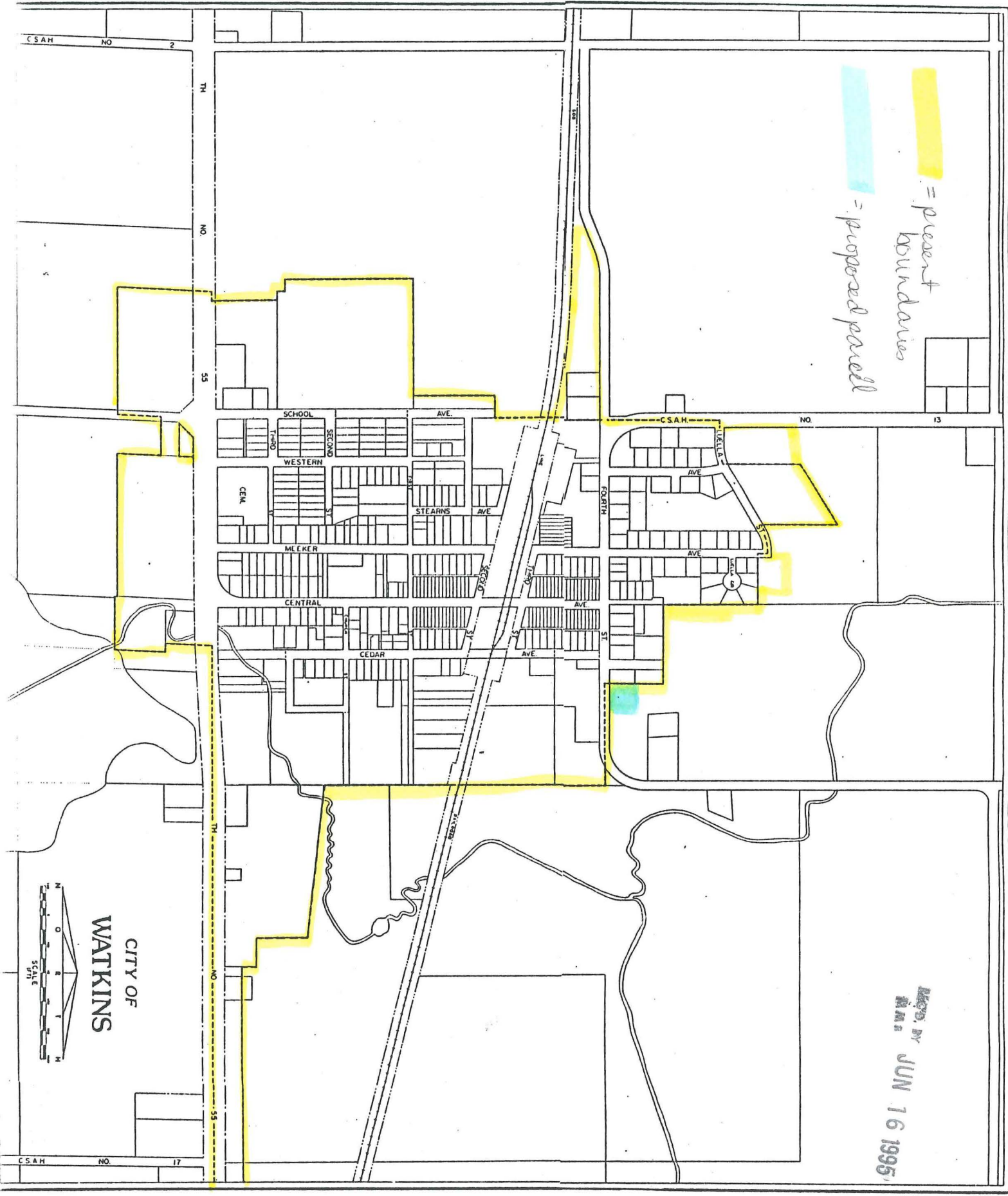
 = present boundaries
 = proposed parcel

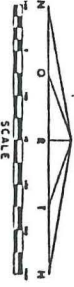

CITY OF
WATKINS



REC'D. BY
M.M. JUN 16 1995