

ORDINANCE NO. 95-1

AN ORDINANCE EXTENDING THE CORPORATE LIMITS OF THE CITY OF WATKINS TO INCLUDE CERTAIN UNINCORPORATED UNPLATTED LAND NOT EXCEEDING 200 ACRES IN AREA ABUTTING UPON THE CITY LIMITS.

WHEREAS, a certain petition dated Feb. 9th, 1995, requesting annexation of the territory hereinafter described was duly presented to the council on the 9th day of February, 1995; and

WHEREAS, the petition was signed by all owners;

WHEREAS, the City of Watkins and the Forest Prairie Township have waived the right to object to said annexation and no other municipality has boundaries which abut upon the boundaries of the land to be annexed; and

WHEREAS, no hearing is required to be held by the governing body of the City of Watkins, Minnesota, on the proposed annexation; and

WHEREAS, the land described in the petition abuts upon the city limits at the northerly boundaries thereof;

The council of the City of Watkins, Minnesota, ordains:

SECTION 1. The city council hereby determined (1) that the territory described herein abuts upon the city limits and is about to become urban or suburban in character; and (2) that none of the territory is now included within the limits of any city.

SECTION 2. Territory Annexed. The corporate limits of the city are hereby extended to include the unplatted land described as follows and the same is hereby annexed to and included within the city as effectually as if it had originally been a part thereof.

REC'D. BY MAR 13 1995
MMB

That part of the East Half of the Southwest Quarter (E1/2 of SW1/4) of Section Two (2), Township One Hundred Twenty-one (121), Range Thirty (30), which lies northerly of the northerly line of the Sioux Line Railroad and which lies southerly of the public highway, all in Meeker County, Minnesota.

SECTION 3. Filing. The city clerk is hereby directed to file certified copies of this ordinance with the Minnesota Municipal Board, the Secretary of State, the Town Clerk, and the County Auditor.

SECTION 4. Effective Date. This ordinance takes effect upon its passage and publication and the filing of the certified copies as directed in Section 3, and approval of the ordinance by the Minnesota Municipal Board.

Adopted by the council this 9th day of March, 1995.

Mary Ellen Spoder
Mayor - Acting

ATTEST:

Debra Korman
Clerk

— Present Boundary
= Proposed Parcel

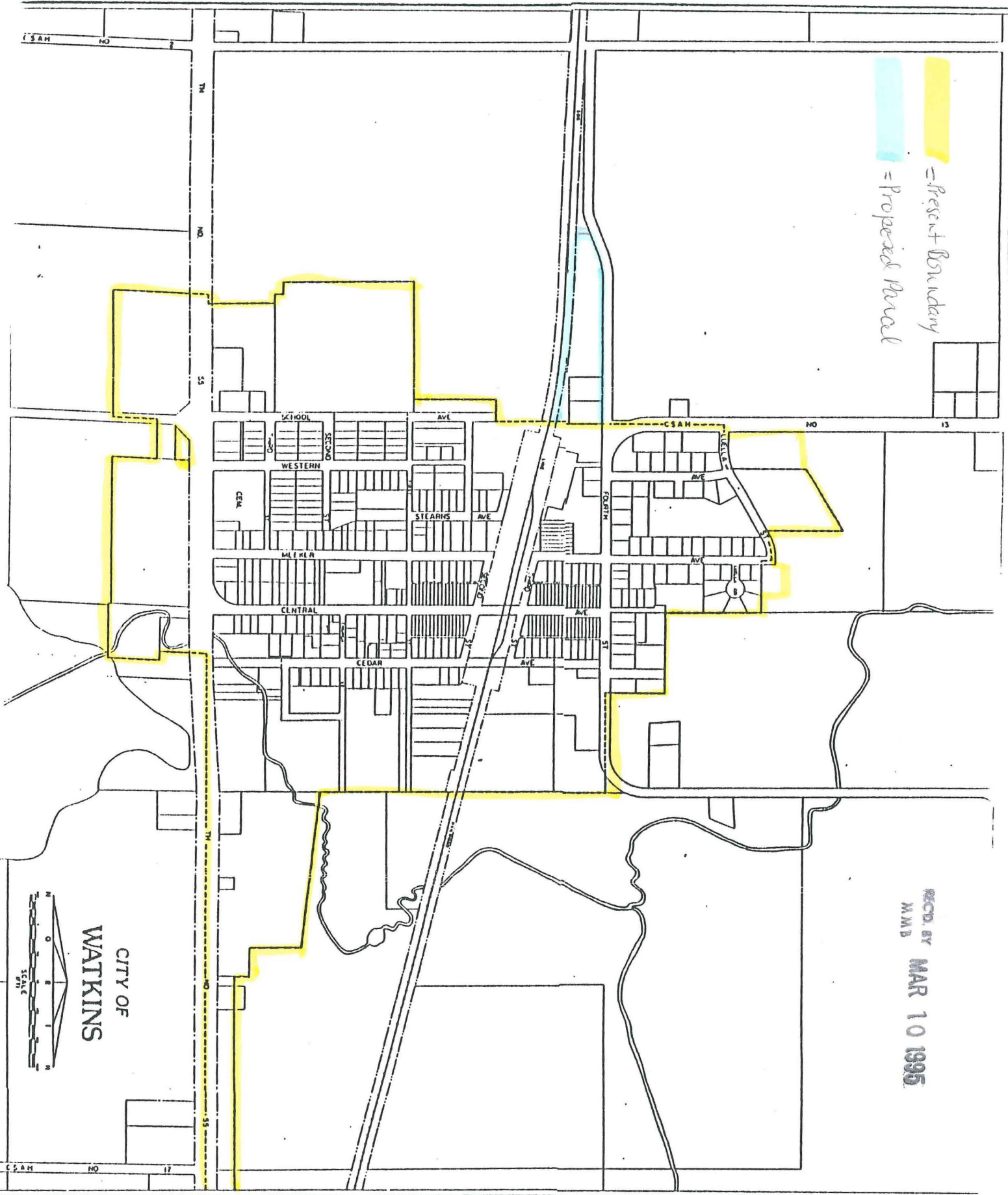

REC'D. BY
M.W.B.
MAR 10 1995

CITY OF
WATKINS

