

PETITION FOR ANNEXATION IN ACCORDANCE
WITH MINNESOTA STATUTES, CHAPTER 414.033

TO THE CITY COUNCIL OF THE CITY OF WATKINS, MINNESOTA:

We, the undersigned, all of the owners of the territory described below, hereby request the council to annex this territory to the city and to extend the city boundaries to include the same, and for that purpose respectfully state:

1. That territory to be annexed consisting entirely of lands which are unplatted and do not exceed 200 acres in area and the description of such lands are as follows:

That part of the East Half of the Southwest Quarter (E1/2 of SW1/4) of Section Two (2), Township One Hundred Twenty-one (121), Range Thirty (30), which lies northerly of the northerly line of the Sioux Line Railroad and which lies southerly of the public highway, all in Meeker County, Minnesota.

2. The territory described above abuts upon the city limits on the westerly boundary thereof and none of it is presently included within the corporate limits of any incorporated city.
3. All of this territory is or is about to become urban or suburban in character.
4. The present population of the area to be annexed is zero.

Dated this 9th day of February, 1995.

James O. Loch

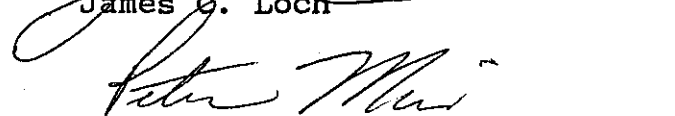
Peter Mies

— Present Boundary
= Proposed Parcel

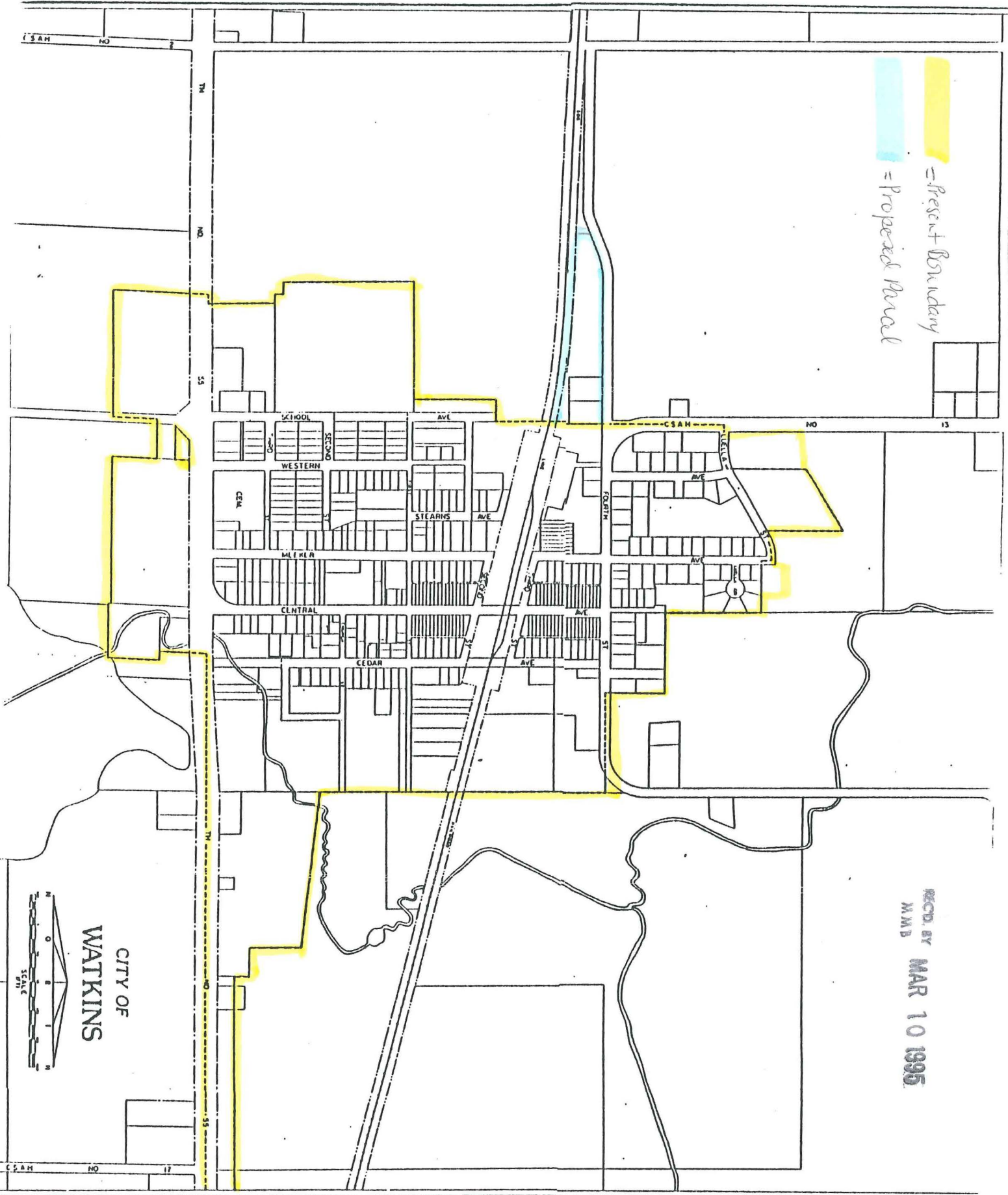

CITY OF
WATKINS
SCALE

RECD. BY
M.W.B.
MAR 10 1995