

AN ORDINANCE ANNEXING CERTAIN UNINCORPORATED PROPERTY  
ABUTTING THE CITY OF STAPLES  
PURSUANT TO MINNESOTA STATUTES SECTION 414.033

WHEREAS, the City of Staples has studied its municipal borders and the City's growth patterns and the City further desires to promote orderly growth and provide municipal services in an efficient manner; and

WHEREAS, the property which is the subject of this annexation abuts the municipality, and the area to be annexed is less than 60 acres, and the municipality has received a petition for annexation from all of the property owners of the land; and

WHEREAS, the City finds that the property proposed for annexation is or about to become urban or suburban in character and the annexation by the City of Staples is required to protect the public health, safety and welfare and the annexation is in the best interests of the property proposed for annexation; and

WHEREAS, the City held a public hearing concerning the annexation on December 6, 1994 following 30 days written notice by certified mail to the township affected by the proposed ordinance and to all landowners within and contiguous to the area being annexed, and no objections to the annexation were received by the City; and

WHEREAS, the City desires to proceed with the annexation of said property by ordinance pursuant to Minnesota Statutes Section 414.033;

NOW, THEREFORE, BE IT ORDAINED by the City Council of the City of Staples as follows:

Section 1. The corporate limits of the City are hereby amended to include the following described property currently in the jurisdiction of Thomastown Township in Wadena County, Minnesota, which property consists of approximately 5.76 acres, and the property is hereby annexed to and included within the corporate limits of the City pursuant to Minnesota Statutes Section 414.033 as if such property had originally been a part of the City:

Part of the Southwest Quarter of the Southeast Quarter (SW 1/4 of SE 1/4) of Section 36, Township 134 North, Range 33 West, described as follows: Commencing at the southwest corner of the Southeast Quarter (SE 1/4) of Section 36, Township 134, Range 33, thence North along the west line of said Southeast Quarter (SE 1/4), 33 feet; thence East at a right angle 33 feet to the point of beginning; thence North

and parallel with the section line a distance of 627 feet; thence East at a right angle 400 feet; thence south at a right angle 627 feet; thence West at a right angle 400 feet, to the point of beginning, subject to easements, restrictions and reservations of record, if any, and together with all abutting streets, highways and alleys.

Section 2. Pursuant to the City Zoning Ordinance, the City Council hereby designates the above described parcel of property being annexed herein to be commercial.

Section 3. The amount required to pay the filing fee of the Minnesota Municipal Board for this annexation ordinance is hereby appropriated for such purpose and the City Administrator is directed to make the necessary filings and provide required information to the Minnesota Municipal Board, the Township of Thomastown, the Auditor of Wadena County, and the Minnesota Secretary of State.

Section 4. The subject property contains one household with an estimated population of four.

Section 5. This ordinance is effective upon passage and publication pursuant to the Staples City Charter, Minnesota Statutes, and approval by the Minnesota Municipal Board.

Section 6. Ordinance No. 386 concerning the annexation of this property which was passed by the City on October 11, 1994 is hereby repealed in its entirety.

PASSED by the City Council of the City of Staples this  
27th day of December, 1994.

APPROVED BY

  
Franklin L. Williams  
Mayor

ATTEST

  
Phil Lindaman  
City Clerk

First Reading: December 6, 1994  
Second Reading: December 27, 1994  
Adoption: December 27, 1994  
Published: January 5, 1995

# CITY OF STAPLES, MN

CURRENT CITY LIMITS  
ANNEXED AREA

REC'D BY JAN 03 1995  
M M R

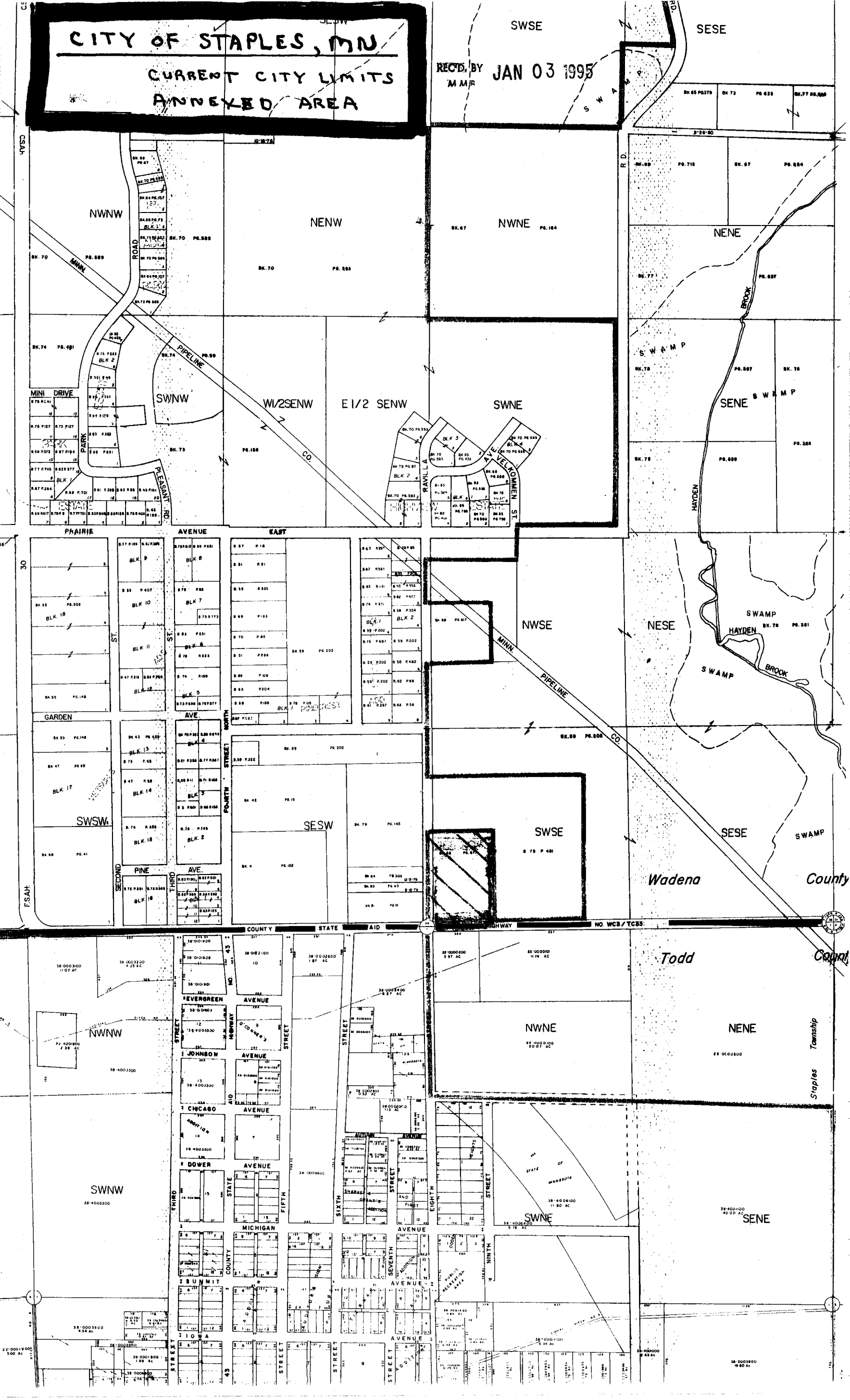

SWSE

SESE

BLK 65 PG 579 BLK 73 PG 638 BLK 77 PG 680

NWNW

NENW

NWNE PG 164

NENE

SWNW

W1/2SENW

E1/2 SENW

SWNE

SENE

PRAIRIE AVENUE EAST

MINN. PIPELINE CO.

WADENA COUNTY

NESE

SWAMP

HAYDEN BROOK

GARDEN AVENUE

SWSW

SESW

SWSE

SESE

Wadena County

Todd County

Staples Township

Staples Township

EVERGREEN AVENUE

JOHNSON AVENUE

CHICAGO AVENUE

DOWER AVENUE

MICHIGAN AVENUE

SUNNIT AVENUE

IOWA AVENUE

NWNE

NENE

SWNW

SWNE

SENE

SWNW

SWNW

SWNW

SWNW