

REC'D BY DEC 23 1994
M M D

In the Matter of:

The Petition of Property Owner for
Annexation of Unincorporated Property
to the City of Thief River Falls.

STATE OF MINNESOTA)
) ss.
COUNTY OF PENNINGTON)

Pursuant to the provisions of M.S.A. §414.033, Solid Waste Integrated Systems of Pennington County, Limited Partnership, ("SWISS"), the petitioner herein respectfully represents:

1. Petitioner is the owner of that unincorporated property located in the Township of Rocksbury, County of Pennington, State of Minnesota, described as follows:

That part of the Northeast Quarter of the Southeast Quarter (NE¼SE¼) of Section Five (5), Township One Hundred Fifty-three (153) North of Range Forty-three (43) West of the Fifth Principal Meridian described as follows:

Beginning at the Northeast corner of said Northeast Quarter of the Southeast Quarter (NE¼SE¼); thence in a westerly direction along the North line of said Northeast Quarter of the Southeast Quarter (NE¼SE¼) a distance of 580.8 feet; thence in a southerly direction along a line parallel with the East line of said Northeast Quarter of the Southeast Quarter (NE¼SE¼) a distance of 750 feet; thence in an easterly direction along a line parallel with the North line of said Northeast Quarter of the southeast Quarter (NE¼SE¼) to the point of intersection with the East line of said Northeast Quarter of the Southeast Quarter (NE¼SE¼); thence in a northerly direction along the East line of said Northeast Quarter of the Southeast Quarter (NE¼SE¼) to the point of beginning,

2. Petitioner desires the property be annexed to the City of Thief River Falls pursuant to the provisions of M.S.A. §414.003, Subd. 5.

3. The property abuts the City of Thief River Falls on the West side of the City.

4. The property is presently industrial in nature and the use shall be industrial.

5. The property does not exceed 20 acres in area and is unplatted.

ROCKSBURY

CODE - 16

REC'D BY DEC 23 1994
M M R

TOWNSHIP 153 NORTH

RANGE 43 WEST

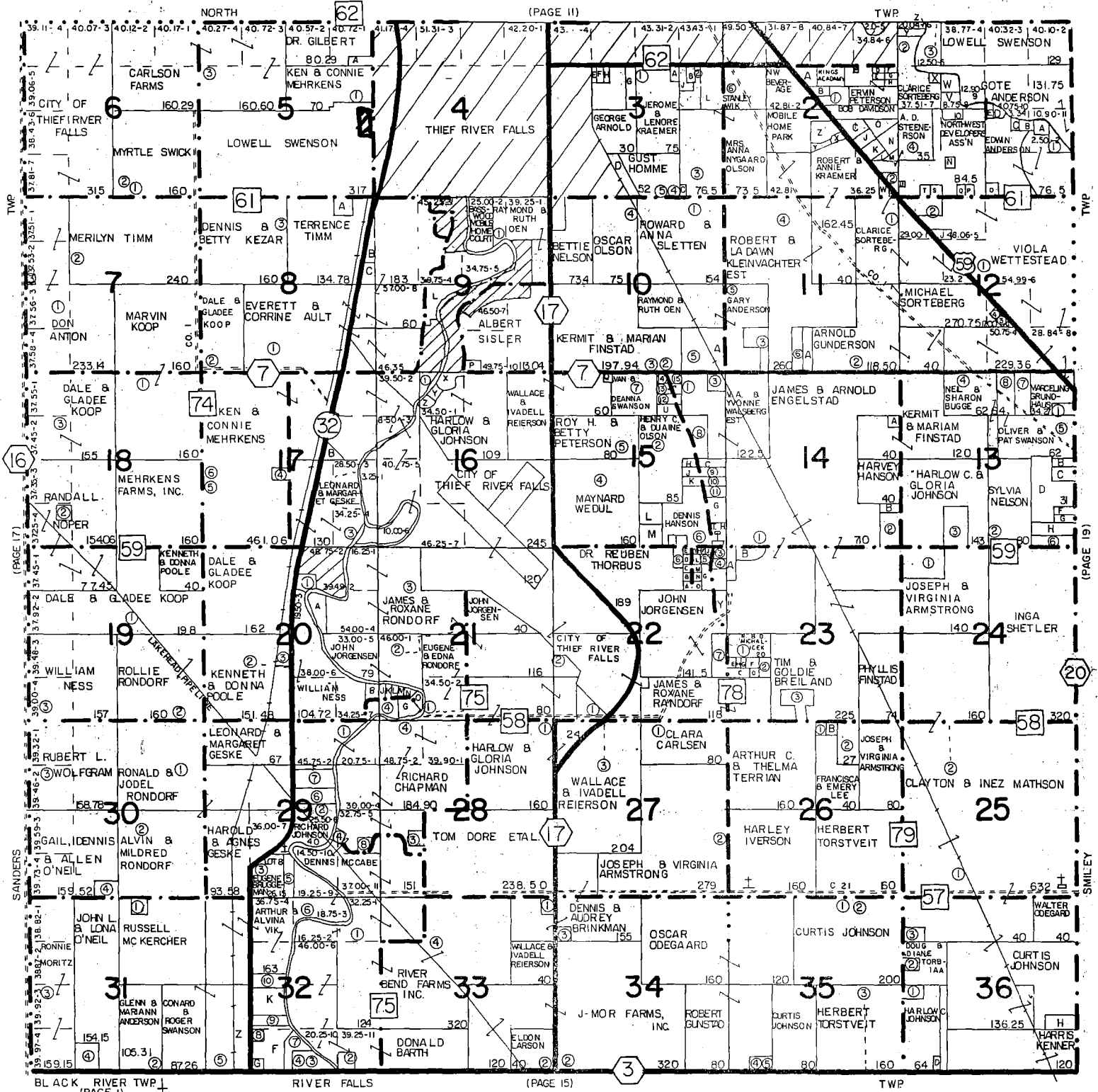

(PAGE II)

(PAGE 15)

TWP
SANDERS
(PAGE 17)
BL ACK RIVER TWP (PAGE I)

TWP
SMILEY
(PAGE 19)

SUNFLOWER SQUARE
FIRST SUBDIVISION

REC'D BY
M.M.P. DEC 23 1994

