

REC'D BY NOV 23 1993
M M R

ORDINANCE NO. 1993-**3**

AN ORDINANCE EXTENDING THE CORPORATE LIMITS
OF THE CITY OF ROGERS TO INCLUDE CERTAIN
UNINCORPORATED TERRITORY ABUTTING THE CITY
LIMITS NOT EXCEEDING 60 ACRES UPON PETITION FOR
ANNEXATION FROM ALL OF THE PROPERTY OWNERS THEREOF

WHEREAS, certain territory described below is not presently included within the corporate limits of any incorporated City; and

WHEREAS, the territory described below is less than 60 acres in area; and

WHEREAS, the territory described below abuts upon the City limits at the north boundary thereof and is deemed to be urban or suburban in character; and

WHEREAS, a certain Petition dated October 12, 1993, requesting annexation of the territory described below was duly presented to this Council on the 12th day of October, 1993; and

WHEREAS, the Petition was signed by all owners of the territory described below.

NOW, THEREFORE, the City Council of the City of Rogers, Minnesota, ordains:

Section 1. Determination of Facts. The City Council hereby determines:

- (1) That the territory described below abuts upon the City limits and is deemed to be urban or suburban in character;
- (2) That the territory described below is appropriate for annexation as it is suitable for commercial, industrial, residential and public uses and needs city services for environmentally and economically sound development.
- (3) That none of the territory is now included within the limits of any city;
- (4) That the territory is 60 acres or less in area; and
- (5) The City has received a petition for annexation from all of the property owners (to wit: Richard A. Weber and Elva L. Weber) of the territory described below.

Section 2. Population. The population of the territory described below is two (2) residents.

Section 3. Territory Annexed. The corporate limits of the City are hereby extended to include the unplatted land described as follows, which land is situated in the County of Hennepin and State of Minnesota, to-wit:

That part of the following tract of land lying north of the centerline of Territorial Road: The Southeast Quarter of the Northwest Quarter of Section 26, Township 120, Range 23, except the West 10 acres thereof; Also, that part of the Northeast Quarter of the Northwest Quarter of Section 26, Township 120, Range 23 described as follows: Beginning at the Southeast corner of the Northeast Quarter of the Northwest Quarter of Section 26, Township 120, Range 23; thence north on the east line of said Northeast Quarter of the Northwest Quarter, 789.37 feet; thence west and parallel with the south line of the Northeast Quarter of the Northwest Quarter of said Section 1327.08 feet to the west line of said Northeast Quarter of the Northwest Quarter of said Section; thence south on the west line of the Northeast Quarter of the Northwest Quarter of said Section 789.37 feet to the southwest corner of the Northeast Quarter of the Northwest Quarter; thence east on the south line of the Northeast Quarter of the Northwest Quarter 1332 feet to the point of beginning.

Section 4. Filing. The City Clerk/Administrator is hereby directed to file certified copies of this Ordinance with the Secretary of State, the County Auditor of the County in which the property is located, the Town Clerk of the Hassan Township and the Minnesota Municipal Board.

Section 5. Effective Date. This Ordinance takes effect upon its passage and publication and the filing of a certified copy as directed in Section 4 and approval by the Minnesota Municipal Board, if required.

Adopted by the City Council of the City of Rogers this 23rd day of November, 1993.

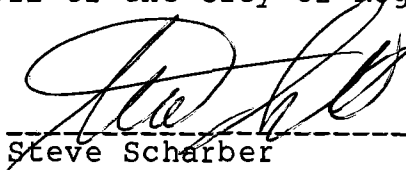

Steve Scharber Mayor

ATTEST:

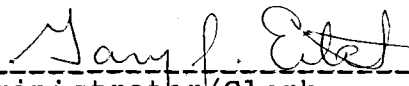

Administrator/Clerk
Gary J. Eitel

(Published in the North Crow River News -----).

REC'D. BY MMR NOV 20 1993

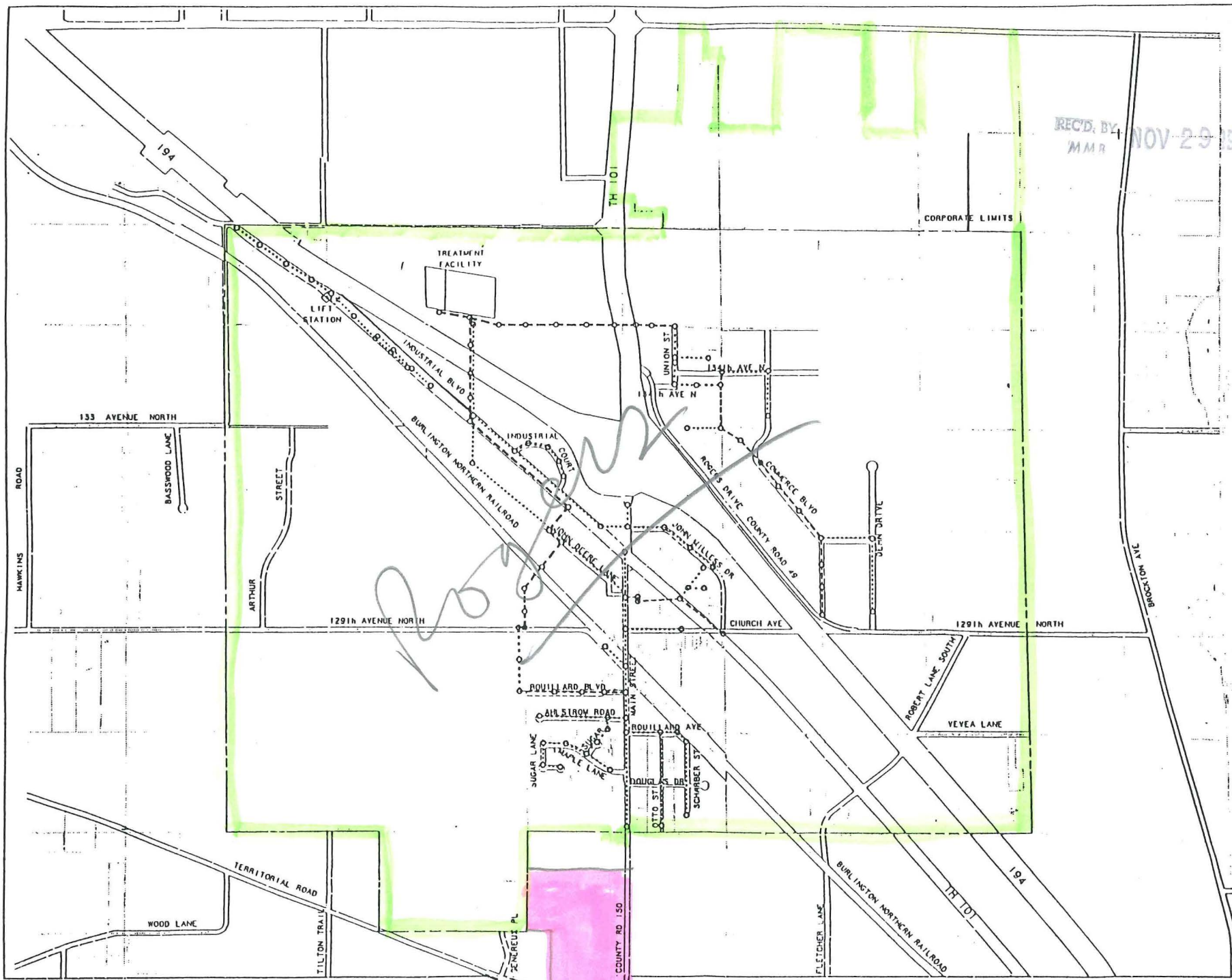

NOR



RO

0 600 12

SCALE:

LEGE
○
—

□

~~2001-06-10~~

Geo Weber Ord No 1993-13
MAP # 2

SCALE 0 1 2 3 4 5 MILES

METROPOLITAN ST. PAUL-MINNEAPOLIS

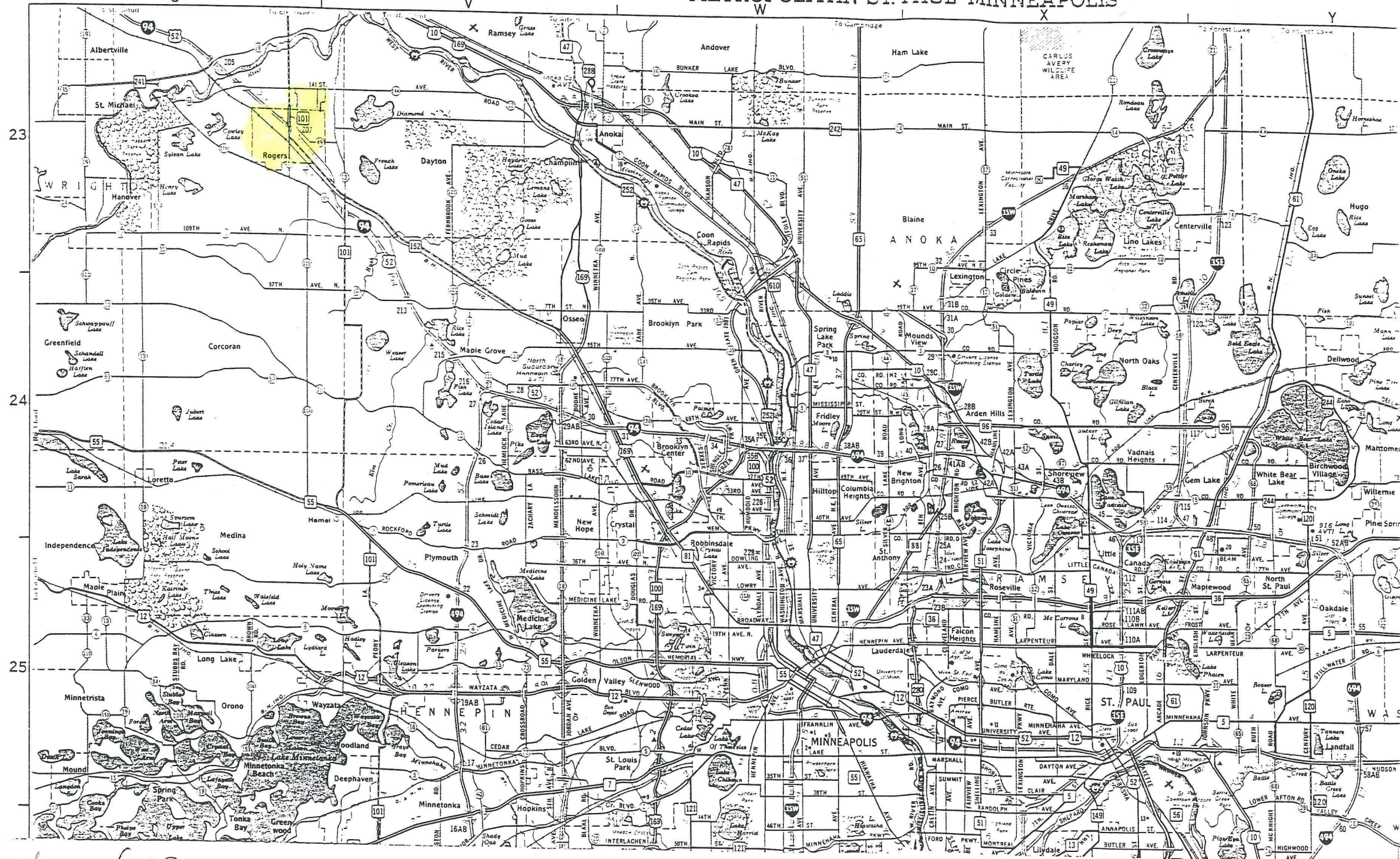

REC'D BY NOV 29 1993
M.A.M.R.

See Weber (ORD NO. 1993-13)

MAP # 3