

REC'D BY MAR 05 1993
MAIL

P	A I
	DEC 31 1992
	135.00

CITY OF HUTCHINSON

PETITION FOR ANNEXATION

TO THE CITY COUNCIL OF HUTCHINSON, MINNESOTA

PETITIONERS STATE:

1. That ~~we~~^I, the undersigned, ~~are~~^{am} the sole _____ or all _____ or a majority _____ of the owners of the following described property lying in the Township of LYNN, County of McLeod, State of Minnesota.

The undersigned petitioner(s) respectfully represents and states that he (~~they~~) is sole owner of the following described lands:

attached -

2. That said property is unincorporated, abuts upon the limits of the City of Hutchinson, and is not included within any other municipality.
3. The acreage of such area is 12.72.
4. The reason for the requested annexation is progress.
5. The population of the area is ONE.

PETITIONERS REQUEST: That pursuant to M.S. 414.033, said property be annexed to and included within the City of Hutchinson.

DATED: 12-31-92.

SIGNED: _____

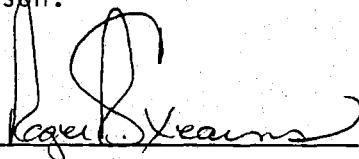

All that part of the South Half of Section 2, Township 116 North, Range 30 West, McLeod County, Minnesota described as follows: Commencing at the Southeast corner of said Section 2; thence on a bearing of South 89° 54' 10" West along the South line of said Section 2, a distance of 1972.18 feet; thence North 0° 41' 50" West, a distance of 1328.81 feet to the point of beginning; thence south 89° 54' 10" West, a distance of 899.21 feet; thence North 3° 37' 10" East; a distance of 103.94 feet; thence South 86° 43' 20" West, a distance of 322.60 feet; thence North 2° 48' 55" West, a distance of 283.31 feet; thence South 89° 40' West, a distance of 254.97 feet; thence North 15° 36' East, a distance of 68.64 feet; thence North 89° 40' East, a distance of 1459.87 feet; thence South 0° 41' 50" East, a distance of 432.49 feet to the point of beginning. Subject to a roadway easement over the Easterly 33 feet of said tract. Containing 12.72 acres more or less.

EXCEPT

Commencing at the southeast corner of said Section 2; thence South 89 degrees 54 minutes 10 seconds West, assumed bearing, along the south line of the Southeast Quarter of said Section 2 a distance of 1972.18 feet; thence North 0 degrees 41 minutes 50 seconds West a distance of 1328.81 feet; thence South 89 degrees 54 minutes 10 seconds West a distance of 899.21 feet; thence North 3 degrees 37 minutes 10 seconds East a distance of 103.94 feet; thence South 86 degrees 43 minutes 20 seconds West a distance of 322.60 feet; thence North 2 degrees 48 minutes 55 seconds West a distance of 211.20 feet to the point of beginning of the land to be described; thence continuing North 2 degrees 48 minutes 55 seconds West a distance of 72.11 feet; thence South 89 degrees 40 minutes 00 seconds West a distance of 254.97 feet; thence North 15 degrees 36 minutes 00 seconds East a distance of 68.64 feet; thence North 89 degrees 40 minutes 00 seconds East a distance of 295.84 feet; thence South 28 degrees 20 minutes 28 seconds West a distance of 16.41 feet thence southwesterly 121.09 feet along a tangential curve concave to the southeast, having a radius of 527.93 feet and a central angle of 13 degrees 08 minutes 28 seconds; thence South 15 degrees 12 minutes 00 seconds West, tangent to said curve, a distance of 12.16 feet to the point of beginning.

* * * * *

AND

That part of the South Half of Section 2, Township 116 North, Range 30 West of the 5th Principal Meridian described as follows:

Commencing at the southeast corner of said Section 2; thence South 89 degrees 54 minutes 10 seconds West, assumed bearing along the south line of the Southeast Quarter of said Section 2 a distance of 1972.18 feet; thence North 0 degrees 41 minutes 50 seconds West a distance of 1328.81 feet; thence South 89 degrees 54 minutes 10 seconds West a distance of 899.21 feet; thence North 3 degrees 37 minutes 10 seconds East a distance of 103.94 feet; thence South 86 degrees 43 minutes 20 seconds West a distance of 322.60 feet to the point of beginning of the land to be described; thence North 2 degrees 48 minutes 55 seconds West a distance of 211.20 feet; thence South 15 degrees 12 minutes 00 seconds West a distance of 200.92 feet; thence South 74 degrees 52 minutes 25 seconds East a distance of 65.32 feet to the point of beginning.

AND

That part of the South Half of Section 2, Township 116 North, Range 30 West of the 5th Principal Meridian described as follows:

Commencing at the southeast corner of said Section 2; thence South 89 degrees 54 minutes 10 seconds West, assumed bearing, along the south line of the Southeast Quarter of said Section 2 a distance of 1972.18 feet; thence North 0 degrees 41 minutes 50 seconds West a distance of 1328.81 feet; thence South 89 degrees 54 minutes 10 seconds West a distance of 899.21 feet to the point of beginning of the land to be described; thence North 3 degrees 37 minutes 10 seconds East a distance of 103.94 feet; thence South 86 degrees 43 minutes 20 seconds West a distance of 322.60 feet; thence South 74 degrees 52 minutes 25 seconds East a distance of 326.83 feet to the point of beginning.

REC'D. BY MAR 05 1993
M M R

TO THE MINNESOTA MUNICIPAL BOARD, THE LYNN TOWNSHIP BOARD,
AND THE MCLEOD COUNTY BOARD, MINNESOTA

WHEREAS, the City Council of Hutchinson, Minnesota, intends to annex certain territory within the town of Hutchinson, described as stated in Exhibit A, totaling 12.72 acres of land;

WHEREAS, the described land is unplatted, does not exceed 100 acres in area, and 100 percent of the owners of said land have petitioned the City Council of the City of Hutchinson for annexation;

NOW THEREFORE, notice is hereby given to the Minnesota Municipal Board, the Town Board of Lynn Township, and the County Board of McLeod County, that the City of Hutchinson intends to annex the described land pursuant to MSA 414.033, Subd. 5, and will so annex the land if no written objections are received from the Town Board or the County Board within ninety (90) days from the service of this notice upon the Town Board and County Board.

Dated: February 12, 1993

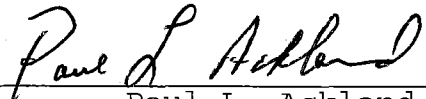

Paul L. Ackland
Mayor

ATTEST:

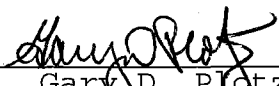

Gary D. Pletz
City Administrator

All that part of the South Half of Section 2, Township 116 North, Range 30 West, McLeod County, Minnesota described as follows: Commencing at the Southeast corner of said Section 2; thence on a bearing of South 89° 54' 10" West along the South line of said Section 2, a distance of 1972.18 feet; thence North 0° 41' 50" West, a distance of 1328.81 feet to the point of beginning; thence south 89° 54' 10" West, a distance of 899.21 feet; thence North 3° 37' 10" East; a distance of 103.94 feet; thence South 86° 43' 20" West, a distance of 322.60 feet; thence North 2° 48' 55" West, a distance of 283.31 feet; thence South 89° 40' West, a distance of 254.97 feet; thence North 15° 36' East, a distance of 68.64 feet; thence North 89° 40' East, a distance of 1459.87 feet; thence South 0° 41' 50" East, a distance of 432.49 feet to the point of beginning. Subject to a roadway easement over the Easterly 33 feet of said tract. Containing 12.72 acres more or less.

EXCEPT

Commencing at the southeast corner of said Section 2; thence South 89 degrees 54 minutes 10 seconds West, assumed bearing, along the south line of the Southeast Quarter of said Section 2 a distance of 1972.18 feet; thence North 0 degrees 41 minutes 50 seconds West a distance of 1328.81 feet; thence South 89 degrees 54 minutes 10 seconds West a distance of 899.21 feet; thence North 3 degrees 37 minutes 10 seconds East a distance of 103.94 feet; thence South 86 degrees 43 minutes 20 seconds West a distance of 322.60 feet; thence North 2 degrees 48 minutes 55 seconds West a distance of 211.20 feet to the point of beginning of the land to be described; thence continuing North 2 degrees 48 minutes 55 seconds West a distance of 72.11 feet; thence South 89 degrees 40 minutes 00 second West a distance of 254.97 feet; thence North 15 degrees 36 minutes 00 seconds East a distance of 68.64 feet; thence North 89 degrees 40 minutes 00 seconds East a distance of 295.84 feet; thence South 28 degrees 20 minutes 28 seconds West a distance of 16.41 feet thence southwesterly 121.09 feet along a tangential curve concave to the southeast, having a radius of 527.93 feet and a central angle of 13 degrees 08 minutes 28 seconds; thence South 15 degrees 12 minutes 00 seconds West, tangent to said curve, a distance of 12.16 feet to the point of beginning.

* * * * *

AND

That part of the South Half of Section 2, Township 116 North, Range 30 West of the 5th Principal Meridian described as follows:

Commencing at the southeast corner of said Section 2; thence South 89 degrees 54 minutes 10 seconds West, assumed bearing along the south line of the Southeast Quarter of said Section 2 a distance of 1972.18 feet; thence North 0 degrees 41 minutes 50 seconds West a distance of 1328.81 feet; thence South 89 degrees 54 minutes 10 seconds West a distance of 899.21 feet; thence North 3 degrees 37 minutes 10 seconds East a distance of 103.94 feet; thence South 86 degrees 43 minutes 20 seconds West a distance of 322.60 feet to the point of beginning of the land to be described; thence North 2 degrees 48 minutes 55 seconds West a distance of 211.20 feet; thence South 15 degrees 12 minutes 00 seconds West a distance of 200.92 feet; thence South 74 degrees 52 minutes 25 seconds East a distance of 65.32 feet to the point of beginning.

AND

That part of the South Half of Section 2, Township 116 North, Range 30 West of the 5th Principal Meridian described as follows:

Commencing at the southeast corner of said Section 2; thence South 89 degrees 54 minutes 10 seconds West, assumed bearing, along the south line of the Southeast Quarter of said Section 2 a distance of 1972.18 feet; thence North 0 degrees 41 minutes 50 seconds West a distance of 1328.81 feet; thence South 89 degrees 54 minutes 10 seconds West a distance of 899.21 feet to the point of beginning of the land to be described; thence North 3 degrees 37 minutes 10 seconds East a distance of 103.94 feet; thence South 86 degrees 43 minutes 20 seconds West a distance of 322.60 feet; thence South 74 degrees 52 minutes 25 seconds East a distance of 326.83 feet to the point of beginning.

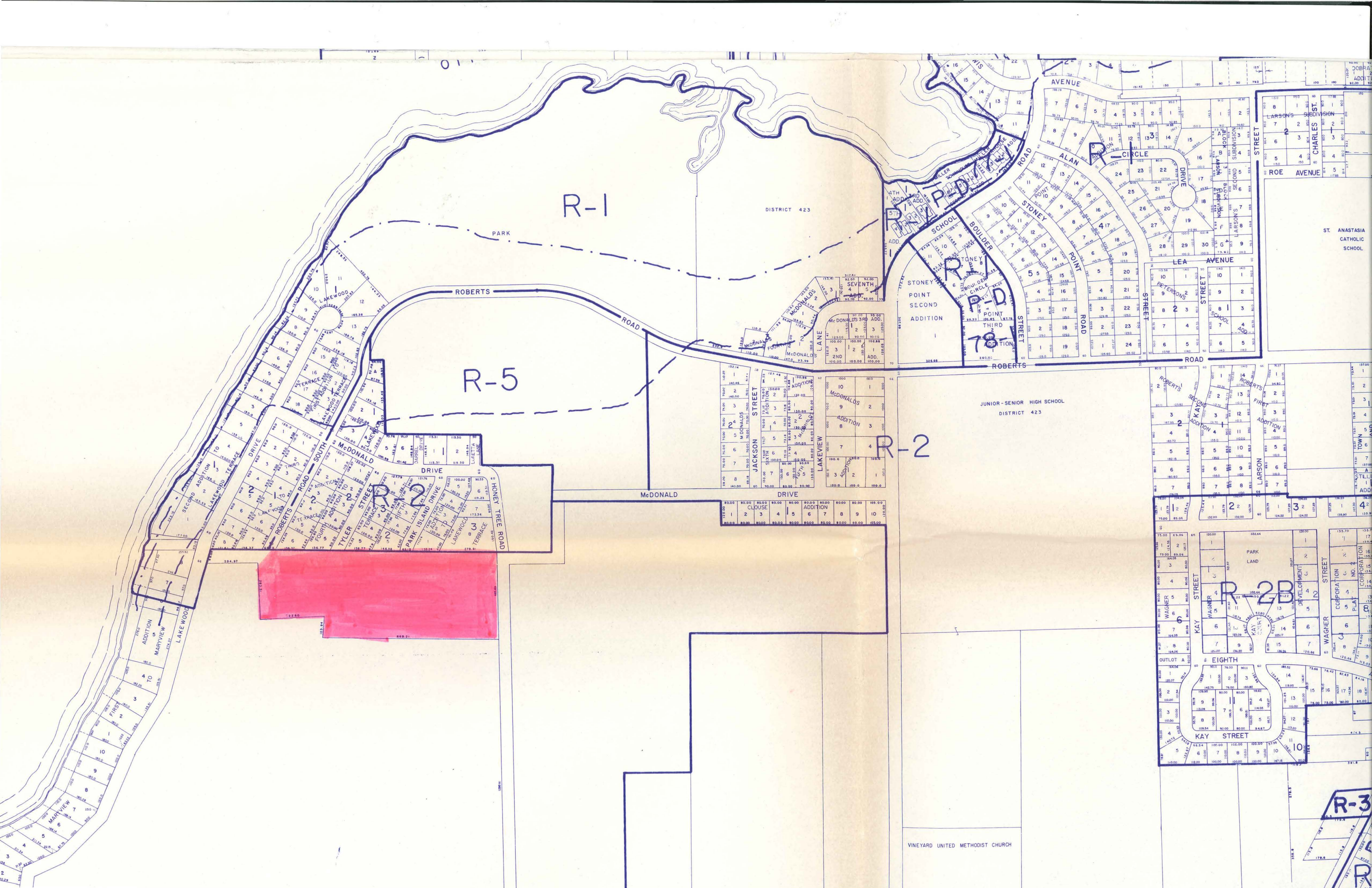

R-1

DISTRICT 423

R-5

JUNIOR-SENIOR HIGH SCHOOL
DISTRICT 423

R-2

R-2B

R-3

ROBERTS ROAD
PARK
LAKEWOOD DRIVE
MCDONALD DRIVE
JACKSON STREET
TYLER STREET
PARK ISLAND DRIVE
LAKEWOOD TERRACE
HONEY TREE ROAD

ROBERTS ROAD
LEA AVENUE
STONEY POINT SECOND ADDITION
STONEY POINT THIRD ADDITION
ALAN AVENUE
CIRCLE DRIVE
STONEY POINT
BOULDER ROAD
MILLER TOWNSHIP
ROBERTS ROAD

CHARLES STREET
ROE AVENUE
LARSON'S SUBDIVISION

ST. ANASTASIA CATHOLIC SCHOOL

1	2	3	4	5	6	7	8	9	10
100.00	100.00	100.00	100.00	100.00	100.00	100.00	100.00	100.00	100.00
100.00	100.00	100.00	100.00	100.00	100.00	100.00	100.00	100.00	100.00

1	2	3	4	5	6	7	8	9	10
100.00	100.00	100.00	100.00	100.00	100.00	100.00	100.00	100.00	100.00
100.00	100.00	100.00	100.00	100.00	100.00	100.00	100.00	100.00	100.00

1	2	3	4	5	6	7	8	9	10
100.00	100.00	100.00	100.00	100.00	100.00	100.00	100.00	100.00	100.00
100.00	100.00	100.00	100.00	100.00	100.00	100.00	100.00	100.00	100.00

VINEYARD UNITED METHODIST CHURCH