

REC'D. BY MAR 01 1993  
MMB

ORDINANCE NO. 173

AN ORDINANCE EXTENDING THE CORPORATE LIMITS OF  
THE CITY OF ISANTI TO INCLUDE CERTAIN UNINCORPORATED  
PROPERTY ABUTTING UPON THE LIMITS OF THE CITY

WHEREAS, the territory described below is not presently within the corporate limits of any incorporated city; and

WHEREAS, this territory is owned by Allen Torkelson; and

WHEREAS, Allen Torkelson has petitioned the City of Isanti for the annexation of this territory; and

WHEREAS, this territory abuts upon the corporate limits of the city at the South boundary thereof and is deemed about to become urban or suburban in character; and,

WHEREAS, this territory consists entirely of an area totalling 60 acres or less; and,

WHEREAS, the population of said area to be annexed is "0".

NOW, THEREFORE, THE CITY OF ISANTI DOES ORDAIN:

Section 1. Territory annexed. The corporate limits of the City of Isanti are hereby extended to include unplatted property described as follows now owned by Allen Torkelson:  
See Exhibit A.

Section 2. Filing. The City Clerk is directed to file certified copies of this ordinance with the Secretary of State, the County Auditor of the county in which the property is located, the Town Clerk of the affected township, and the Minnesota Municipal Board.

Section 3. Effective date of annexation. This ordinance takes effect ten days from the date of its publication and the filing of certified copies as directed in Section 2.

Adopted by the City Council of Isanti, Minnesota, this 16<sup>th</sup>  
day of February, 1993.

ATTEST:

  
\_\_\_\_\_  
Mayor

  
\_\_\_\_\_  
City Administrator

REC'D. BY MAR 01 1993  
MME

EXHIBIT A

Northeast Quarter of Northwest Quarter (NE 1/4 of NW 1/4) of Section Thirty-One (31), Township Thirty-Five (35), Range Twenty-Three (23), EXCEPT that certain tract of land platted as "Isanti Hills". (City of Isanti) (2.43 acres) Southeast Quarter of Northwest Quarter (SE 1/4 of NW 1/4) of Section Thirty-One (31), Township Thirty-Five (35), Range Twenty-Three (23). (Isanti Township) (40 acres), excepting and reserving to the said State, in trust for the taxing districts concerned, all minerals and mineral rights, as provided by law.

The above described parcel consists of approximately 42.43 acres.

REC'D. BY MAR 01 1993  
M.A.R.

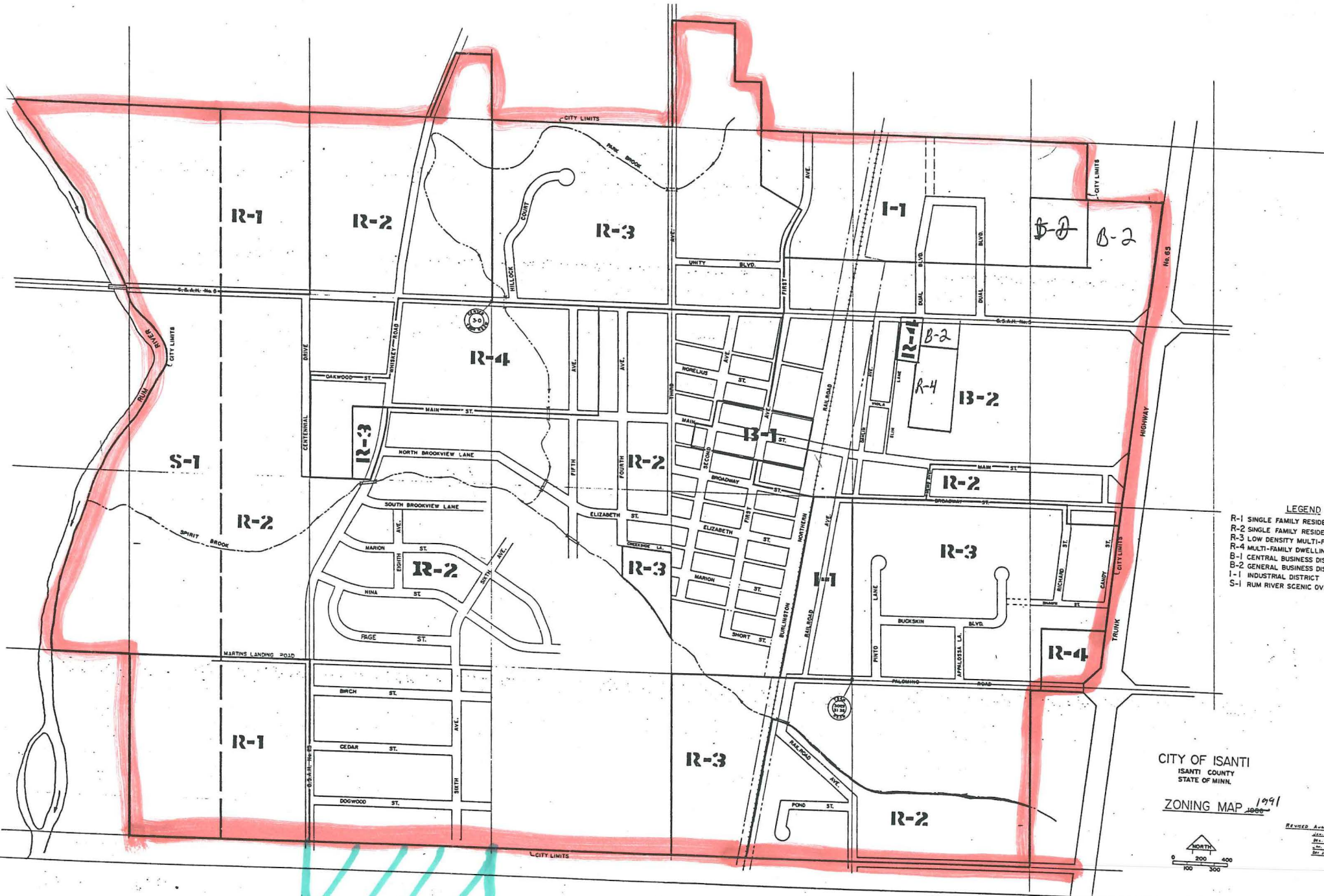

 - City Boundary

 - Annexed Area

- LEGEND
- R-1 SINGLE FAMILY RESIDENTIAL DISTRICT
  - R-2 SINGLE FAMILY RESIDENTIAL DISTRICT
  - R-3 LOW DENSITY MULTI-FAMILY RESIDENTIAL DISTRICT
  - R-4 MULTI-FAMILY DWELLING DISTRICT
  - B-1 CENTRAL BUSINESS DISTRICT
  - B-2 GENERAL BUSINESS DISTRICT
  - I-1 INDUSTRIAL DISTRICT
  - S-1 RUM RIVER SCENIC OVERLAY DISTRICT

CITY OF ISANTI  
ISANTI COUNTY  
STATE OF MINN.

ZONING MAP 1991  
2000

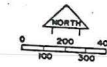

REVISED AUG. 3, 1993 - SEE MAP 128  
AUG. 3, 1993 - SEE MAP 127  
MAY 1, 1992 - SEE MAP 126  
MAY 1, 1991 - SEE MAP 125  
MAY 1, 1990 - SEE MAP 124  
MAY 1, 1989 - SEE MAP 123  
MAY 1, 1988 - SEE MAP 122  
MAY 1, 1987 - SEE MAP 121  
MAY 1, 1986 - SEE MAP 120  
MAY 1, 1985 - SEE MAP 119  
MAY 1, 1984 - SEE MAP 118  
MAY 1, 1983 - SEE MAP 117  
MAY 1, 1982 - SEE MAP 116  
MAY 1, 1981 - SEE MAP 115  
MAY 1, 1980 - SEE MAP 114  
MAY 1, 1979 - SEE MAP 113  
MAY 1, 1978 - SEE MAP 112  
MAY 1, 1977 - SEE MAP 111  
MAY 1, 1976 - SEE MAP 110  
MAY 1, 1975 - SEE MAP 109  
MAY 1, 1974 - SEE MAP 108  
MAY 1, 1973 - SEE MAP 107  
MAY 1, 1972 - SEE MAP 106  
MAY 1, 1971 - SEE MAP 105  
MAY 1, 1970 - SEE MAP 104  
MAY 1, 1969 - SEE MAP 103  
MAY 1, 1968 - SEE MAP 102  
MAY 1, 1967 - SEE MAP 101  
MAY 1, 1966 - SEE MAP 100