

MMB Docket No. A-4973

ORDINANCE #565

AN ORDINANCE ANNEXING THE EAST HALF OF THE SOUTHWEST QUARTER OF SECTION 19, TOWNSHIP 41, RANGE 20, PINE COUNTY, MINNESOTA, TO THE CITY OF HINCKLEY.

The City Council of the City of Hinckley ordains:

SECTION 1. WHEREAS, Walter Nilsen and Kenneth Smith are the owners of the following described premises located in the County of Pine, State of Minnesota, described as follows, to-wit:

That part of the East Half of the Southwest Quarter of Section 19, Township 41, Range 20, Pine County, Minnesota, which lies northerly of the Grindstone River.

Subject to a 50 foot sewer easement granted to the City of Hinckley, Minnesota, recorded in Book 22 of Miscellaneous, page 283.

And subject to a 16.5 foot easement granted to Northwestern Bell Telephone Company recorded in Book 12 of Miscellaneous, page 304.

SECTION 2 WHEREAS, said above described premises are adjacent to land within the municipal limits of the City of Hinckley, and said premises are not included in any other municipality and that said premises are urban in character.

SECTION 3. WHEREAS, The City Council of the City of Hinckley finds that annexation of the above-described premises to the City of Hinckley is in the best interests of the City of Hinckley and the premises affected.

BE IT HEREBY ORDAINED, That the City Council of the City of Hinckley, pursuant to Minnesota Statutes Annotated 414.033, Subd. 2, does hereby annex said above-described premises and lands to the City of Hinckley, and the Clerk of the City Council of the City of Hinckley is hereby directed to forthwith send copies of this Ordinance to the Minnesota Municipal Board of the State of Minnesota, the Town Clerk of the Township of Barry, the Pine County Auditor, and the Secretary of State of the State of Minnesota.

Passed by the Hinckley City Council this 1st day of September, 1992.

ATTEST:



Mayor of City of Hinckley

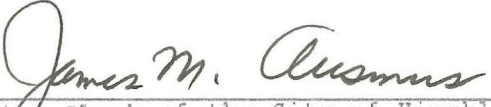

City Clerk of the City of Hinckley



CITY OF
HINCKLEY
PINE COUNTY
MINNESOTA



REVISION
NOV - 1973
MAY - 1981

G. Zornig Plans Service
2204 W 7th St, Duluth,

BARRY

REC'D. BY MAY 14 1992

T.41N.-R.20W.

SEE PAGE 30

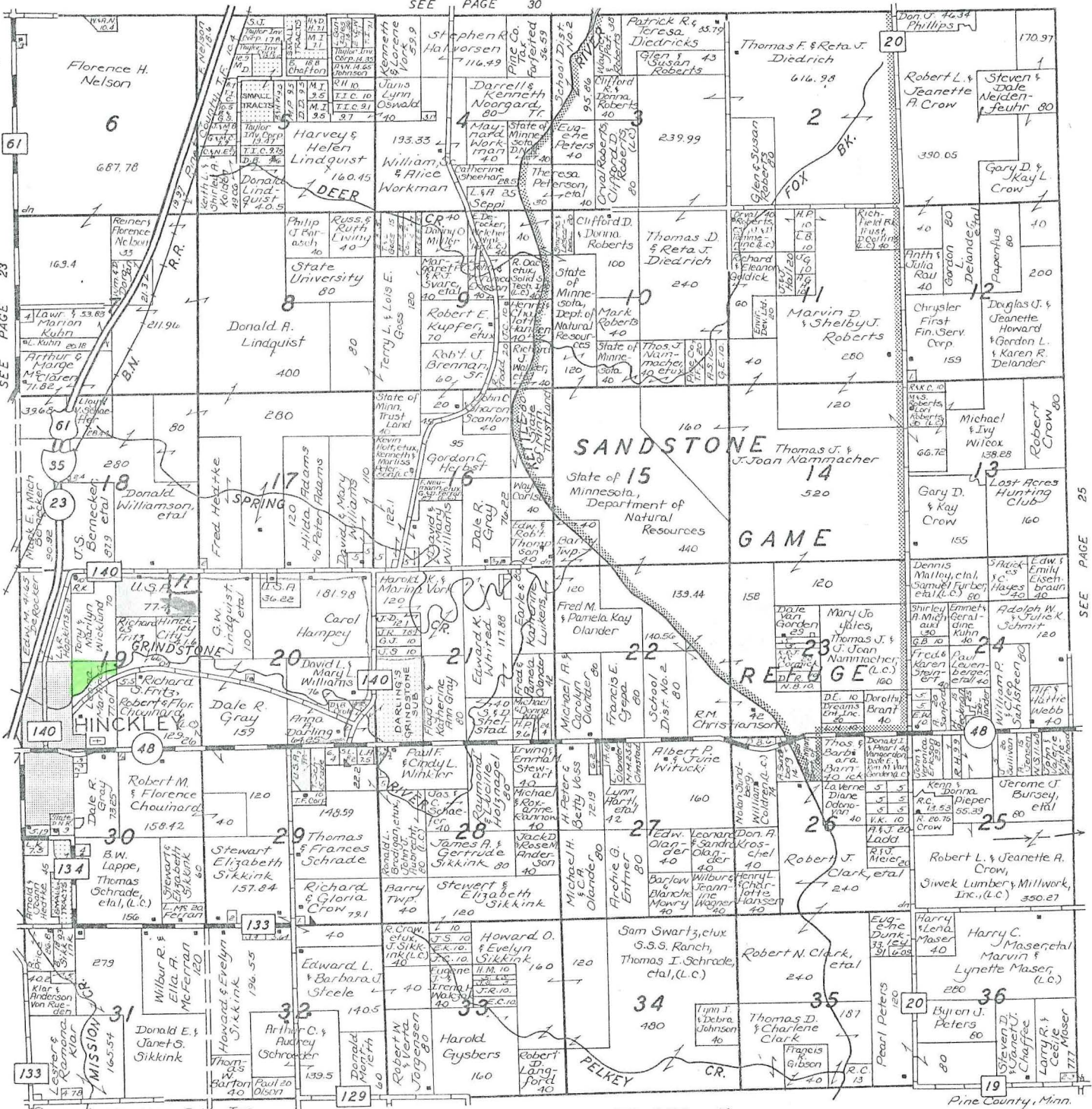

SEE PAGE 23

SEE PAGE 25

© 1989 Rockford Map Publishers, Inc. SEE PAGE 19

SEE PAGE 20

Pine County, Minn.



ASSOCIATED MILK PRODUCERS, INC.
NORTH CENTRAL REGION
 (218) 624-4803

Office:
 AMPI TWIN PORTS DIVISION
 HINCKLEY, MINNESOTA 55037
 PHONE: (612) 384-6131

HINCKLEY CO-OP AG SERVICE

P.O. Box 70 - Hinckley, Minnesota 55037 — (612) 384-6251



PRODUCTS: Feed - Seed - Fertilizer - Chemicals

SERVICES:

Grinding - Mixing - Delivery & Fertilizer Spreading - Custom Spraying