

Date: 5/5/92

To The City Council of Hinckley, County of Pine, State of Minnesota

We, the undersigned, all the owners of the territory described below, hereby request the council to annex this territory to the city and to extend city boundaries to include the same, and for that purpose respectfully state:

1. The territory to be annexed consists entirely of lands which have been platted into lots and blocks, which plat(s) has (have) been duly and legally made and certified according to the laws of this state and filed in the office of the county recorder of Pine County, Minnesota. All of these lands lie entirely within the County of Pine, Minnesota and the description of such lands is as follows:

See Attachment per M.B. Rude April 22, 1992

2. The territory described above abuts upon the city limits at the east end boundary (boundaries) thereof and none of it is presently included within the corporate limits of any incorporated city.

3. All of this territory is or is about to become urban or suburban in character.

Walter Nilsen

Walter Nilsen

Kenneth J. Smith
Kenneth J. Smith

REC'D. BY
MMB MAY 14 1992

LAND SURVEYING
SUBDIVISION DESIGN

M.B. RUDE
LAND SURVEYORS
ROUTE 4 - BOX 227
PINE CITY, MINNESOTA 55063
Telephone 612/629-3267



April 22, 1992

Mr. Mike Montag
MONTAG DEVELOPMENT, INC.
PO Box 815
Mankato, Minnesota 56001

Dear Mr. Montag:

This is the description that you have requested:

That part of the East Half of the Southwest Quarter of Section 19, Township 41, Range 20, Pine County, Minnesota, which lies northerly of the Grindstone River.

Subject to a 50 foot sewer easement granted to the City of Hinckley, Minnesota, recorded in Book 22 of Miscellaneous, page 283.

And subject to a 16.5 foot easement granted to Northwestern Bell Telephone Company recorded in Book 12 of Miscellaneous, page 304.

Thank you.

Sincerely,

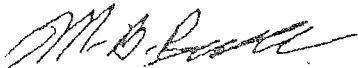
M. B. Rude
Land Surveyor



MBR/rr



G. Zornig Plans Service
2204 W 7th St, Duluth,

BARRY

REC'D. BY MAY 14 1992
MMB

T.41N.-R.20W.

SEE PAGE 30

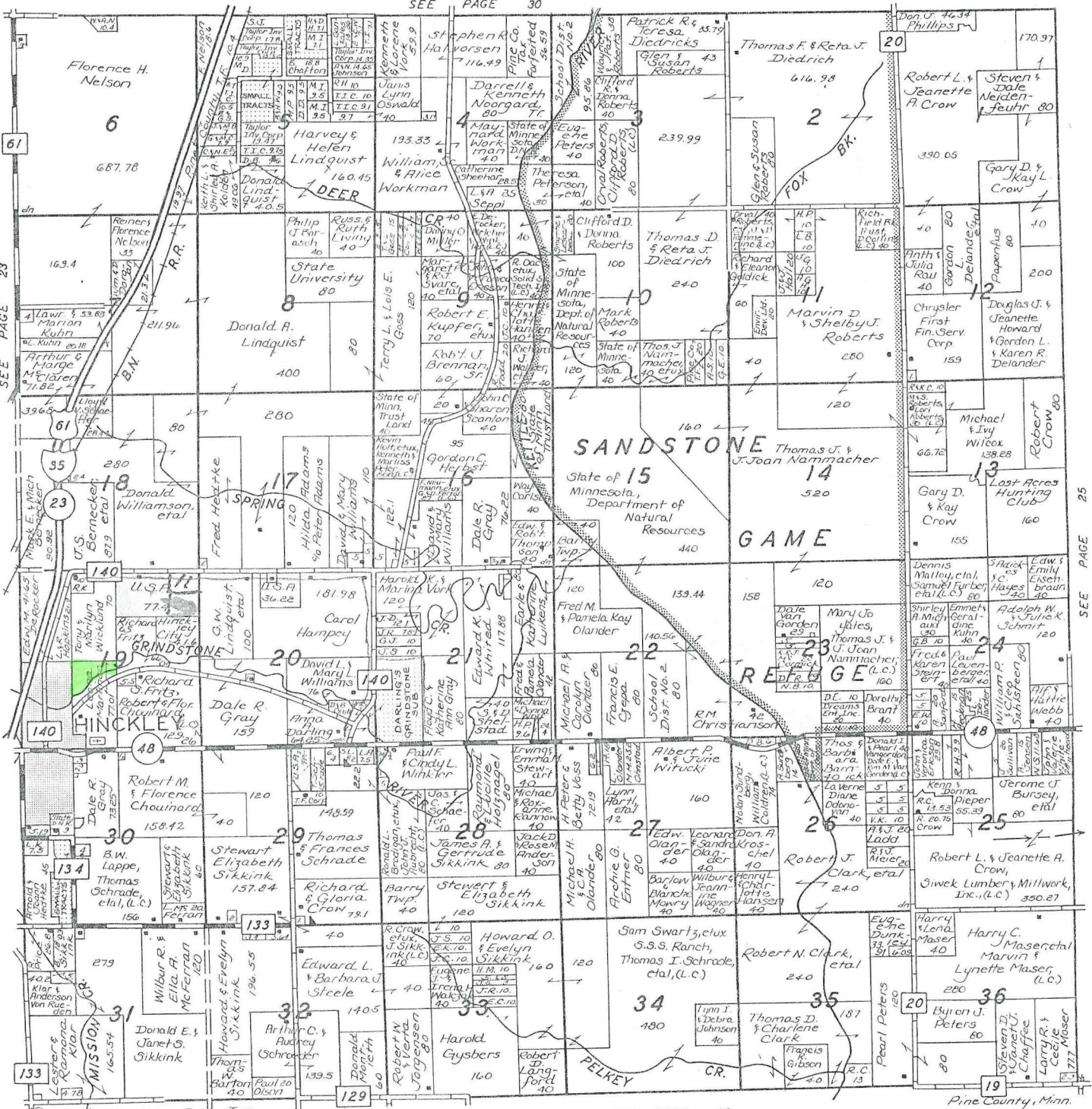

SEE PAGE 23

SEE PAGE 25

©1989 Rockford Map Publishers, Inc.
SEE PAGE 19

SEE PAGE 20

Pine County, Minn.



ASSOCIATED MILK PRODUCERS, INC.
NORTH CENTRAL REGION
 (218) 624-4803

Office:
 AMPI TWIN PORTS DIVISION
 HINCKLEY, MINNESOTA 55037
 PHONE: (612) 384-6131

HINCKLEY CO-OP AG SERVICE

P.O. Box 70 - Hinckley, Minnesota 55037 — (612) 384-6251



PRODUCTS: Feed - Seed - Fertilizer - Chemicals

SERVICES:

Grinding - Mixing - Delivery & Fertilizer Spreading - Custom Spraying