

ORDINANCE NO. 1992 - 193

AN ORDINANCE ANNEXING APPROXIMATELY 10.5 ACRES
OF LAND IN SECTION 14
AND SECTION 23 OF WAKEFIELD TOWNSHIP

WHEREAS, the City has received a petition from the owner of approximately 10.5 acres of land in Section 14 and Section 23 of Wakefield Township requesting that the land be annexed into the City of Cold Spring; and

WHEREAS, such land abuts upon the corporate limits of the City of Cold Spring, is unplatted and does not exceed 200 acres in size; and

WHEREAS, pursuant to Minnesota Statutes Section 414.033, a municipal council may by ordinance declare land annexed to the municipality if the owner of the land petitions the City for annexation of the land, the land is abutting the City, is unplatted and does not exceed 200 acres in size.

NOW, THEREFORE, be it ordained by the City Council of the City of Cold Spring as follows:

That part of the Southeast Quarter of the Southwest Quarter of Section 14, Township 123 North, Range 30 West and that part of the Northeast Quarter of the Northwest Quarter of Section 23, Township 123 North, Range 30 West and that part of Block 35, in the Townsite (now City) of Cold Spring, Minnesota, according to the recorded plat thereof, described as follows:

Commencing at the south quarter corner of said Section 14; thence South 89 degrees 31 minutes 32 seconds West on an assumed bearing along the south line of said Section 14, a distance of 864.86 feet; thence North 02 degrees 47 minutes 00 seconds West 133.07 feet to the northwesterly right-of-way line of the Burlington Northern Railroad to an iron pipe in place, to the point of beginning of the tract to be described; thence South 67 degrees 33 minutes 06 seconds West along said right-of-way line to the intersection with the west line of the Southeast Quarter of the Southwest Quarter, Section 14; thence northerly along said west line to the thread of stream of the Sauk River; thence northeasterly, northwesterly, northerly and northeasterly along said thread of stream to the intersection of a line monumented by two iron pipes in place, bearing North 02 degrees 47 minutes 00 seconds West from the point of beginning; thence South 02 degrees 47 minutes 00 seconds East to the point of beginning.

SECTION 1. The City of Cold Spring, pursuant to Minnesota Statutes Section 414.033, subd. 5, hereby annexes the following described land, as follows:

SECTION 2. The City Council of the City of Cold Spring hereby finds and determines that the above-described land in Section 14 and Section 23, Wakefield Township, is owned by the petitioner, abuts upon the present territorial limits of the City of Cold Spring, is unplatted and does not exceed 200 acres in size, is conditioned as to be properly subject to municipal government, and such land is deemed to be urban or suburban in character or about to become so, and the annexation of said land will be in the best interests of the City of Cold Spring and the above-described land.

SECTION 3. The land described in Section 1 above and outlined in the map attached hereto and incorporated herein as "Exhibit A," is hereby annexed, added to, and made part of the City of Cold Spring, Minnesota, as effectually as if it had been originally a part thereof.

SECTION 4. This ordinance shall take effect and be enforced from and after its passage, publication, and approval by the Minnesota Municipal Board.

Enacted by the City Council for the City of Cold Spring, Minnesota, this 14th day of July, 1992.

CITY OF COLD SPRING

By Earl R. Dargensen
Mayor

ATTEST:

Verena M. Weber
City Clerk-Treasurer

Published in the Cold Spring Record on the 28th day of July, 1992.

Verena M. Weber
City Clerk-Treasurer

RECEIVED BY
MMR APR 02 1992

CITY OF COLD SPRING MINNESOTA

RIEKE • CARROLL • MULLER
ASSOCIATES INC.
ARCHITECTS • ENGINEERS • PLANNERS

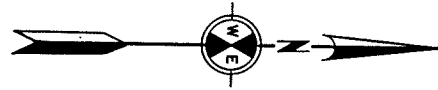

ROCORI HIGH SCHOOL
ATHLETIC FIELD

ROCORI
SCHOOL

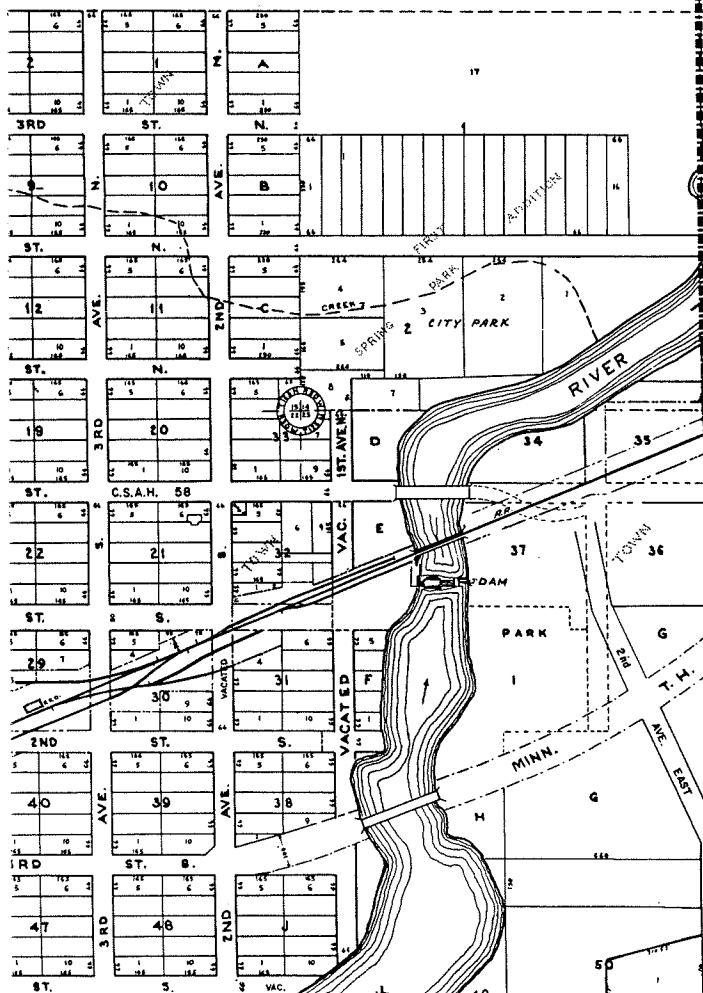
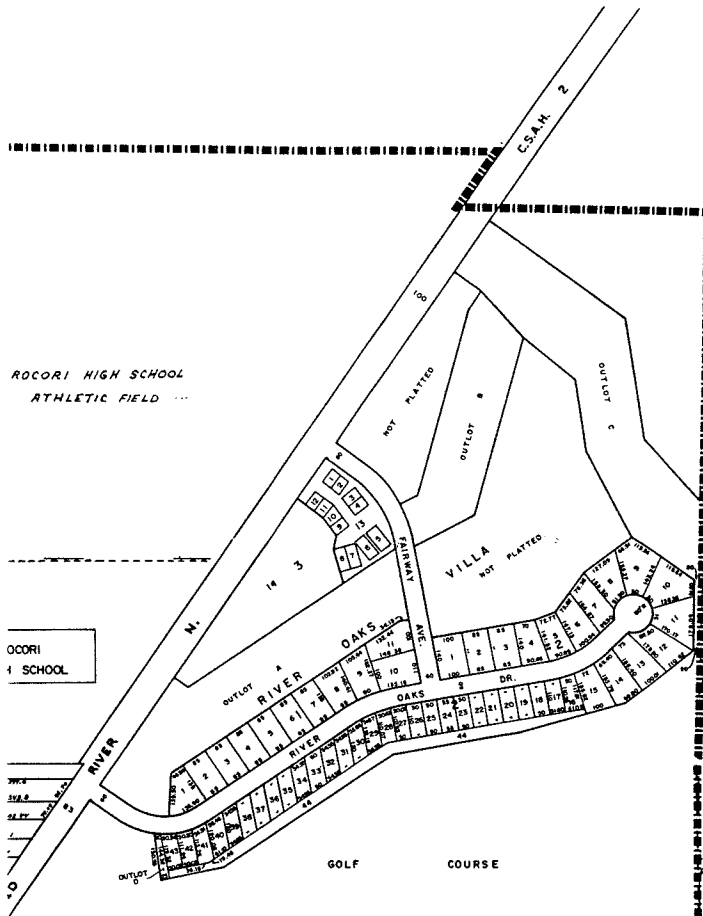

*Lance
Stone
Property*

*CITY OF COLD
SPRING PROPERTY*

NO. 23
To St. Cloud

MINN.
CORPORATE