

REC'D. BY
MMLB JUN 21 1991

Proposed Ordinance No. 7/91

ORDINANCE NO. 1032

AN ORDINANCE EXTENDING THE CORPORATE LIMITS OF THE CITY OF OWATONNA TO INCLUDE CERTAIN UNINCORPORATED, PLATTED AND UNPLATTED LAND ABUTTING UPON THE CITY LIMITS OF THE CITY OF OWATONNA.

WHEREAS, the property herein described is more than sixty percent (60%) bordered by the City of Owatonna and is less than forty (40) acres in area; and

WHEREAS, the property described is 9.18 acres in area, no part of which is included within the limits of an incorporated city; and

WHEREAS, on April 29, 1991, notification was given to the Owatonna Township Board of Supervisors, Steele County Board of Commissioners and the Minnesota Municipal Board; and

WHEREAS, the Owatonna Town Board has waived any objection to the annexation; and

WHEREAS, the City of Owatonna is a city of the third class operating under a Home Rule Charter adopted pursuant to the provisions of the Constitution and Laws of the State of Minnesota.

NOW THEREFORE, THE CITY COUNCIL OF THE CITY OF OWATONNA DO ORDAIN:

SECTION 1. The City Council hereby determines:

1. That the annexation will be to the best interest of the City of Owatonna and of the property affected.
2. The property herein described abuts immediately upon the corporate limits of the City of Owatonna and is suitably conditioned for and needs urban government.
3. That none of said territories are now included within the limits of the City.

SECTION 2. That the following described property, referred to in the preamble of this ordinance, situated in the County of Steele, State of Minnesota, to-wit:

All that land in the Northwest Quarter of Section 8, Township 107 North, Range 20 West, described as:

Lying South of the North line of the Northwest Quarter of said Section 8 and North of the Crane Creek Industrial Addition that is currently not within the City of Owatonna. Property includes Outlot A, Frerichs Addition; Lots 1 and 2, Block 1, Frerichs Addition; portions of U.S. Highway 14 and 28th Avenue N.W. right-of-way; and unplatted properties bounded on the South by Lots 2 and 7, Block 1, and Outlot A, Crane Creek Industrial Addition.

be and the same hereby is annexed to the City of Owatonna and shall, upon the effective date of this ordinance, become a part of the City of Owatonna as effectively as if it had been originally a part thereof, and the corporate limits of said City of Owatonna are hereby extended to include said unplatted land.

SECTION 3. The Zone Class B-2 , "Community Business," shall be applied to the lands herein described.

SECTION 4. This ordinance is enacted pursuant to the provisions of Minnesota Statutes, Chapter 414, Section 414.033, Subd. 3.

SECTION 5. Upon its adoption, approval and publication, a certified copy of this ordinance shall be filed with each of the following:

- Owatonna Town Clerk
- Minnesota Municipal Board
- Steele County Auditor
- Minnesota Secretary of State

as provided by law.

SECTION 6. This ordinance shall take effect upon its passage, publication and approval by the Minnesota Municipal Board.

Passed and adopted this 18th day of June, 1991, with the following vote: Aye 7; No 0; Absent 0.

Approved and signed this 18th day of June, 1991.

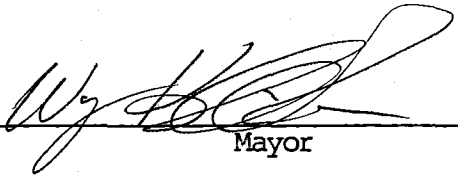

Mayor

ATTEST:



City Clerk

U. S. HIGHWAY NO. 14

---2666.60'---

---1135.60'---

---822'---

RESIDENCE 2

BOARD & CARE FACILITY 1

FREICHS ADD.

350'

130'

130'

90'

220'

505'

RESIDENCE

RESIDENCE

VACANT

RESIDENCE

RESIDENCE & TWO BUSINESSES

RESIDENCE

366.01'

365'

91.50'

PROPOSED ANNEXATION

9.18 ACRES

CRANE CREEK

BLOCK 2

393.15'

394.56'

505'

505'

4

INDUSTRIAL

O. L. A

BLOCK 1

28TH AVE. NW.

436.80'

437.82'

438.83'

364.80'

365'

365'

570'

570'

570'

7

6

5

OWATONNA
STEELE CO

REC'D. BY
MMB APR 29 1991

OFFICE OF C

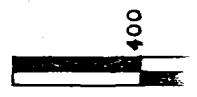
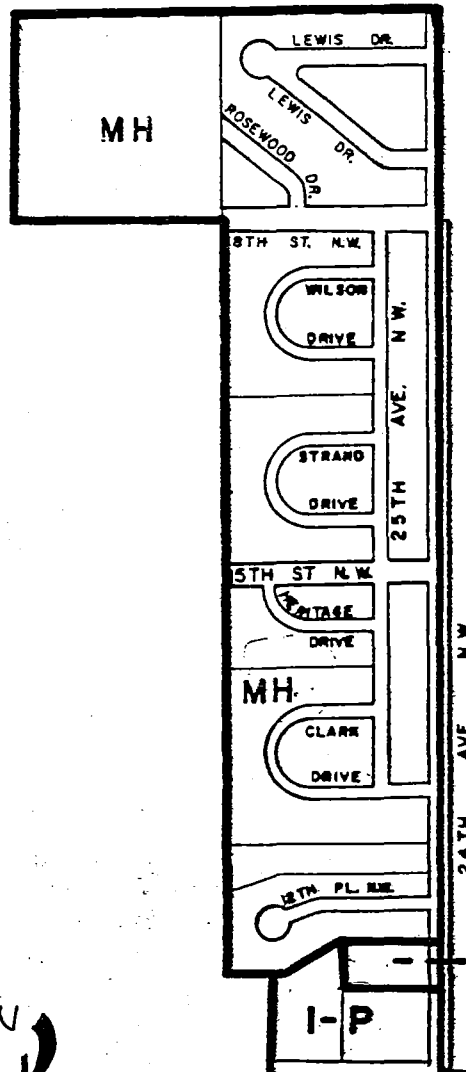

ZONING MAP OF
ORDINANCE
ADOPTED BY C
APRIL
REVISED

PROPOSED ANNEXATION

DRAWN BY: D.R.H., S.D

U.S. HIGHWAY NO. 14

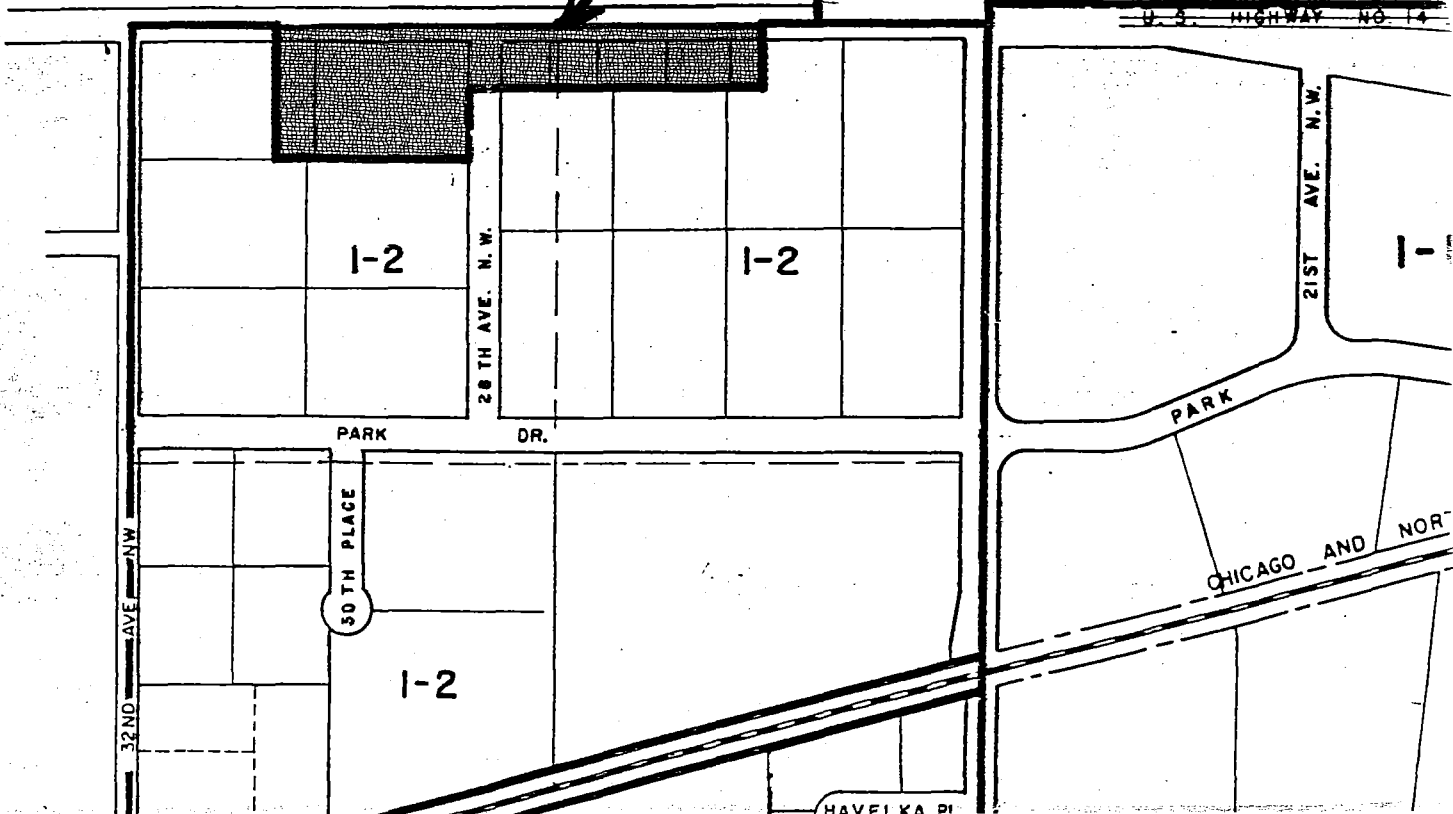

REC'D. BY APR 29 1991

M.A.M.B.

D E F G H I J K L M N O P Q

OWATONNA, MINNESOTA

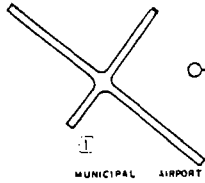

MUNICIPAL AIRPORT

0 1/2 MILE 1 MILE



PROPOSED ANNEXATION

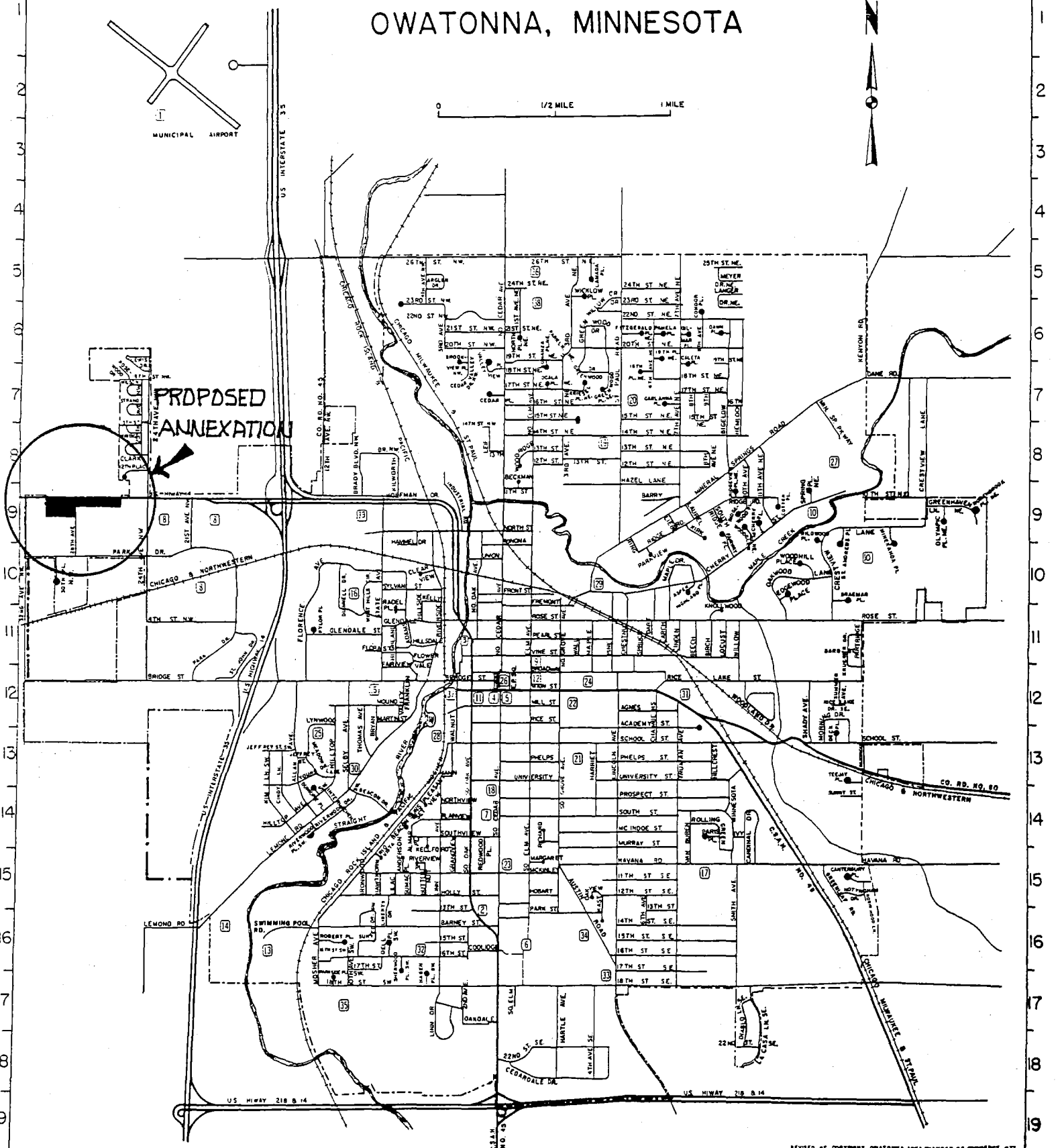

A B C D E F G H I J K L M N O P Q