

# City of Owatonna

REC'D. BY  
M.M.B. APR 29 1991

## PLANNING AND ZONING DEPARTMENT

April 29, 1991

### NOTICE OF PROPOSED ANNEXATION BY THE CITY OF OWATONNA

Pursuant to Minnesota Statutes 414.033, Subd. 3, the City of Owatonna is submitting notification of its intent to annex by Ordinance property in the Northwest Quarter of Section 8, Township 107 North, Range 20 West described as:

Lying South of the North line of the Northwest Quarter of said Section 8 and North of the Crane Creek Industrial Addition that is currently not within the City of Owatonna. Property includes Outlot A, Frerichs Addition; Lots 1 and 2, Block 1, Frerichs Addition; portions of U.S. Highway 14 and 28th Avenue N.W. right-of-way; and unplatted properties bounded on the South by Lots 2 and 7, Block 1, and Outlot A, Crane Creek Industrial Addition.

Said property is more than 60 percent bordered by existing City limits and is 9.18 acres in area. The property proposed for annexation includes platted and unplatted land and portions of street right-of-ways. The properties are developed and include a board and care facility, two businesses, and six residences.

The purpose for the annexation is:

- Property is bordered on three sides by existing city limits.
- City services are available to the properties.
- Board and Care facility is expanding.
- At least one on-site septic system is failing and others may be hooked into a tile line.

This notice is dated April 29th, 1991, and I certify that it was mailed on or before that same date. Failing notification, the City will finalize the annexation ordinance after 90 days from service of notice.

REC'D. BY APR 29 1991  
MMB

Notices have been sent to:

✓ Minnesota Municipal Board  
Owatonna Township  
Steele County Board of Commissioners

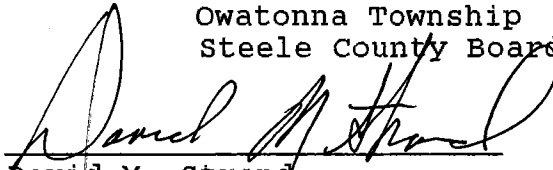
  
David M. Strand  
Director of Planning  
City of Owatonna  
540 West Hills Circle  
Owatonna, MN. 55060

(507)451-4541

U. S. HIGHWAY NO. 14

---2666.60'---

---1135.60'---

---822'---

RESIDENCE

BOARD & CARE FACILITY

RESIDENCE

RESIDENCE

VACANT

RESIDENCE

RESIDENCE & TWO BUSINESSES

RESIDENCE

90'

366.01'

365'

91.50'

130'

130'

130'

350'

2

1

---220'---

PROPOSED ANNEXATION

9.18 ACRES

436.80'

7

437.82'

O. L. A

438.83'

INDUSTRIAL

ADD.

505'

CREEK

1

394.56'

28TH AVE. NW.

364.80'

365'

BLOCK I

RANE

393.15'

BLOCK

2

505'

6

5

570'

570'

570'

4

OWATONNA  
STEELE CO

REC'D. BY  
MMB APR 29 1991

OFFICE OF C

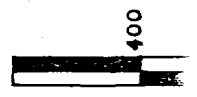
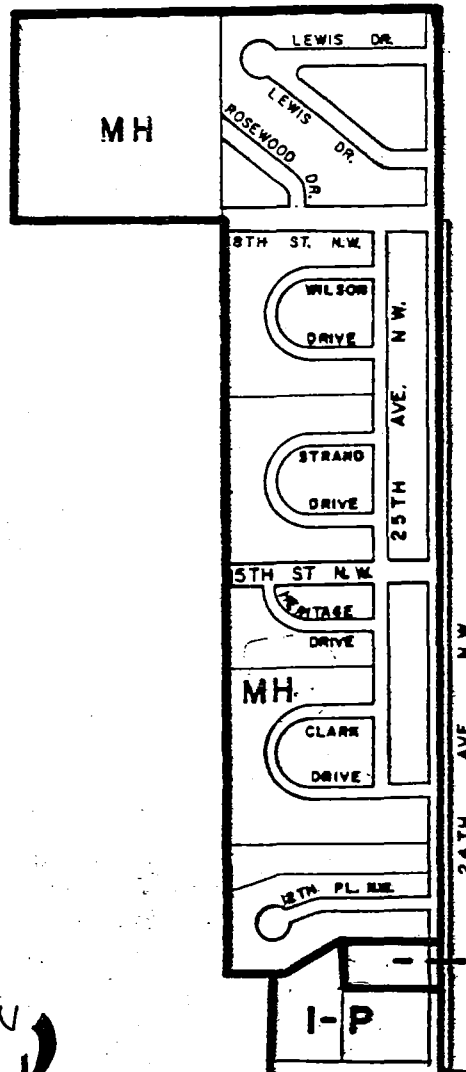

ZONING MAP OF  
ORDINANCE  
ADOPTED BY C  
APRIL  
REVISED

PROPOSED ANNEXATION

DRAWN BY: D.R.H., S.D

U.S. HIGHWAY NO. 14

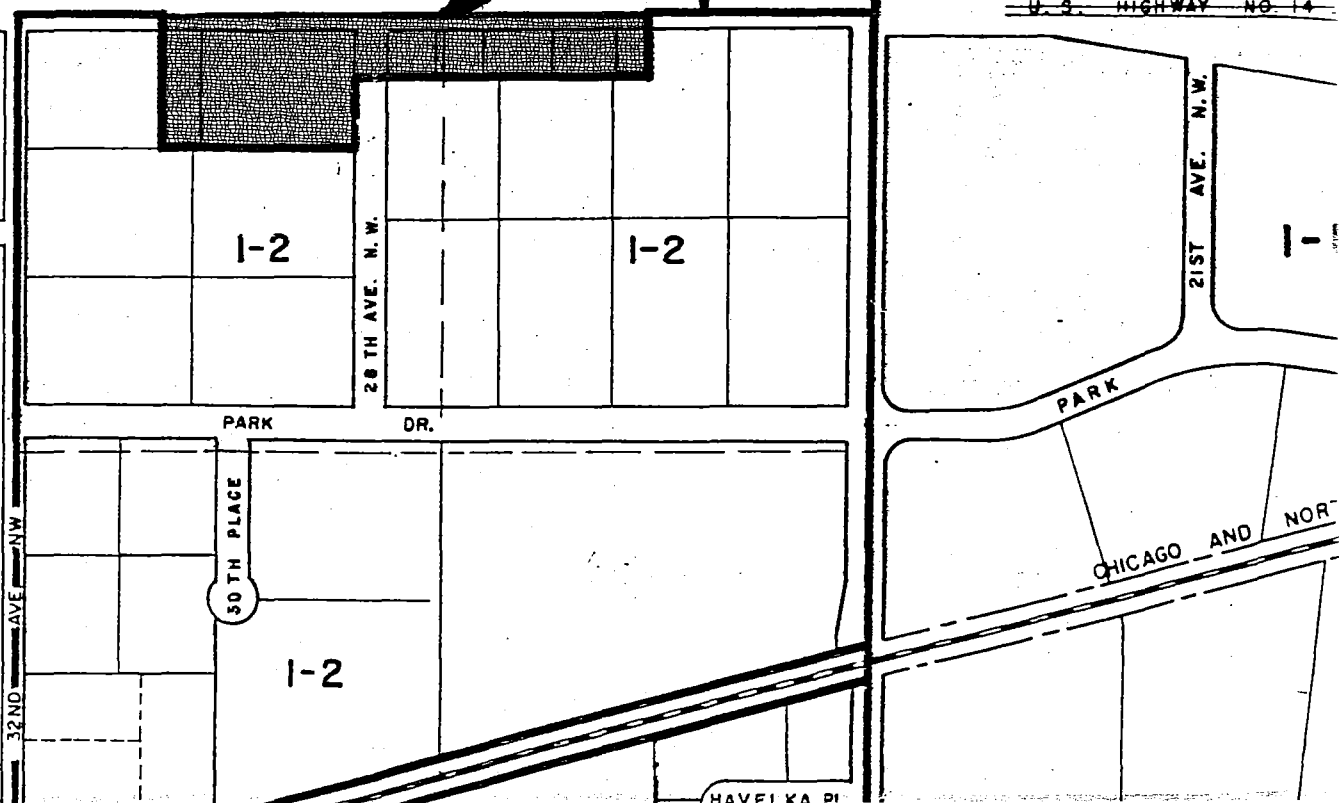

REC'D. BY APR 29 1991

M.A.M.B.

D E F G H I J K L M N O P Q

# OWATONNA, MINNESOTA

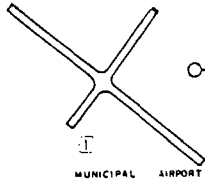

MUNICIPAL AIRPORT

0 1/2 MILE 1 MILE



**PROPOSED ANNEXATION**

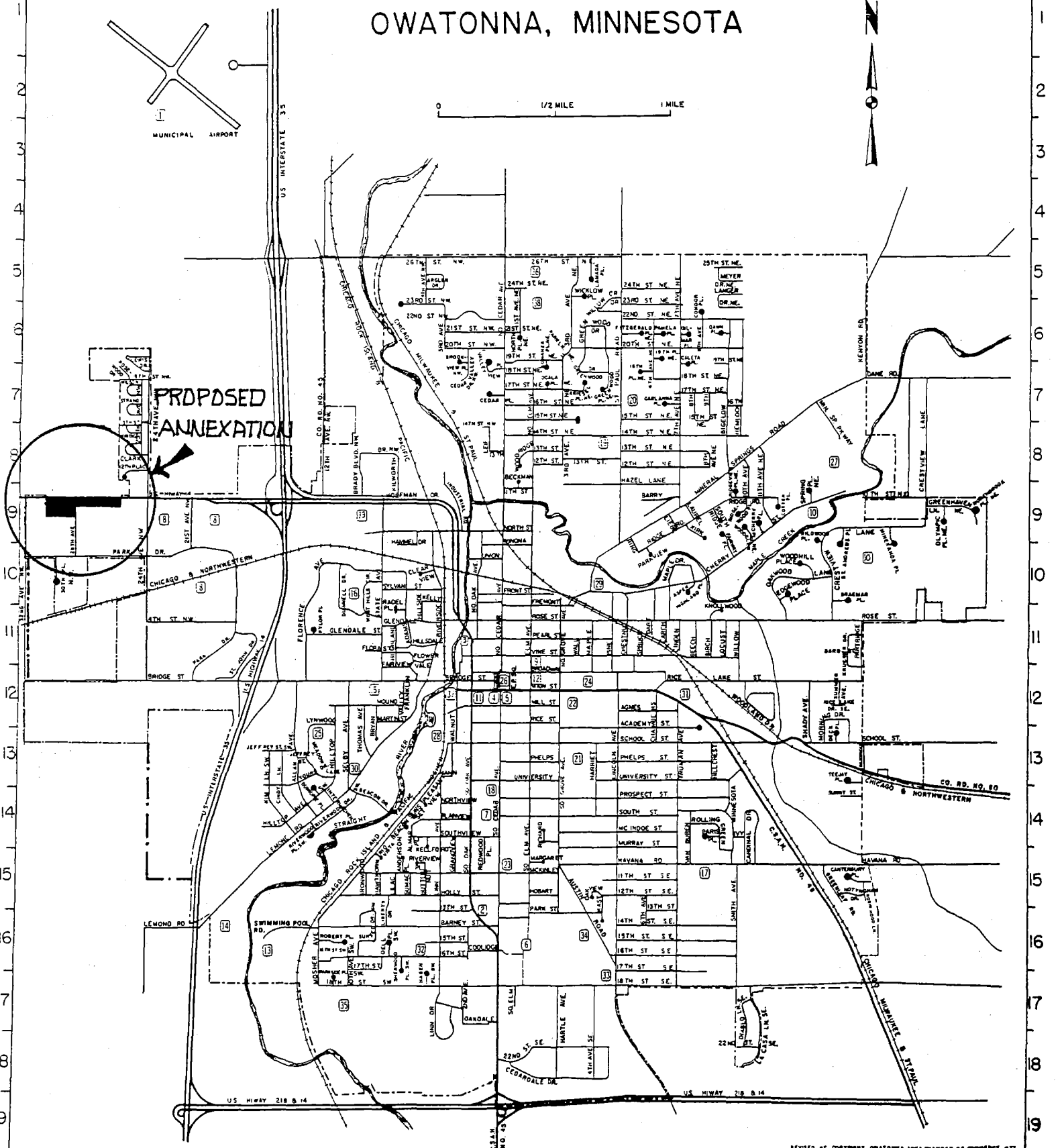

A B C D E F G H I J K L M N O P Q