

IN THE MATTER OF THE PETITION OF  
VIRGINIA JONES, INDIVIDUALLY AND AS WIFE OF CLARENCE A. JONES,  
AND AS PERSONAL REPRESENTATIVE OF THE  
ESTATE OF CLARENCE A. JONES, DECEASED

FOR ANNEXATION TO THE CITY OF MEDFORD  
PURSUANT TO MINNESOTA STATUTES 414.033, SUBD. 5

-----  
TO: Council of the City of Medford, Minnesota

and

Minnesota Municipal Board  
165 Metro Square Building  
St. Paul, Minnesota 55101

PETITIONER STATES: A majority of the property owners in number are required to commence a processing for annexation under Minnesota Statutes 414.033, subdivision 5.

It is hereby requested by all of the property owners of the area proposed for annexation to annex certain property described herein lying in the Town of Medford to the City of Medford, County of Steele, State of Minnesota.

The area proposed for annexation is described as follows:

A strip of land 60.00 feet in width in that part of the South half of the South Half of Section 8, Township 108 North, Range 20 West, Steele County, Minnesota, being 30.00 feet on each side of the following described centerline:

Commencing at the South Quarter Corner of said Section 8; thence South 89 degrees 20 minutes 51 seconds West assumed bearing, 148.22 feet along the south line of the Southwest Quarter of Section 8 to the east line of Minnesota Department of Transportation Plat 74-4 as recorded in the Office of the Steele County Recorder; thence North 07 degrees 14 minutes 43 seconds West 249.50 feet along the east line of said plat to the point of beginning of the centerline to be described;

thence South 89 degrees 44 minutes 21 seconds East 509.50 feet, parallel with the south line of the Southeast Quarter of Section 8; thence North 33 degrees 45 minutes 00 seconds East 269.79 feet; thence South 89 degrees 44 minutes 21 seconds East 849.38 feet to the west line of the Corporate Limits of Medford, being 61.00 feet southerly of the westerly extension of the south line of the plat of Jones Second Addition as recorded in the Office of the Steele County Recorder, and there terminating.

RECD. BY  
MMB JAN 28 1991

The side lines of said easement are prolonged or shortened to begin at the east line of Minnesota Department of Transportation Right of Way Plat No. 74-4.

The petitioner further states:

1. There is one (1) property owner in the area proposed for annexation.
2. All property owners have signed this Petition.
3. The population of the annexation area is 0.
4. The property is unincorporated, abuts the city's West boundary and is not included within any other municipality.
5. The area of land to annex in acres is:  
Platted: None Unplatted: 2.24 acres Total: 2.24 acres
6. The reason for the requested annexation is to better serve property with municipal services not otherwise available.
7. All of the annexation area is or is about to become urban or suburban in character.
8. The area proposed for annexation is not included in any area that has already been designated for orderly annexation pursuant to Minnesota Statutes Section 414.0325.

PETITIONER HEREBY REQUESTS: That pursuant to Minnesota Statutes Section 414.033, Subdivision 5, the property described herein be annexed to and included within the City of Medford.

Dated:

Jan 11-1991

Virginia Jones  
Virginia Jones, individually and  
as wife of Clarence A. Jones, and  
as Personal Representative of  
Estate of Clarence A. Jones,  
deceased

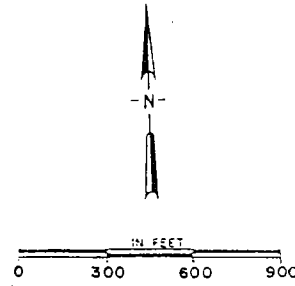

# CITY OF MEDFORD

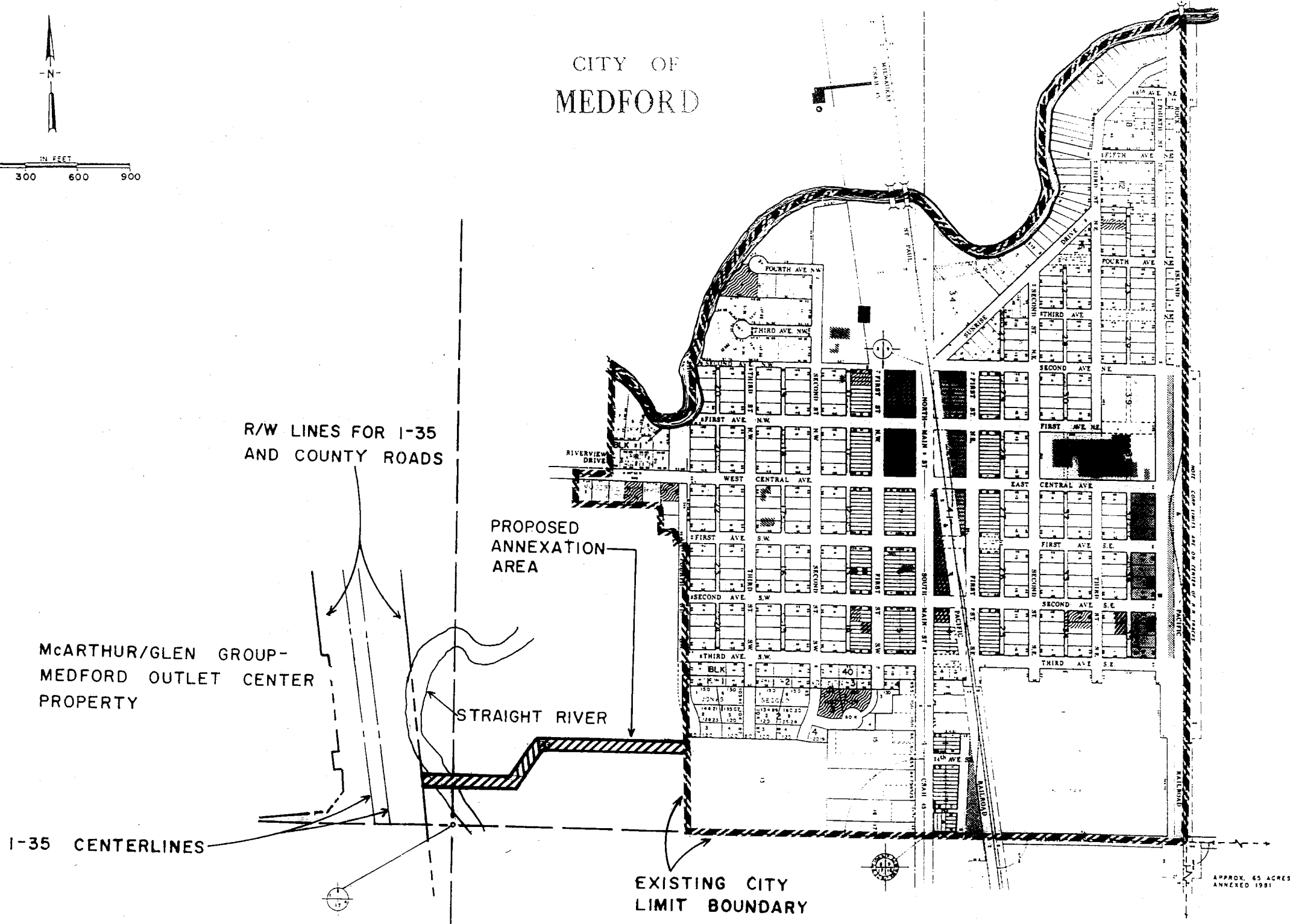

APPROX. 65 ACRES  
ANNEXED 1991