

ORDINANCE NO.

2724

REC'D. BY
MMB

MAR 07 1991

AN ORDINANCE RELATING TO ANNEXATION; ANNEXING TO THE CITY OF ROCHESTER APPROXIMATELY 15.11 ACRES OF LANDS SITUATED IN PORTIONS OF THE NORTHEAST QUARTER OF SECTION 15, ROCHESTER TOWNSHIP.

THE COMMON COUNCIL OF THE CITY OF ROCHESTER DO ORDAIN:

Section 1. A petition has been filed with the Common Council of the City of Rochester, signed by the owner of land described herein, requesting the Common Council to annex said land to the City of Rochester. The land described in said petition for annexation is located in Rochester Township, Olmsted County, Minnesota, and is described together with adjacent public road right-of-way as follows:

That part of the Northwest Quarter of the Northeast Quarter of Section 15, Township 106 North, Range 14 West, Olmsted County, Minnesota, described as follows:

Commencing at the northwest corner of said Northeast Quarter; thence easterly on a Minnesota State Plane Grid Azimuth from north of 88 degrees 20 minutes 54 seconds along the north line of said Northeast Quarter 772.00 feet; thence southerly 178 degrees 20 minutes 54 seconds azimuth 36.31 feet to the center line Woodcrest Lane S.W. formerly County Road "D" and the point of beginning; thence continue southerly 178 degrees 20 minutes 54 seconds azimuth 568.53 feet; thence easterly 88 degrees 20 minutes 54 seconds azimuth 68.00 feet; thence southerly 178 degrees 20 minutes 54 seconds azimuth 489.47 feet; thence easterly 88 degrees 20 minutes 54 seconds azimuth 482.67 feet to the southwesterly corner of Woodland Hills, according to the plat thereof on file at the County Recorder's Office, Olmsted County; thence northerly 358 degrees 07 minutes 23 seconds azimuth along the westerly line of said Woodland Hills also being the east line of said Northwest Quarter of the Northeast Quarter 1074.42 feet to the center line of said Woodcrest Lane S.W.; thence westerly 266 degrees 37 minutes 40 seconds azimuth along said center line 546.69 feet to the point of beginning.

Said tract contains 12.66 acres more or less.

Also:

That part of the Northwest Quarter of the Northeast Quarter of Section 15, Township 106 North, Range 14 West, Olmsted County, Minnesota, described as follows:

Commencing at the northwest corner of said Northeast Quarter; thence easterly on a Minnesota State Plane Grid Azimuth from north of 88 degrees 20 minutes 54 seconds along the north line of said Northeast Quarter 772.00 feet; thence southerly 178 degrees 20 minutes 54 seconds azimuth 36.31 feet to the center line of Woodcrest Lane S.W. formerly County Road "D" and the

point of beginning; thence continue southerly 178 degrees 20 minutes 54 seconds azimuth 365.00 feet; thence westerly 268 degrees 20 minutes 54 seconds azimuth 336.10 feet to the center line of C.S.A.H. No. 147 (18th Avenue S.W.); thence northerly 11 degrees 31 minutes 56 seconds azimuth along said center line 374.07 feet to the intersection with the center line of said Woodcrest Lane S.W.; thence easterly 62.44 feet along said center line on a nontangential curve concave northerly having a central angle of 12 degrees 25 minutes 31 seconds a radius of 287.94 feet and a chord azimuth of 92 degrees 50 minutes 26 seconds; thence easterly 86 degrees 37 minutes 40 seconds azimuth along said center line 188.74 feet to the point of beginning.

Said tract contains 2.45 acres more or less.

Said petition has also been filed with the Town Board of Rochester Township, with the County Board of the County of Olmsted, and with the Minnesota Municipal Board, and the Town Board of Rochester Township has notified the City that it has no objections to the annexation of the above-described land.

Section 2. The quantity of land included in said petition is approximately 15.11 acres in size.

Section 3. The Common Council of the City of Rochester does hereby determine that the land described in Section 1 abuts upon the present territorial limits of the City of Rochester, is so conditioned as to be properly subjected to municipal government, and the annexation of said land will be in the best interest of the City of Rochester and the land described.

Section 4. Therefore, the land described in Section 1 above is hereby annexed, added to and made a part of the City of Rochester, Minnesota, as effectually as if it had originally been a part thereof.

Section 5. Present and future owners of the lands annexed by this ordinance are hereby notified that in addition to the usual assessments, it is the intention of the Common Council to assess against benefited property all or a portion of the cost of any storm sewer, water tower, pumping station, and trunk line sanitary sewer construction, heretofore or hereafter undertaken to serve the area annexed.

Section 6. This ordinance shall take effect and be in force from and after its official publication and from and after the filing of a certified copy hereof with the Minnesota Municipal board, the Rochester Town Clerk, the County Auditor, and the Secretary of State.

REC'D. BY
MMB MAR 07 1991

PASSED AND ADOPTED BY THE COMMON COUNCIL OF THE CITY OF
ROCHESTER, MINNESOTA, THIS 20 DAY OF Feb, 1991.

Deane B. Selby
PRESIDENT OF SAID COMMON COUNCIL

ATTEST: Carole G. Busman
CITY CLERK

APPROVED THIS 21 DAY OF Feb, 1991.

Acting Deane B. Selby
MAYOR OF SAID CITY

(Seal of the City of
Rochester, Minnesota)

MAR 07 1991

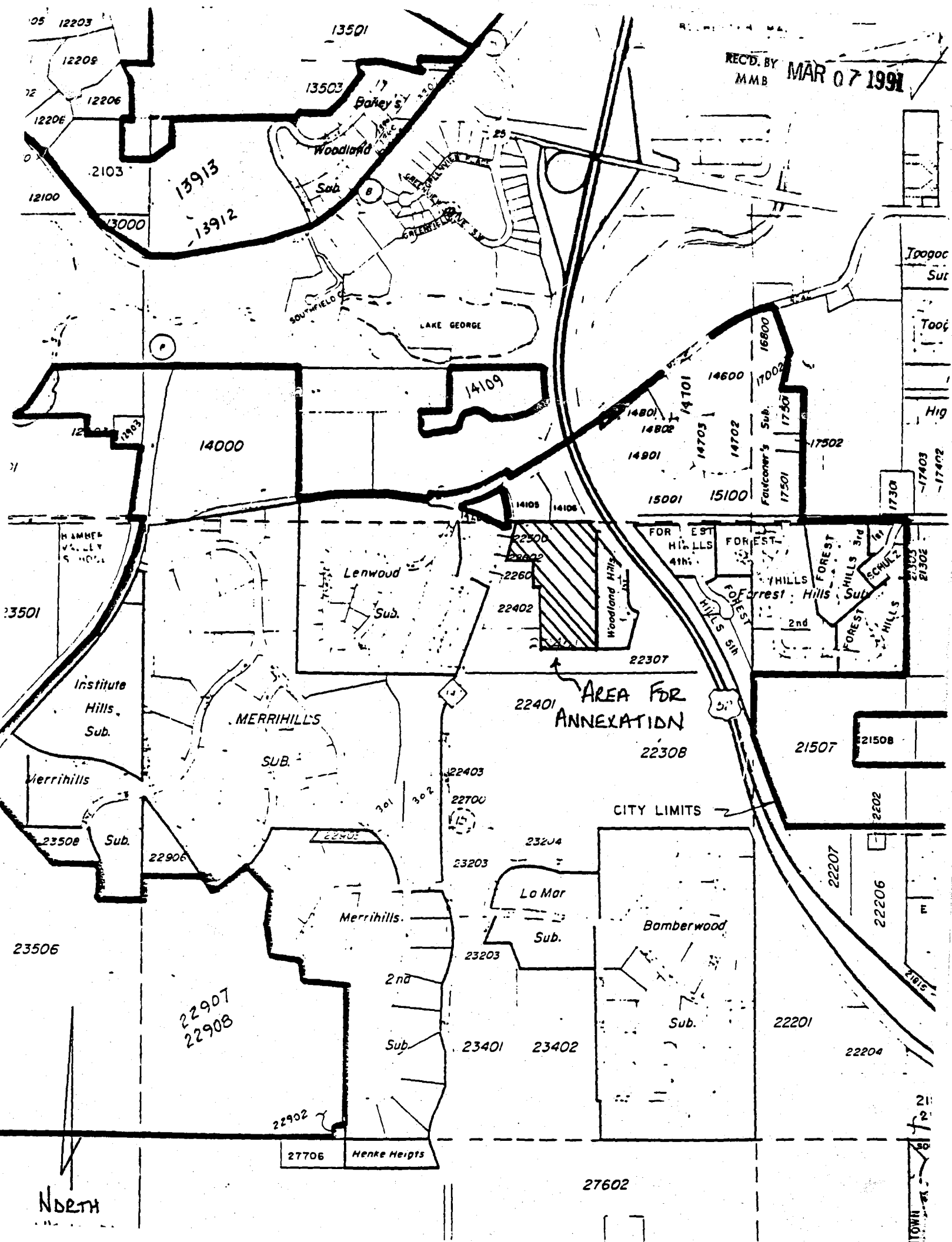

REC'D. BY
M M B

MAR 07 1991

A-4

R-1

AREA FOR
ANNEXATION

A-4

OUT

R-10

CITY LIMITS

R-1

ELIMINATE
ADDITIONAL

R

- A-1 AGRICULTURAL PROTECTION DISTRICT
A-2 AGRICULTURAL PROTECTION DISTRICT
A-3 AGRICULTURAL DISTRICT
A-4 AGRICULTURAL-URBAN EXPANSION DISTRICT
ARC AGRICULTURAL RESIDENTIAL CLUSTER DISTRICT
RSD RURAL SERVICE CENTER DISTRICT
RA RURAL RESIDENTIAL DISTRICT
R-1 LOW DENSITY RESIDENTIAL DISTRICT
R-2 MIXED LOW DENSITY RESIDENTIAL DISTRICT
R-3 MEDIUM DENSITY RESIDENTIAL DISTRICT

RC RECREATIONAL COMMERCIAL DISTRICT
CS COMMERCIAL SERVICE DISTRICT
HC HIGHWAY COMMERCIAL DISTRICT
I INDUSTRIAL
MI MEDICAL INSTITUTIONAL

FW FLOODWAY DISTRICT
FFA FLOOD FRINGE DISTRICT
FFB FLOOD FRINGE DISTRICT
FP FLOOD PLAIN DISTRICT

A - 4