

PETITION FOR ANNEXATION BY ORDINANCE

IN THE MATTER OF THE PETITION OF
JAMES L. WANOUS, DANIEL J. WANOUS, AND MARY LOU BAILEY
FOR ANNEXATION PURSUANT TO MINNESOTA STATUTES 414.033, SUBD. 5

TO: Council of the City of Owatonna, Minnesota.

Minnesota Municipal Board
165 Metro Square Building
St. Paul, Minnesota 55101

PETITIONERS STATE: The property owner or a majority of the property owners in number are required to commence a proceeding under M.S. 414.033, Subd. 5.

It is hereby requested by all of the property owners to annex certain property described herein lying in the Town of Owatonna to the City of Owatonna, County of Steele, Minnesota.

The area proposed for annexation is described as follows:

The north 6 feet of that part of the South 70 acres of the Northeast Quarter of Section 22, Township 107 North, Range 20 West lying east of the center of the Owatonna and Austin Road.

AND

The Northeast Quarter of Section 22, Township 107 North, Range 20 West,

EXCEPT: *The South 70 acres thereof;*

AND EXCEPT: *That portion thereof lying West of the so-called Austin Road, formerly known as the Owatonna and Austin Road;*

AND EXCEPT: *Beginning at a point on the North line of said Northeast Quarter that is 140 feet East of the center of the Old Austin Road; thence East 160 feet; thence South 180 feet; thence West 160 feet, thence North 180 feet to the point of beginning;*

AND EXCEPT: *Commencing at the Southwest corner of the Northwest Quarter of said Northeast Quarter, thence East 282.45 feet along the South line of said Northwest Quarter of said Northeast Quarter to a point on the centerline of the public highway (known as the Old Austin Road), being the True Point of Beginning; thence North 38 degrees 21.5 minutes West 98.69 Feet along the center line of said highway; thence North 68 degrees 48.5 minutes East 392.97 feet; thence South 21 degrees 11.5 minutes East 165 feet; thence South 68 degrees 48.5 minutes West 342 Feet to the centerline of said Highway; thence North 38 degrees 21.5 minutes West 74 feet to the True Point of Beginning.*

AND FURTHER EXCEPT: *Beginning at a point on the North line of said Northeast Quarter at the intersection of said North line and the center of the Old Austin Road; thence East along said North line 140 feet; thence South 180 feet; thence west 140 feet, more or less to a point on the centerline of said Old Austin Road; thence in a Northerly direction along said centerline to the point of beginning.*

1. There are 3 property owners in the area proposed for annexation.
2. All property owners or their signatory has signed this petition.
3. The population of the area is 0.
4. Said property is unincorporated, abuts on the city's southerly boundary and is not included within any other municipality.
5. The area of land to be annexed is unplatted and totals 84.2 acres.
6. The reason for the requested annexation is the property is bounded on three sides by city limits line; city services are adjacent to and available; and a multi family housing development is being proposed for a portion of the property. This development requires an urban level of services.
7. All of the annexation area is or is about to become urban or suburban in character.
8. The area proposed for annexation is not included in any area that has already been designated for orderly annexation pursuant to M.S. 414.0325.

PETITIONERS REQUEST: That pursuant to M.S. 414.033, the property described herein be annexed to and included within the City of Owatonna.

Dated: 11-9-90

James L. Wanas
Daniel J. Wanas
by James Wanas under power of Attorney
Mary Lou Bailey
by James Wanas under power of Attorney

OWATONNA, MINNESOTA

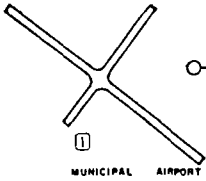

MUNICIPAL AIRPORT

0 1/2 MILE 1 MILE



OWATONNA AREA
Chamber of Commerce

REC'D BY
M.M.B. NOV 14 1990

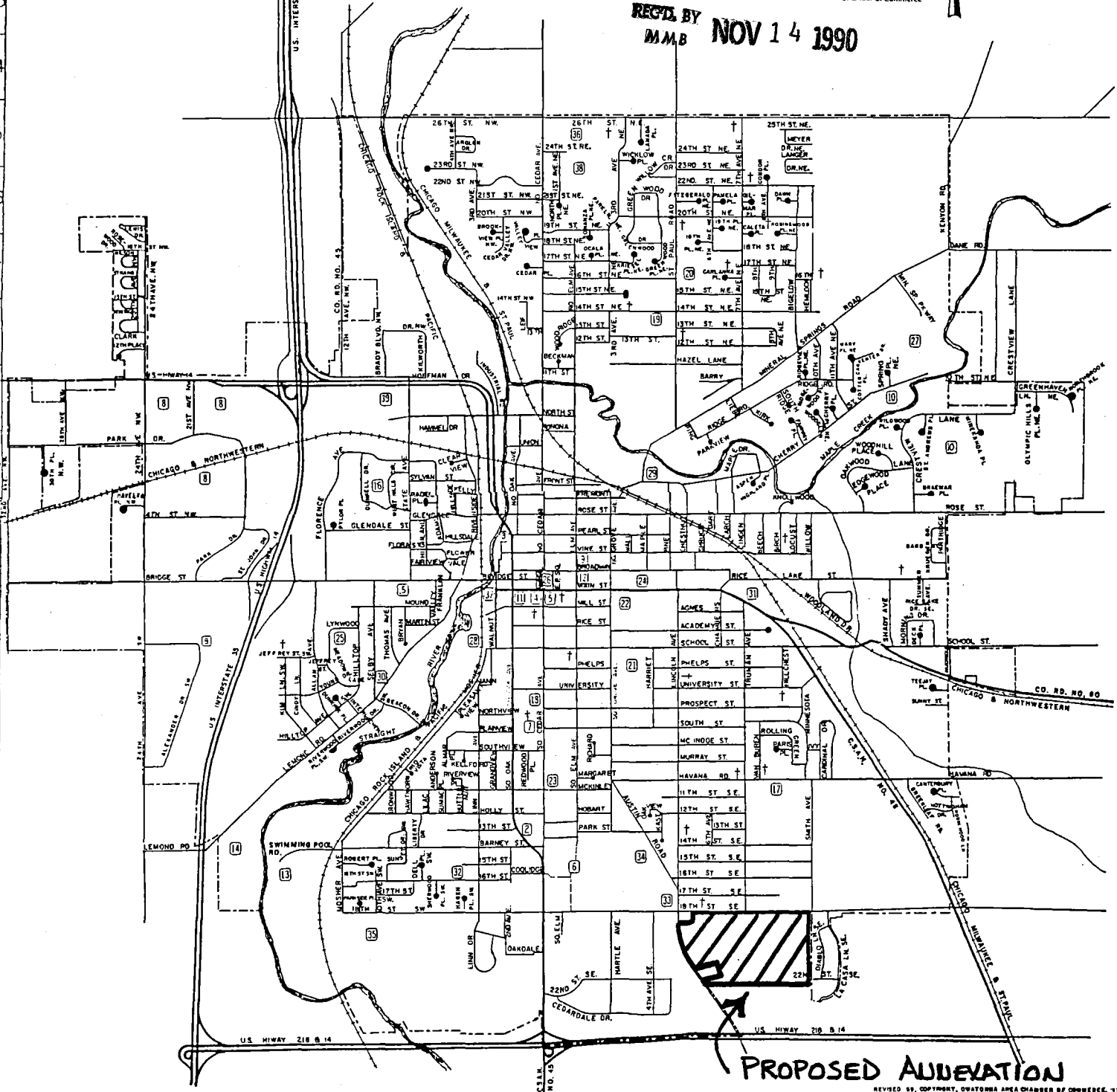

PROPOSED ANNEXATION

REVISED 59, COPYRIGHT, OWATONNA AREA CHAMBER OF COMMERCE, '77

PUBLIC BUILDINGS & LOCATIONS

Map #	Name
1	Airport
2	Bus Depot
3	Chamber of Commerce
14	Country Club
5	Court House (Steele County)
6	Fairgrounds & 4 Seasons Bldg.

Code
C-1
I-17
H-11
D-16
I-12
I-16
I-19

Map #
10
11
12
13
16

Name
Municipal Golf Course (Brooktree)
Municipal Utilities
Police & Sheriff Dept.
Post Office
Swimming Beach-Kohlmer Lake
West Hills: Arts Council, City

Code
N-9
H-12
H-12
I-12
E-16

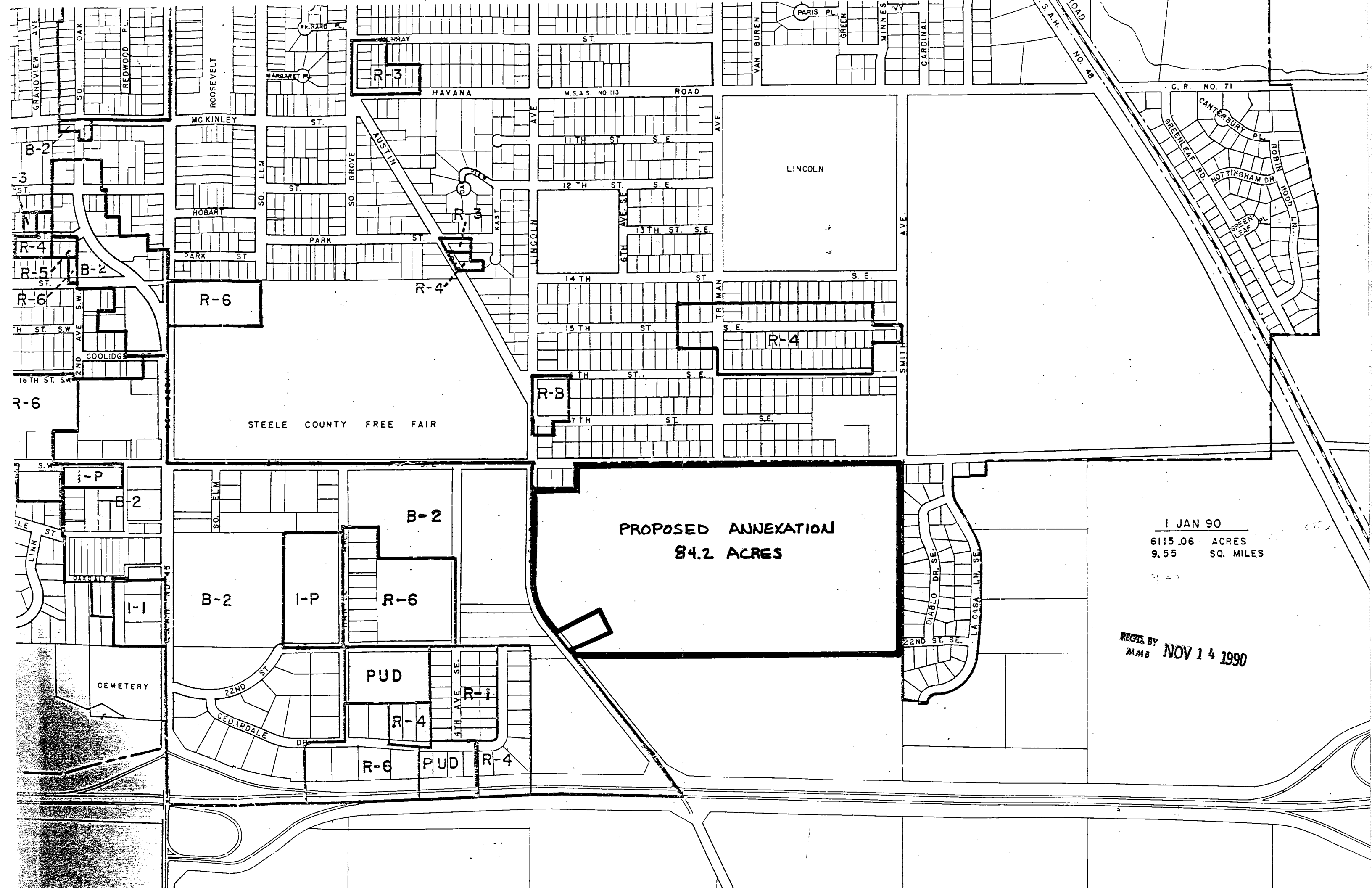

R-3

HAVANA

M.S.A.S. NO. 113

ROAD

LINCOLN

R-6

R-4

R-4

R-3

STEELE COUNTY FREE FAIR

PROPOSED ANNEXATION
84.2 ACRES

B-2

B-2

I-P

R-6

PUD

R-4

R-6

PUD

R-4

1 JAN 90

6115.06 ACRES
9.55 SQ. MILES

REC'D BY
MMB NOV 14 1990