

REC'D. BY
MMB DEC 26 1990

ORDINANCE NO. 2716

AN ORDINANCE ANNEXING TO THE CITY OF ROCHESTER, MINNESOTA, APPROXIMATELY 19.68 ACRES OF LAND IN THE NORTHWEST QUARTER OF SECTION 30, TOWNSHIP 107 NORTH, RANGE 13 WEST, HAVERHILL TOWNSHIP, OLNSTED COUNTY, MINNESOTA.

THE COMMON COUNCIL OF THE CITY OF ROCHESTER DO ORDAIN:

Section 1. A petition has been filed with the Common Council of the City of Rochester, signed by the owner of land described herein, requesting the Common Council to annex said land to the City of Rochester. The land described in said petition for annexation is located in Haverhill Township, Olmsted County, Minnesota, and is described together with adjacent public road right-of-way as follows:

That part of the Northwest Quarter of Section 30, Township 107 North, Range 13 West, Olmsted County, Minnesota, described as follows:

Commencing at the southwest corner of said Northwest Quarter; thence northerly on a Minnesota State Plane Grid Azimuth from north of 359 degrees 42 minutes 20 seconds along the west line of said Northwest Quarter 985.44 feet; thence easterly 89 degrees 42 minutes 20 seconds azimuth 370.41 feet to the southwesterly corner of Northern Heights East Third Subdivision; thence northeasterly 36 degrees 13 minutes 12 seconds azimuth along the northwesterly line of Northern Heights East Third Subdivision 531.04 feet to the northerly corner of Northern Heights East Third Subdivision and the easterly corner of Northern Heights East Sixth Subdivision and the point of beginning; thence northwesterly 314 degrees 50 minutes 14 seconds azimuth along the northeasterly line of Northern Heights East Sixth Subdivision 384.34 feet; thence northeasterly 36 degrees 13 minutes 12 seconds azimuth 416.74 feet; thence southeasterly 120 degrees 06 minutes 40 seconds azimuth 382.17 feet; thence northeasterly 36 degrees 13 minutes 12 seconds azimuth 372.97 feet; thence southeasterly 116 degrees 13 minutes 12 seconds azimuth 189.46 feet; thence southeasterly 128 degrees 49 minutes 01 seconds azimuth 117.85 feet; thence northeasterly 38 degrees 49 minutes 01 seconds azimuth 180.32 feet; thence southeasterly 128 degrees 49 minutes 01 seconds azimuth 786.21 feet to the center line of C.S.A.H. No. 2; thence westerly 260 degrees 51 minutes 05 seconds azimuth along said center line 4.71 feet; thence southwesterly 420.35 feet along said center line on a tangential curve concave southeasterly, having a radius of 572.96 feet and a central angle of 42 degrees 02 minutes 04 seconds; thence southwesterly 218 degrees 49 minutes 01 seconds azimuth along said center line 367.41 feet; thence northwesterly 306 degrees 13 minutes 12 seconds azimuth 913.30 feet; thence southwesterly 216 degrees 13 minutes 12 seconds azimuth 313.08 feet to the point of beginning.

Said tract contains 19.68 acres more or less.

Said petition has also been filed with the Town Board of Haverhill Township, with the County Board of the County of Olmsted, and with the Minnesota Municipal Board, and the Town Board of Haverhill Township has notified the City that it has no objections to the annexation of the above-described land.

Section 2. The quantity of land included in said petition is approximately 19.68 acres in size.

Section 3. The Common Council of the City of Rochester does hereby determine that the land described in Section 1 abuts upon the present territorial limits of the City of Rochester, is so conditioned as to be properly subjected to municipal government, and the annexation of said land will be in the best interest of the City of Rochester and the land described.

Section 4. Therefore, the land described in Section 1 above is hereby annexed, added to and made a part of the City of Rochester, Minnesota, as effectually as if it had originally been a part thereof.

Section 5. Present and future owners of the lands annexed by this ordinance are hereby notified that in addition to the usual assessments, it is the intention of the Common Council to assess against benefited property all or a portion of the cost of any storm sewer, water tower, and trunk line sanitary sewer construction, heretofore or hereafter undertaken to serve the area annexed.

Section 6. This ordinance shall take effect and be in force from and after its official publication and from and after the filing of a certified copy hereof with the Minnesota Municipal board, the Haverhill Town Clerk, the County Auditor, and the Secretary of State.

PASSED AND ADOPTED BY THE COMMON COUNCIL OF THE CITY OF ROCHESTER, MINNESOTA, THIS 10 DAY OF Dec, 1990.

Nancy B. Selby
PRESIDENT OF SAID COMMON COUNCIL

ATTEST: Cara A. Johnson
CITY CLERK

APPROVED THIS 11 DAY OF Dec, 1990.

Charles H. ...
MAYOR OF SAID CITY

(Seal of the City of Rochester, Minnesota)



AREA FOR ANNEXATION

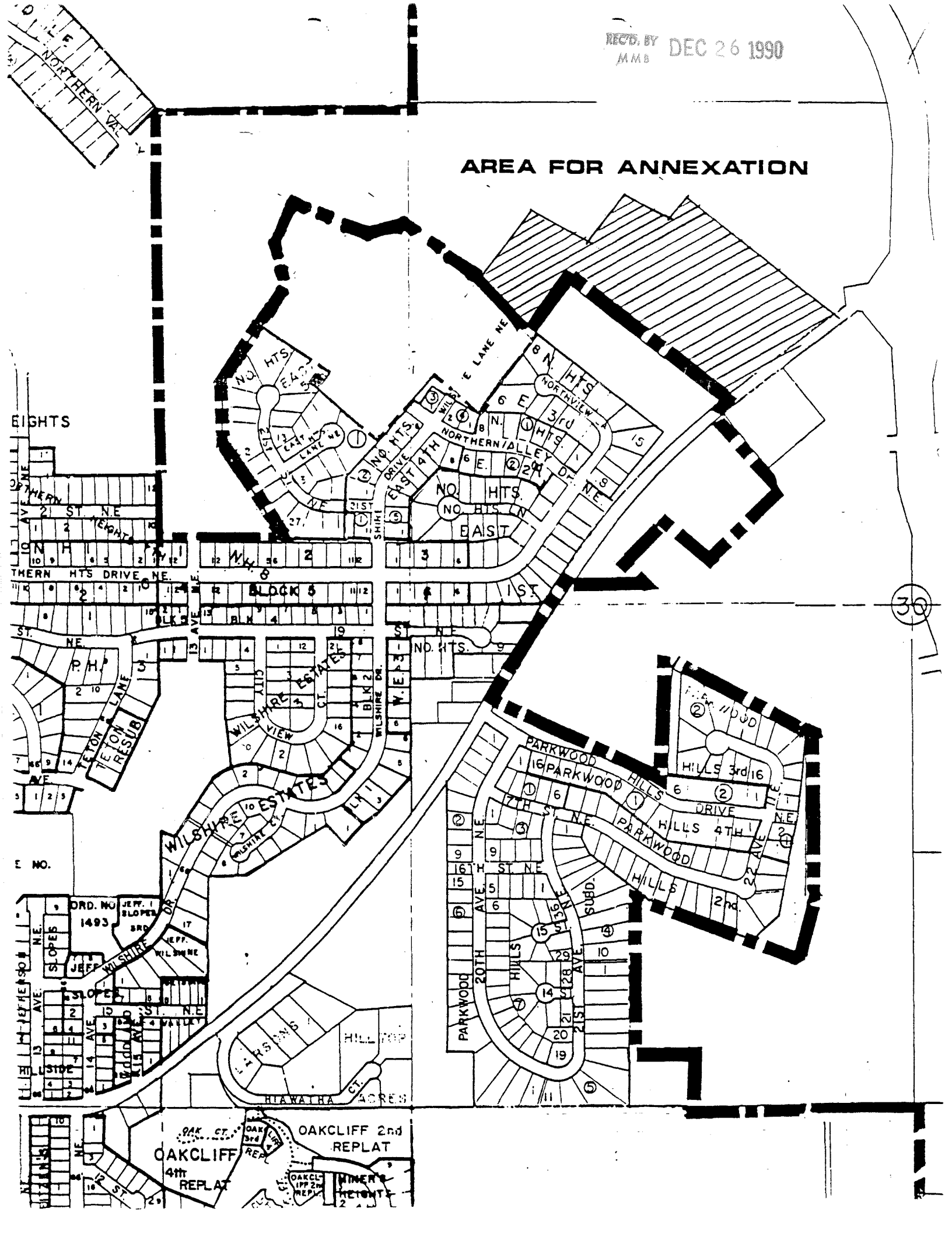

30

RIGHTS

E. NO.

ORD. NO. 1493
 JEFF. SLOPER BRD.
 JEFF. WILSHIRE
 WILSHIRE
 HILL TOP
 HIAWATHA CT. ACRES
 OAKCLIFF 2nd REPLAT
 OAKCLIFF 4th REPLAT
 OAKCLIFF 2nd REPLAT
 OAKCLIFF 2nd REPLAT