

ORDINANCE NO. 361

AN ORDINANCE EXTENDING THE CORPORATE LIMITS OF THE  
CITY OF STAPLES

The City Council of the City of Staples does ordain as follows:

Section 1. A petition has been filed with the governing body of the City of Staples, Minnesota by Gary Knosalla and Sandra Knosalla, as the owners of the following described real estate for the purpose of having such real estate included within the City limits of the City of Staples, Minnesota:

SEE ATTACHED LEGAL DESCRIPTION

Section 2. The above described real estate is unplatted and consists of approximately one-half acre and the above petitioners are the sole owners of said property.

Section 3. Notice of the filing of the Petition has been filed with the Town Board of Staples Township, the Todd County Board of Commissioners, the Minnesota Municipal Board and the City of staples and no objections to the Petition have been received.

Section 4. All fees required to be paid by the Petitioners have been duly paid.

Section 5. The City Council hereby determines that the annexation will be to the best interests of the City of Staples, Minnesota and of the territory affected; the real estate described herein abuts upon the City and is so conditioned as properly to be subjected to City government.

Section 6. Therefore, the City of Staples, Minnesota hereby ordains and declares that the property hereinbefore described be, and the same is, hereby annexed to, and included in, the City of Staples, Minnesota, as effectually as if it had originally been a part thereof.

Section 7. This ordinance shall be final and take effect and be in force from and after filing a certified copy thereof with the Minnesota Municipal Commission, Town Clerk of Staples Township, the Todd County Auditor, and the Minnesota Secretary of State.

ATTEST:

APPROVE:

Phil E. Lindaman  
Phil E. Lindaman, City Clerk

John G. Wilson  
John G. Wilson, Mayor

First Reading: October 9, 1990  
Second Reading: October 23, 1990  
Final Passage: October 23, 1990  
Published: November 1, 1990

Certified copy filed with Minnesota Municipal Commission,  
Town Clerk of Staples Township, Todd County Auditor and  
Minnesota Secretary of State

RECEIVED BY  
MMB NOV 01 1990

**DESCRIPTION OF LAND OWNED BY GARY AND SANDRA KNOSALLA TO BE ANNEXED TO THE CITY OF STAPLES:**

A tract of land lying and being in and a part of the Northeast Quarter of the Northwest Quarter (NE $\frac{1}{4}$  OF NW $\frac{1}{4}$ ) of Section 11, Township 133 North, Range 33 West, described as follows: Commencing at the point where the west right of way line of First Street South, as the same is now laid out and platted intersects with the center line of Wisconsin Avenue as the same is now laid out and platted, and which Street and Avenue are parts of the plats of Homedale Addition and Donovans Addition to Staples, and with said point of intersection as the point of beginning, thence northerly along the west right of way line of said First Street a distance of 150 feet; thence westerly and at a right angle a distance of 150 feet; thence southerly at a right angle a distance of 150 feet; thence easterly at a right angle a distance of 150 feet to the point of beginning, all according to the United States Government Survey thereof, including all abutting streets and alleys.

REC'D BY  
HMB AUG 31 1990



Subject  
Tract  
Shaded)

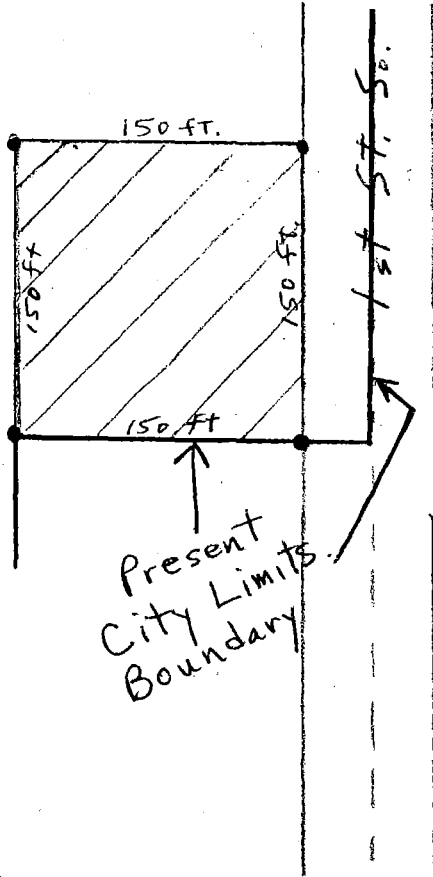
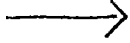

Present  
City Limits  
Boundary

Wisconsin Ave.