

IN THE MATTER OF THE PETITION OF
GARY KNOSALLA AND SANDRA KNOSALLA
FOR ANNEXATION OF LAND TO THE CITY OF STAPLES

PETITION

TO: City of Staples, Todd County Board of Commissioners,
Town Board of Staples Township, and Municipal Board,
State of Minnesota

1. Petitioners herein state that they are the owners in fee of the following described property, and that said property presently abuts the city limits of the City of Staples, Minnesota:

SEE ATTACHED LEGAL DESCRIPTION ALONG WITH MAP THAT SHOWS THE PROPERTY IN QUESTION AND THE PRESENT CITY LIMIT LINE.

2. Petitioners state that the above described property is unplatted and consists of approximately one-half acre, more or less, and that Petitioners are the sole owners of said property.

3. Petitioners further state that the property is now suburban and residential in character and that the petitioners desire the above described property to be annexed by the City of Staples and to be, therefore, included within the City Limits of the City of Staples, Minnesota, and Petitioners hereby make this Petition in accordance with Minnesota Statutes Section 414.033 (Subd. 5).

Dated this 28th day of AUGUST, 1990.

Gary Knosalla
Gary Knosalla

Sandra Knosalla
Sandra Knosalla

REC'D BY
MAMB AUG 31 1990

DESCRIPTION OF LAND OWNED BY GARY AND SANDRA KNOSALLA TO BE
ANNEXED TO THE CITY OF STAPLES

A tract of land lying and being in and a part of the Northeast Quarter of the Northwest Quarter (NE $\frac{1}{4}$ of NW $\frac{1}{4}$) of Section 11, Township 133 North, Range 33 West, described as follows:

Commencing at the point where the west right of way line of First Street South, as the same is now laid out and platted intersects with the center line of Wisconsin Avenue as the same is now laid out and platted, and which street and Avenue are parts of the plats of Homedale Addition and Donovans Addition to Staples, and with said point of intersection as the point of beginning, thence northerly along the west right of way line of said First Street a distance of 150 feet; thence westerly and at a right angle a distance of 150 feet; thence southerly at a right angle a distance of 150 feet; thence easterly at a right angle a distance of 150 feet to the point of beginning, all according to the United States Government Survey thereof, including all abutting streets and alleys.

SEE MAP ON REVERSE SIDE

REC'D BY
HMB
AUG 31 1990



Subject
Tract
Shaded)

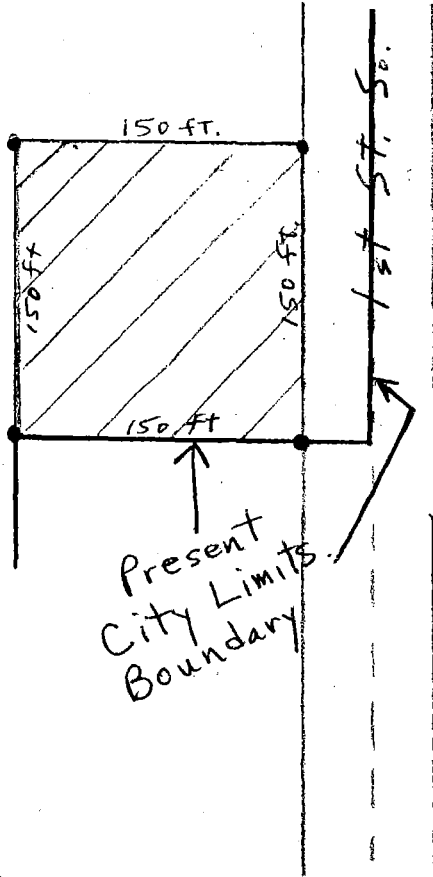
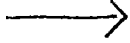

Present
City Limits
Boundary

Wisconsin Ave.