

REC'D. BY
MMB AUG 21 1990

AN ORDINANCE ANNEXING PROPERTY TO THE
CORPORATE LIMITS OF THE CITY OF MANKATO

WHEREAS, certain property, described in the attached legal description, is not presently included in the corporate limits of any incorporated city, village, or burough; and

WHEREAS, pursuant to Minnesota Statutes 414.033, subdivision 5, the owners of said described property have petitioned the City of Mankato for annexation for such property; and

WHEREAS, the property is located adjacent to existing City boundaries and can be served with public utilities; and

WHEREAS, said described property is unplatted and does not exceed 200 acres in area; and

WHEREAS, the total acreage of said described property is approximately 8.1025 acres; and

WHEREAS, there are no persons residing on the property; and

WHEREAS, the Council of the City of Mankato finds that the property is urban in character and objection to the annexation has been withdrawn by the Mankato Township Board of Supervisors by the adoption of an annexation waiver on July 2, 1990.

NOW, THEREFORE, the Council of the City of Mankato hereby ordains that the corporate limits of the City of Mankato are hereby extended to include the land as described in the attached legal, and the same is hereby annexed and included within the City of Mankato as effectively as if it had originally been a part thereof.

The City Clerk is hereby directed to file copies of this ordinance with the Minnesota Municipal Board, the Blue Earth County Auditor, and the Mankato Town Board.

This ordinance shall become effective 30 days after its passage, due publication thereof, and approval by the Minnesota Municipal Board.

Adopted this 13th day of August, 1990.

Vernon Carstensen
Mayor
City of Mankato

ATTEST: 
Sandra R. Paulson
City Clerk

REC'D BY
MMB AUG 21 1990

LEGAL

That part of the Northeast Quarter of the Southwest Quarter of Section 5, Township 108 North, Range 26 West, lying southerly of the southerly right of way line of United States Highway No. 14, and lying easterly of the easterly right of way line of Minnesota Trunk Highway No. 22, and lying westerly of the northerly extension of the centerline of Fourth Street, according to the plat of Duke's Park and lying 100 feet North and parallel with the North line of the plat of Duke's Park, excepting therefrom, that parcel previously annexed described as

Commencing at the point of intersection of the South line of the Northeast Quarter (NW $\frac{1}{4}$) of the Southwest Quarter (SW $\frac{1}{4}$) of Section 5 with the centerline of Fourth Street, according to the Plat of Duke's Park Addition; thence North 07 degrees 12 minutes 58 second East (Blue Earth County NAD 83 Datum) along the centerline of Fourth Street, a distance of 290.00 feet; thence North 07 degrees 26 minutes 00 seconds East, along the centerline of Fourth Street, 217.12 feet to the point of beginning; thence continuing North 07 degrees 26 minutes 00 seconds East along the centerline of Fourth Street, a distance of 124.36 feet to a point on a 432.66 foot radius curve concave to the Southeast, having a central angle of 09 degrees 46 minutes 00 seconds and a 73.66 foot chord which bears South 49 degrees 06 minutes 29 seconds West; thence along the curve 73.75 feet to a point of reverse curve, said curve being 369.04 foot radius curve concave to the Northwest, having a central angle of 20 degrees 55 minutes 43 seconds and a 134.05 foot chord which bears South 54 degrees 41 minutes 21 seconds West; thence along the curve 134.80 feet to the North right of way line of Minerva Street; thence North 89 degrees 04 minutes 55 seconds East along said line, a distance of 149.01 feet to the point of beginning.

Said annexation parcel includes 8.1025 acres.

REC'D BY MMB AUG 21 1990

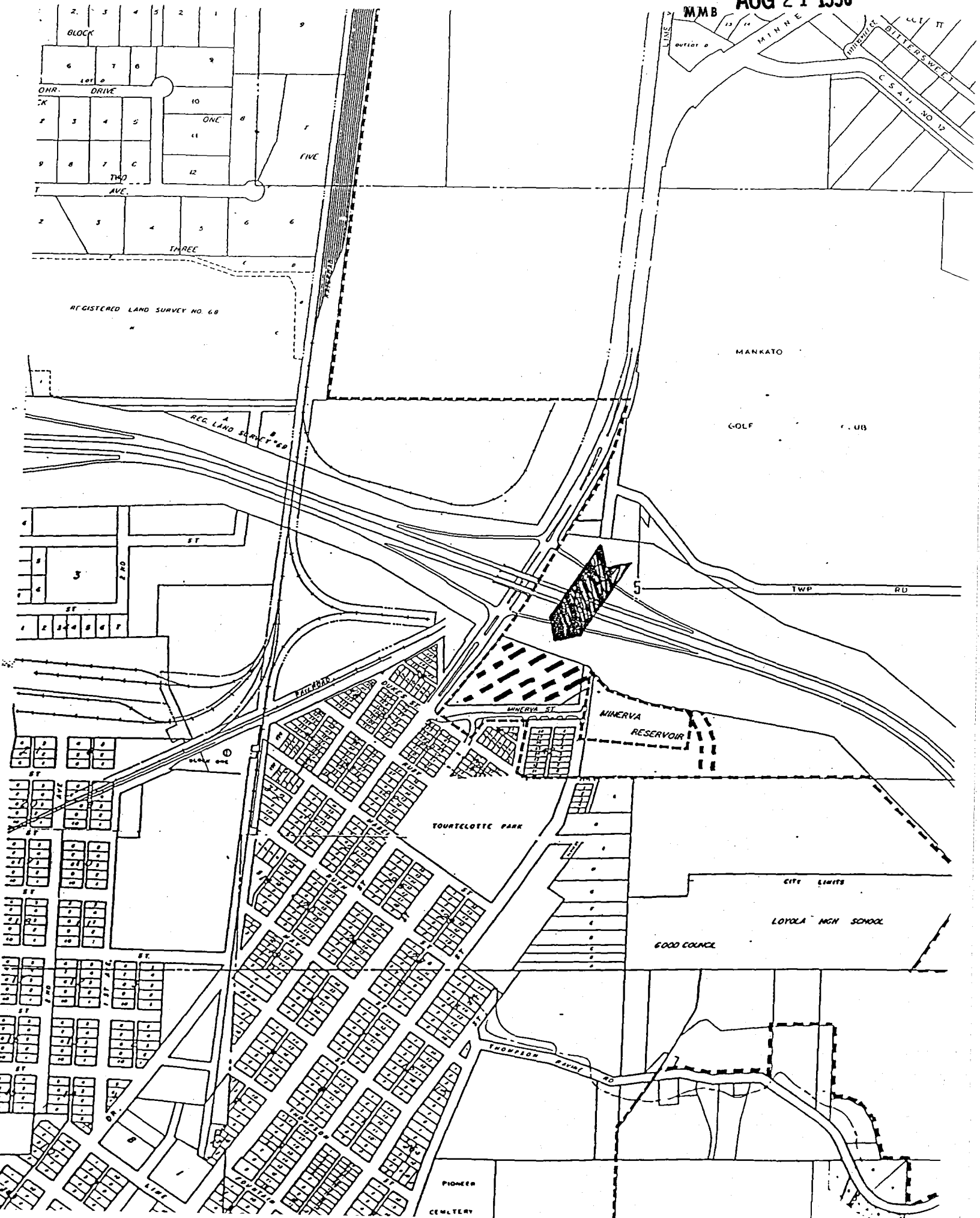

BLOCK
2 3 4 5 2 1
6 7 8 9
10
11
12
THIRD AVE.

REGISTERED LAND SURVEY NO. 68

REG. LAND SURVEY NO. 69

OUTLOT D
MINNE
BITTER SWEET
C.S. 411 NO 12

MANKATO

GOLF

CLUB

TWP RD

MINERVA ST

MINERVA RESERVOIR

TOURTELOTTIC PARK

CITY LIMITS

LOYOLA HIGH SCHOOL

GOOD COUNSEL

THOMPSON PARK RD

PIONEER CEMETERY