

MAY 25 1990

ORDINANCE NUMBER 120-3rd SERIES

AN ORDINANCE EXTENDING THE CORPORATE LIMITS OF THE CITY OF EAST GRAND FORKS TO INCLUDE CERTAIN UNPLATTED LAND IN GOVERNMENT LOT 3, GOVERNMENT LOT 5, AND THE SOUTHEAST QUARTER OF THE SOUTHWEST QUARTER (SE $\frac{1}{4}$ SW $\frac{1}{4}$) OF SECTION SEVEN (7), TOWNSHIP ONE HUNDRED FIFTY ONE (151) NORTH, RANGE FORTY-NINE (49) WEST OF THE FIFTH PRINCIPAL MERIDIAN, POLK COUNTY, MINNESOTA, NOT EXCEEDING TWO HUNDRED ACRES, WHICH TRACT CONTAINS 6.77 ACRES, MORE OR LESS.

The City Council of the City of East Grand Forks, Minnesota, do ordain:

Section 1. A petition has been filed with the City Council of the City of East Grand Forks, Minnesota, by KLK Investments, a Minnesota Partnership consisting of Kerry L. Knoff, Kurt L. Knoff, and Kim L. Knoff, and Park West Limited, a Corporation, being the owners of the land hereinafter described, to have such land included within the city limits of the City of East Grand Forks; that copies of said petition were filed with the Minnesota Municipal Board, the Town Board of Huntsville Township, and the County of Polk, Minnesota; and that a Waiver of Objections has been received from Huntsville Township.

Section 2. That the tract of land being annexed is described as follows, to wit:

That part of Government Lot 3, Government Lot 5, and the Southeast Quarter of the Southwest Quarter of Section 7, Township 151 North, Range 49 West of the 5th Principal Meridian, Polk County Minnesota described as follows:

Beginning at the Northeast corner of Government Lot 4 as shown on the plat of Riverview 3rd Addition, the point of beginning; thence southerly along the east line of said Government Lot 4 having an assumed bearing of South 0 degrees 46 minutes 30 seconds East a distance of 86.91 feet; thence South 89 degrees 22 minutes 21 seconds East a distance 181.97 feet; thence North 0 degrees 37 minutes 39 seconds East a distance 268.85 feet; thence North 19 degrees 52 minutes 21 seconds West a distance of 263.94 feet; thence North 44 degrees 07 minutes 39 seconds East a distance of 203.76 feet; thence North 45 degrees 52 minutes 21 seconds West a distance of 60.00 feet; thence North 44

degrees 07 minutes 39 seconds East a distance of 250.00 feet; thence North 45 degrees 52 minutes 21 seconds West a distance of 400.00 feet; thence North 61 degrees 18 minutes 06 seconds West a distance 202.20 feet to the easterly boundary of Riverview 3rd Addition; thence continuing along said easterly boundary South 13 degrees 16 minutes 08 seconds West a distance of 250.00 feet; thence southeasterly a distance of 70.02 feet along a non-tangential curve concave to the southwest, radius 130.00 feet, chord distance 69.17 feet, chord bearing South 61 degrees 18 minutes 06 seconds East; thence South 45 degrees 52 minutes 21 seconds East a distance of 112.73 feet; thence South 0 degrees 46 minutes 30 seconds East a distance of 66.97; thence South 44 degrees 07 minutes 39 seconds West a distance of 172.57 feet; thence South 45 degrees 52 minutes 21 seconds East a distance of 160.00 feet; thence South 44 degrees 07 minutes 39 seconds West a distance of 40.00 feet; thence southerly a distance of 55.85 feet along a tangential curve concave to the east, radius 50.00 feet, central angle 64 degrees 00 minutes 00 seconds; thence South 19 degrees 52 minutes 21 seconds East a distance of 148.40 feet; thence South 0 degrees 46 minutes 30 seconds East a distance of 293.92 feet to the point of beginning. Containing 6.77 acres more or less.

Section 3. That the City Council hereby determines:

- a. That the quantity of land embraced within the foregoing description is less than 200 acres.
- b. That the annexation will be to the best interests of the City of East Grand Forks, Minnesota, and of the territory affected.
- c. That the territory and land described as above abuts upon the City of East Grand Forks, Minnesota, is suitably conditioned for municipal government and is about to become urban in character.
- d. That the petition for annexation assigned by all of the owners of the land and real estate hereinabove described.

Section 4. The corporate limits of the City of East Grand Forks, Minnesota, are hereby extended to include the property

described in Section 2, and the same is hereby annexed to and included in the City of East Grand Forks, Minnesota, as effectually as if it had originally been a part thereof.

Section 5. The Clerk/Treasurer of the City of East Grand Forks is hereby directed to file certified copies of this Ordinance with the State of Minnesota Municipal Board, the County Auditor of Polk County, the Chairman of the Town Board of Huntsville Township, and the Secretary of State of the State of Minnesota.

Section 6. This Ordinance takes effect upon its passage and publication, and the filing of the certified copy as directed in Section 5, and shall be given the Number 120-3rd Series.

VOTING AYE: Christensen, Wogaman, Casney, Hagen, Olson, Beauchamp, Grassel

VOTING NAY: None

ABSENT: None

The President declared the Ordinance passed.

Passed this 17th day of May, 1990.

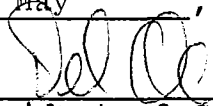

President of City Council

ATTEST:



David E. Mack, City Clerk

I hereby approve the foregoing Ordinance this 22nd day of May, 1990.

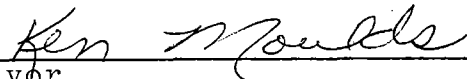

Mayor

mis4\ordinanc.klk

REGD BY APR 19 1990

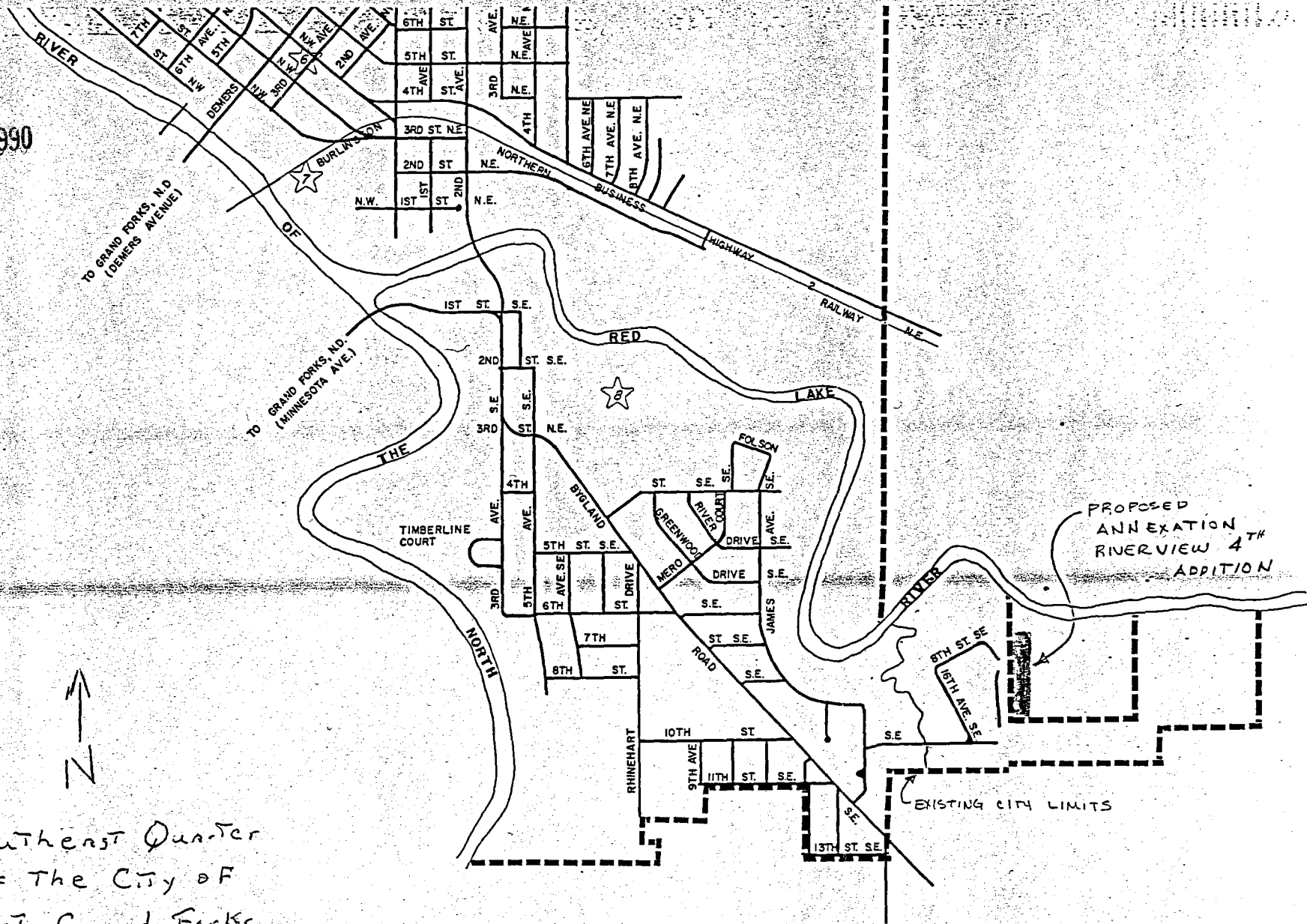

Southeast Quarter
of the City of
East Grand Forks