

An ordinance extending the corporate limits of the City of Minneota to include certain unincorporated property owned by and abutting upon the limits of the City of Minneota.

WHEREAS, the territory described below is not presently within the corporate limits of any incorporated city; and

WHEREAS, this territory abutts upon the corporate limits of the City at the north boundary thereof and is deemed to be urban or suburban in character;

The City Council of the City of Minneota ordains:

Section 1. Territory annexed. The corporate limits of the City of Minneota are hereby extended to include the platted (unplatted) property described as follows: (As Attached)

Section 2. Filing. The property owner is directed to file certified copies of this ordinance with the Secretary of State, the County Auditor of the county in which the property is located, the Town Clerk of the affected township and the Minnesota Municipal Board.

Section 3. Effective date of annexation. This ordinance takes effect upon its passage and publication and the filing of certified copies as directed in Section 2.

Section 4. Effective Date. This ordinance shall be effective from and after its adoption and publication.

Passed and adopted by the Common Council of the City of Minneota this 4th day of December, 1989.

Paul L...
Mayor

ATTEST:

Betty J. Fer

Published in the Minneota Mascot 12/06/89, 1989, and 12/13/89, 1989.

The South 234 feet of the North 250 feet of the East 370.00 feet of the Southeast Quarter of the Northeast Quarter (SE1/4NE1/4) of Section Thirty-five, Township One Hundred Thirteen (113), Range Forty-three (43), Lyon County, Minnesota,

ALSO

An easement for Roadway purposes over and across the South 33.00 feet of the North 166.00 feet of the East 178.30 feet of said SE1/4NE1/4 of said Section 35, Township 113, Range 43.

A-4685
Minneota

MAP OF
MINNEOTA
LYON COUNTY
POP. 1320

REC'D. BY DEC 20 1989
MAB

T 113N T 113N
R 43W R 42W

24|19
25|30

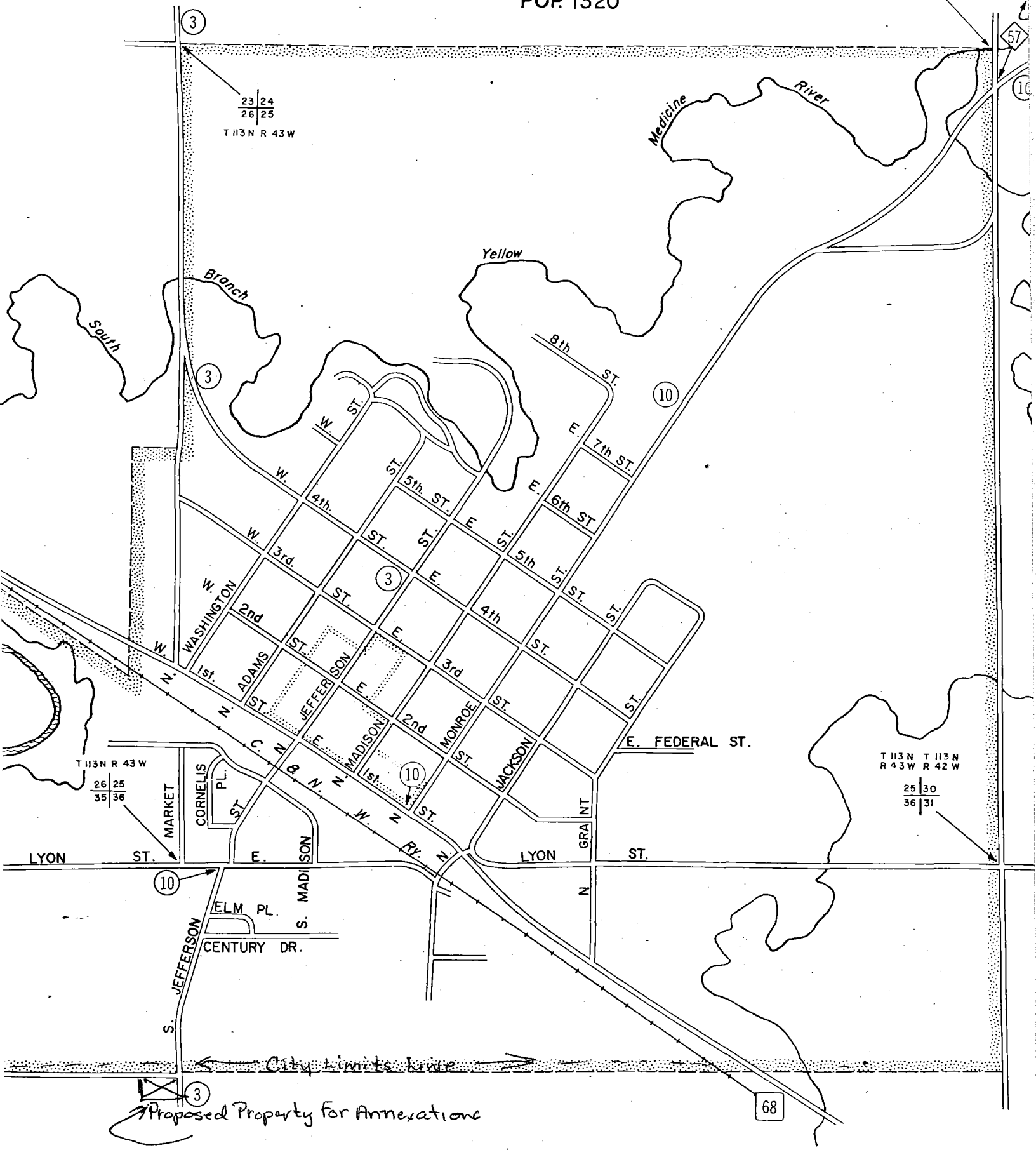

REC'D. BY DEC 20 1989
MMB



→ Property proposed for annexation

↙ Dotted line represents City limits

Parcel A

REC'D. BY
MMB DEC 20 1989

Section 35 Township 113 Range 43
1.06 Acres M or L PT SE4 NE4 EX 297' X 165' for cemetery EX .99 to
Merritt, EX 37.61 acres to Moorse

and

Section 35 Township 113 Range 43
.99 acres M or L PT SE4 NE4 (117' X 370') and Easement of Record