

IN THE MATTER OF THE PETITION OF  
Robert Swan  
For Annexation Pursuant to M.S. 414.033, Subd. 5

REC'D. BY  
MMB  
DEC 20 1989

TO: The City Council of the City of Minneota, Minnesota.

Minnesota Municipal Board  
165 Metro Square Building  
St. Paul, MN 55101

PETITIONERS STATE: The property owner or a majority of the property owners in number are required to commence a proceeding under M.S. 414.033, Subd. 5.

It is hereby requested by:

\_\_\_\_\_ the sole property owner; or  
 X  all of the property owners; or  
\_\_\_\_\_ a majority of the property owners of the area proposed for annexation to annex certain property described herein lying in the Town of Eidsvold Township to the City of Minneota, County of Lyon, Minnesota.

The area proposed for annexation is described as follows:

*SEE Exhibit A & B ATTACHED*

1. There are two (2) property owners in the area proposed for annexation.
2. Both property owners have signed this petition.
3. The population of the annexation area is 3.
4. Said property is unincorporated, abuts on the city's N S E W boundary of the city and is not included within any other municipality.
5. The area of land to be annexed in acres is: \_\_\_\_\_  
Platted  X  Unplatted \_\_\_\_\_ Total \_\_\_\_\_
6. The reason for the requested annexation is: greater police protection and existing City services currently installed.
7. All of the annexation area is or is about to become urban or suburban in character.
8. The area proposed for annexation is not included

in any area that has already been designated for orderly annexation pursuant to M.S. 414.0325.

PETITIONERS REQUEST: That pursuant to M.S. 414.033, the property described herein be annexed to and included within the City of Minneota, Minnesota.

Dated: 10-6-89

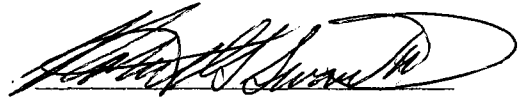

M. J. Buck Swan M.D.

\_\_\_\_\_

\_\_\_\_\_

1988 STATEMENT OF PROPERTY TAX PAYABLE

RECEIPT # 1178

NEW IMPROVEMENTS	ESTIMATED MARKET VALUE	4,000	ASSESSED VALUE	680
			HC	680

YOUR ITEMIZED STATEMENT	
3. STATE *	0.00
4. COUNTY	24.29
5. TOWNSHIP/CITY	6.36
6. SCHOOL	30.06
7. A. REG EIGHT	.09
B. WATR DISTRI	.87

PROPERTY CLASS **RESIDENTIAL FULL HSTD**

Property description for tax purposes only. (The legal description of your property may differ.)

SECT-35 TWP-113 RANG-43  
1.06 ACRES M OR L PT SE4 NE4 EX 297' X 165' FOR CEMETERY EX .99 A TO MERRITT, EX 37.61 ACRES TO MOORSE

8. TAX BEFORE CREDITS 61.67

9. CREDITS WHICH REDUCE YOUR TAX	
A. STATE SCHOOL AGRICULTURAL CREDIT	
B. STATE PAID HOMESTEAD CREDIT	33.67
C.	
D.	

ELIGIBLE FOR A REFUND???

To find out if you're eligible for The Minnesota Property Tax Refund ... fill out Form M-1PR using these amounts.

1. Fill in this amount on line 10	61.67
2. Fill in this amount on line 12	33.67

10. TAX AFTER CREDITS 28.00

\* THE STATE OF MINNESOTA DOES NOT RECEIVE ANY PROPERTY TAX REVENUES. THE STATE OF MINNESOTA REDUCES YOUR PROPERTY TAX BY PAYING CREDITS AND REIMBURSEMENTS TO LOCAL UNITS OF GOVERNMENT.

TAXPAYER 13795

ROBERT G & MARY BIRD SWAN  
RT

MINNEOTA MN 56264

CHECK CASH ESCROW  
ESCROW # 10

SPECIAL ASSESSMENTS	CODE	AMOUNT
INTEREST		
PRINCIPAL		
11. SPECIAL ASSESSMENTS - ADDED TO YOUR TAX		.00
12. TOTAL AMOUNT PAYABLE		28.00
PAY IN FULL		
MAY 15		
		28.00

MAKE CHECKS PAYABLE TO:  
MARILYN KONTZ • COUNTY TREASURER  
LYON COUNTY COURTHOUSE  
MARSHALL, MINNESOTA 56258

NO RECEIPT SENT UNLESS REQUESTED,  
YOUR CANCELLED CHECK IS YOUR RECEIPT

LYON COUNTY EIDSVOLD TOWNSHIP  
1988 STATEMENT OF PROPERTY TAX PAYABLE

TAXPAYER'S STATEMENT PRCL# 05-035010-0  
RECEIPT # 1182

NEW IMPROVEMENTS	ESTIMATED MARKET VALUE	22,400	ASSESSED VALUE	3,808
			HC	3,808

YOUR ITEMIZED STATEMENT	
3. STATE *	0.00
4. COUNTY	139.24
5. TOWNSHIP/CITY	35.61
6. SCHOOL 414	168.33
7. A. REG EIGHT	.51
B. WATR DISTRI	4.88

PROPERTY CLASS **RESIDENTIAL FULL HSTD**

Property description for tax purposes only. (The legal description of your property may differ.)

SECT-35 TWP-113 RANG-43  
.99 ACRES  
M OR L PT SE4 NE4 (117' X 370') AND EASEMENT OF RECORD

8. TAX BEFORE CREDITS 348.57

9. CREDITS WHICH REDUCE YOUR TAX	
A. STATE SCHOOL AGRICULTURAL CREDIT	
B. STATE PAID HOMESTEAD CREDIT	188.57
C.	
D.	

ELIGIBLE FOR A REFUND???

To find out if you're eligible for The Minnesota Property Tax Refund ... fill out Form M-1PR using these amounts.

1. Fill in this amount on line 10	348.57
2. Fill in this amount on line 12	188.57

10. TAX AFTER CREDITS 160.00

\* THE STATE OF MINNESOTA DOES NOT RECEIVE ANY PROPERTY TAX REVENUES. THE STATE OF MINNESOTA REDUCES YOUR PROPERTY TAX BY PAYING CREDITS AND REIMBURSEMENTS TO LOCAL UNITS OF GOVERNMENT.

TAXPAYER 13795

ROBERT G & MARY BIRD SWAN  
RT

MINNEOTA MN 56264

CHECK CASH ESCROW  
ESCROW # 10

SPECIAL ASSESSMENTS	CODE	AMOUNT
INTEREST		
PRINCIPAL		
11. SPECIAL ASSESSMENTS - ADDED TO YOUR TAX		.00
12. TOTAL AMOUNT PAYABLE		160.00
FIRST HALF DUE	SECOND HALF DUE	
MAY 15	OCTOBER 15	
80.00	80.00	

MAKE CHECKS PAYABLE TO:  
MARILYN KONTZ • COUNTY TREASURER  
LYON COUNTY COURTHOUSE  
MARSHALL, MINNESOTA 56258

NO RECEIPT SENT UNLESS REQUESTED,  
YOUR CANCELLED CHECK IS YOUR RECEIPT

AMERICAN BUSINESS FORMS, GLENWOOD, MN 56334

AMERICAN BUSINESS FORMS, GLENWOOD, MN 56334

Exhibit (A)

Exhibit (B)

MAP OF  
MINNEOTA  
LYON COUNTY  
POP. 1320

REC'D. BY DEC 20 1989  
MAB

T 113N T 113N  
R 43W R 42W

24|19  
25|30

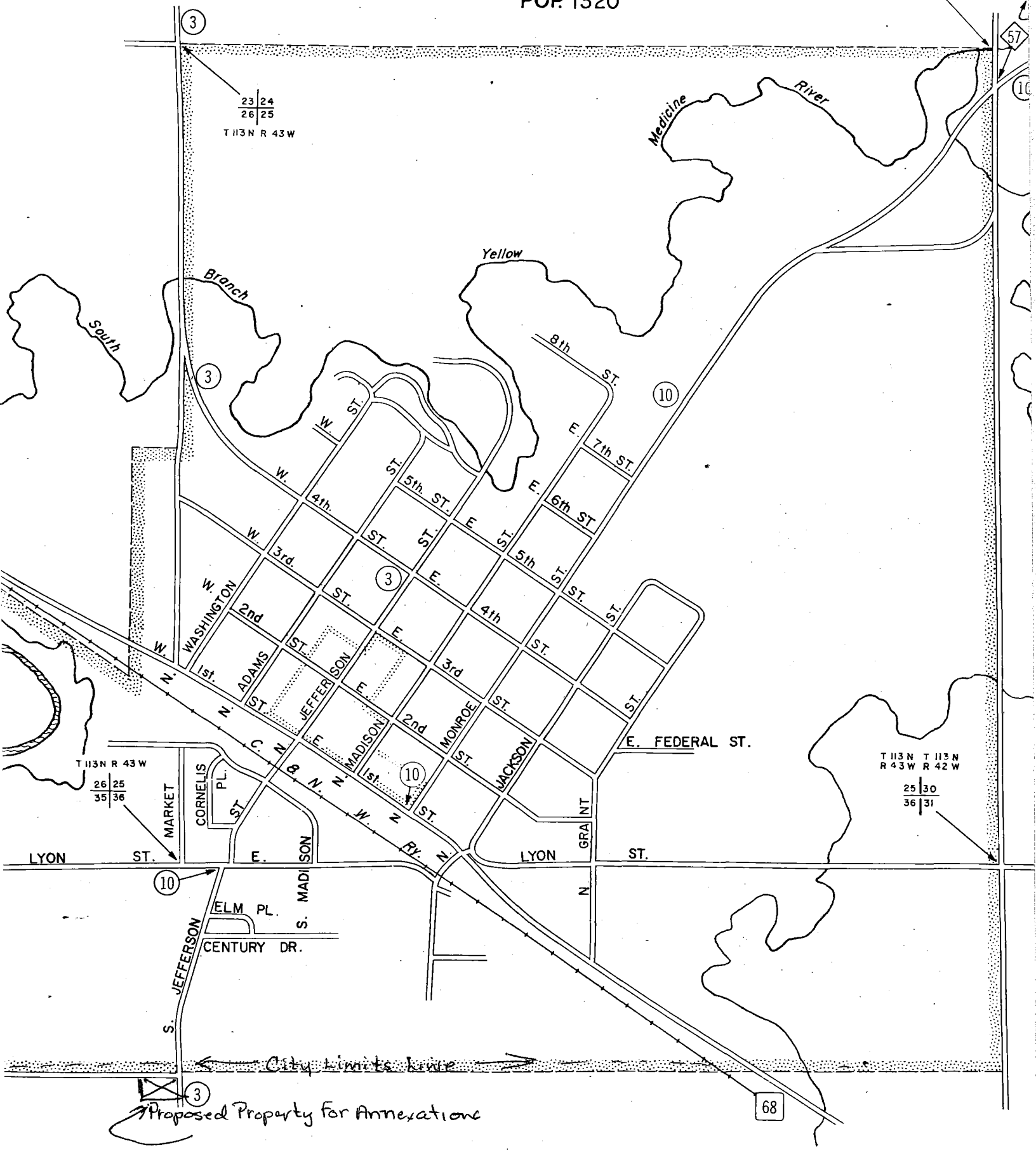



→ Property proposed for annexation

↙ Dotted line represents City limits

REC'D. BY  
MMB DEC 20 1989

Section 35 Township 113 Range 43  
1.06 Acres M or L PT SE4 NE4 EX 297' X 165' for cemetery EX .99 to  
Merritt, EX 37.61 acres to Moorse

and

Section 35 Township 113 Range 43  
.99 acres M or L PT SE4 NE4 (117' X 370') and Easement of Record