

CITY OF WACONIA
ORDINANCE NO. 365

AN ORDINANCE ANNEXING CERTAIN LANDS INTO THE CORPORATE LIMITS
OF THE CITY OF WACONIA, MINNESOTA

WHEREAS, The City of Waconia has received a petition to annex certain lands into the corporate limits of the City of Waconia, Minnesota; and

WHEREAS, The City Council has filed an intent to annex with the State of Minnesota Municipal Board, who has assigned Docket No. A-4672; and

WHEREAS, The Municipal Board has advised the City that all necessary requirements have been met for this annexation and that the City may proceed to adopt and file an annexation ordinance.

NOW, THEREFORE, THE CITY COUNCIL OF THE CITY OF WACONIA, CARVER COUNTY, MINNESOTA DOES HEREBY ORDAIN:

SECTION 1. Declaration. It is hereby determined that the annexation of lands described in SECTION 2 below would be in the best interest of the City of Waconia.

SECTION 2. Territory Annexed.

(Paul Strong Property)

That part of the East 1/2 of the Southwest 1/4 of Section 23, Township 116, Range 25, described as follows:

Commencing at the center post of Section 23, Township 116, Range 25; thence running South on said Center line to the South line of said Section 160 rods; thence west on said South line 45 rods to a post; thence North 160 rods to a post on the East and West Center line; thence East to the place of beginning 45 rods.

EXCEPT THE FOLLOWING TRACT:

1. All that part thereof which lies northerly of the northerly right-of-way-line of the Chicago and Northwestern Railway.

(NSP Property)

All that part of the Southeast Quarter (SE 1/4) of Section 23, Township 116, North of Range 25, West of the 5th P.M. as follows:

Commencing at a point 33 feet South of the center of said Section 23; thence South on the North and South center line of said Section 23, 400 feet to the Northerly right-of-way line of State Trunk Highway Number 5; thence northeasterly on the north line of said Trunk Highway number 5, 604.4 feet; thence northwesterly 102.75 feet to a point 33 feet South of the East and West Center line of said Section 23 and 517.25 feet East of the place of beginning; thence West on a line parallel to the East and West center line of said Section 23, 517.25 feet to the place of beginning. Containing 3.22 acres, more or less.

SECTION 3. Filing. The City Clerk is hereby directed to file certified copies of this Ordinance with the Municipal Board of the State of Minnesota, the Secretary of State, and the County Auditor of Carver County as required by law.

SECTION 4. Effective Date of Annexation. This Ordinance takes effect upon its passage and publication and the filing of certified copies as directed in Section 3 and shall be deemed final upon approval of this Ordinance by the Municipal Board of the State of Minnesota.

Adopted by the City Council of the City of Waconia, Minnesota this 16th day of January, 1990.



Larry D. Bodahl

ATTEST: 

Esther Zellmann, Clerk-Treasurer

M/ Lehrke

S/ Kelzer

Zender	<u>Aye</u>
Kelzer	<u>Aye</u>
Lehrke	<u>Aye</u>
Findley	<u>Absent</u>
Bodahl	<u>Aye</u>

CITY OF WACONIA

Existing
— = City limits

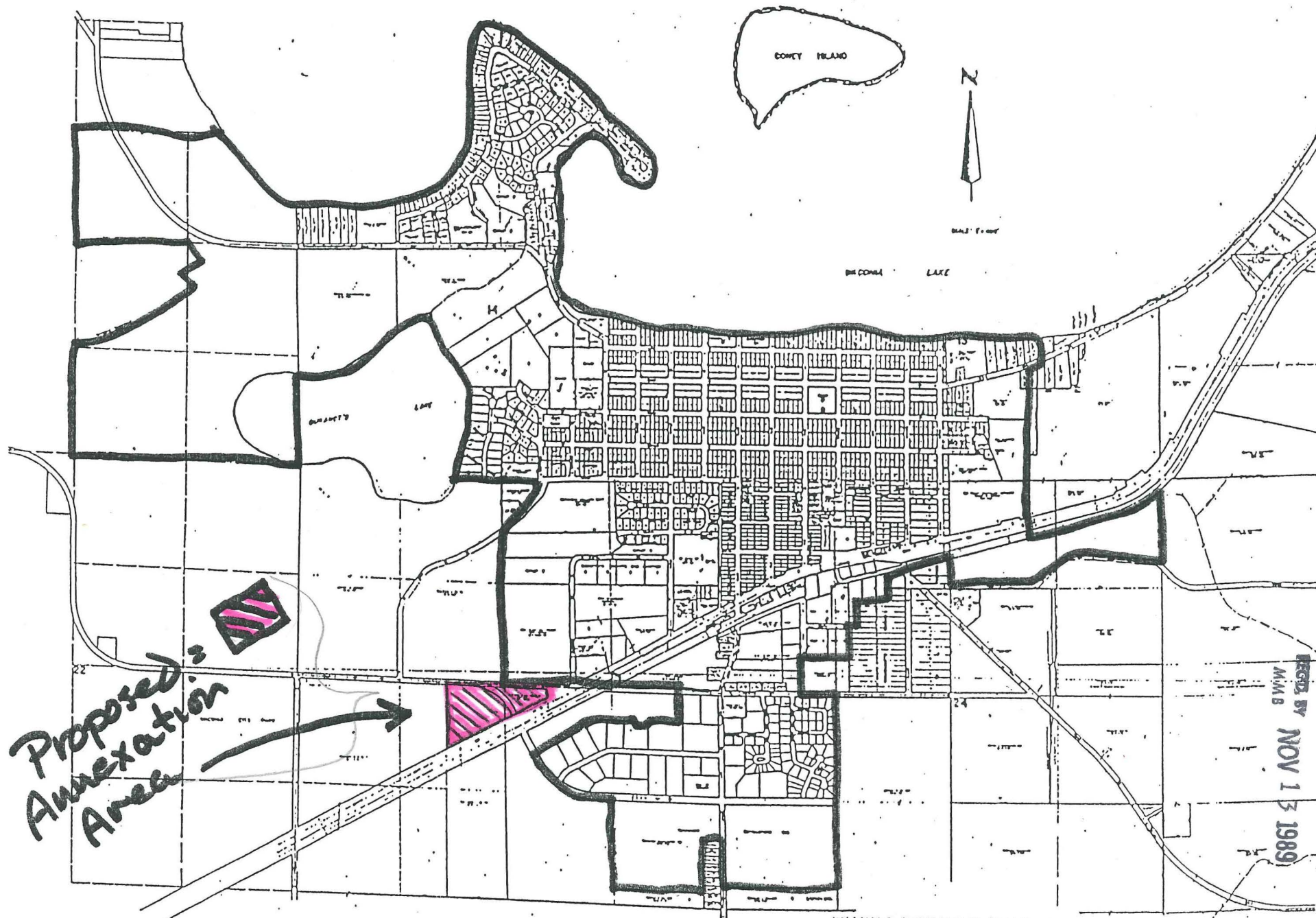

REC'D BY NOV 07 1989
MWB

REC'D BY OCT 12 1989
MWB

REC'D BY NOV 13 1989
MWB

