

ORDINANCE NO. 198

AN ORDINANCE EXTENDING THE CORPORATE LIMITS OF THE CITY OF STEWARTVILLE TO INCLUDE CERTAIN UNINCORPORATED TERRITORY COMPLETELY SURROUNDED BY LAND WITHIN THE CITY LIMITS AND ABUTTING THEREON.

WHEREAS, certain territory described below is not presently included within the corporate limits of any incorporated city or borough; and

WHEREAS, this territory is completely surrounded on all sides by lands already included within the corporate limits of the city and is deemed to be urban or suburban in character;

The city council of Stewartville ordains:

Section 1. Territory annexed. The corporate limits of the city of Stewartville, Minnesota, are hereby extended to include the unplatted territory described as follows; which territory now is and has heretofore been completely surrounded by territory already included within the city limits:

High Forest Township, Olmsted County, that part of the Northwest (NW) Quarter of the Northeast Quarter designated as follows: Beginning at the Northwest (NW) corner of the Northeast (NE) quarter, thence easterly along the North line 287.20 feet, thence Southerly 303.34 feet, thence Westerly 287.20 feet to the West line of said Northeast (NE) Quarter, thence Northerly along said West line, 303.34 feet to the point of beginning, Section No. Two (2), Township No. 104, in Range No. Fourteen (14).

and

High Forest Township, Olmsted County, commencing at the Northeast (NE) corner of the Northwest Quarter (NW 1/4), Section No. Two (2), Township No. 104, in Range No. Fourteen (14), thence West 12.64 rods, thence south 56.86 rods, thence East 12.64 rods, thence North 56.86 rods to a place of beginning

Section 2. Filing. The city clerk (recorder) is directed to file certified copies of this ordinance with the Secretary of State, the County Auditor of the county in which the property is located, the Town Clerk of the affected township and the Minnesota Municipal Board.

Section 3. Population. The population of the annexed territory is 10 or less.

Section 4. Effective date of annexation. This ordinance takes effect upon passage and publication and the filing of certified copies as directed in Section 2 and approval by the Minnesota Municipal Board.

Adopted by the city council of City of Stewartville, Minnesota,

1989.

Attest:

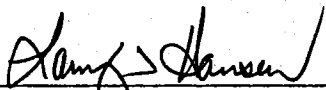
  
\_\_\_\_\_  
Larry D. Hansen  
City Clerk-Administrator

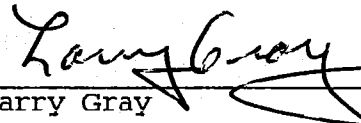
  
\_\_\_\_\_  
Larry Gray  
Mayor

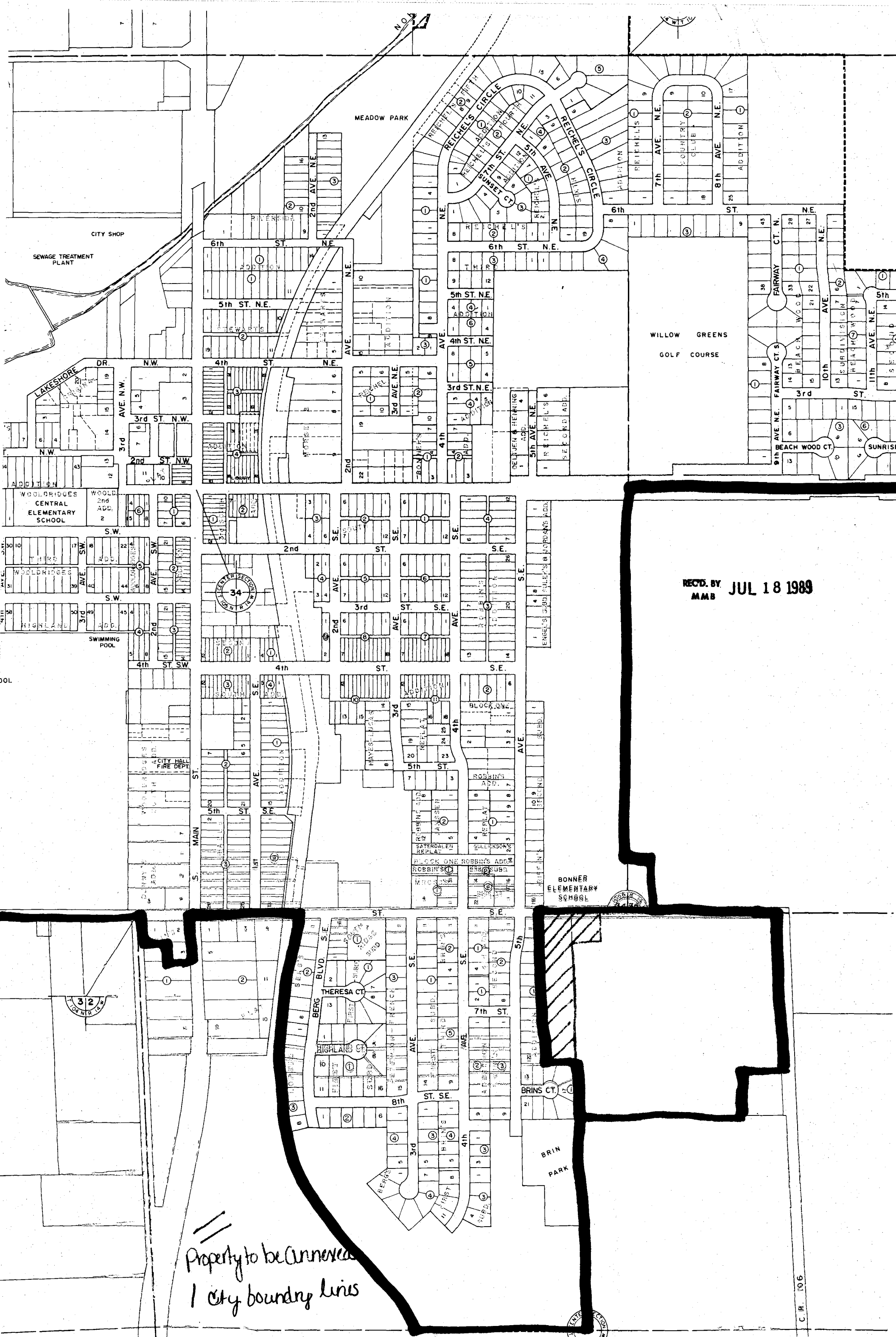

REC'D. BY JUL 18 1989  
MAM

Property to be Annexed  
/ City boundary lines