

AN ORDINANCE ANNEXING THE NORTHEAST QUARTER OF SOUTHEAST QUARTER (NE $\frac{1}{4}$  of SE $\frac{1}{4}$ ) OF SECTION TWENTY-THREE (23), TOWNSHIP FORTY-ONE (41), RANGE TWENTY-ONE (21), PINE COUNTY, MINNESOTA, TO THE CITY OF HINCKLEY

The City Council of the City of Hinckley ordains:

SECTION 1. WHEREAS, Scott A. Jensen and Elaine A. Jensen, Husband and Wife, are the owners in fee simple of the following described real estate situated in Hinckley Township, Pine County, Minnesota, to-wit:

Northeast Quarter of Southeast Quarter (NE $\frac{1}{4}$  of SE $\frac{1}{4}$ ) of Section 23, Township 41, Range 21, LESS the North Half of Northeast Quarter of Northeast Quarter of Southeast Quarter (N $\frac{1}{2}$  of NE $\frac{1}{4}$  of NE $\frac{1}{4}$  of SE $\frac{1}{4}$ ) of Section 23, Township 41, Range 21, Pine County, Minnesota.

SECTION 2. WHEREAS, Timothy P. Schmitz and Florence M. Schmitz, Husband and Wife, are the owners in fee simple of the following described real estate situated in Hinckley Township, Pine County, Minnesota, to-wit:

North Half of Northeast Quarter of Northeast Quarter of Southeast Quarter (N $\frac{1}{2}$  of NE $\frac{1}{4}$  of NE $\frac{1}{4}$  of SE $\frac{1}{4}$ ) of Section 23, Township 41, Range 21, Pine County, Minnesota.

SECTION 3. WHEREAS, said above-described property is unplatted and does not exceed 200 acres, and abuts to and is bordered by the City of Hinckley, and is not included in any other municipality.

SECTION 4. WHEREAS, the Township of Hinckley has waived in writing all right to object to the above-described annexation of the above-described real estate by the City of Hinckley, and

SECTION 5. The City Council of the City of Hinckley finds that annexation of the above-described premises to the City of Hinckley is in the best interests of the City of Hinckley and the premises affected, and further finds that the above-described premises are now, or are about to become, urban or suburban in character.

BE IT HEREBY ORDAINED, That the City Council of the City of Hinckley,, pursuant to Minnesota Statutes Annotated 414.033, Subd. 4, does hereby annex said above-described lands and premises to the City of Hinckley, and the Clerk of the City Council of the City of Hinckley is hereby directed to forthwith send copies of this Ordinance to the Minnesota Municipal Board of the State of Minnesota, the Town Clerk of the Township of Hinckley, the Pine County Auditor, and the Secretary of State of the State of Minnesota.

Passed by the Hinckley City Council this 7<sup>th</sup> day of March, 1989.

Tom R. Celuch  
Mayor of City of Hinckley

Attest:

James M. Ausmus  
City Clerk of the City of Hinckley

I hereby certify that the above Ordinance is a true and correct copy of an Ordinance adopted by the City Council of the City of Hinckley at a regular meeting of said Council held on the 7th day of March, 1989.

Dated: March 7<sup>th</sup>, 1989.

James M. Ausmus  
City Clerk  
City of Hinckley



# HINCKLEY

REC'D. BY FEB 21 1989  
MMR

T.41N.-R.21W.

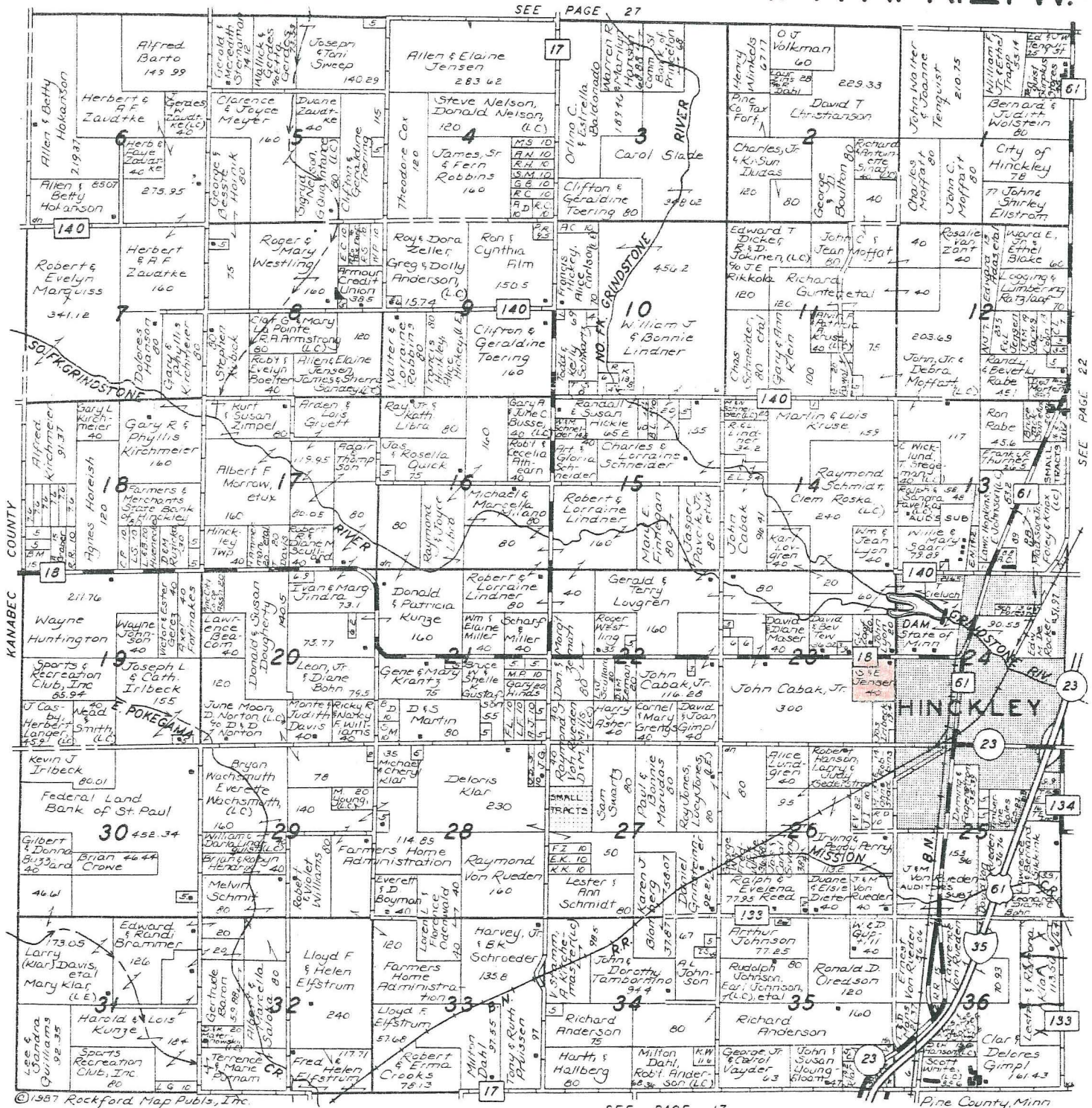

©1987 Rockford Map Publs., Inc. SEE PAGE 16

SEE PAGE 17

## HINCKLEY CO-OP AG SERVICE

P.O. Box 70, Hinckley, Minnesota 55037

(612) 384-6251

Where The  
Farm-to-Food  
System Begins

**PRODUCTS**  
Feed - Seed - Fertilizer - Chemicals

**SERVICES**  
Grinding - Mixing - Delivery & Fertilizer Spreading  
Custom Spraying



ASSOCIATED MILK PRODUCERS, INC.  
NORTH CENTRAL REGION

(218) 624-4803

Office:  
AMPI TWIN PORTS DIVISION  
HINCKLEY, MINNESOTA 55037  
PHONE: (612) 384-6131